

NOTE: To prevent rust, paint all exposed metal, such as weld seams, and/or metal exposed by grinding or cutting, with corrosion resistant paint.

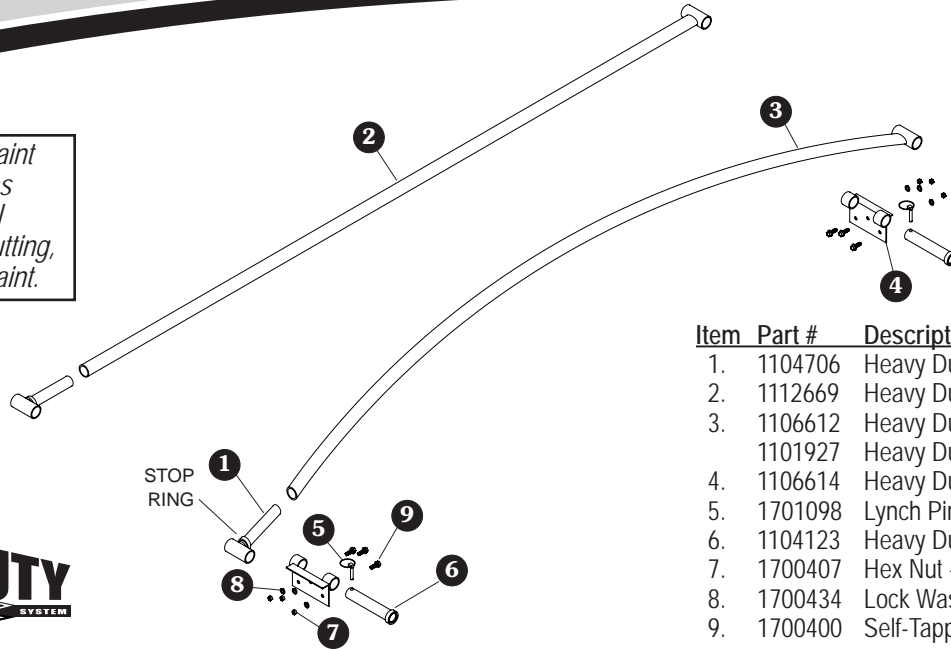

Item	Part #	Description
1.	1104706	Heavy Duty Bow Shank
2.	1112669	Heavy Duty Flat Bow
3.	1106612	Heavy Duty Low Rise Bow
	1101927	Heavy Duty High Rise Bow
4.	1106614	Heavy Duty Bow Bracket
5.	1701098	Lynch Pin - 5/16" x 1 3/4"
6.	1104123	Heavy Duty Bow Pin
7.	1700407	Hex Nut - 3/8"
8.	1700434	Lock Washer - 3/8"
9.	1700400	Self-Tapping Screw - 3/8" x 1"

STEP 1A: End Dumps and Belly Dumps: Equally space bow brackets on box, aligning brackets on opposite sides of box.

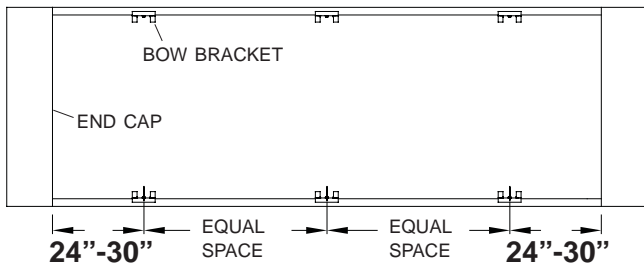

STEP 1B: Dump Bodies: Locate front bow brackets 8" behind any obstruction such as cab shield, dog house, or plank gussets. Equally space remaining bow brackets on box, aligning brackets on opposite sides of box.

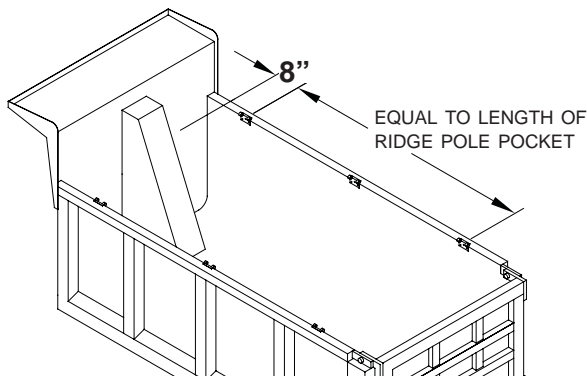

NOTE: If your kit uses a ridge pole, measure length of ridge pole pocket on the tarp. The distance between front and rear bow brackets should be equal to the length of the ridge pole pocket.

STEP 2: Mark and drill 5/16" holes, secure brackets with screws, washers, and nuts.

NOTE: To mount bows to planks, secure with 3/8" x 2 1/2" carriage bolts, nuts and lock washers (carriage bolts not included).

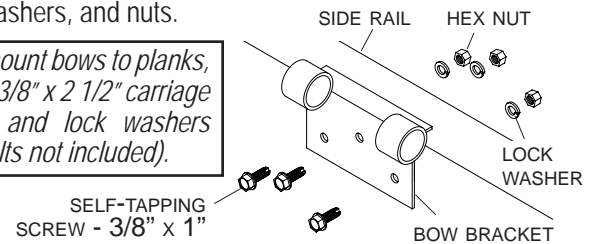

STEP 3: Insert bow shank into driver's side bow bracket, and align bow with passenger's side bow bracket. Align bow with bow shank, and mark point where bow meets stop ring. Remove bow and cut at marked location. Grind edges smooth. *Do not weld shank to bow.*

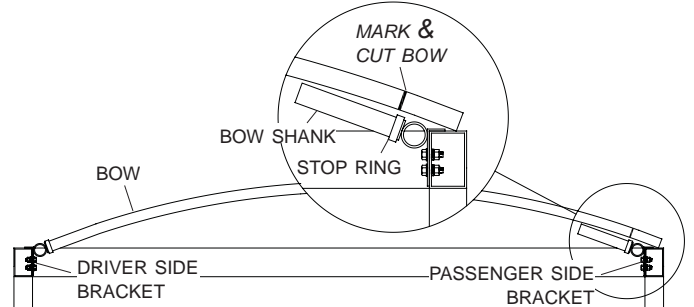

STEP 4: Insert bow shank into bow. Fasten bow into bow brackets with bow pins. Secure with lynch pins.

