

**STEP 1: Conductor Plug:** Unfasten and remove insert from conductor plug. Feed 6 ga. wire through plug, and into brass contacts on insert. Tighten set screws to secure wires. Replace insert into conductor plug and secure screw.

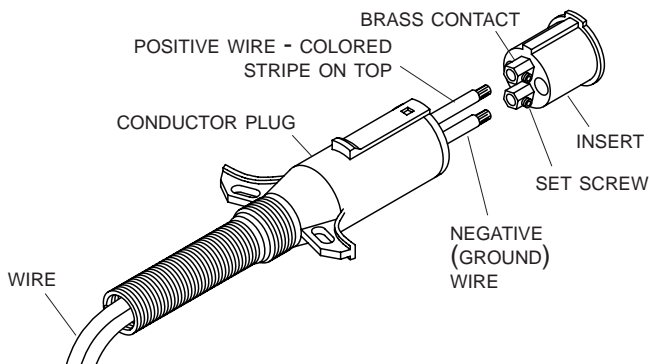

## CAUTION

**Check all hardware for complete assembly before operating. Inspect system at this time and adjust as required.**



**STEP 2: Rocker Switch:** Locate rocker switch in a convenient operating location. Switch can be mounted in cab, on dash panel, on driver's side door jamb or in a convenient location outside the cab.

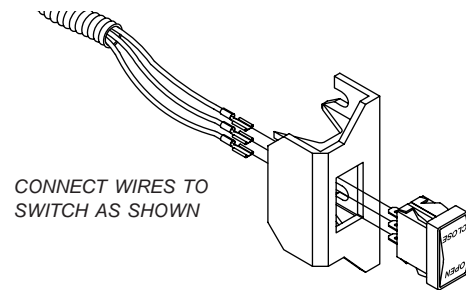

**STEP 3: Mount Solenoid:** Mount solenoid in a suitable location - a ventilated area near the battery is ideal. Determine best route for wire. This is usually along the frame with existing wire harness. Run 6 ga. wire from conductor plug to solenoid and from power supply to solenoid as shown in diagram. Run 14 ga. wires from solenoid to switch.

**STEP 4: Circuit Breaker & Battery:** Mount circuit breaker as close as possible to battery or power supply.

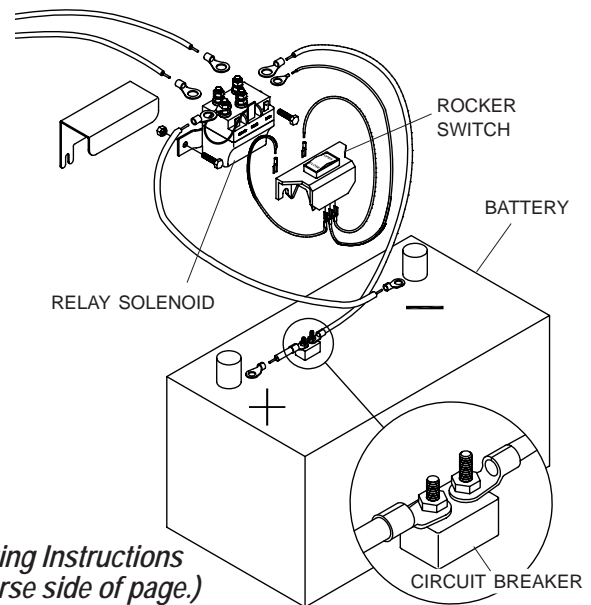

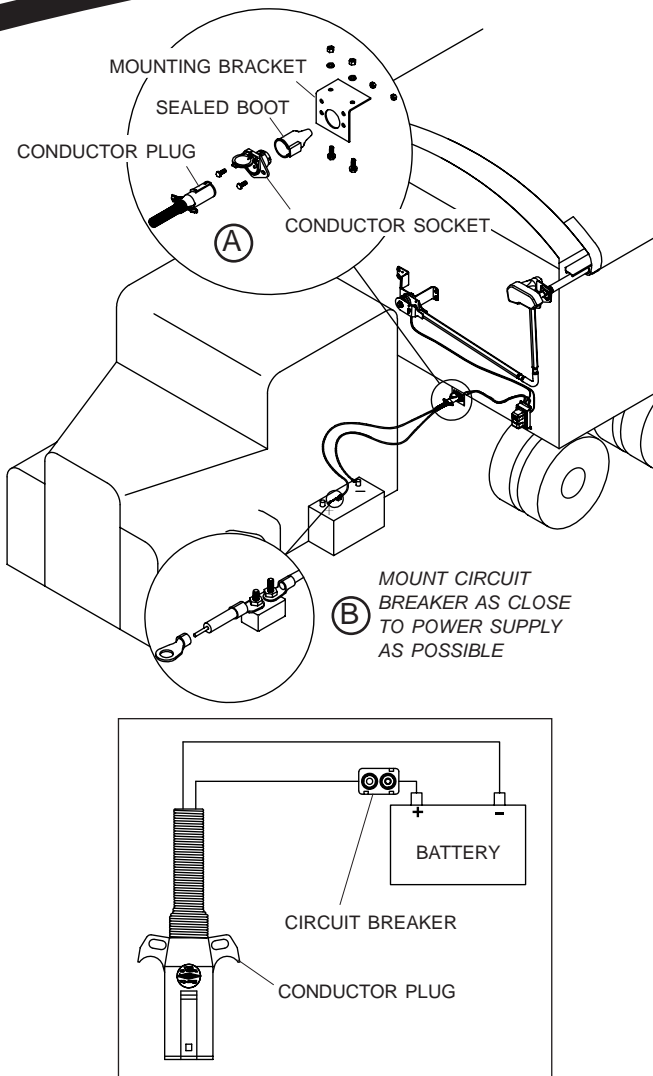

**STEP 1: Conductor Plug:** Unfasten and remove insert from conductor plug. Feed 6 ga. wire through plug and into brass contacts on insert. Tighten set screws to secure wires. Replace insert into conductor plug and secure screw.

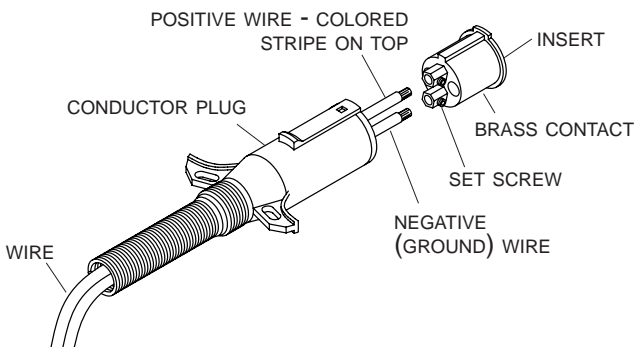

## CAUTION

**Check all hardware for complete assembly before operating. Inspect system at this time and adjust as required.**

*Cut wires to length and strip only enough wire insulation to install ring terminals. Insert bare wire into ring terminals and crimp securely.*

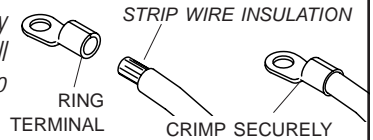

**STEP 2: Circuit Breaker & Battery:** Mount circuit breaker as close as possible to battery or power supply.

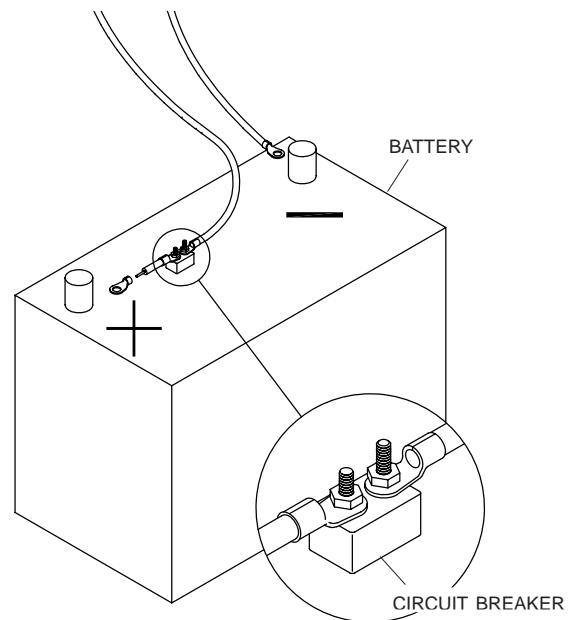

## Operation

**A) Check motor direction by activating switch to "OPEN".** If switch is running system backwards, change wire leads on motor to opposite connections.

**B) Close tarp:** Push switch to "CLOSE" and hold. Observe tarp and release switch when tarp is fully closed.

**C) Open tarp:** Push switch to "OPEN" and hold. Observe tarp and release switch when tarp is fully opened.

Release switch at end of cycle or modified-reset circuit breaker will trip. After breaker resets, switch will activate motor again. To reduce unnecessary strain on tarp components, release switch at end of each cycle.