

Item	Part #	Description
1.	1704837	Solar Panel
2.	1120829	Back Bracket
3.	1120839	Solar Panel Bracket - Standoff
4.	1704397	Rubber Grommet - 7/16" x 5/16"
5.	1120291	Spacer Washer - HDPE - 1/4" x 1"
6.	1700400	Self-Tapping Screw - 3/8" x 1"
7.	1700434	Lock Washer - 3/8"
8.	1700407	Hex Nut - 3/8"
9.	1121045	Electrical Wire - 14 Ga. - 3 Lead - 10'
10.	1704152	Dome Nut - 1/2"
11.	1704187	Lock Nut - 1/2"
12.	1704739	Ring Terminal - 14-16 Ga. x #10 Stud

WIRE CLIPS	
Item	Part # Description
13.	1704700 Wire Clip - Nylon
14.	1704405 Self-Drilling Screw - #8 x 3/4"

STEP 1: Determine solar panel location on trailer. Locate panel toward passenger side of trailer, with electrical box on panel toward center of trailer. Hold panel and back brackets against trailer, aligning slots in back brackets with horizontal and vertical rivet lines on trailer. Mark rivets that need to be removed. If slots cannot be aligned with rivets, drill 5/16" holes in trailer and fasten with 3/8" x 1" self-tapping screw, lock washers and nuts.

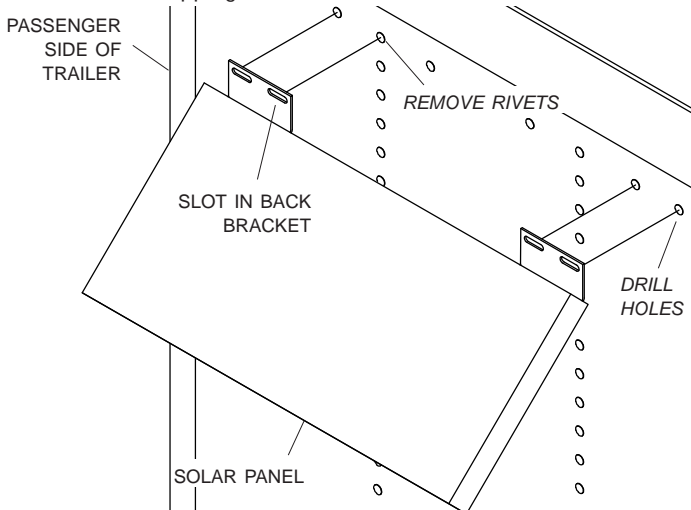

STEP 2: Mark and drill 7/16" holes and fasten back brackets to panel with 3/8" x 1" self-tapping screws, lock washers and nuts.

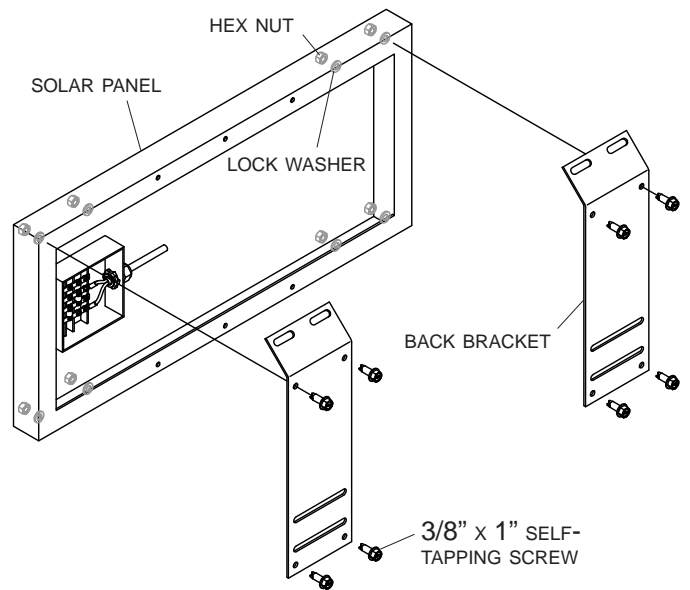

STEP 3: Mark hole location near solar panel electrical box for electric wire to pass through trailer wall. Drill 3/4" hole and install grommet.

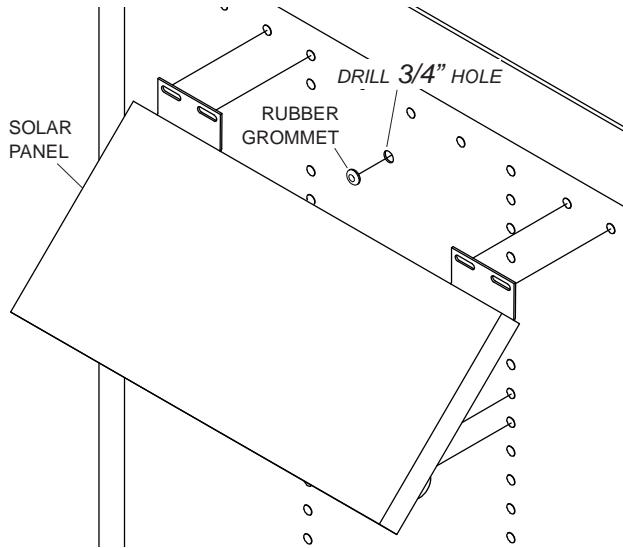

NOTE: Install backer plate if trailer wall is less than 1/8" thick.

STEP 4: Align two standoff brackets with slots in back brackets. Loosely fasten standoff brackets to back bracket with 3/8" x 1" self-tapping screws, lock washers and nuts.

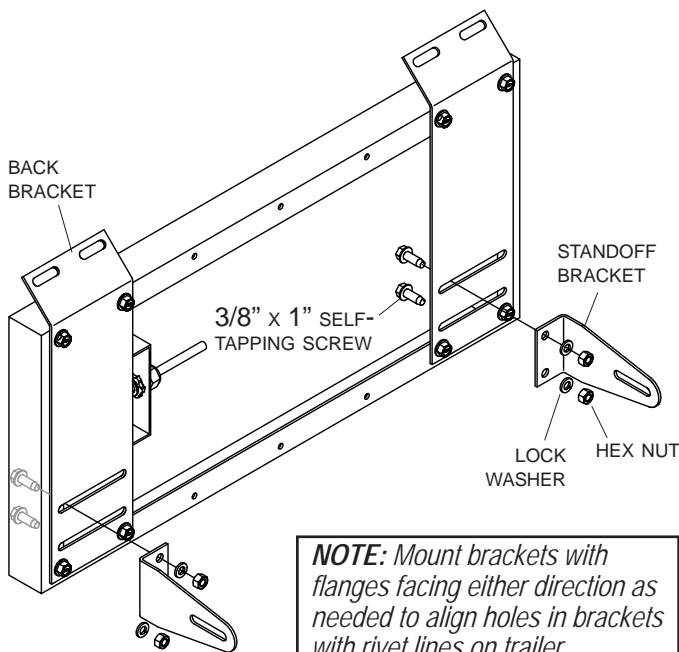

NOTE: Mount brackets with flanges facing either direction as needed to align holes in brackets with rivet lines on trailer.

STEP 5: Loosely fasten remaining two standoff brackets to installed standoff brackets. Fasten with 3/8" x 1" self-tapping screws, lock washers and nuts.

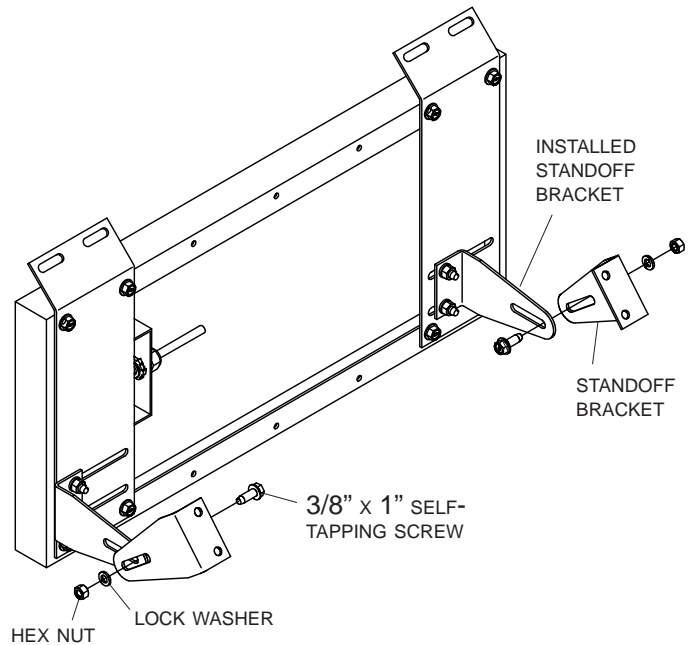

STEP 6: Mount solar panel to trailer through rivet holes where possible using 3/8" x 1" self-tapping screws, spacer washers, lock washers and nuts. Fasten back brackets to horizontal rivet line, then loosely fasten standoff brackets to trailer.

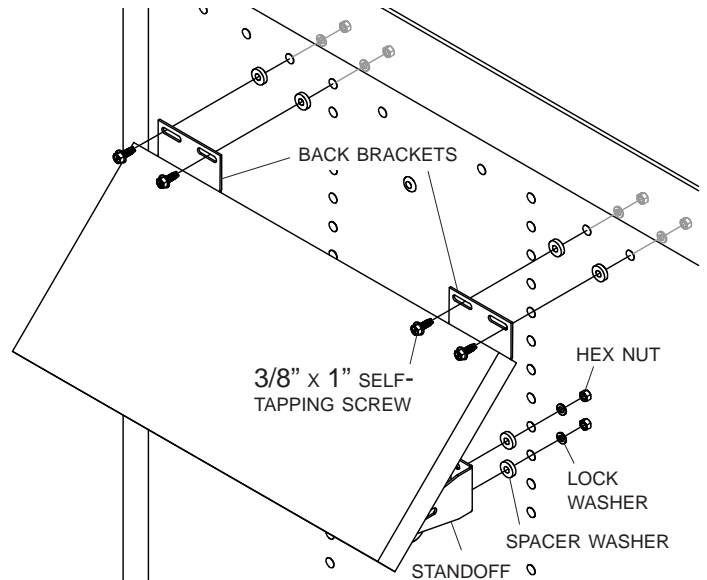

STEP 7: Tighten all fasteners on trailer first, then tighten standoffs to back brackets. Tighten fasteners holding standoffs together last. Run electrical wire through trailer to inside of trailer. Secure with wire clips (included).

Item	Part #	Description
1.	1119783	Battery Box Bottom
2.	1117734	Battery Box Top
3.	1117740	Battery Box Hold-Down Bracket
4.	1117739	Battery Box Front Bracket
5.	1117741	Battery Clip
6.	1704162	Solar Controller
7.	1704161	Solar Gel Battery
8.	1700381	Cap Screw - 1/4" x 1"
9.	1700408	Hex Nut - 1/4"
10.	1700427	Flat Washer - 1/4"
11.	1700436	Lock Washer - 1/4"
12.	1704152	Dome Nut - 1/2"
13.	1704187	Lock Nut - 1/2"
14.	1704354	Modified-Reset Circuit Breaker - 40 Amp
15.	1703327	Button Hd. Cap Screw - 1/4" x 5/8"
16.	1702654	Machine Screw - Rnd. Hd. - #10 x 1"
17.	1702653	Nut/Machine Screw w/Washer - #10
18.	1700400	Self-Tapping Screw - 3/8" x 1"
19.	1700434	Lock Washer - 3/8"
20.	1700407	Hex Nut - 3/8"
21.	1701357	End Plug

WIRE CLIPS

28. 1704338 Self-Tapping Screw - 1/4" x 1"
 29. 1704595 Wire Clip - 1 1/4" - 9/32" Hole

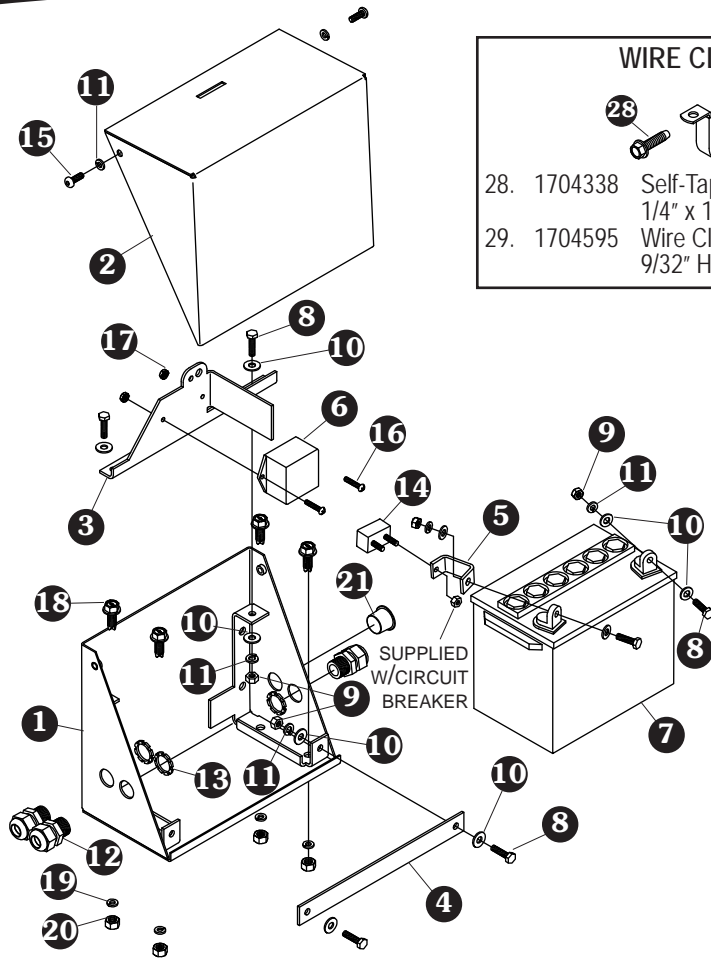

TERMINALS & CONNECTORS

22. 1702707 Ring Terminal - 6 Ga. x 1/4" Stud
 23. 1704153 Ring Terminal - 14-16 Ga. x 1/4" Stud
 24. 1704739 Ring Terminal - 14-16 Ga. x #10 Stud
 25. 1703245 Ring Terminal - 6 Ga. x #10 Stud
 26. 1704862 Wire Nut Connector
 27. 1704154 Parallel Connector - 16-14 Ga.

BATTERY BOX BOTTOM

STEP 1: Using either holes in bottom or in back of battery box bottom as a guide, mark hole locations on trailer. Drill 5/16" holes and fasten battery box bottom to trailer with 3/8" x 1" self-tapping screws, lock washers and nuts.

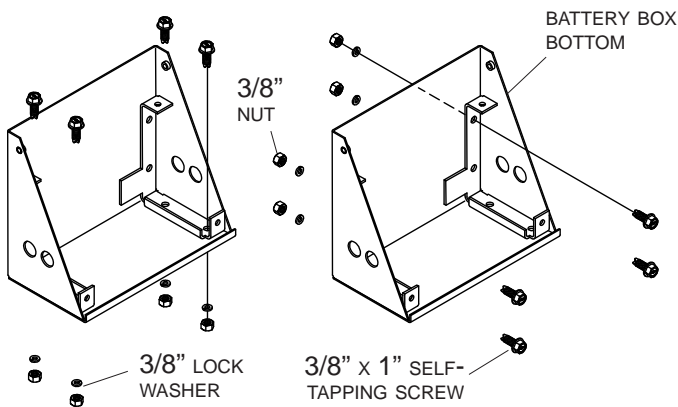

NOTE: Install backer plate if trailer wall is less than 1/8" thick.

BATTERY CLIP & CIRCUIT BREAKER

STEP 2: Fasten battery clip and circuit breaker to battery with 1/4" cap screws, flat washers, lock washers and nuts as shown. Fasten circuit breaker with nut provided.

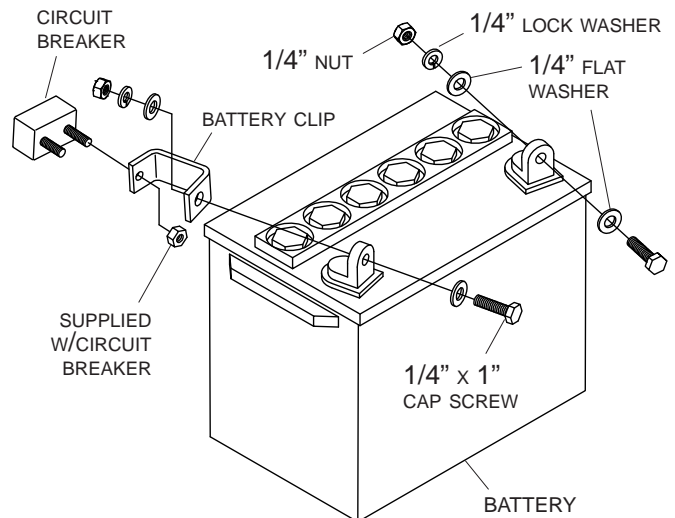

DOME NUTS & HOLD-DOWN BRACKETS

STEP 3: Secure dome nut strain reliefs to battery box bottom with 1/2" lock nuts.

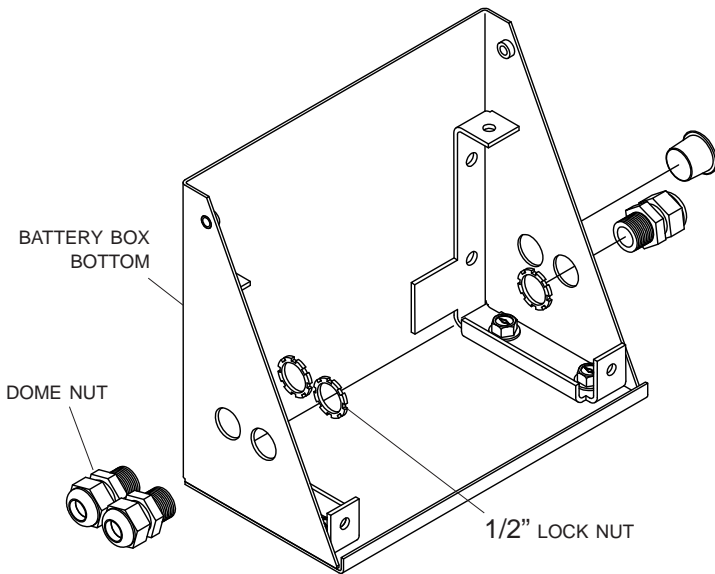

SOLAR CONTROLLER

STEP 4: Fasten solar controller to hold-down bracket with #10 x 1" machine screws and nut/washers.

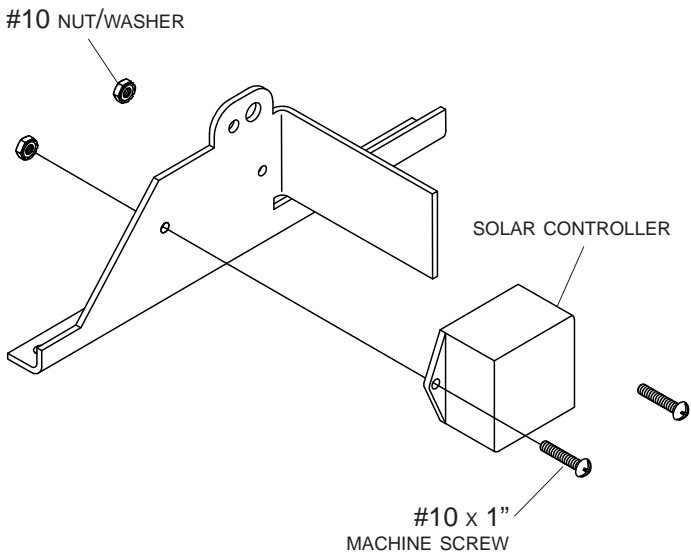

BATTERY & BRACKETS

STEP 5: Place battery in battery box bottom. Install hold-down bracket and front bracket with 1/4" x 1" cap screws, flat washers, lock washers and nuts.

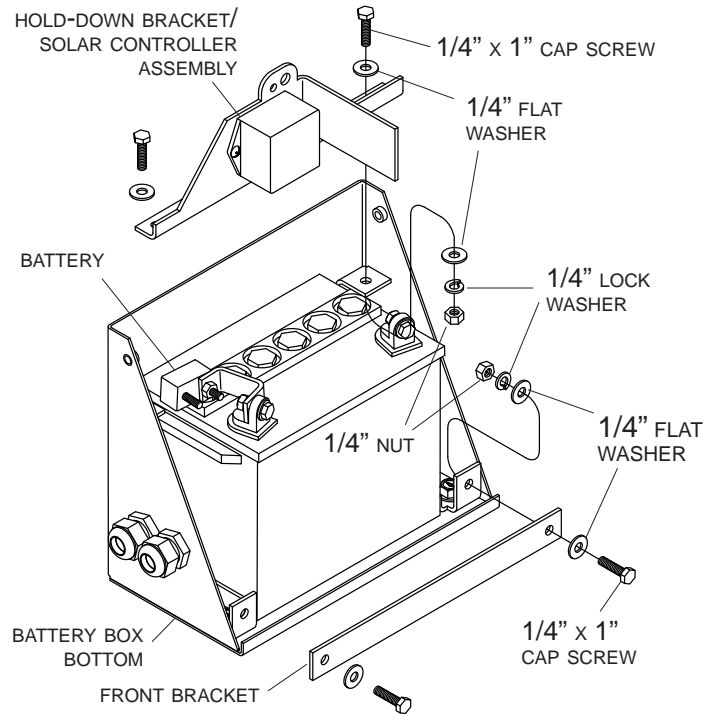

BATTERY BOX TOP

NOTE: Before installing box top, connect wire as shown in solar panel instructions on next page.

STEP 6: Secure battery box top to battery box bottom with 1/4" x 5/8" cap screws and lock washers.

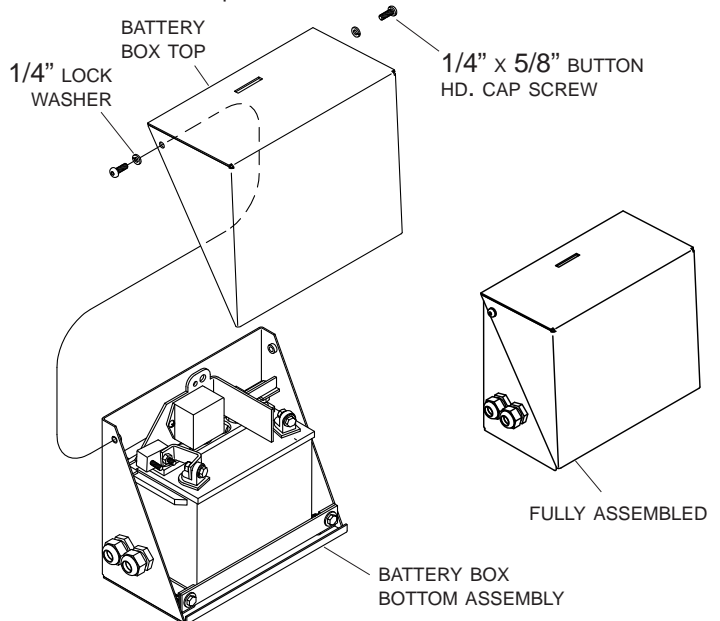

This unit replaces battery power from the vehicle. Disconnect vehicle power source before installing this unit.

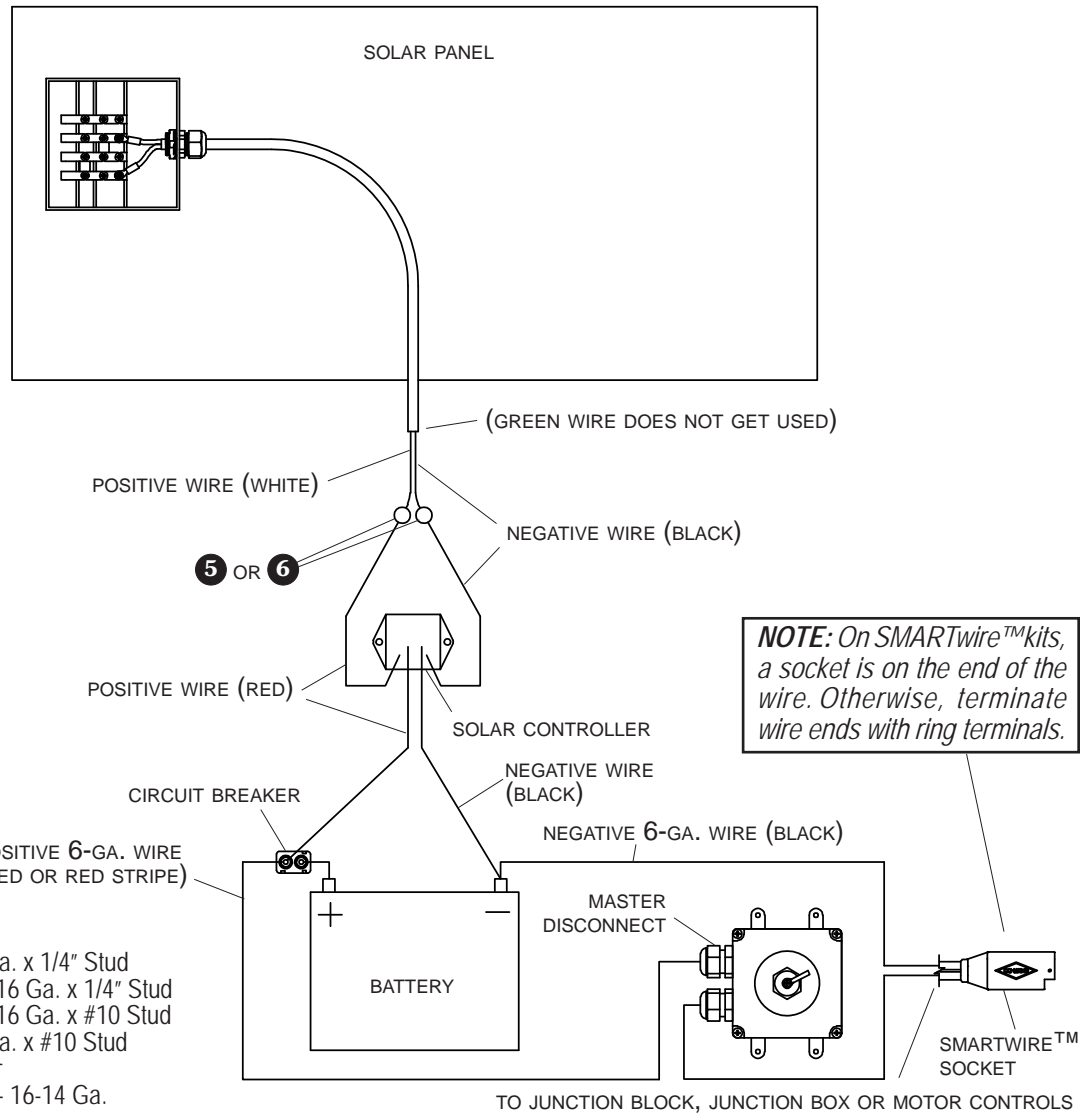

Item	Part #	Description
1.	1702707	Ring Terminal - 6 Ga. x 1/4" Stud
2.	1704153	Ring Terminal - 14-16 Ga. x 1/4" Stud
3.	1704739	Ring Terminal - 14-16 Ga. x #10 Stud
4.	1703245	Ring Terminal - 6 Ga. x #10 Stud
5.	1704862	Wire Nut Connector
6.	1704154	Parallel Connector - 16-14 Ga.

SOLAR PANEL WIRING

STEP 1: Insert solar panel lead through 1/2" dome nut on right side of battery box. Connect solar panel leads to solar controller leads with parallel connectors or wire nuts. Connect positive (white) solar panel lead to positive solar wire (outside red) on controller. Connect negative solar panel lead (black) to negative solar wire on controller (outside black).

STEP 2: Connect solar controller to battery with ring terminals. Connect positive solar controller wire (inside red) to circuit breaker with 14- to 16-ga. x #10 ring terminal ③. Connect negative solar controller wire (inside black) to negative battery terminal with 14- to 16-ga. x 1/4" ring terminal ②.

NOTE: Circuit breaker is needed to protect solar panel. Mount circuit breaker next to positive (red) battery terminal.

WIRING LOADS TO BATTERY

STEP 3: Two 1/2" dome nuts (fit up to 6-ga. wire) are provided for the 6-ga. load wire. For outgoing load wire, crimp 6-ga. x #10 ring terminal ④ to positive wire and connect to circuit breaker. Crimp 6-ga. x 1/4" ring terminal ① on negative wire and connect to negative battery post. Route 6-ga. wire as desired but do not fasten down yet. Locate desired mounting position for master disconnect switch and install prior to securing wire.

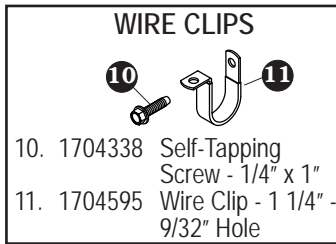
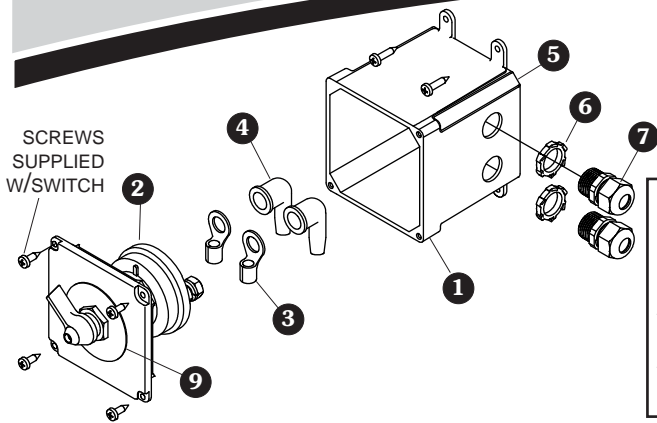

Item	Part #	Description
1.	1704405	Self-Drilling Screw - #8 x 3/4"
2.	1704283	Master Battery Disconnect Switch
3.	1703244	Ring Terminal - 6 Ga. x 3/8" Stud
4.	1704330	Rubber Boot
5.	1118556	Solar Master Disconnect Box
6.	1704187	Lock Nut - 1/2"
7.	1704152	Dome Nut - 1/2"
8.	1119077	6 Ga. Dual Conductor Wire - 10' (not shown)
	1121094	SMARTwire™ - 6 Ga. Socket - 13' 8" (not shown)
9.	1704284	Face Plate - Rotary Switch

STEP 1: Route wire (P/N 1119077 or 1121094) along planned route. Determine desired location of master disconnect switch along wire route. Cut positive half of this wire at mounting location. Do not cut negative wire. Carefully peel positive side of wire away from negative side about 1' on either side of cut.

STEP 2: Unfasten screws and remove cover/switch assembly from master disconnect box.

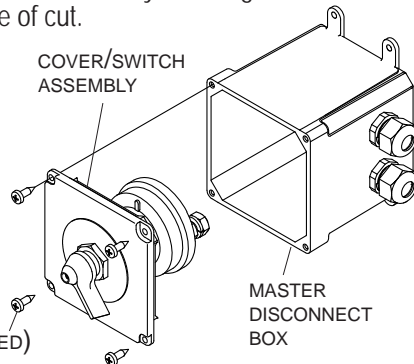

#8 x 1/2" SCREWS (SUPPLIED)

STEP 3: Run positive 6-ga. wire ends through dome nuts on master disconnect box. Run wire ends through rubber boots and crimp 3/8" ring terminals to ends of wire.

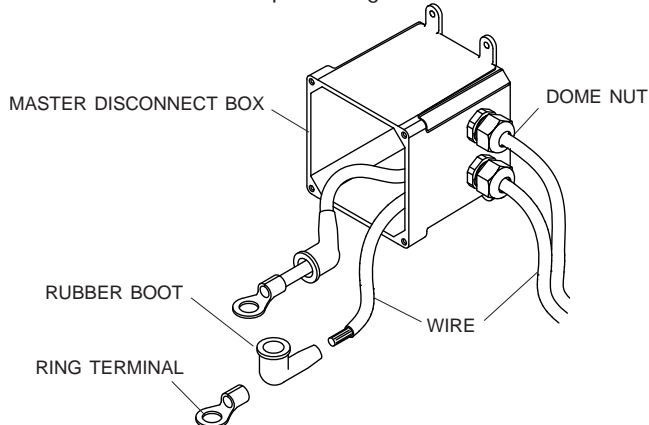

STEP 4: Connect wires to master disconnect switch. Coat with dielectric grease and install rubber boots over ring terminals.

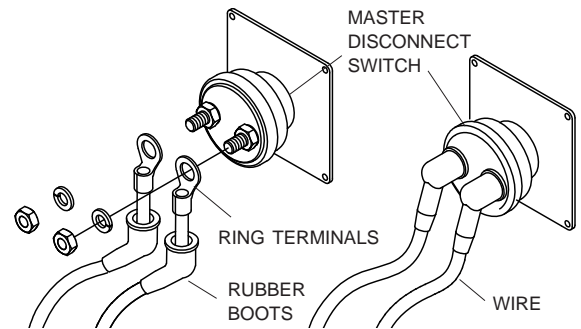

STEP 5: Re-install cover/switch assembly to master disconnect box. Fasten with supplied (#8 x 1/2") screws.

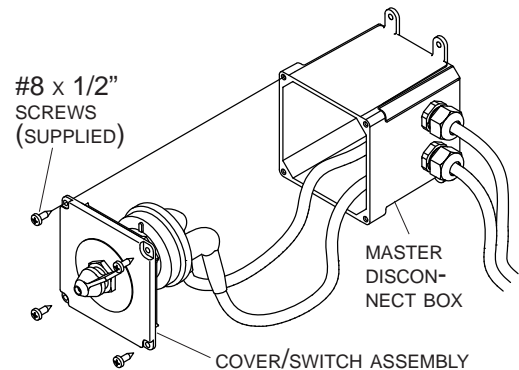

STEP 6: Fasten master disconnect switch box to trailer with four #8 x 3/4" self-drilling screws.

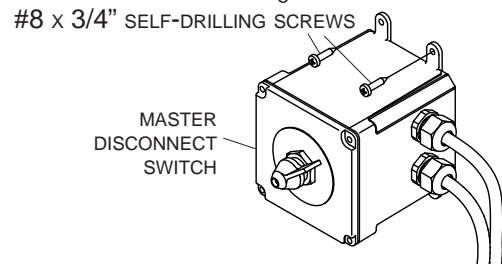

NOTE: Cut wires to length and strip only enough wire insulation to install ring terminals. Insert bare wire into ring terminals and crimp securely.

