

Item	Part#	Description
1.	1118028	ProTrap® Hinge Bracket
2.	1118277	Shim Insulator
3.	1700400	Self-Tapping Screw - 3/8" x 1"
4.	1700429	Flat Washer - 3/8"
5.	1700434	Lock Washer - 3/8"
6.	1700407	Hex Nut - 3/8"
7.	1702904	Cap Screw - 3/8" x 1 1/8"
8.	1701580	Nylon Lock Nut - 3/8"
9.	1704264	Cap Screw - 3/8" x 2"
10.	1119065	ProTrap® Motor Assembly
11.	1704367	Flange Hd Cap Screw - #10 x 3/4"
12.	1704302	SMARTtransmitter™ w/Decal
13.	1704597	SMARTtransmitter™ Battery (High Capacity)
14.	1118601	ProTrap® Display Base
15.	1118602	SMARTtransmitter™ Holder
16.	1703959	Cap Screw - 1/4" x 3/4"
17.	1700427	Flat Washer - 1/4"
18.	1700436	Lock Washer - 1/4"
19.	1700408	Hex Nut - 1/4"
20.	1704271	ProTrap® Decal

**STEP 1:** Assemble ProTrap® hinge bracket assembly to ProTrap® motor assembly with 3/8" x 1 1/8" cap screws and nylon lock nuts.

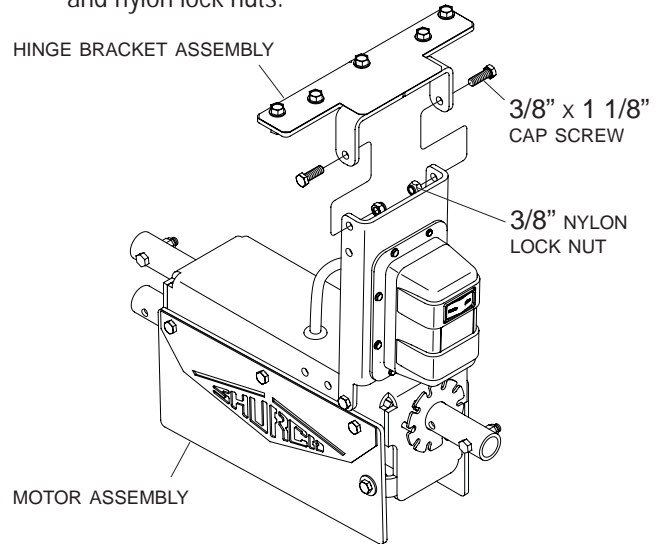

**STEP 2:** Fasten SMARTtransmitter™ holder to ProTrap® display base with 1/4" x 3/4" cap screws, lock washers, flat washers and hex nuts.

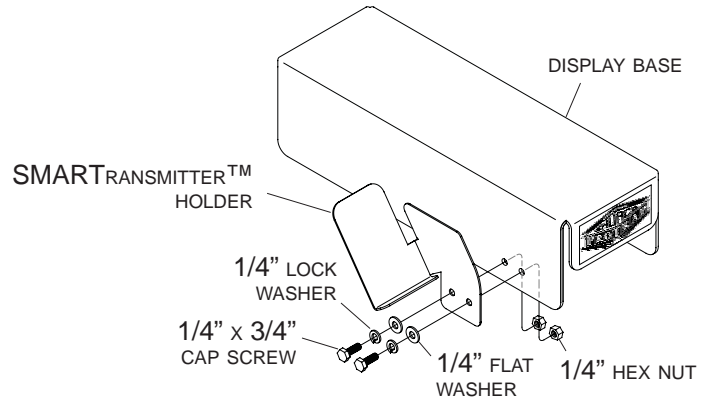

**STEP 3:** Set ProTrap® motor/hinge bracket assembly on display base assembly as shown.

