



ENGINEERED TARPING SOLUTIONS

P/N 1114952 Rev. H

# OWNER'S MANUAL



## Value Series Swing Arm Electric Shur-Lok<sup>®</sup>

*READ BEFORE INSTALLING*

PO BOX 713 ■ 2309 SHUR-LOK STREET ■ YANKTON, SD 57078-0713  
PHONE 1-800-4-SHUR-LOK (1-800-474-8756) ■ FAX 605-665-0501  
[www.shurco.com](http://www.shurco.com)

SHOP ONLINE: [www.shopshurco.com](http://www.shopshurco.com)

**NOTE:** Installation procedures and/or parts used may vary to fit your truck box.

**SWING ARM**

**STEP 1: Farm bodies:** Locate center line on front of truck box. Drill 9/16" hole on center line 38" to 56" from top of box.

**Semi trailers:** Locate center line on front of truck box. Drill 5/16" holes through 7" standoff on center line 38" to 56" from top of box.

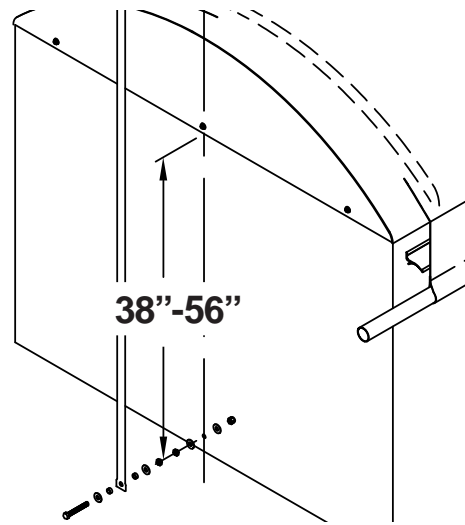

**NOTE:** Swing arm must operate without interference. Locate hole to allow clearance for swing arm operation.

**STEP 2:** Fasten as shown below. For farm bodies, adjust as needed to allow clearance for arm and motor, so not to hit any obstacles.

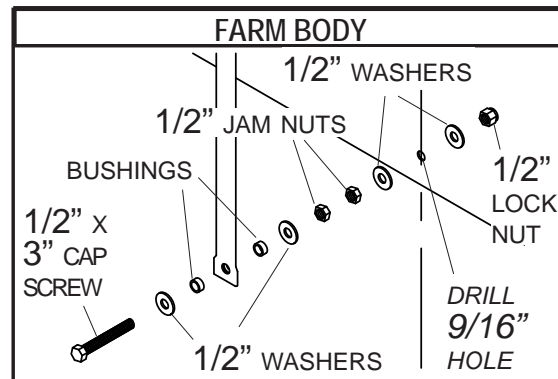
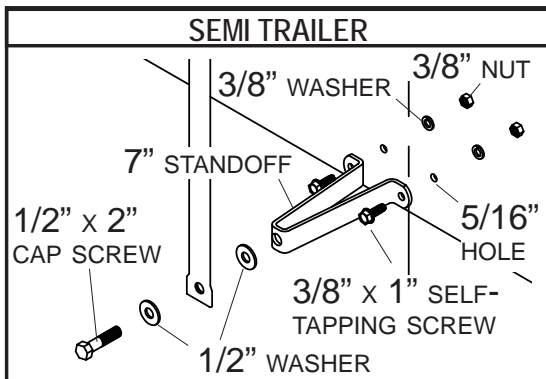
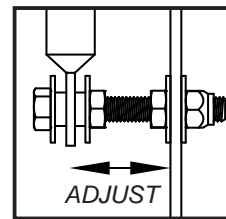

**SLIDE ARM & MOTOR**

**STEP 3:** Mount electric motor and back plate to upper slide arm with three 5/16" x 1/2" cap screws.

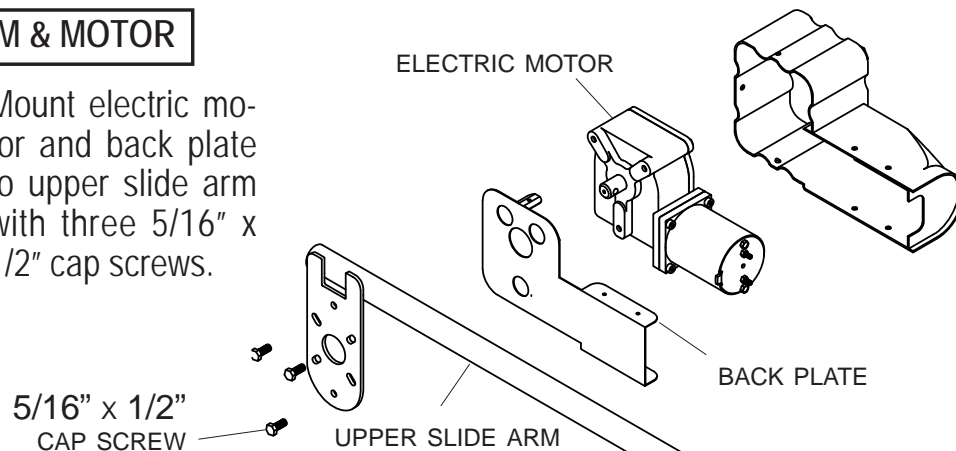

**STEP 4:** Roll tarp closed over box with roll tube hanging below latchplate. Remove crank assembly from roll tube.

**STEP 5:** Hold motor and install upper slide arm over lower swing arm. Insert motor shaft into roll tube adapter. Fasten with 5/16" x 2 1/2" cap screw and top lock nut. Align swing arm vertically so it swings freely without hitting any obstructions.

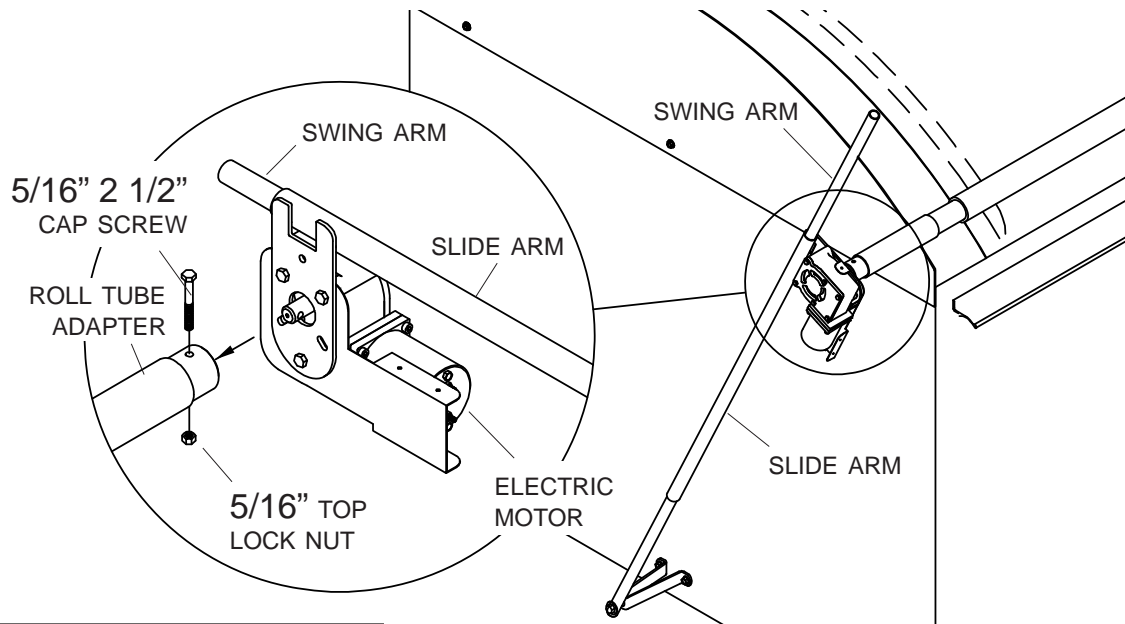

### ROLL TUBE EXTENSION

**STEP 6:** At front of trailer, slide tarp back on roll tube and adjust roll tube away from any obstructions, leaving space for roll tube eye and retaining rings on roll tube.

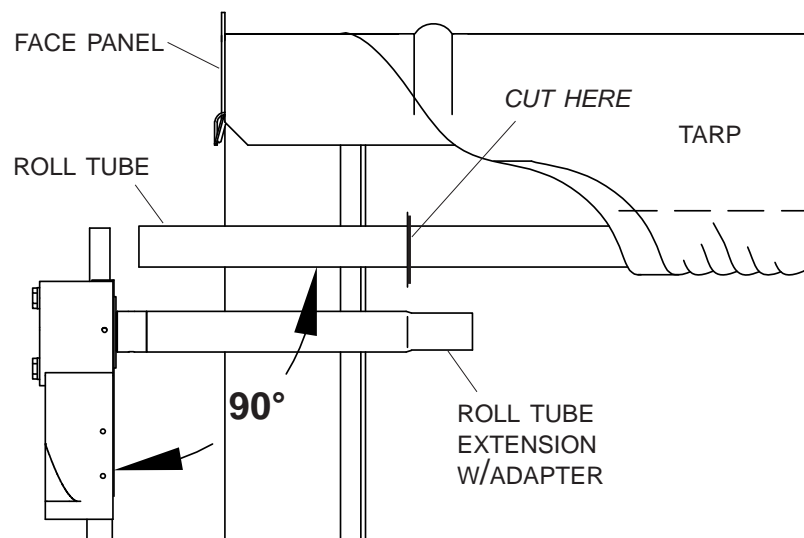

**STEP 7:** Hold swing/slide arms with motor and roll tube extension 90° to roll tube. Mark roll tube and cut at marked location.

**STEP 8:** Unfasten and remove motor from roll tube extension. Insert swaged end of roll tube extension w/drive shaft into roll tube. Align extension straight with roll tube and weld all around. Grind smooth.

**NOTE:** Pull roll tube away from tarp and trailer before welding to protect from weld spatter. Align roll tube extension straight with roll tube before welding so tarp system will roll smoothly.

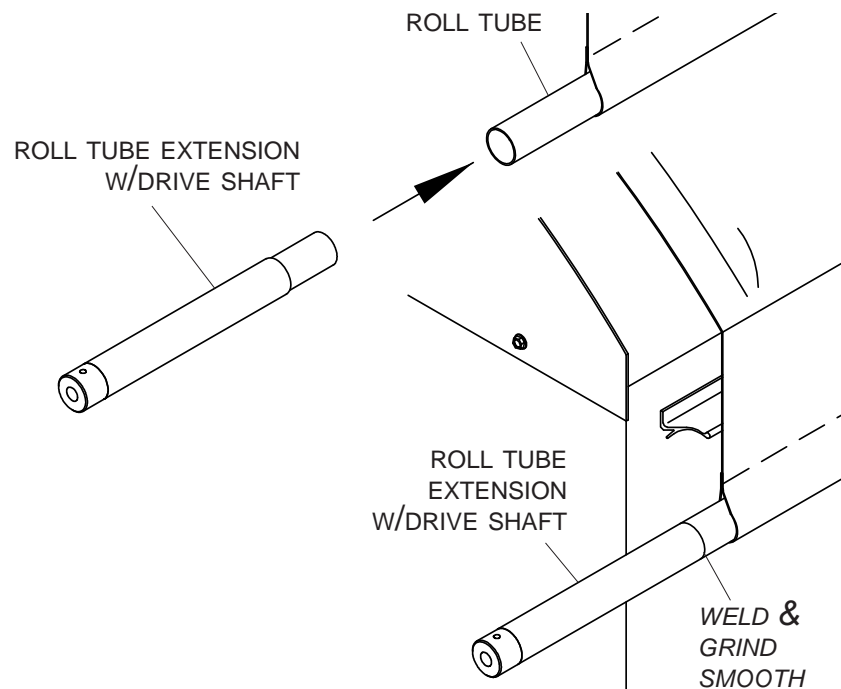

**NOTE:** To prevent rust, paint all exposed metal, such as weld seams and/or metal exposed by grinding or cutting, with corrosion-resistant paint.

**STEP 9:** Slide roll tube extension weldment back into position.

**SHOCK CORD**

**STEP 10:** Open tarp against tarp stops. At rear of box and on square front boxes without obstructions, locate eye bracket in configuration shown at top left. For non-square front boxes, notch latchplate 1" and align eye bracket with edge of notch on latchplate.

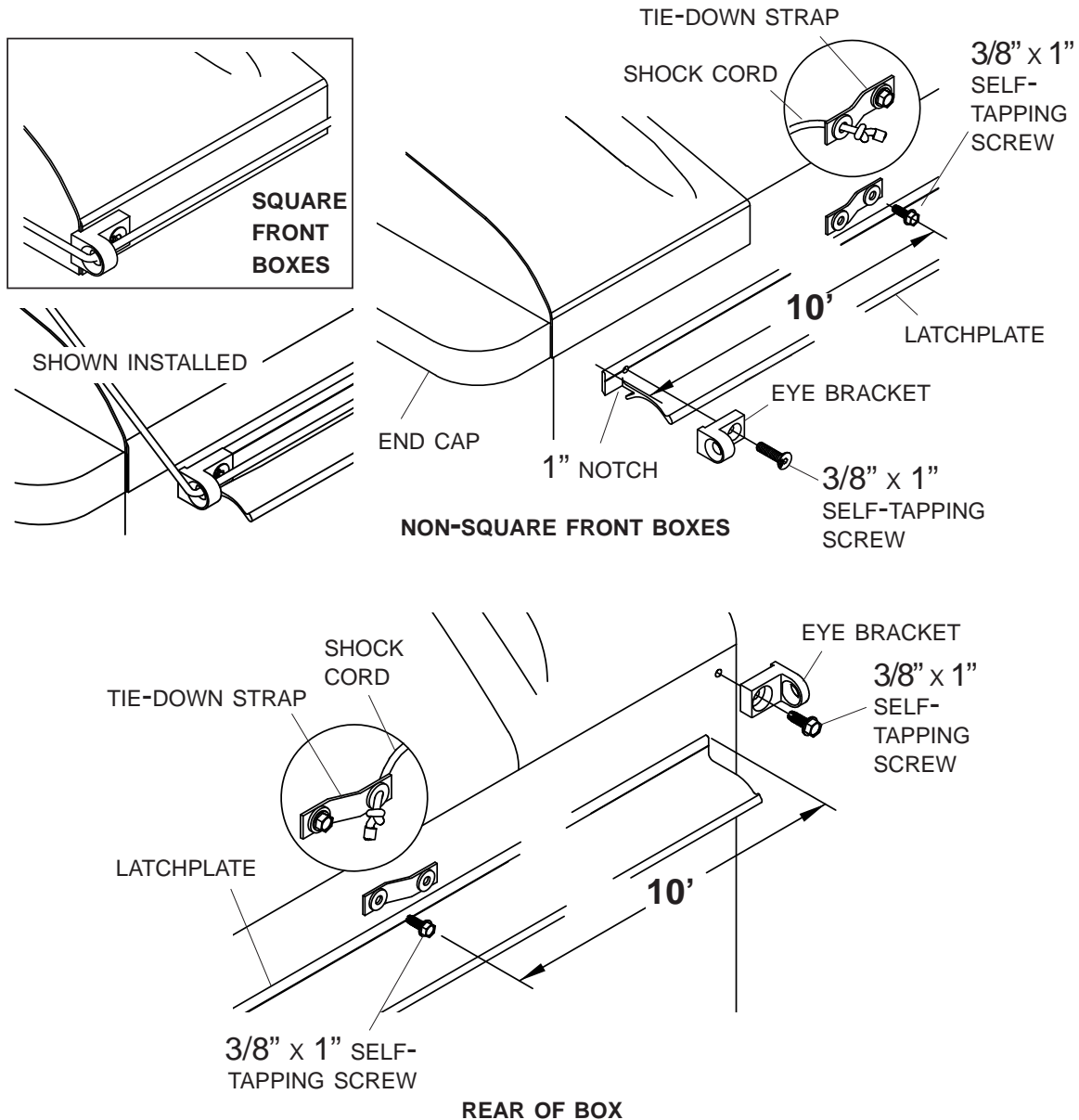

**STEP 11:** Using eye brackets as a guide, mark and drill 5/16" holes in trailer. Fasten brackets to trailer with 3/8" x 1" self-tapping screws.

**STEP 12:** Mount shock cord tie-down straps 10' back from outer edges of latchplate. Drill 5/16" holes and fasten with 3/8" x 1" self-tapping screws.

**STEP 13:** Lead first shock cord through front eye bracket, then through grommet on rear tie-down strap. Lead second shock cord through rear eye bracket, then through front tie-down strap. Tie knots in shock cords at tie-down straps to secure. Trim ends of shock cords and wrap with tape to prevent fraying.

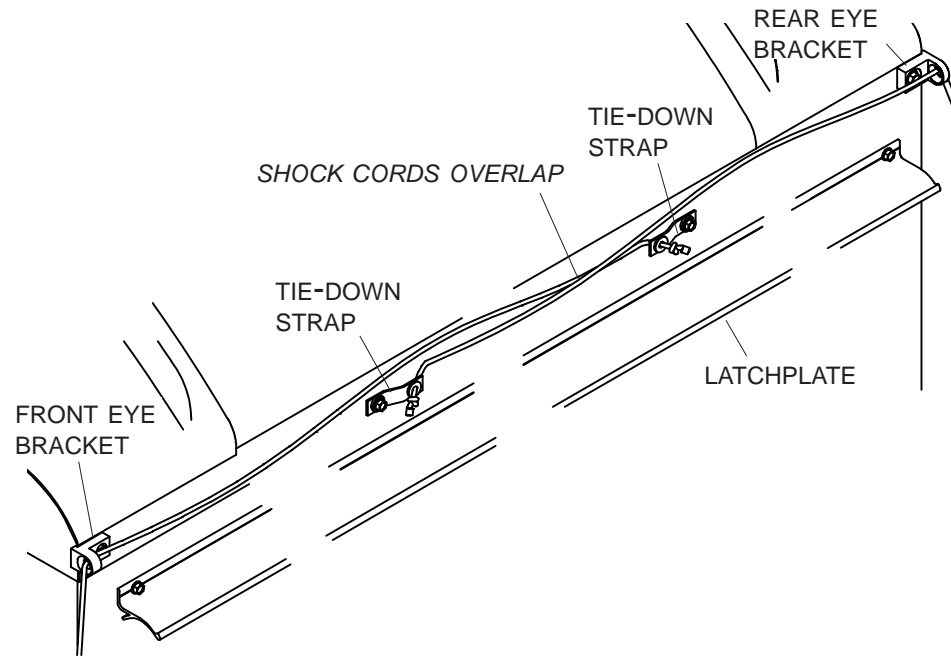

### ROLL TUBE EYES

**STEP 14:** Roll tarp closed and let hang. Slide roll tube eyes and retaining collars onto front and rear of roll tube. Refasten motor to roll tube and re-align swing arm vertically so arm swings freely without interference. When swing arm is aligned and roll tube is in place, secure tarp to roll tube with U-clamps, fastening with 1/4" x 3/4" self-drilling screws.

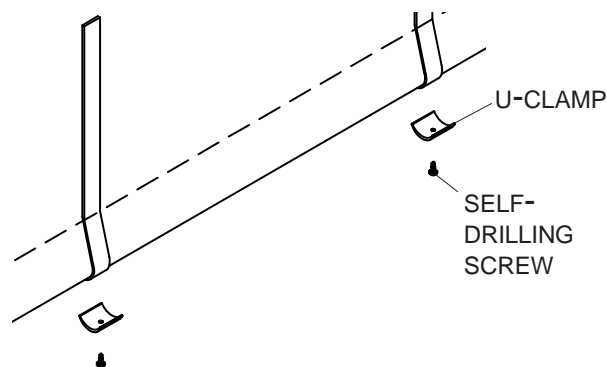

**STEP 15:** Allow shock cords to hang down. Slide roll tube eyes onto each end of roll tube and align eyes approximately 1" from shock cords, toward outside of trailer. Space retaining rings about 1/8" from each side of roll tube eyes. Tighten self-drilling screws to secure retaining rings.

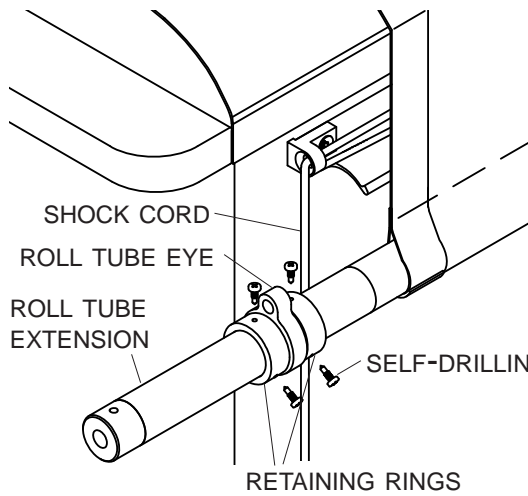

**RADIUS FRONT TRAILER**

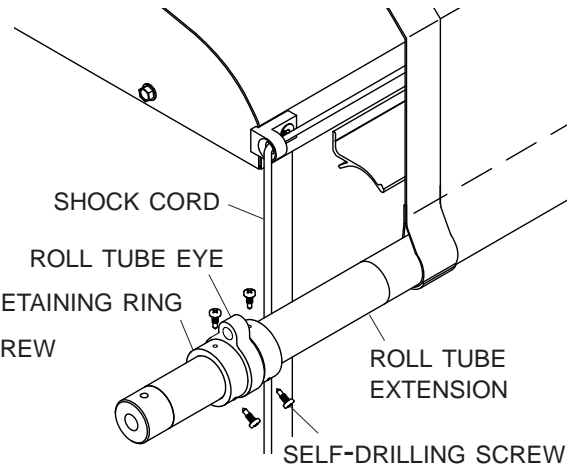

**SQUARE FRONT TRAILER**

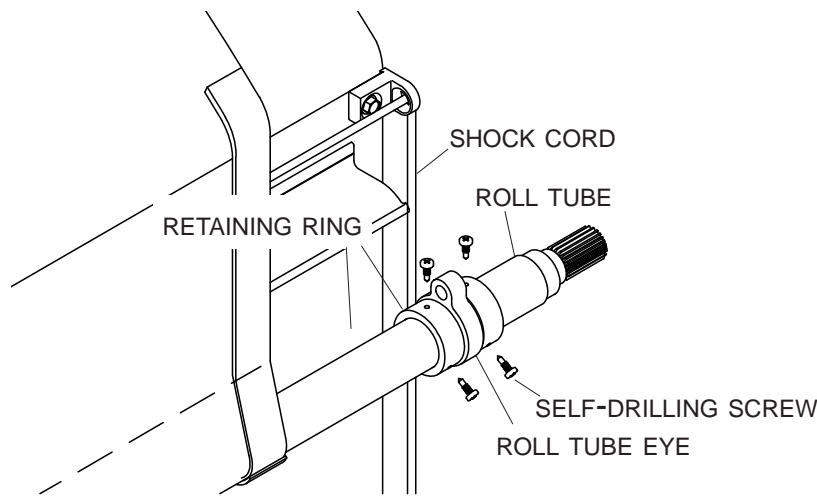

**REAR OF TRAILER**

**STEP 16:** With lower swing arm extending past top of slide arm and motor in the most extended position, drill 5/16" hole in lower swing arm. Install 3/8" x 1" self-tapping screw to secure slide arm. Remove excess length on swing arm, if required, and install end plug.

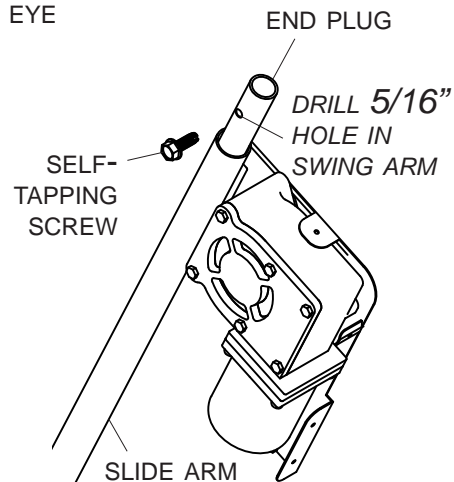

**STEP 17:** Roll tarp closed tight under latchplate and pull shock cords through roll tube eyes to create tension. Tie permanent knots in shock cords at front and rear of roll tube.

**NOTE:** Shock cord must not cross over windshield during operation.

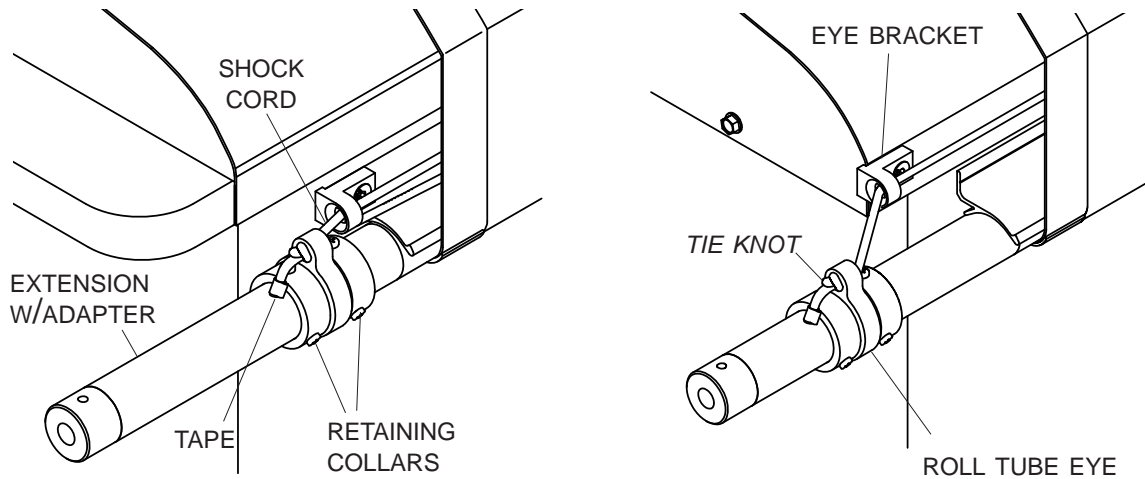

**RADIUS FRONT TRAILER**

**SQUARE FRONT TRAILER**

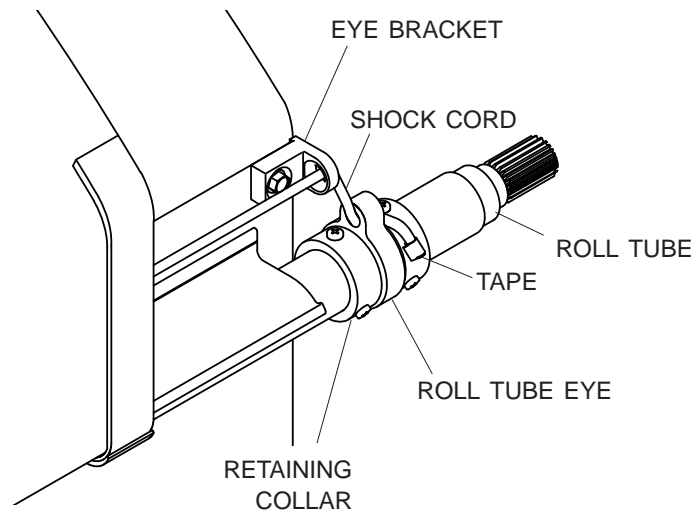

**REAR OF TRAILER**

**STEP 18:** Roll tarp open and closed to make sure roll tube returns correctly. Adjust tension in shock cords as needed. Trim end of shock cord and wrap with tape to prevent fraying.

**ELECTRIC MOUNTING & WIRING**

**STEP 18: Wire routing:** Bring wire up from front of box and loop around 7" standoff, leaving slack in wire. Route wire along lower swing arm, up slide arm and to motor connectors. Secure wire to upper slide arm with nylon cable ties. Leave sufficient slack in wire to allow for movement of swing arm.

**NOTE:** For farm trucks with hoists, run wire to rear of box, around hoist pin and back to front of box (there is no plug connection).

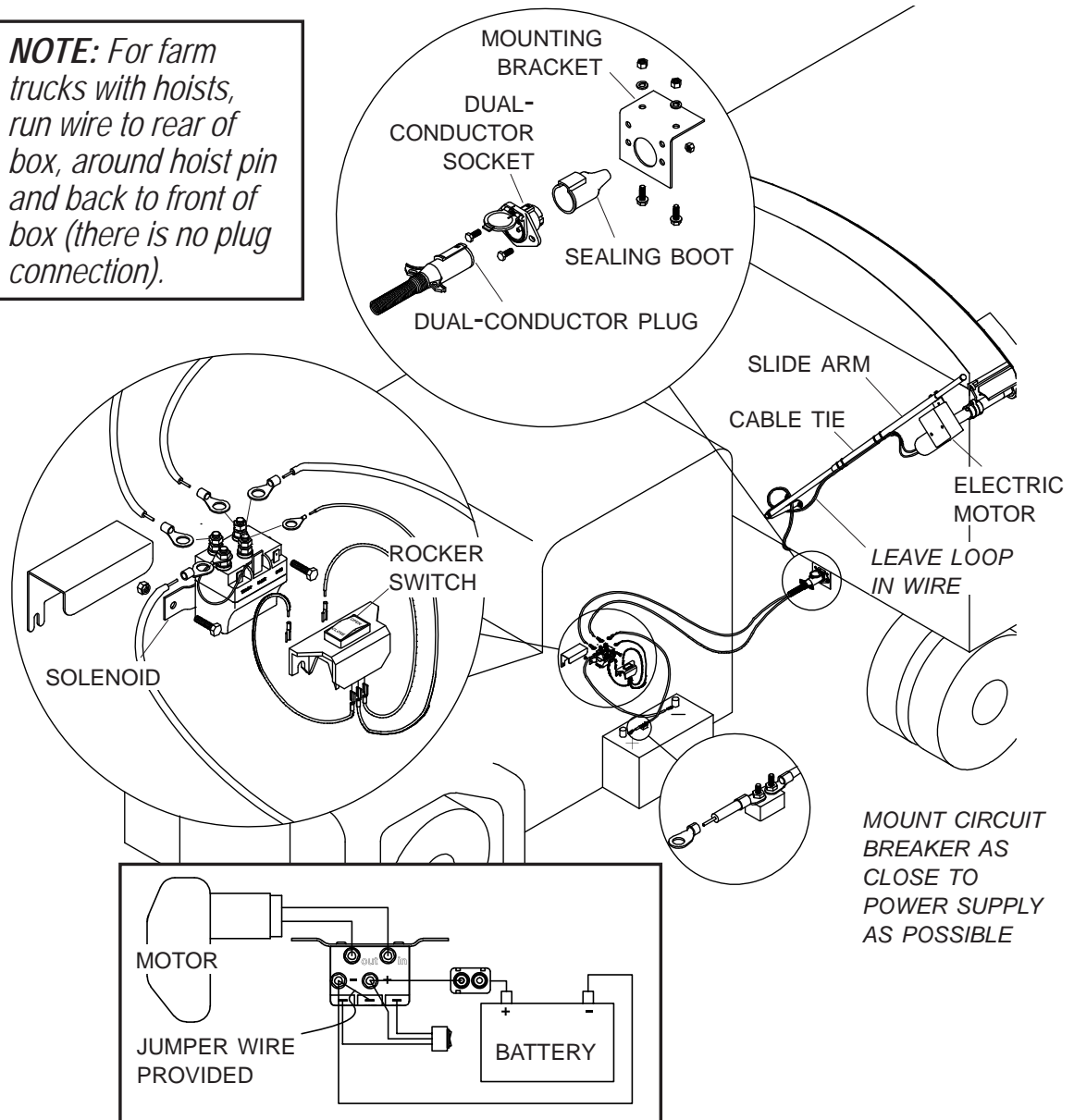

**Mount solenoid:** Mount solenoid in a suitable location - a ventilated area near the battery is ideal. Determine best route for wire. This is usually along the frame with existing wire harness. Run 6-ga. wire from motor to solenoid and from power supply to solenoid as shown in diagram. Run 14-ga. wire from solenoid to switch as shown, and mount switch in area convenient to operator. Mount switch inside or outside cab. Mount with bracket or install directly into dash panels.

**STEP 19: Dual-conductor socket:** Mount dual-conductor socket at suitable location on front of box, usually near existing plugs. Fasten conductor socket to mounting bracket and fasten mounting bracket to box. Slide 6-ga. wire through boot. Connect wire ends to conductor socket. Slide boot up against conductor socket. Secure boot to 6-ga. wire with cable tie.

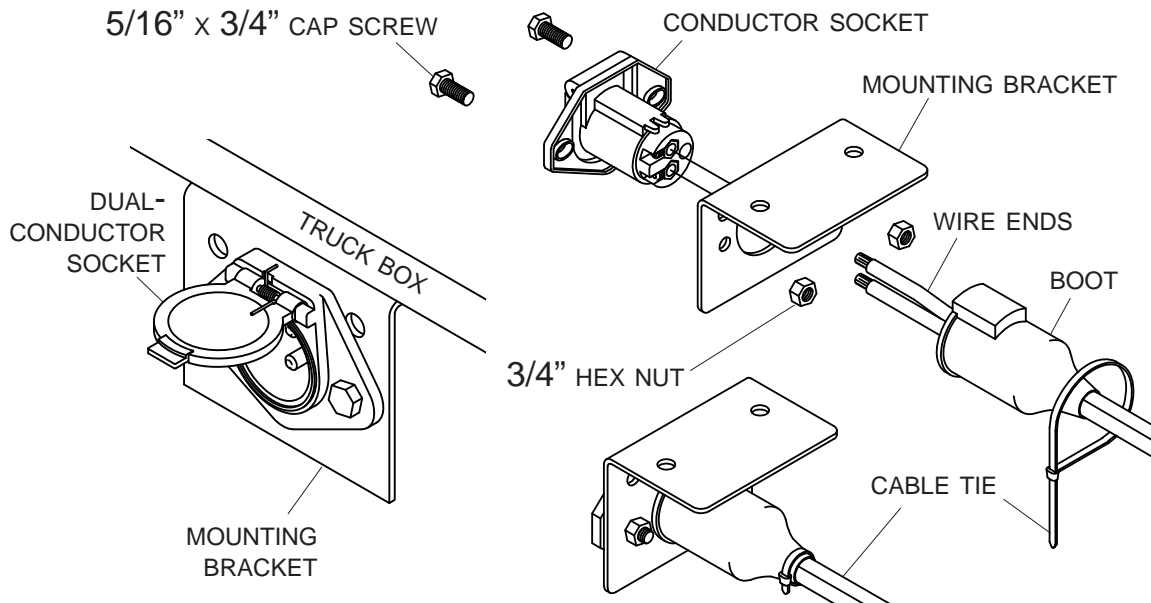

**Dual-conductor plug:** Remove insert from conductor plug. Feed wire through plug and into brass contacts on insert. Tighten set screws to secure wires. Replace insert into conductor plug and replace screws.

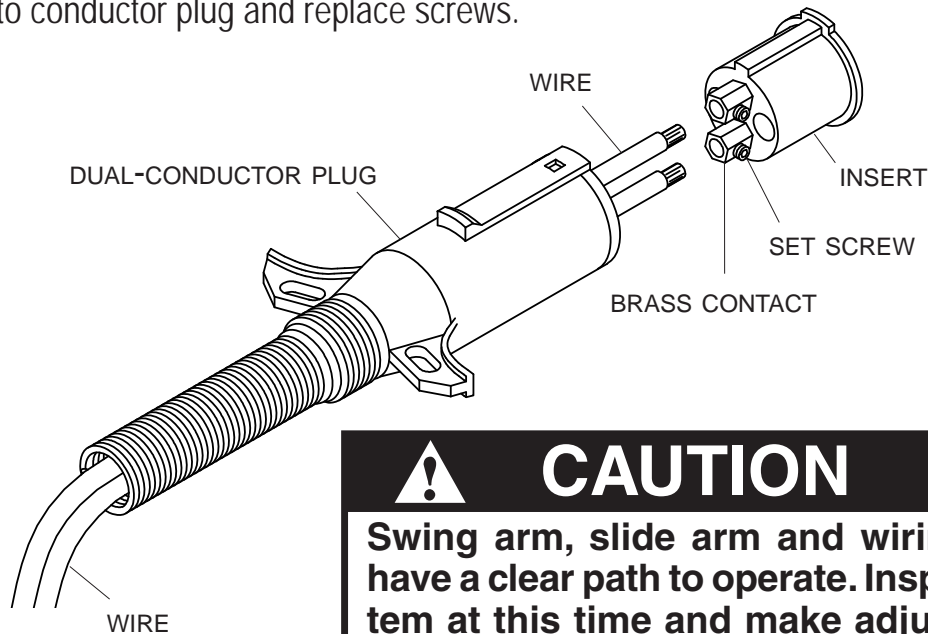

## CAUTION

Swing arm, slide arm and wiring must have a clear path to operate. Inspect system at this time and make adjustments as required.

**STEP 20: Rocker switch:** Locate rocker switch in a convenient operating area. Switch can be mounted inside cab to dashboard, in dash panel, on driver side door jamb or in a convenient location outside the cab.

**STEP 21: Electrical wire:** Cut wires to length and strip only enough wire insulation to install ring terminals. Shrink wrap can be applied to 6-ga. wire connectors. Insert bare wire into ring terminals and crimp securely. Slide shrink wrap over entire connection and apply heat to seal.

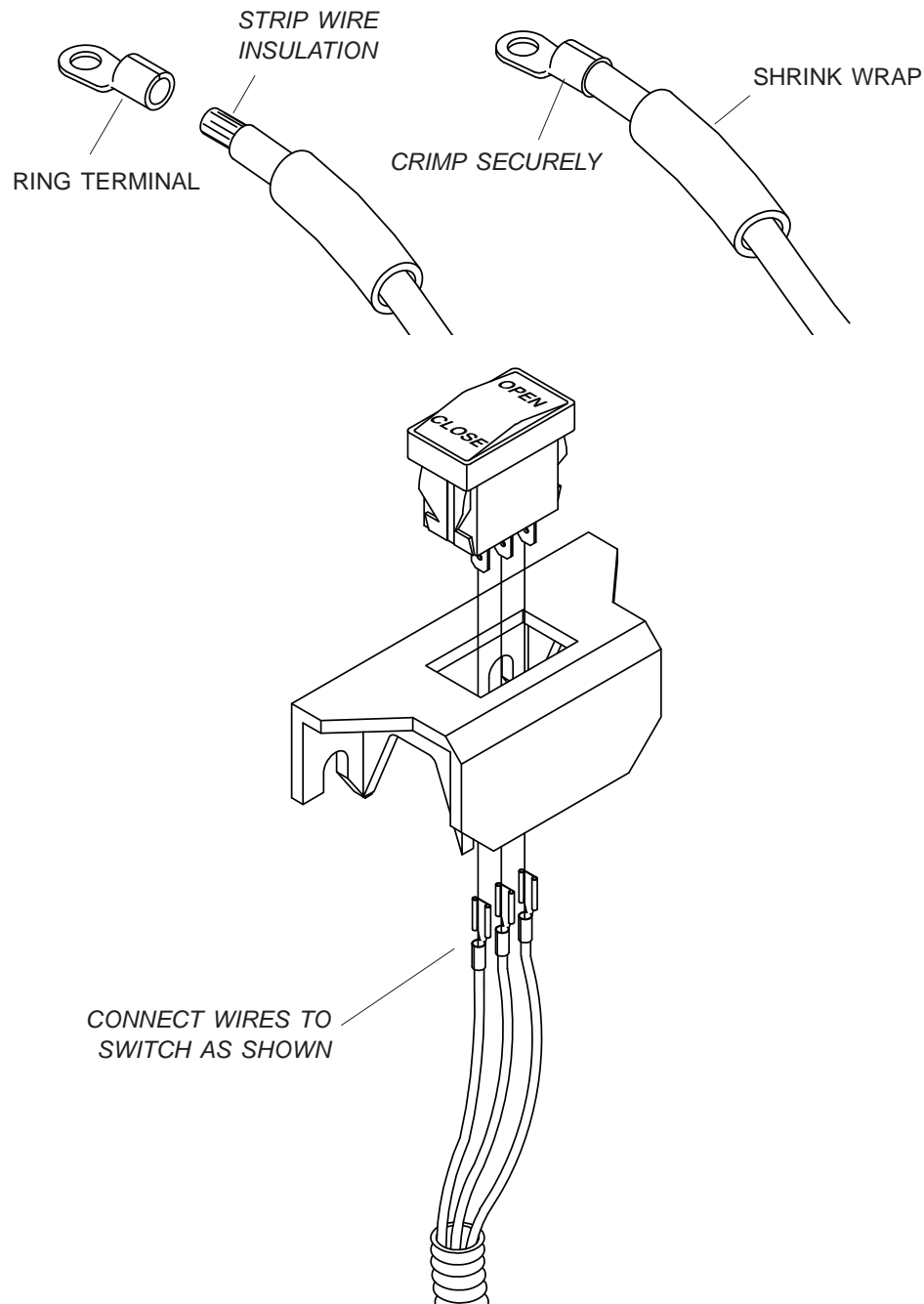

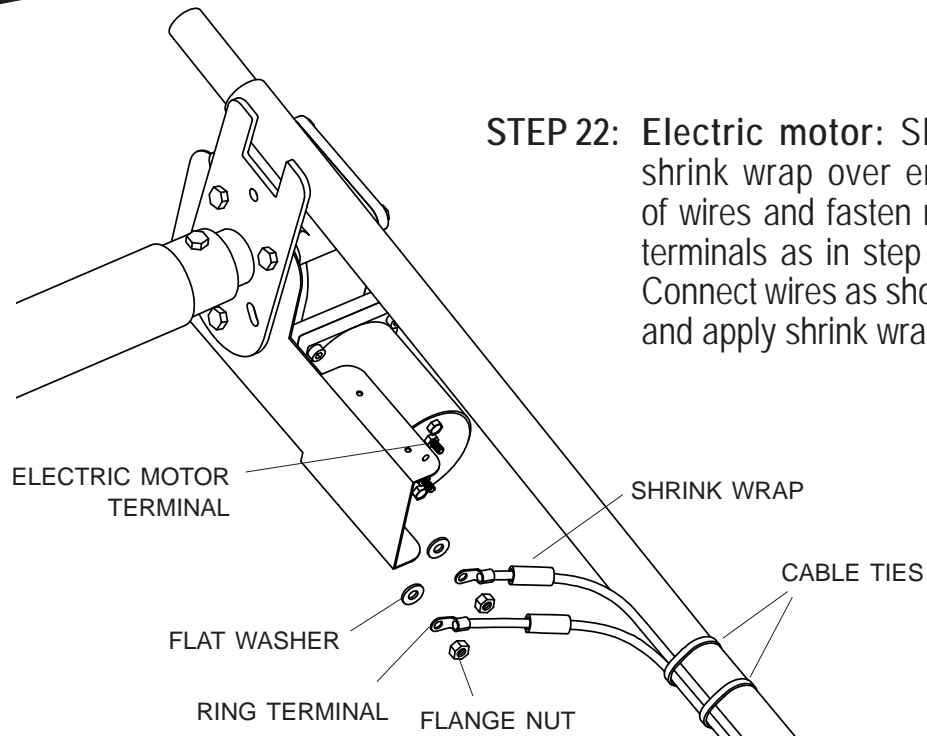

**STEP 22: Electric motor:** Slide shrink wrap over ends of wires and fasten ring terminals as in step 11. Connect wires as shown and apply shrink wrap.

Check motor direction by activating switch to "OPEN." If switch is running system backwards, change wire leads on motor to opposite connections.

Push shrink wrap over connections and apply heat to seal. Fasten motor cover to motor with screws supplied.

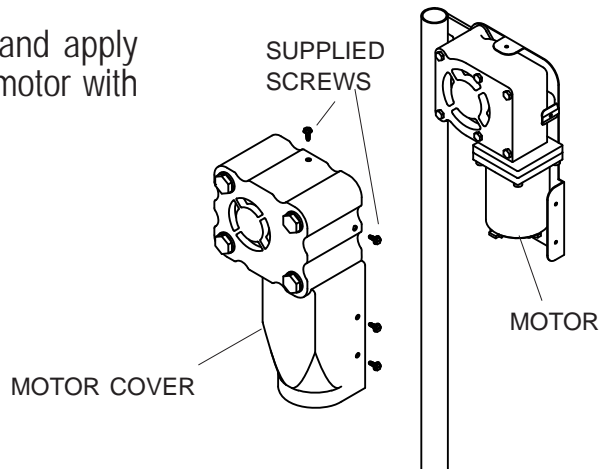

## OPERATION

**Close tarp:** Push switch to "CLOSE" and hold. Observe tarp and release switch when tarp is fully closed.

**Open tarp:** Push switch to "OPEN" and hold. Observe tarp and release switch when tarp is fully opened.

**NOTE:** Release switch at end of cycle or automatic circuit breaker will trip. After breaker resets, switch will activate motor again. To reduce unnecessary strain on tarp components, release switch at end of each cycle.



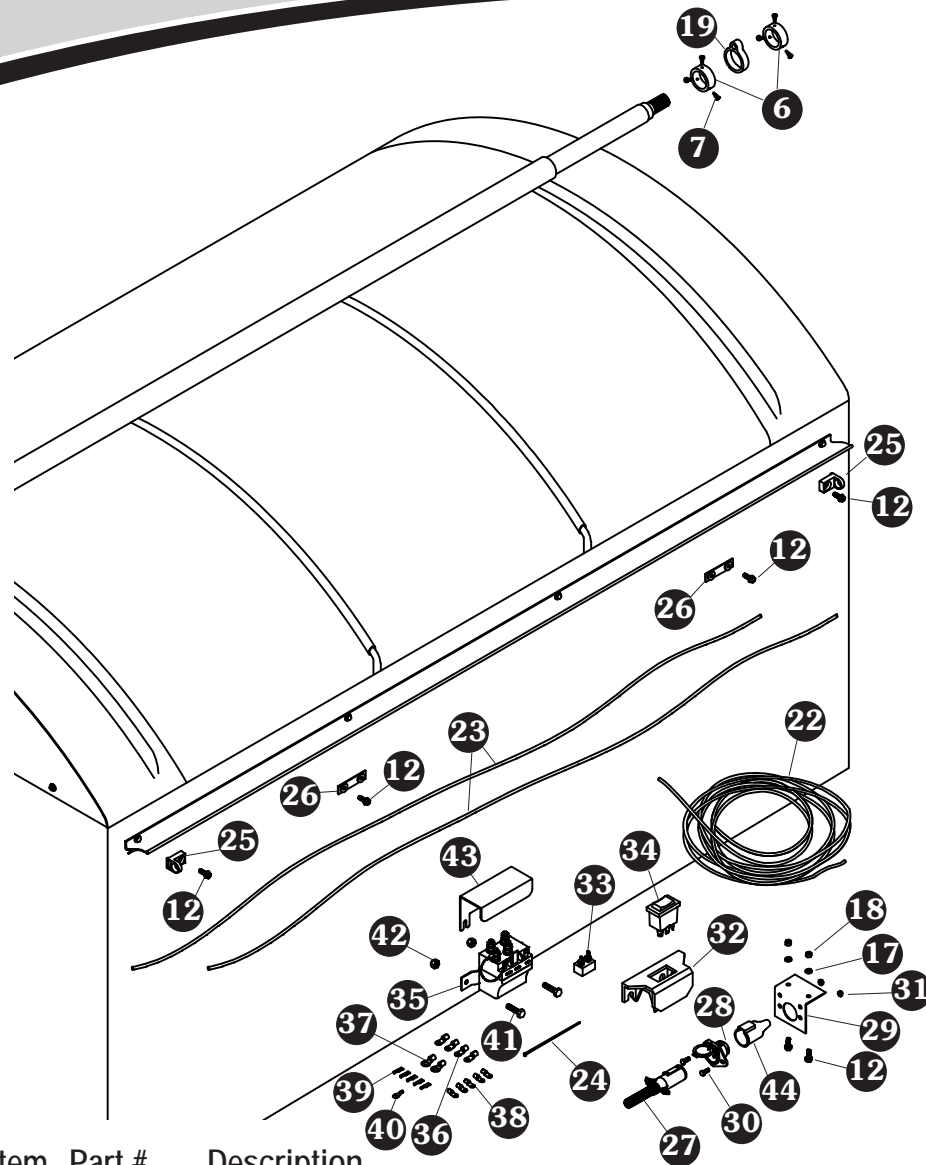

Item	Part #	Description	Item	Part #	Description
22.	1110312	Dual Conductor 6-Ga. Wire - 50'			
	1108102	Dual Conductor 6-Ga. Wire - 75'			
	1116482	Electrical Wire 14-Ga. Lead - 15'			
23.	1100169	Shock Cord - 138"	39.	1703659	Push-On Terminal - 14 Ga. - 1/4" - Switch/Solenoid
24.	1703231	Cable Tie - 8"	40.	1703660	Ring Terminal - 14 Ga. x 5/16 Stud - Solenoid
25.	1703445	Shock Cord Eye Bracket	41.	1700381	Cap Screw - 1/4" x 1"
26.	1114948	Shock Cord Tie-Down Strap	42.	1701543	Nylon Lock Nut - 1/4"
27.	1115385	Heavy-Duty Dual-Conductor Plug	43.	1703896	Solenoid Cover
28.	1115386	Heavy-Duty Dual-Conductor Socket	44.	1704573	Conductor Socket Sealed Boot
29.	1109015	Mounting Bracket - Conductor Plug	45.	1700398	Self-Drilling Screw - 1/4" x 3/4" (not shown)
30.	1701045	Cap Screw - 5/16" x 3/4"			
31.	1700411	Hex Nut - 5/16"			
32.	1703661	Rocker Switch Mounting Bracket			
33.	1704354	40-Amp Modified-Reset Circuit Breaker			
34.	1116020	Rocker Switch			
35.	1703845	Motor Reversing Solenoid			
36.	1703245	Ring Terminal - 6 Ga. x #10 Stud - Motor Breaker			
37.	1703244	Ring Terminal - 6 Ga. x 3/8 Stud - Battery			
38.	1702707	Ring Terminal - 6 Ga. x 1/4" - Motor/Solenoid			



