

STEP 1 - Locate and drill holes.

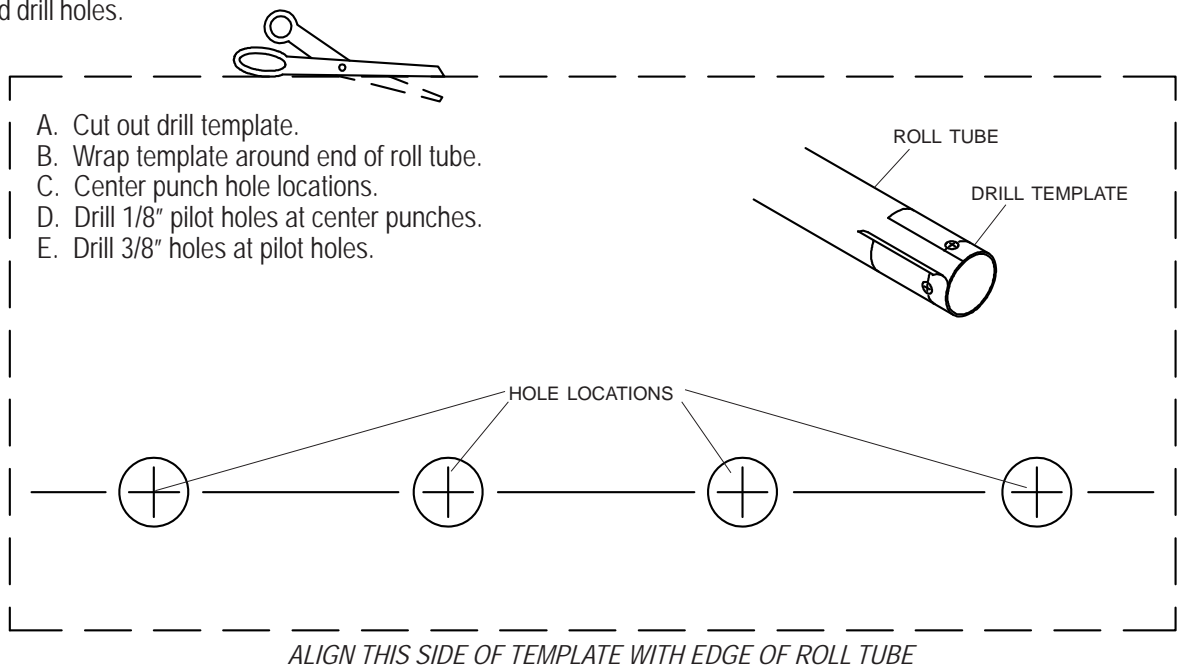

STEP 2 - Assemble and weld.

A. Insert Wil-Slip™ joint into end of roll tube, aligning dimples in cast housing with holes in roll tube.

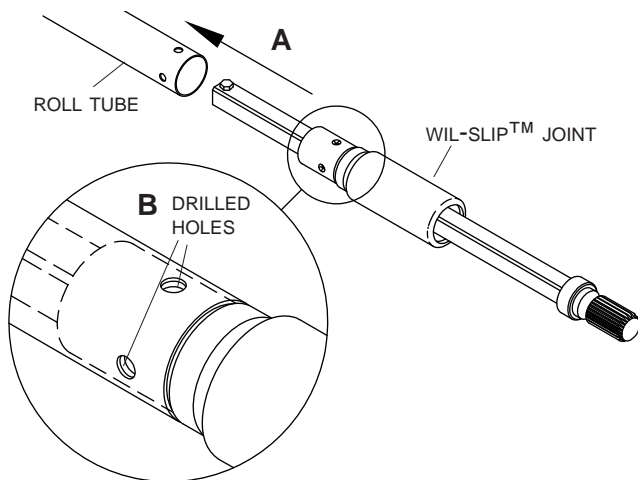

B. Weld into drilled holes, filling holes with weld until flush with roll tube.

NOTE: Weld into drilled holes one at a time, allowing part to cool between welds. Excessive heat could damage plastic bushing.

**WELD INTO DRILLED HOLES ONLY.
 DO NOT WELD AROUND ROLL TUBE.**

STEP 3 - Install U-clamps after installing tarp.

A. Fasten tarp to roll tube with U-clamps and 1/4" x 3/4" self-drilling screws (see Owner's Manual).

B. To prevent interference with Wil-Slip™ joint, remove screw at end of roll tube. Grind end to shorten and replace.

