

Item	Part #	Description
	1118337	Hopper Parts Kit - Dakota
1.	1118305	Bearing Retainer - Dakota
2.	1700400	Self-Tapping Screw - 3/8" x 1"
3.	1700434	Lock Washer - 3/8"
4.	1700407	Hex Nut - 3/8"
5.	1118306	Door Stop - Dakota

**NOTICE:** Door stop components must be installed before completing the Wiring section of Owner's Manual P/N 1121006.

## ⚠ WARNING

Disconnect power before installation. Failure to do so may result in serious injury, death, or equipment damage.

Refer to the owner's manual for additional safety procedures.

## ⚠ CAUTION

Keep hands and fingers clear of moving parts when installing door stops. Pinch points may cause injury.

### DOOR STOP

**STEP 1:** Remove existing door stop located on bottom side of hopper door. Replace with door stop provided in kit.

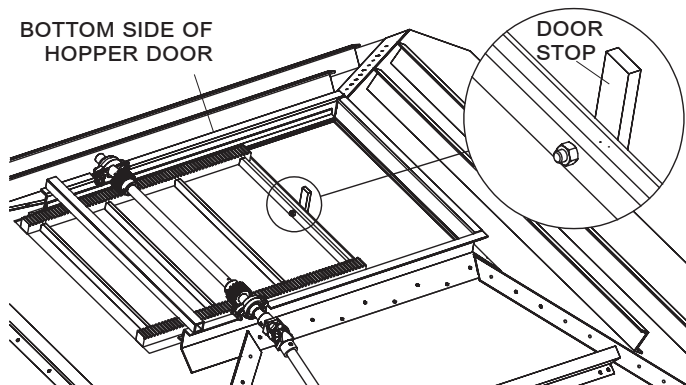

### BEARING RETAINER

**NOTICE:** Install bearing retainer if more than 1/8" clearance exists between teeth of pinion and rack. Retainer is used to maintain engagement between the rack and pinion on the bottom of the hopper door.

**STEP 1:** Remove bearings and pinion shaft. With a die grinder or small jig saw, elongate holes in hopper rail to allow pinion shaft to fully engage into rack on hopper door.

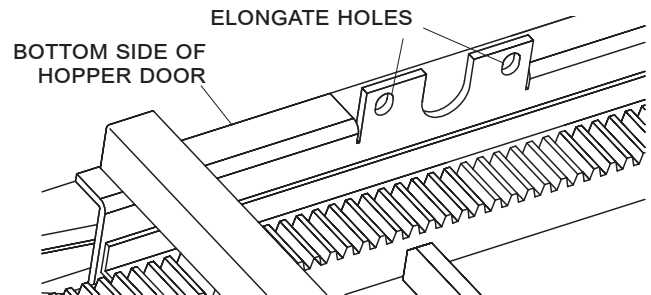

**STEP 2:** Re-install pinion shaft, placing bearing retainers on inside of hopper rails.

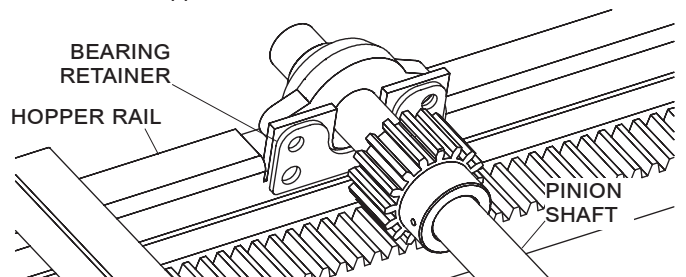

Continue instructions on reverse side.

**BEARING RETAINER** *Continued*

**STEP 3:** Push pinion shaft up into bearing retainers as far as possible and tighten bearing bolts.

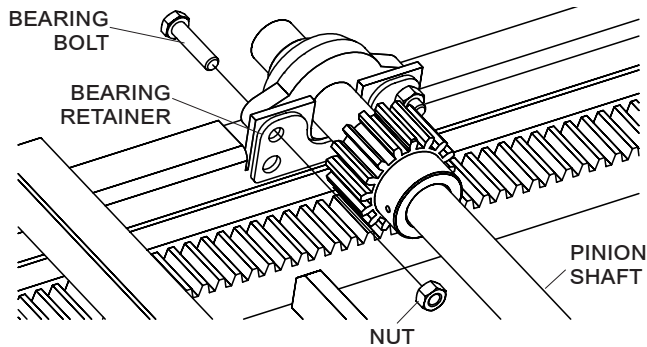

**STEP 4:** Drill two 5/16" holes through upper holes in bearing retainer plates and fasten with **self-tapping screws (2)**, **lock washers (3)**, and **nuts (4)**.

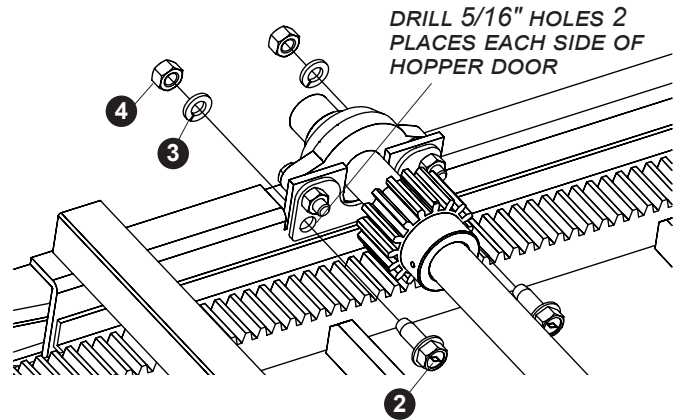

**STEP 5:** Repeat instructions on opposite side of hopper door.