

Installation Instructions - Hinge Bracket Mount to Rail

Trailer Makes: Merritt, Jet, Cornhusker

P/N 1118561 Rev. F

Item	Part #	Description
1.	1118568	Shim Insulator - Rail Mount
2.	1118526	Hinge Bracket - Rail Mount
	1121929	Hinge Bracket - Extended Rail Mount
3.	1700400	Self-Tapping Screw - 3/8" x 1"
4.	1700429	Flat Washer - 3/8"
5.	1700434	Lock Washer - 3/8"
6.	1700407	Hex Nut - 3/8"

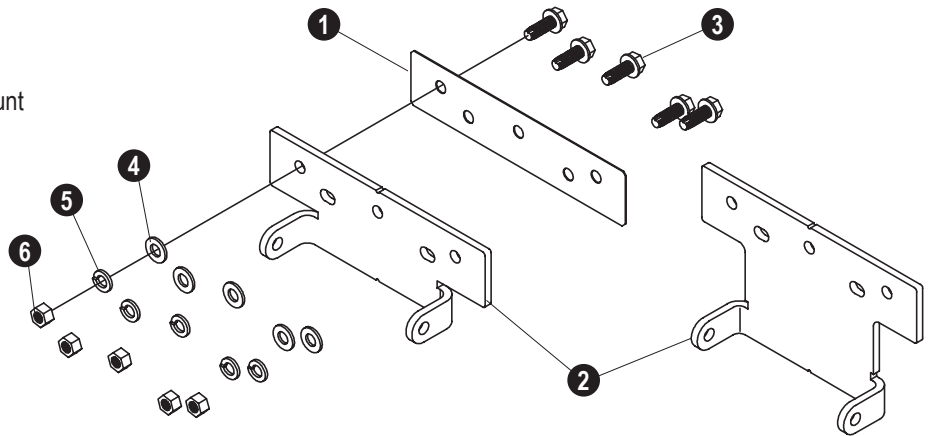

NOTICE: Refer to the ProTrap® Owner's Manual (P/N 1121006) for complete ProTrap installation instructions.

WARNING

Disconnect power before installation. Failure to do so may result in serious injury, death, or equipment damage.

Refer to the owner's manual for additional safety procedures.

MERRITT TRAILER

STEP 1: Align holes in **hinge bracket (2)** with three existing holes in trailer rail as shown. Fasten **shim insulator (1)** and **bracket (2)** to rail with **self-tapping screws (3)**, **flat washers (4)**, **lock washers (5)**, and **nuts (6)**.

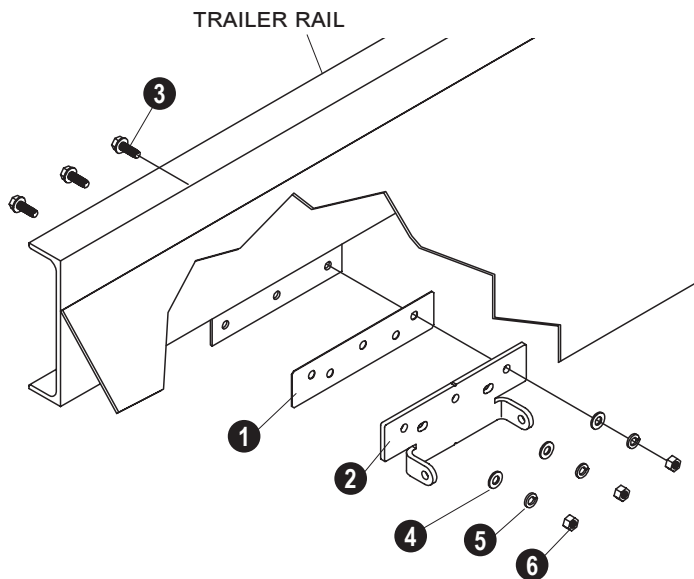

Continue instructions on reverse side.

JET ALUMINUM TRAILER

STEP 1: Align **hinge bracket (2)** with two existing holes in trailer rail. Using **hinge bracket (2)** as a guide, mark and drill three more 5/16" holes in rail. Fasten **shim insulator (1)** and bracket to rail with **self-tapping screws (3)**, **flat washers (4)**, **lock washers (5)** and **nuts (6)**.

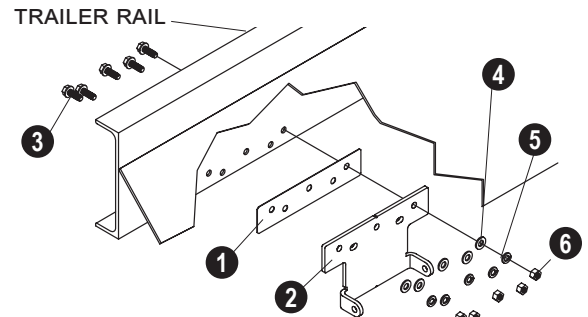

Continue instructions on reverse side.

JET STEEL TRAILER

STEP 1: Cut existing bracket on trailer leaving 2-1/2" remaining. Align hinge bracket with 2-1/2" bracket. Using **hinge bracket (2)** as a guide, mark and drill five 5/16-inch holes. Fasten **shim insulator (1)** and **bracket (2)** to trailer with **self-tapping screws (3)**, **flat washers (4)**, **lock washers (5)** and **nuts (6)**.

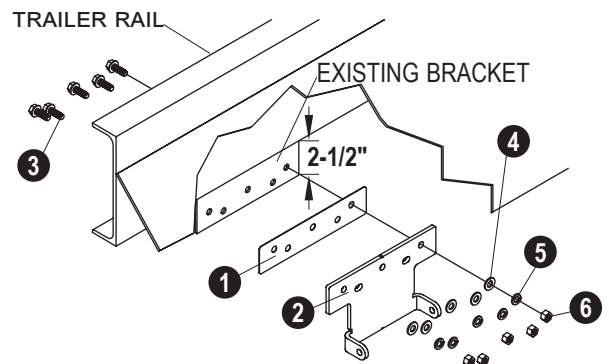

Continue instructions on reverse side.

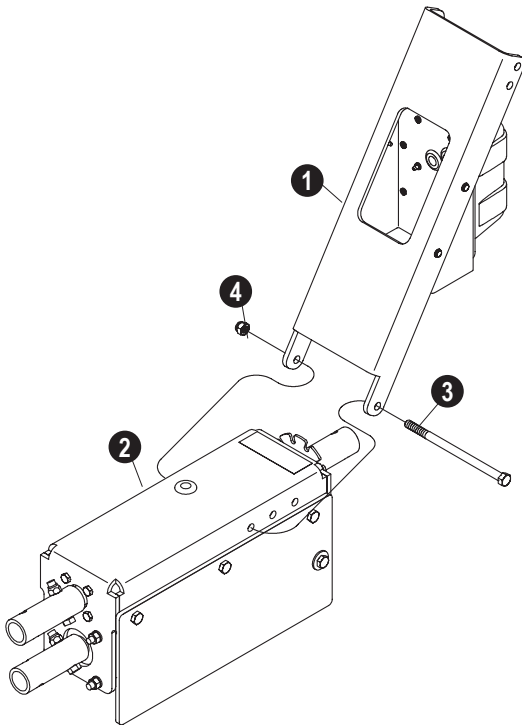

Item	Part #	Description
1.		Intermediate Bracket Assembly - Rail Mount
2.		ProTrap Assembly
3.	1702904	Cap Screw - 3/8" x 1 1/8"
4.	1701580	Nylon Lock Nut - 3/8"

ALL TRAILER MAKES

STEP 2: Align the **bracket assembly (1)** with the **ProTrap (2)** as shown above. Insert **cap screw (3)** through the bracket and ProTrap, and secure with **nut (4)**.

NOTICE: Continue ProTrap® installation with the Motor Assembly section of the Owner's Manual (P/N 1121006).