

Item	Part #	Description
1.	1116482	Electrical Wire - 14 Ga. 3 Lead x 15'
2.	1703661	Rocker Switch Mounting Bracket *
3.	1116020	Rocker Switch - SPDT *
4.	1704153	Ring Terminal - 14 Ga. x 1/4" Stud
5.	1703659	Female QDisc - 14 Ga. Push-On 1/4" Terminal
6.	1704518	Female QDisc - 14 Ga. x 1/4" Piggy Back
7.	1704517	Rubber Grommet - 3/8" x 11/16"

* Not included in Value Series Remote upgrade kits.

STEP 1: Disconnect positive wire from battery. Unfasten and remove solenoid cover from solenoid/bracket assembly.

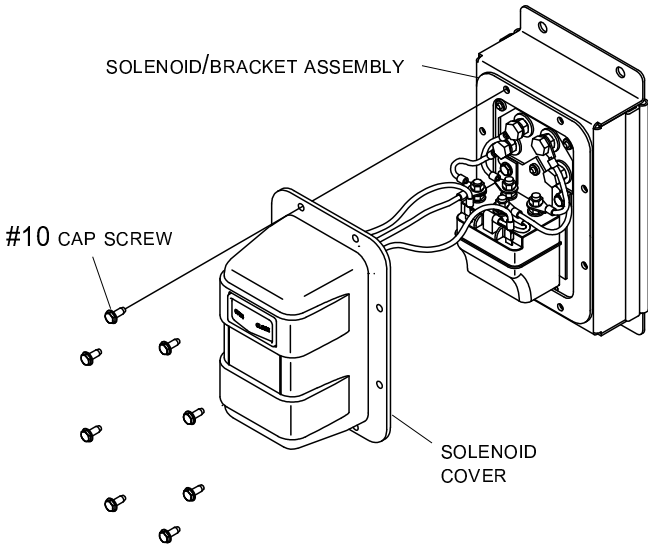

STEP 2: Drill 1/2" hole at pilot hole in modular control bracket. Install rubber grommet around hole.

NOTE: Modular control bracket is shown unassembled for clarity. Unfasten one screw and rotate solenoid out of the way, if needed.

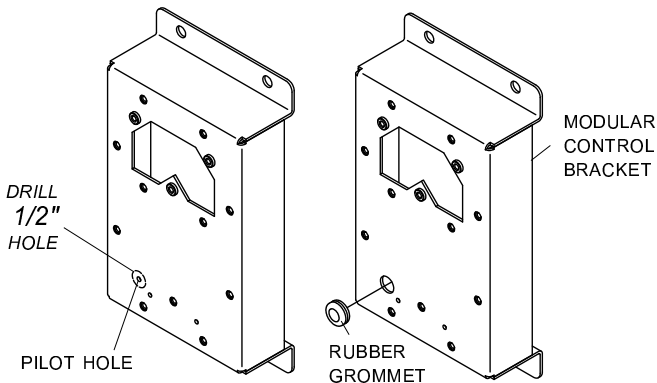

STEP 3: Cut and strip wire ends of electric wire 1. On one end of wire, crimp push-on female disconnects 5 onto all three wire ends and connect to rocker switch 3.

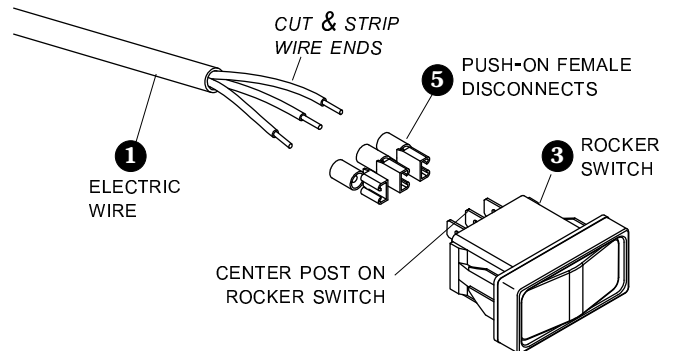

STEP 4: On opposite end of electric wire 1, crimp ring terminal 4 to wire, connected to center post on rocker switch 3. Crimp piggyback quick disconnects 6 to remaining two wire ends.

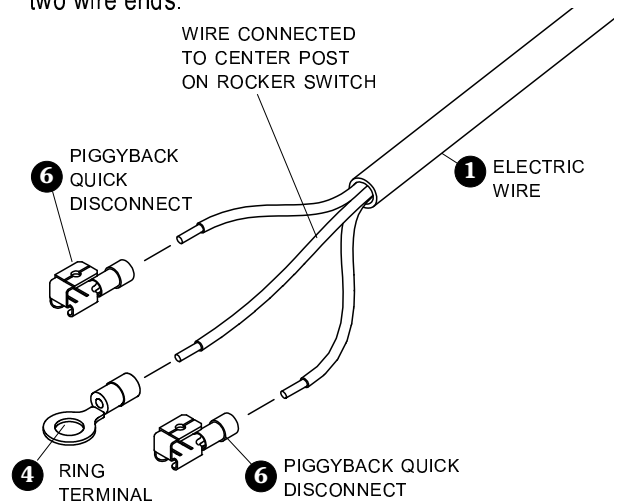

STEP 5: Route wire ends through grommet 7 as shown.

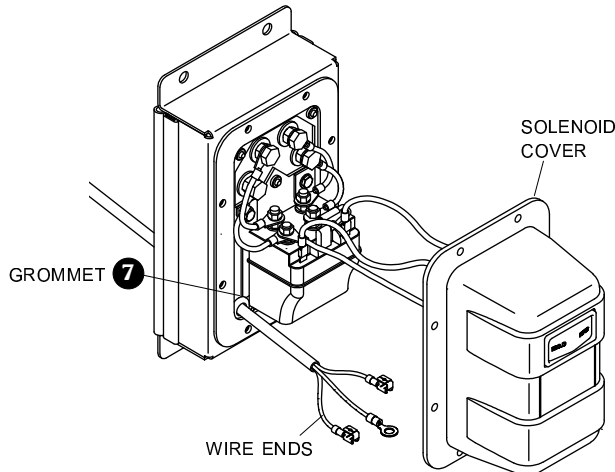

STEP 6: Remove washers and nut from negative post on solenoid and place ring terminal 4 over post. Re-fasten washers and nut over ring terminal on negative post.

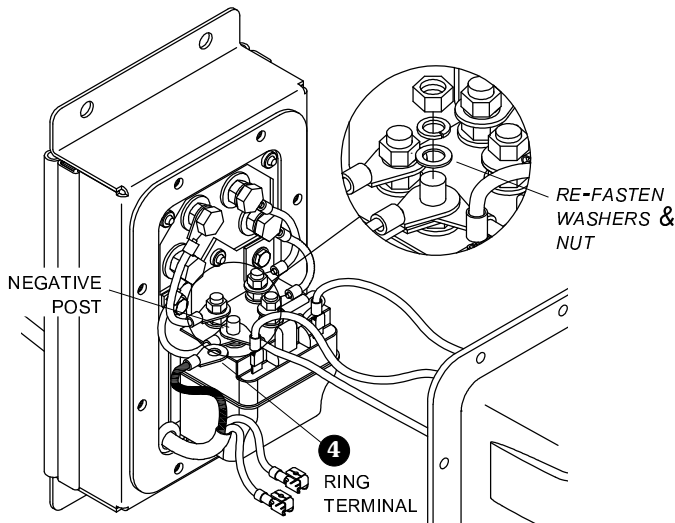

STEP 7: Remove female quick disconnect 5 from left male spade connector on solenoid. Press piggyback quick disconnect 6 onto left male spade on solenoid.

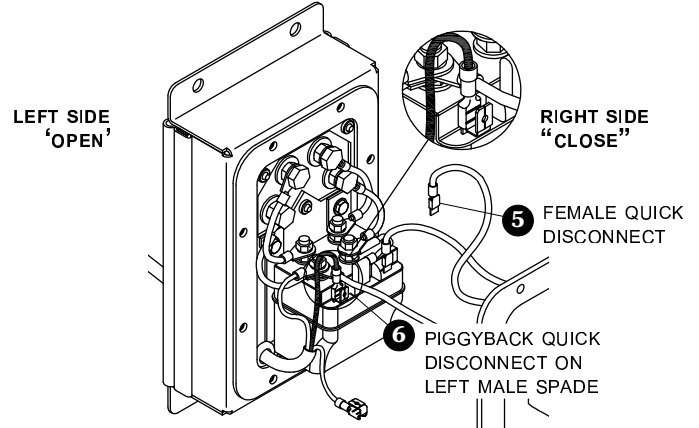

NOTE: Left male spade connector on solenoid connects to "Open" side of rocker switch on solenoid cover. Right male spade connector connects to "Close" side of switch.

STEP 8: Replace female quick disconnect 5 onto piggyback quick disconnect 6.

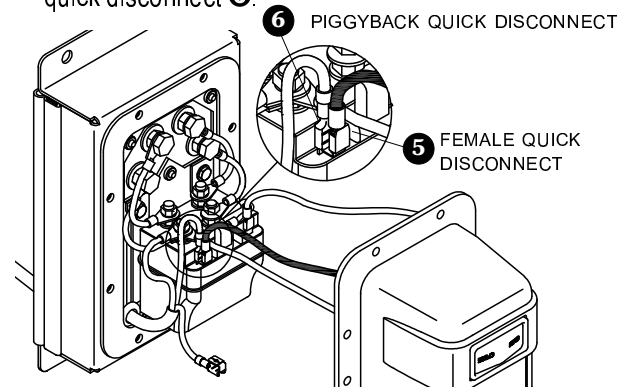

STEP 9: Repeat steps 7 and 8 on male spade connector on right side of solenoid. Re-connect power to battery.

STEP 10: Cycle both switches to verify operation as labeled.

STEP 11: Replace cover.

TROUBLESHOOTING TIPS

Problem:

Try This:

Tarp closes when "Open" button is pressed on both rocker switches. Tarp opens when "Close" button is pressed on both rocker switches.	On the solenoid, switch two piggyback quick disconnects from one male spade to the other.
Cab rocker switch works correctly, but rocker switch on solenoid cover works backwards (tarp opens when "Close" is pressed).	Remove and switch two female quick disconnects from one piggyback quick disconnect to the other.
Rocker switch on solenoid cover works correctly, but cab rocker switch works backwards (tarp opens when "Close" is pressed).	Remove and switch two female quick disconnects from one piggyback quick disconnect to the other. Then remove and switch two piggyback quick disconnects from one male spade to the other.

Our **Advanced Troubleshooting Guide** is available on our website: <http://www.shurco.com>, or call our Help Line: 1-866-748-7435.

