

# Installation Instructions - 6-Hole Sealed Junction Box w/Breaker

P/N 1119742 Rev. D

Item	Part #	Description
	1119437	Junction Box Kit w/Breaker- ProTrap® 150- 6 Hole
	1119436	Junction Box Kit w/Breaker- ProTrap® 250- 6 Hole
1.	1119364	Junction Box Back Plate
2.	1119435	Junction Box w/Breaker- 6 Hole
3.	1119438	Junction Box Mtg Plate
4.	1702653	Machine Screw Nut w/Washer
5.	1704308	Flange Hd Cap Screw - #10 x 1/2"
6.	1700381	Cap Screw - 1/4" x 1"
7.	1700398	Self-Drilling Screw - 1/4" x 3/4"
8.	1704556	Rubber Grommet
9.	1702707	Ring Terminal - 6 Ga. x 1/4" Stud
10.	1703245	Ring Terminal - 6 Ga. x #10 Stud
11.	1700436	Lock Washer - 1/4"
12.	1700408	Hex Nut - 1/4"
13.	1704563	30-Amp Manual Reset Circuit Breaker - ProTrap® 150
	1704557	35-Amp Manual Reset Circuit Breaker - ProTrap® 250
14.	1704555	Gasket for Circuit Breaker

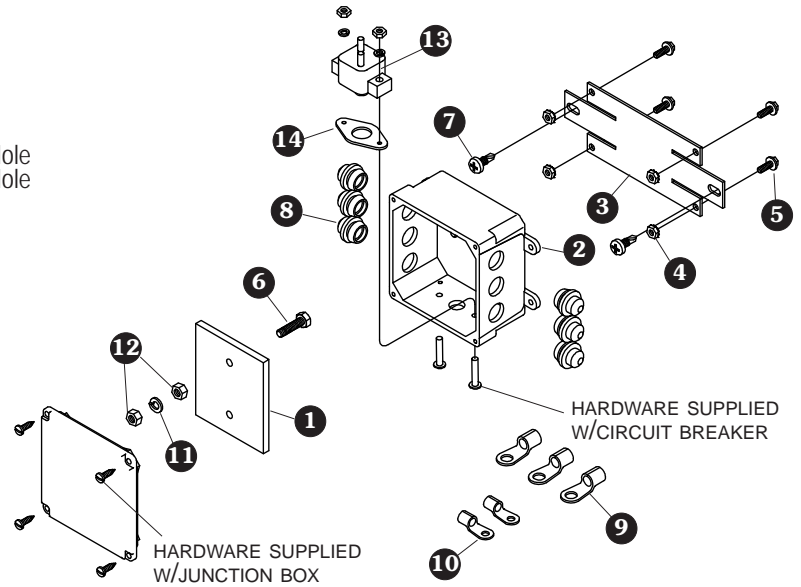

*Routing wires through the sealed junction box greatly reduces corrosion on wire connections. Used with the 3500 Series and ProTrap® systems.*

**NOTE:** Use junction boxes on trailers with two or more hoppers.

**STEP 1:** Insert 1/4" X 1" cap screw through top hole in back plate and secure with nut.

**NOTE:** Place back plate into junction box before installing circuit breaker.

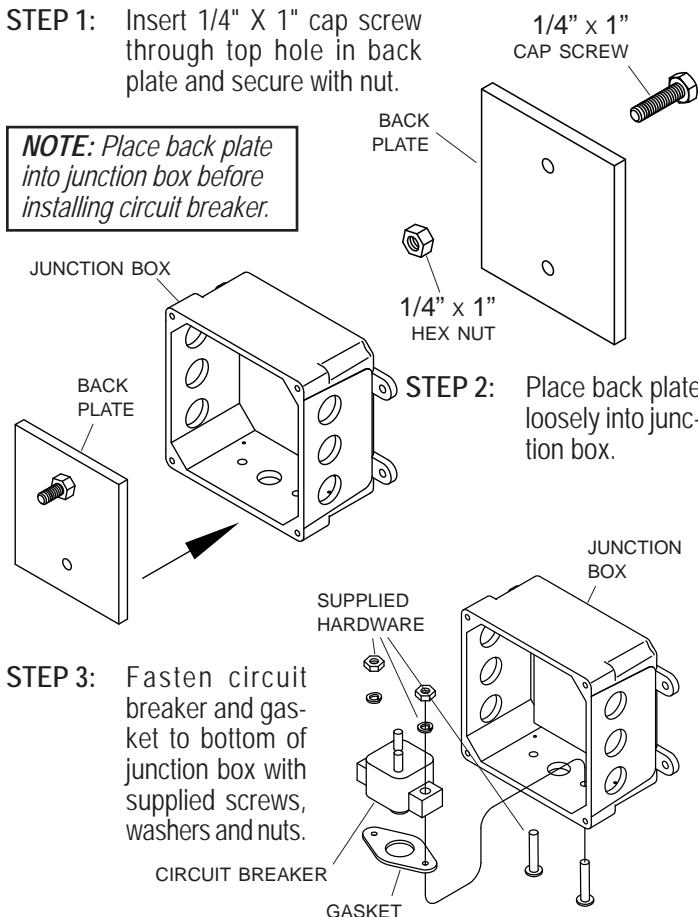

**STEP 4:** Fasten mounting plate to junction box with #10 X 1/2" cap screws and nut/washers.

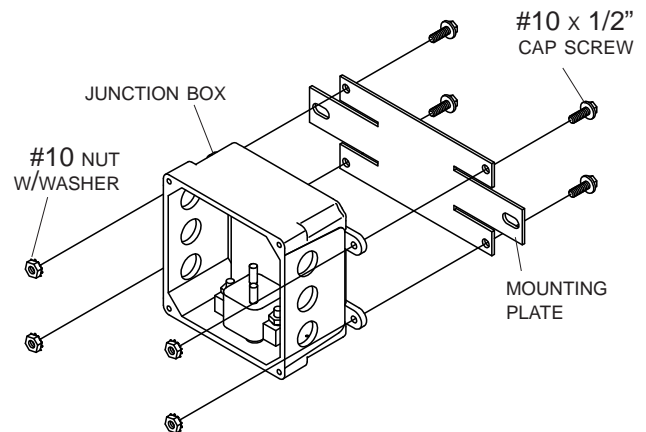

**STEP 5:** Install rubber grommets into holes in junction box.

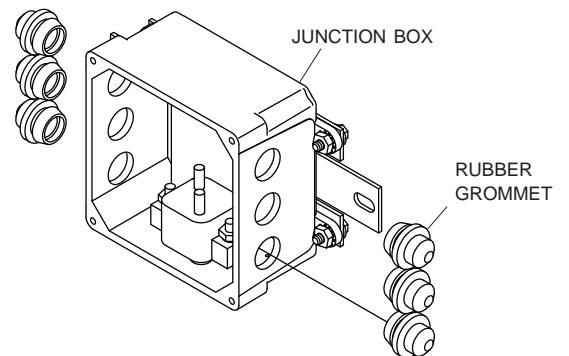

PO BOX 713 ■ 2309 SHUR-LOK STREET  
YANKTON, SOUTH DAKOTA 57078-0713  
PH. 1-800-474-8756 ■ FAX 605-665-0501



SHUR-CO® HELP LINE  
CALL: 1-866-748-7435  
www.shurco.com

**STEP 6:** Two-hopper trailer: Locate junction box between hoppers to supply power to ProTrap® units. Using slots in junction box assembly as a guide, mark and drill 3/16" holes and fasten to trailer with 1/4" x 3/4" self-drilling screws.

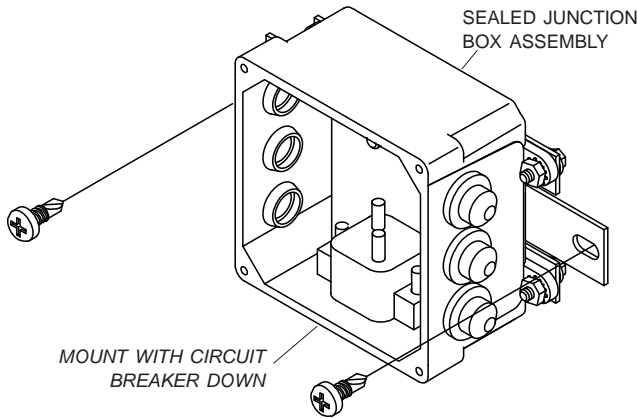

**STEP 7:** Pierce grommets with ballpoint pen so that terminal wires can be inserted through pierced holes.

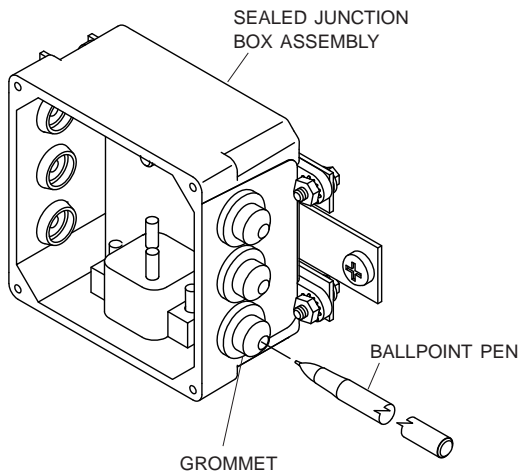

**STEP 8:** Run 6 ga. wire from conductor socket to junction box. Crimp 1/4" ring terminals to wire ends. Remove hex nut and lock washer from junction post assembly. Place positive wires on positive post and negative wires on negative post. Secure with hex nuts and lock washers.

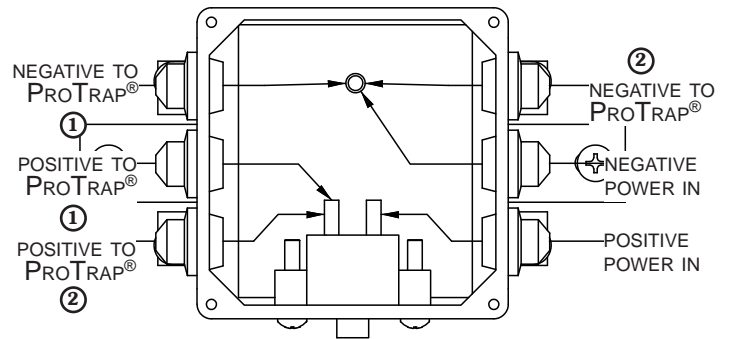

**STEP 9:** Fasten cover to junction box with supplied screws.

