

Item	Part #	Description
1.	1120784	Upper Arm Conversion Assembly - Std.
	1120785	Upper Arm Conversion Assembly - 7 1/4"
2.	1704330	Rubber Insulating Boot
3.	1702707	Ring Terminal - 6 Ga. x 1/4" Stud
4.	1703882	Cap Plug w/Hole - 1 1/4"
5.	1704378	Electric Connector Protector - .14 oz. (not shown)

STEP 1a: Remove existing motor and upper arm. Unfasten and remove electric wires from motor. Unfasten and remove hardware holding manual override collar and electric motor to roll tube, then remove motor from upper arm.

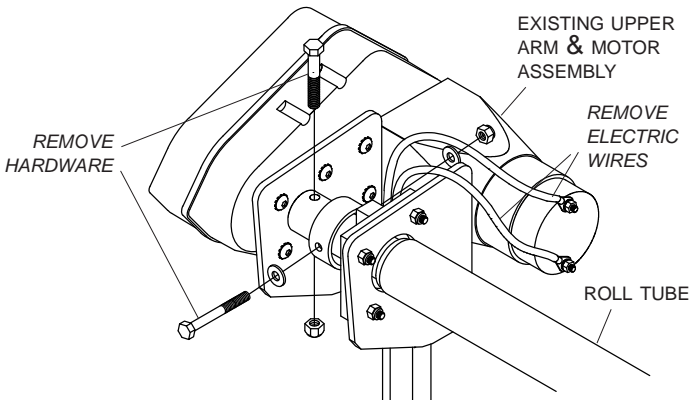

STEP 1b: Unthread upper flex arm from flex arm joint. Remove and discard upper flex arm.

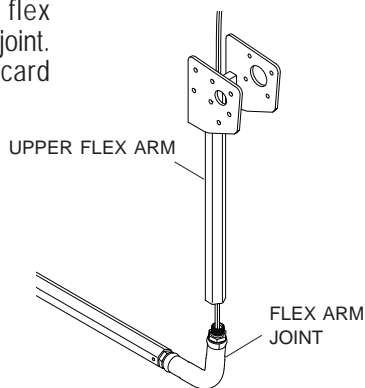

STEP 2: Install 4500 Series upper arm conversion assembly. Insert wire from lower arm through upper flex arm on upper arm conversion assembly. Thread flex arm into flex arm joint.

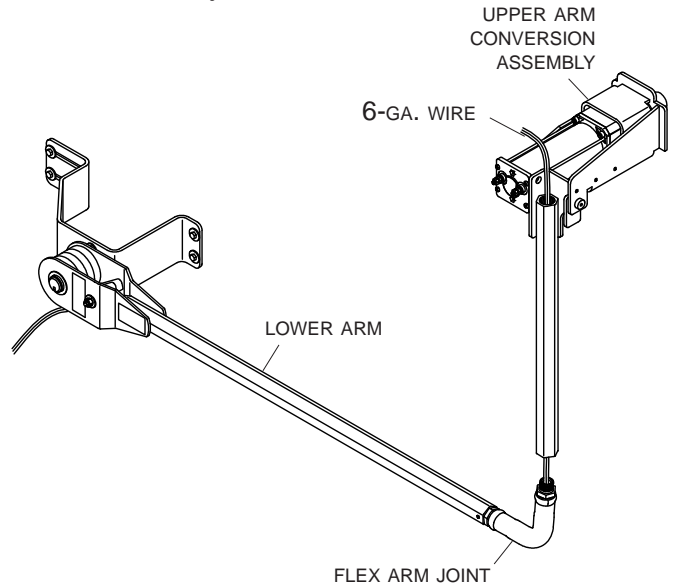

STEP 3: Hold upper arm with motor and roll tube extension in vertical plane to trailer and 90° to roll tube. Mark roll tube at location to be cut.

NOTE: Requires two people for safe installation.

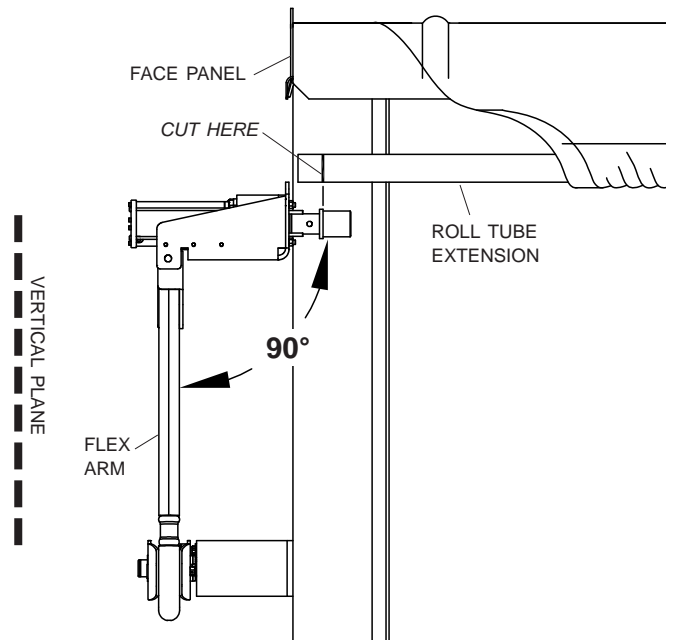

STEP 4: Insert roll tube drive shaft on upper arm conversion assembly into existing roll tube. Weld in place and grind smooth.

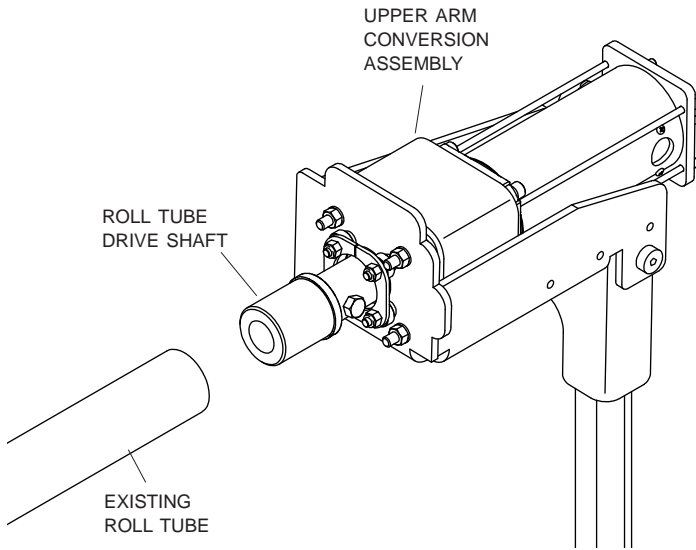

STEP 5: Install cap plug with hole on upper arm. Leave about 12" of wire extending from top of upper arm.

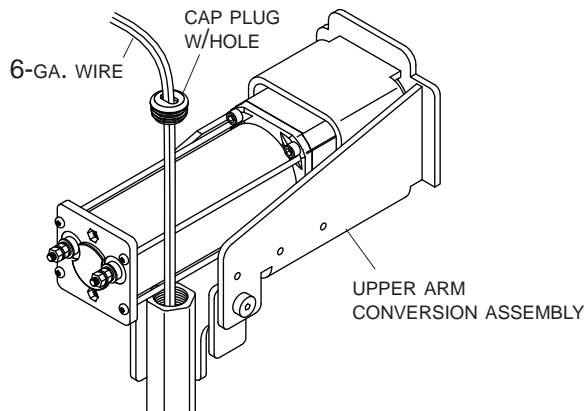

STEP 6: Run wire ends through rubber boots and crimp ring terminals to ends of wire.

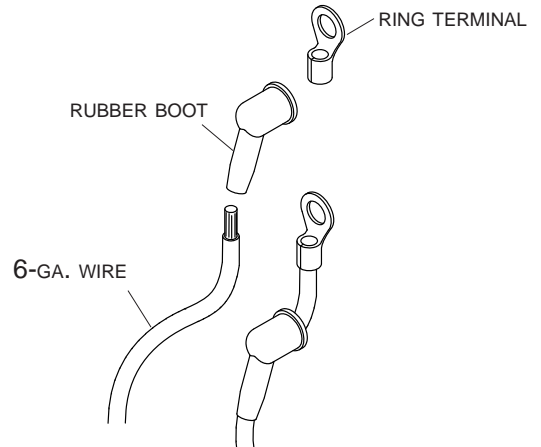

STEP 7: Connect wires to posts on motor. Coat with dielectric grease and install rubber boots over ring terminals.

