

OPERATION

The contactor module protects the motorized tarp system by limiting the amount of time the motor exerts a stall torque. A status indicator LED is lit solid when the contactor is on and flashes to indicate a fault condition. After a fault condition, the module will turn back on in five to ten seconds.

Other faults include low-battery voltage and loss of ground connection on the module.

| Item Part # | Description |
|-------------|------------------------------------|
| 1. 1700400 | Self-Tapping Screw - 3/8" x 1" |
| 2. 1700434 | Lock Washer - 3/8" |
| 3. 1700407 | Hex Nut - 3/8" |
| 4. 1704925 | Torque-Limiting Assembly |
| 5. 1121395 | Mounting Bracket |
| 6. 1704367 | Hex Flange Cap Screw - #10 x 3/4" |
| 7. 1702653 | Nut - Machine Screw w/Washer - #10 |
| 8. 1703244 | Ring Terminal - 6 Ga. x 3/8" Stud |

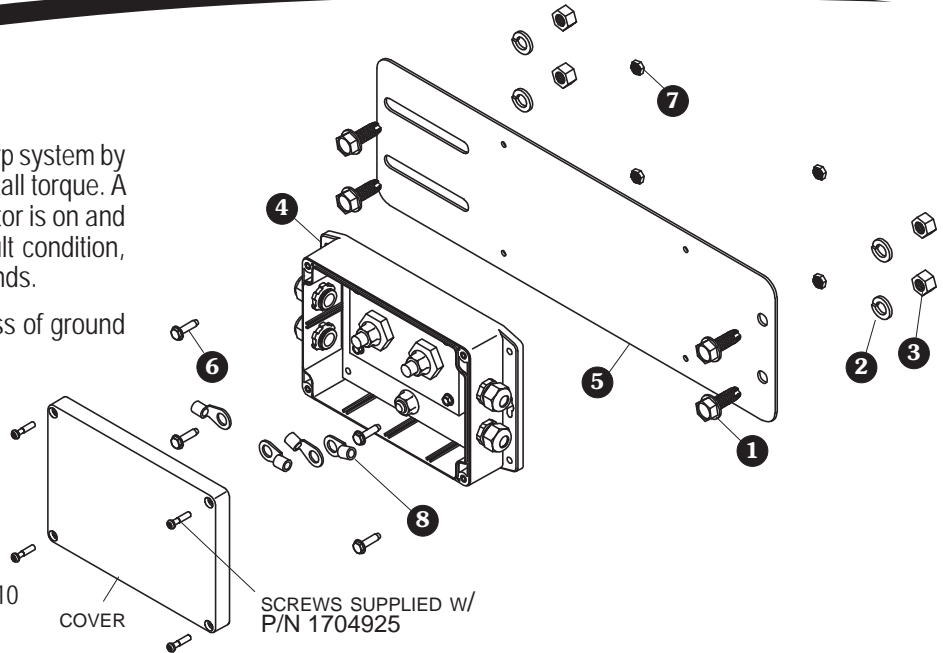

- STEP 1:** Disconnect electric system from power source.
- STEP 2:** For wireless systems. Mount torque-limiting module on trailer. Mount module between wireless receiver and junction box or dual-pole conductor as shown. If applicable, use mounting bracket to span between vertical trailer supports.

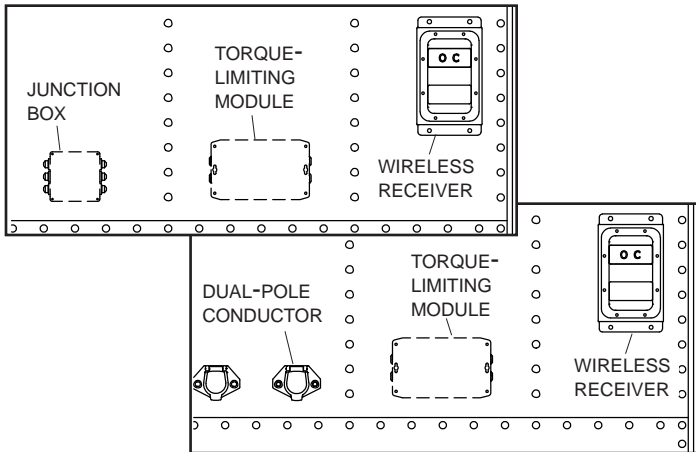

NOTE: Mount torque-limiting module on a vertical surface.

For non-wireless systems. With rocker switch in cab, mount torque-limiting module on truck. Mount module between truck battery and solenoid, as shown in wiring diagram for rocker switch in cab.

NOTE: Hooking up a trailer with a non-wireless 3500 system to a truck that does not have a torque-limiting module may void the warranty of the tarp and/or motor.

- STEP 3:** Remove screws holding cover on module.

CAUTION

Verify polarity of wires. Improper wiring may result in damage to system and/or truck or trailer.

- STEP 4:** Cut 6-ga. wire where module has been mounted and feed 6-ga. wires through dome nuts.
- STEP 5:** Crimp ring terminals on wire ends and fasten to posts as shown.

NOTE: Cut wires to length and strip only enough wire insulation to install ring terminals. Insert bare wire into ring terminals and crimp securely.

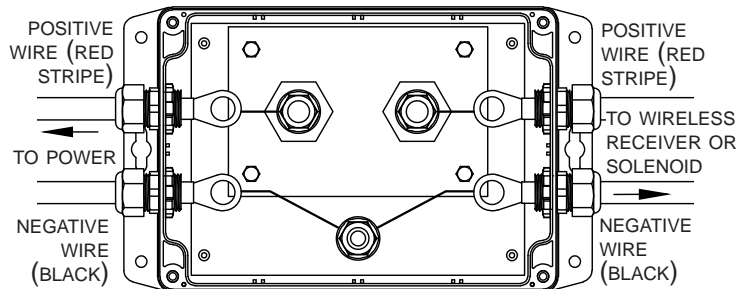

- STEP 6:** Replace cover on module and fasten screws.
- STEP 7:** Reconnect electric system components to power source.

CAUTION

Do not weld on vehicle while torque-limiting module is installed or module may be damaged. If welding is necessary, disconnect load and battery terminals first.

WIRING DIAGRAM - 3500 SERIES ONLY (WIRELESS)

POWER IS NOT SPLIT USING A JUNCTION BOX

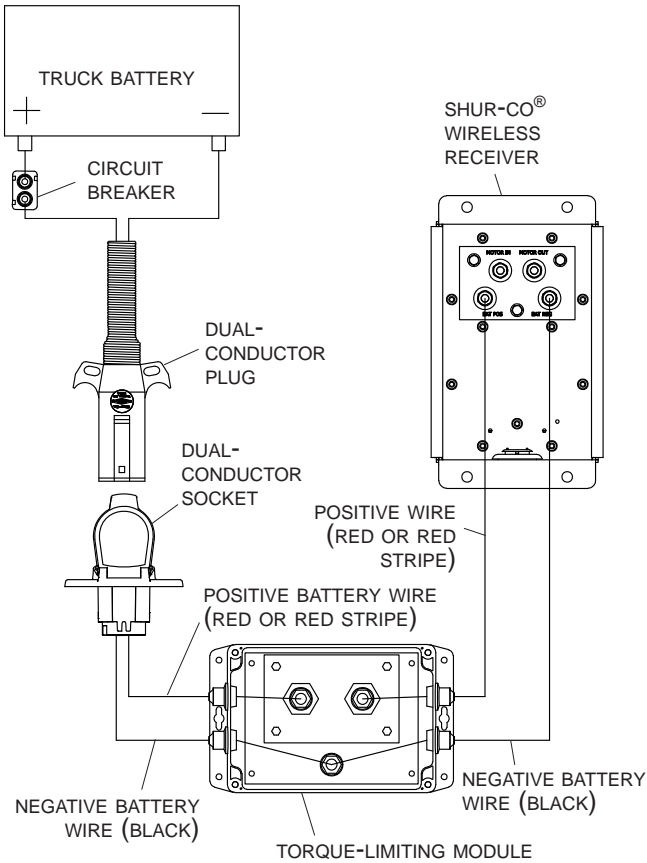

WIRING DIAGRAM - 3500 SERIES COMBO KIT (WIRELESS)

POWER IS SPLIT USING A JUNCTION BOX

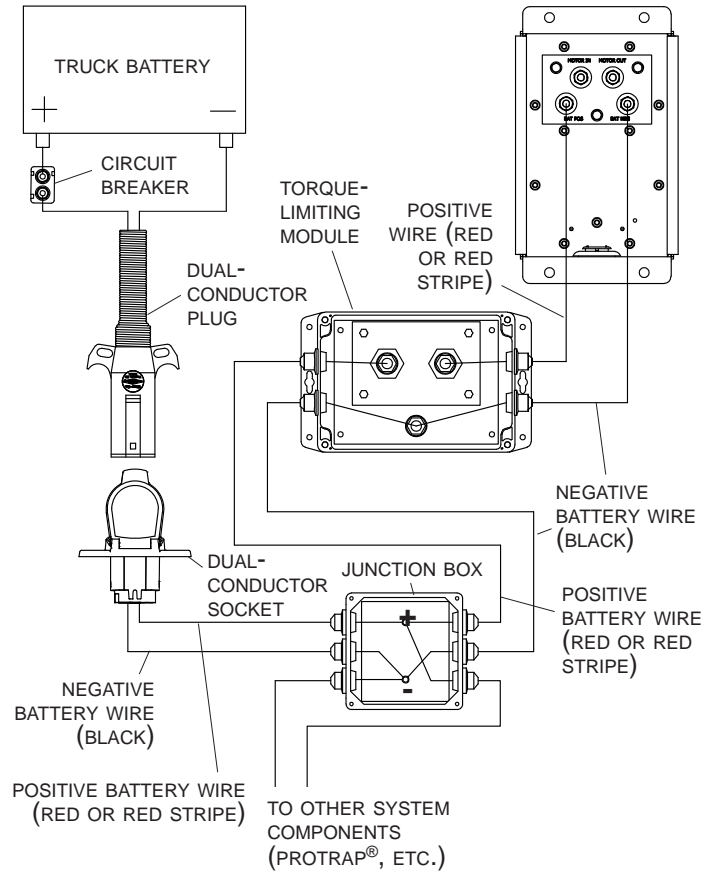

WIRING DIAGRAM - 3500 SERIES ONLY (ROCKER SWITCH IN CAB)

