

Item	Part #	Description
1.	1118257	Shur-Co® Wireless Receiver
2.	1704354	40-Amp Modified-Reset Circuit Breaker
3.	1702707	Ring Terminal - 6 Ga. 1/4" Stud
4.	1704330	Rubber Insulating Boot
5.	1702926	Cap Screw - 5/16" x 7/8"
6.	1700419	Lock Nut - 5/16"
7.	1201237	Flat Washer - 5/16"
8.	1118437	5-Channel SMARTransmitter®

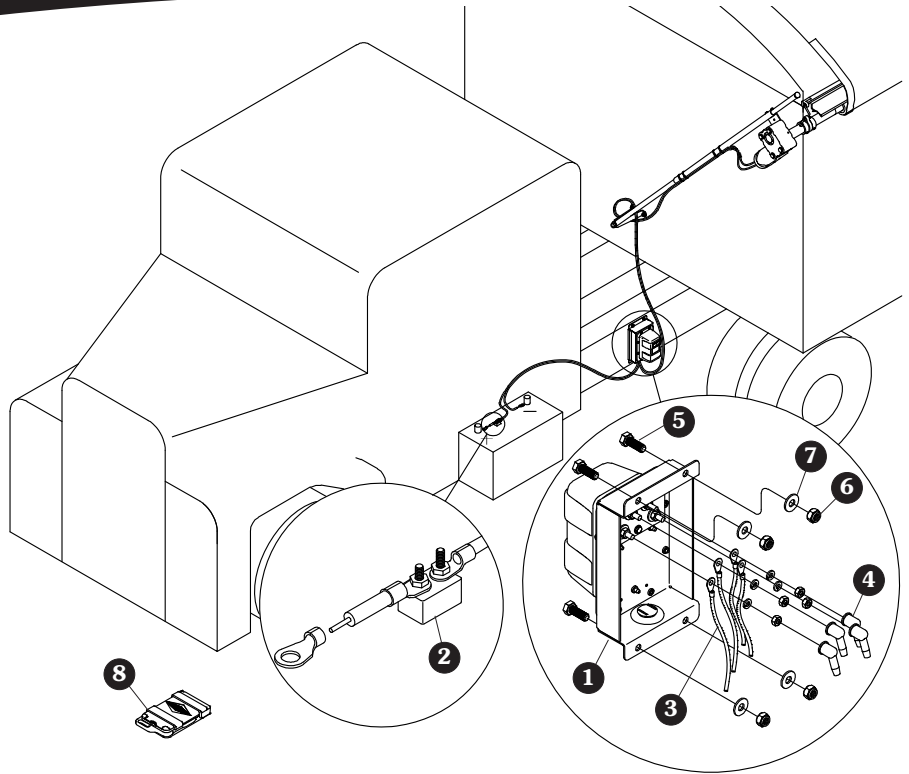

**NOTE:** Cut wires to length and strip only enough wire insulation to install ring terminals. Insert bare wire into ring terminals and crimp securely.

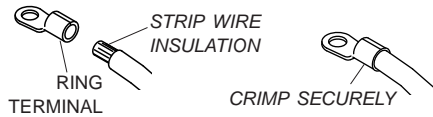

- STEP 1:** Disconnect electric components from power source.
- STEP 2:** Unfasten and remove electric wires connecting solenoid to motor. Unfasten and remove solenoid from cab.
- STEP 3:** Determine mounting location for wireless receiver. Receiver may be mounted on back of cab or on frame.

**NOTE:** Wireless receiver must be mounted on a vertical surface, within 15' of rocker switch. See instructions P/N 1119352.

- STEP 4:** Circuit breaker & battery. Mount circuit breaker as close as possible to battery or power supply.

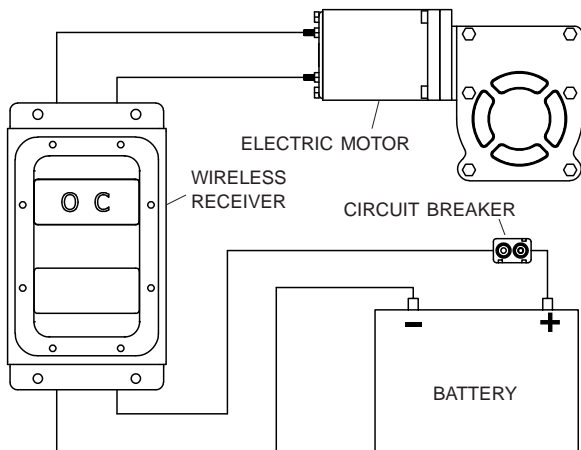

- STEP 5:** Shur-Co® Wireless Receiver. Identify 6-ga. wires running from electric motor. Route wires as desired, securing with cable ties. Insert ends of wires through grommet in wireless receiver and through rubber boots. Crimp 1/4" ring terminals onto wire ends. Remove nuts and lock washers from back of wireless receiver. Place positive wire on upper orange post and negative wire on upper black post. Secure lock washers and hex nuts. Coat with dielectric grease and install rubber boots over ring terminals.

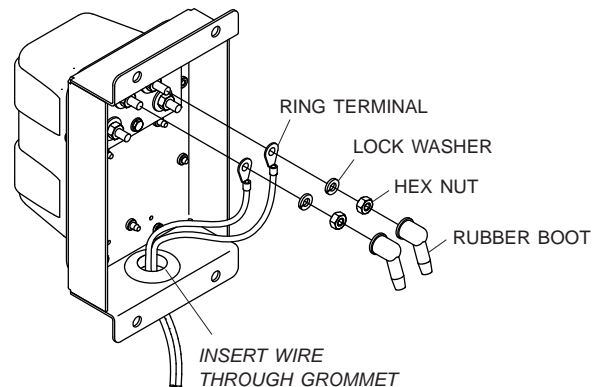

**NOTE:** Use dielectric grease (P/N 1704378) to prevent corrosion on terminals.

**STEP 6:** From battery, run a section of 6-ga. wire, long enough to reach wireless receiver, through grommet in wireless receiver and through rubber boots. Crimp 1/4" ring terminals to wire ends. On back of wireless receiver, place positive wire on lower orange post and negative wire on lower black post. Secure with 1/4" lock washers and hex nuts. Coat with dielectric grease and install rubber boots over ring terminals.

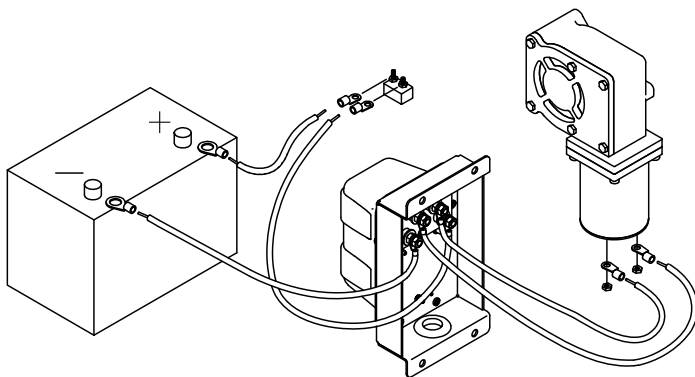
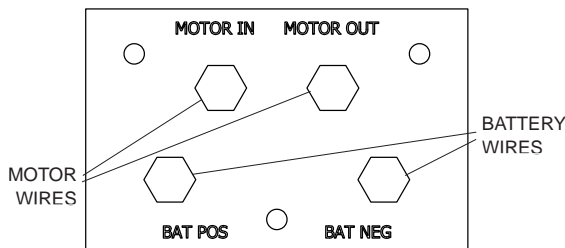
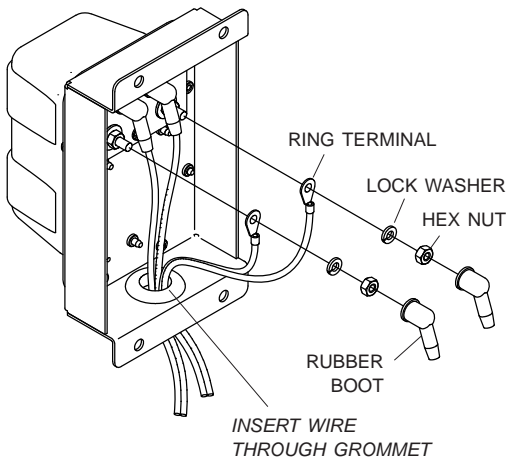

**STEP 7:** Mark and drill 11/32" holes and fasten with 5/16" x 7/8" cap screws, flat washers and lock nuts.

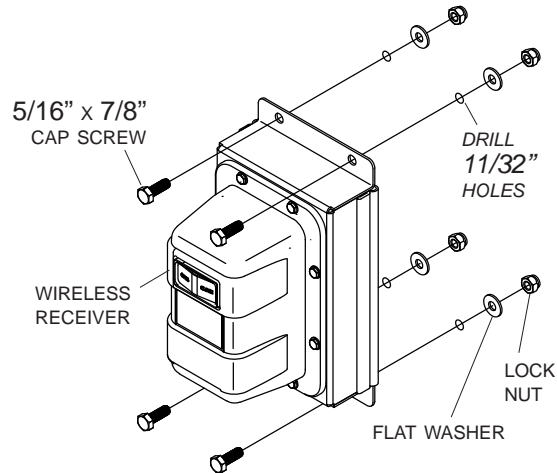

**CAUTION**  
Check all hardware for complete assembly before operating. Inspect system at this time and adjust as required.

**OPERATION:**

- A) Check motor direction by activating switch to "OPEN." If switch is running system backwards, change wire leads on motor to opposite connections.
- B) Close tarp: Push switch to "CLOSE" and hold. Observe tarp and release switch when tarp is fully closed.
- C) Open tarp: Push switch to "OPEN" and hold. Observe tarp and release switch when tarp is fully opened.

**NOTE:** Release switch at end of cycle or modified-reset circuit breaker will trip. After breaker resets, switch will activate motor again. To reduce unnecessary strain on tarp components, release switch at end of each cycle.

**NOTE:** Pressure Wash. The receiver may be pressure washed, but keep nozzle at least 3' from system while spraying.

