

Item	Part #	Description
1.	1120708	Solenoid Cover Assembly - 4500 HD Series SMART2™
2.	1704312	Motor-Reversing Solenoid - 3 Pt. Mt.
3.	1121641	Receiver Encoder Wire - 6'
4.	1703231	Cable Tie - 8"

**STEP 1:** Disconnect power to receiver. Remove existing gray cover and RF solenoid from receiver bracket.

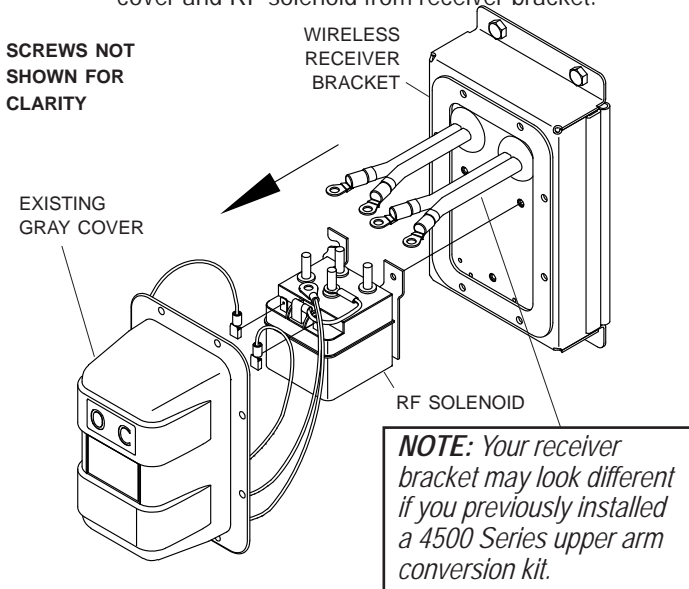

**STEP 2:** Using pilot hole in receiver bracket as guide, drill 1/2" hole in bracket.

**NOTE:** If your receiver bracket does not have pilot hole, measure 1 5/16" from both bottom edge and left side edge of receiver bracket and mark hole location for drilling.

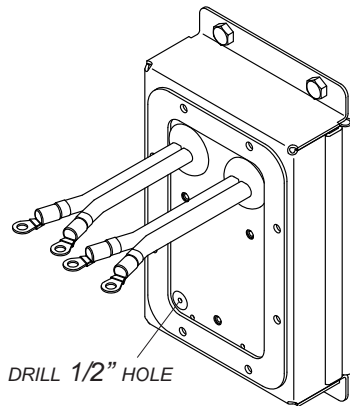

**STEP 3:** Install solenoid 2 onto wireless receiver bracket. Fasten with #10 x 1/2" cap screws.

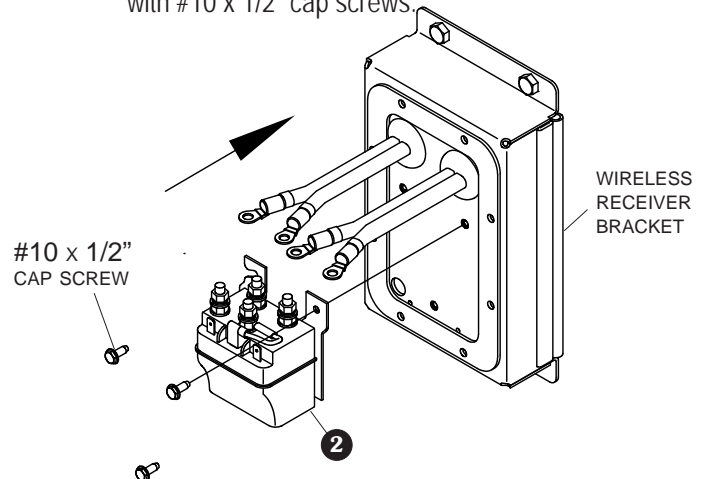

**STEP 4:** Remove receiver bracket from trailer and install encoder wire 3 through drilled hole from back side of bracket. Feed one connector at a time through drilled hole.

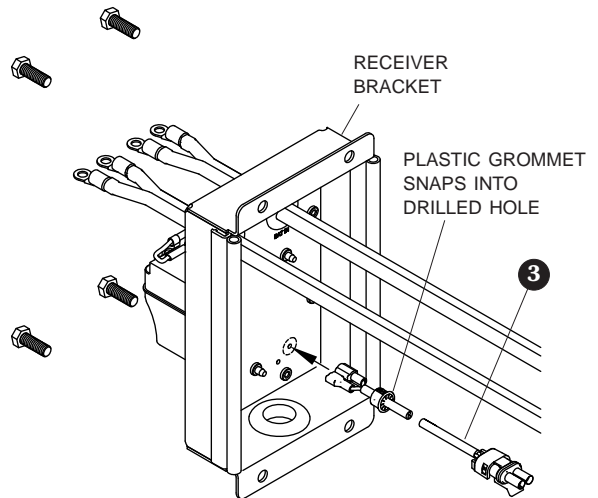

**STEP 5:** Route encoder wire ③ from receiver to encoder wire from motor and connect sealed connectors together. Secure cable with cable ties ④.

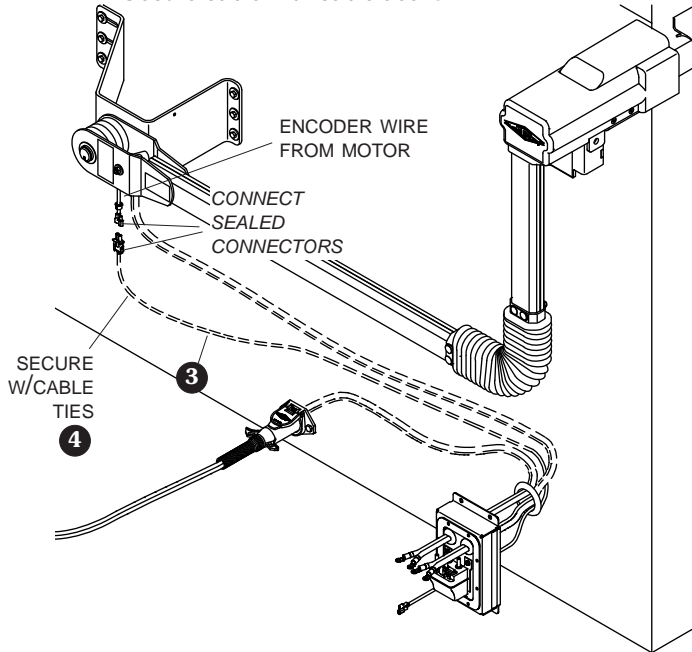

**STEP 6:** Remount receiver bracket to trailer.

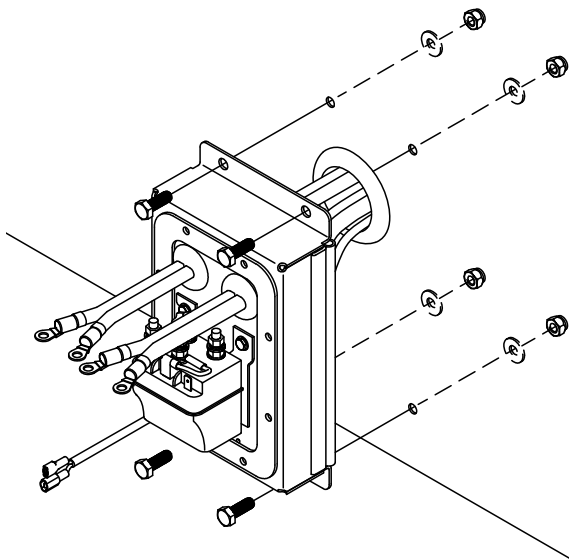

**STEP 7:** Connect wires from receiver bracket to solenoid and from gray solenoid cover to solenoid as shown below.

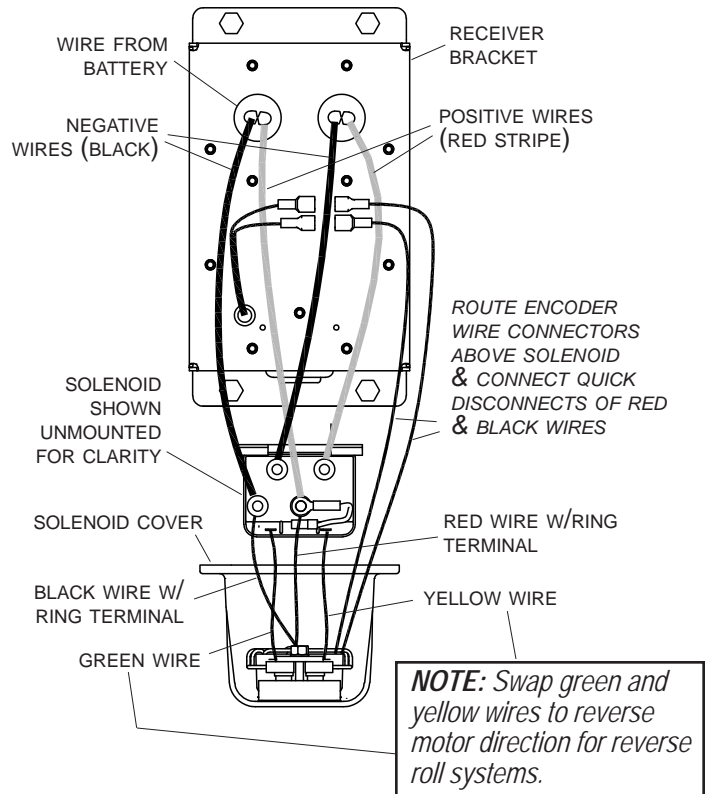

**STEP 8:** Reconnect power to receiver. Pair (introduce) SMART2™ remote to receiver as shown in remote instructions (P/N 1122198) and verify operation.

**STEP 9:** Replace solenoid cover and secure with #10 x 1/2" cap screws.

