

CAUTION
 Check all hardware for complete assembly before operating. Inspect system and adjust as required.

CHASSIS CONTROL BOX OPERATION

Control box operation: Press and hold CLOSE button to close tarp/sheet. Press and hold OPEN button to open tarp/sheet.

NOTE: Additional instructions can be found in SMART1+™ Instruction Guide.

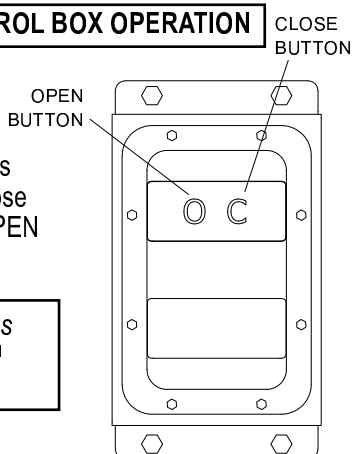

REMOTE POWER UP/DOWN

Transmitter (remote) will power up when lid is opened. Remote will power down when lid is closed or when lid is left open three minutes after last button is pushed.

TO ACCESS BATTERY, UNFASTEN SCREW ON BACK OF REMOTE WITH PHILLIPS SCREWDRIVER

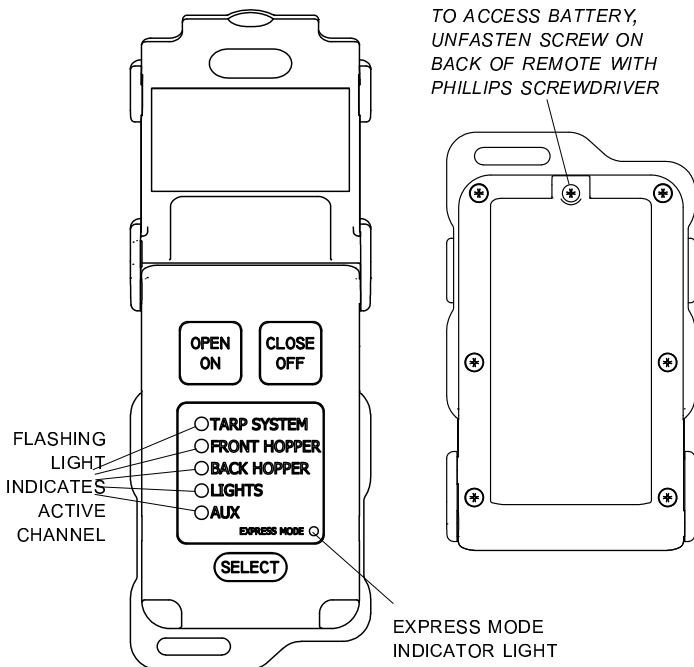

STANDARD REMOTE OPERATION

After power-up, first channel will be immediately active and channel indicator light will be flashing. *Open/On* and *Close/Off* buttons are operational for indicated active channel. While either *Open* or *Close* button is pressed, indicator light for active channel will flash faster, indicating command is being transmitted on active channel. *Select* button will cycle between enabled channels.

Each channel on remote can be set to operate in either *Momentary Mode* or *Express Mode*.

Momentary Mode: When in *Momentary Mode*, motor will operate only while button is held down.

Indicator light labeled **EXPRESS MODE** will be off when remote is in *Momentary Mode*.

If remote channel is in *Momentary Mode*, initiate a one-time *Express Mode* command by pressing *Open* or *Close* button, then simultaneously pressing *Select* button. System can be stopped at any time by pressing any button on remote or closing remote lid.

Indicator light labeled *Express Mode* will be lit for first five seconds after initiating "One Time" *Express* command.

Express Mode: When remote channel is programmed for *Express Mode*, *Open* or *Close* button can be pressed and released. System will continue to operate until fully open or closed. System can be stopped at any time by pressing any button on remote or closing remote lid.

Indicator light labeled **EXPRESS MODE** will be on when remote is in *Express Mode*.

CONFIGURING REMOTE CHANNELS

Refer to SMART1+™ Operating Instruction Guide (P/N 1123159) and instructional video, which can be found on line at <http://www.shurco.com>.

LOW BATTERY INDICATION

If battery level is getting low, all lights on remote will flash for three seconds when lid is opened and operation is attempted. Remote will then operate normally.

If battery level drops lower, remote will automatically turn off after flashing indication. Batteries must be replaced.

REPLACING BATTERIES

SMART1+™ remote uses two AAA (LR03) batteries. To access batteries, unfasten center screw and gently lift cover tab.

SMART1+™ Operators Instruction Guide is available on our website: <http://www.shurco.com>

MANUAL OVERRIDE INSTRUCTIONS

STEP 1: To release tension on straps, unplug white control wire that supplies power to spool motor. Press *Close* button on SMART1+™ remote or manual control box. This will unlock motor break, releasing any tension in webbing and sheet. Reconnect quick-disconnect.

NOTE: If spool motor has failed, follow same steps with center tube motor and press *Open* button.

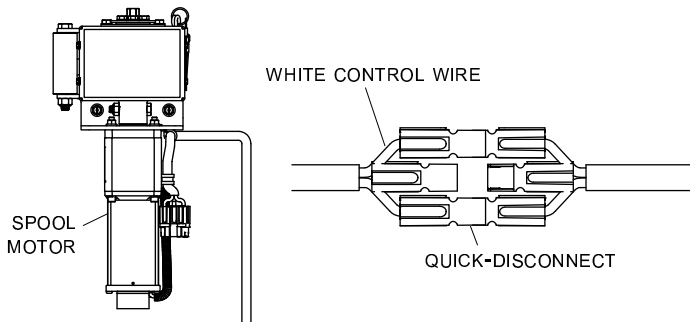

STEP 2: Disconnect power to receiver by unplugging SMARTwire™ connector.

STEP 3: Using two 17mm wrenches, remove M10 lock nuts from motor bolts at spool and center tube motors.

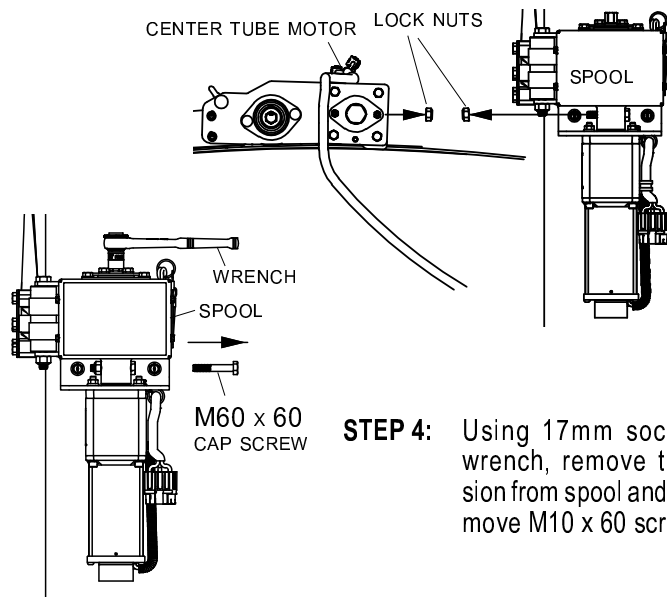

STEP 4: Using 17mm socket wrench, remove tension from spool and remove M10 x 60 screw.

STEP 5: Using supplied center tube manual override wrench, remove tension from center tube motor and remove M10 x 45 screw.

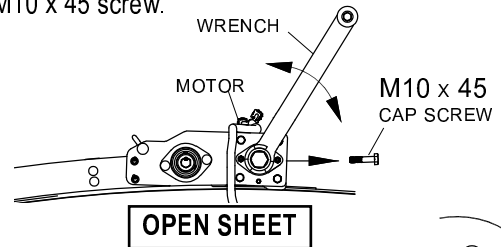

Using supplied center tube manual override wrench on center tube motor shaft, turn shaft clockwise (counterclockwise for reverse-roll) until tarp/sheet is fully open.

Secure in this position by reinstalling M10 x 45 cap screw and M10 lock nut. These must be removed before closing tarp/sheet.

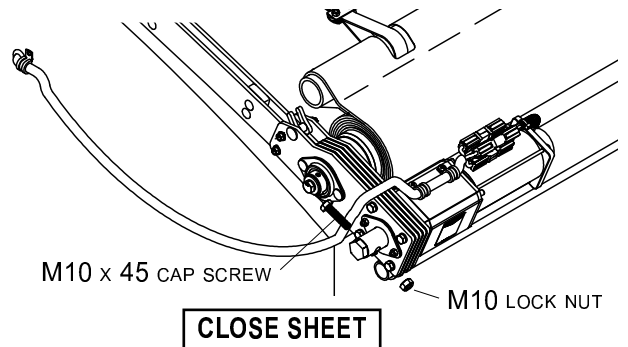

Use 17mm socket wrench on hex end of spool, turning spool clockwise (counterclockwise for reverse-roll) until sheet is fully closed.

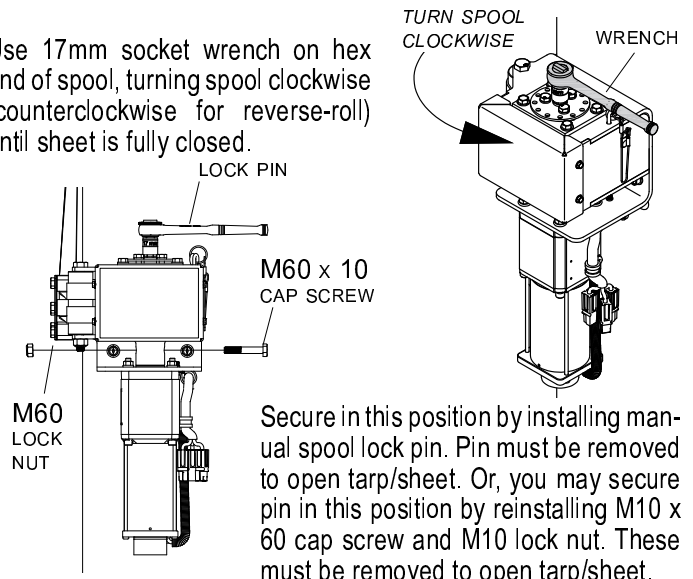

Secure in this position by installing manual spool lock pin. Pin must be removed to open tarp/sheet. Or, you may secure pin in this position by reinstalling M10 x 60 cap screw and M10 lock nut. These must be removed to open tarp/sheet.

NOTE: This is a short-term solution. Contact Shur-Co®, LLC UK at +44 (0) 1795 473499 for replacement parts.

SMART1+™ Operators Instruction Guide is available on our website: <http://www.shurco.com>