



TARP SYSTEMS & ACCESSORIES

READ BEFORE INSTALLING

P/N 1127298 Rev. D

DRIVEMAXX OWNER'S MANUAL



By: Shur-Co®

SWING AUGER DRIVE KIT

Download ShurLink™ App



2309 SHUR-LOK STREET • YANKTON, SD 57078-0713
PHONE: 1-800-SHUR-LOK (1-800-474-8756) • FAX: 1-605-665-0501
www.SHURCO.com

SHOP ONLINE: www.SHOPSHURCO.com

Scan QR Code

ORDER
TERMS AND CONDITIONS



WARRANTY

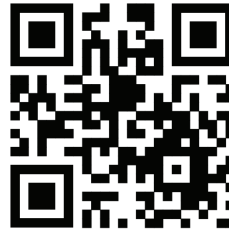

PATENTS



SHUR-CO[®], LLC SERVICE AND DISTRIBUTION CENTERS

SHUR-CO[®] CORPORATE HQ
2309 Shur-Lok Street, Yankton
800-729-2969
Fax: 605-665-0501

SHUR-CO[®] of FLORIDA
3353 SE Gran Park Way, Stuart
800-327-8287
Fax: 772-287-0431

SHUR-CO[®] of CANADA
490 Elgin Street, Unit 2
Brantford, Ontario N3S 7P8
800-265-0823
Fax: 519-751-3997

SHUR-CO[®] of IDAHO
921 Garber Street, Caldwell
208-455-1046
Fax: 208-455-1046

SHUR-CO[®] of OHIO
4676 Lynn Road, Rootstown
866-356-0242
Fax: 330-297-5599

SHUR-CO[®] of ILLINOIS
3993 E. Mueller Avenue, Decatur
866-356-0246
Fax: 217-877-8270

SHUR-CO[®] of NORTH DAKOTA
1746 4th Avenue. NW, West Fargo
877-868-4488
Fax: 701-277-1284

SHUR-CO[®] UK LIMITED
Unit 41, Rochester Airport Estate
Laker Road
Rochester, Kent ME1 3QX

MESSAGE TO OWNERS

Thank you for buying this tarping system from Shur-Co®. We appreciate your confidence in our products. Please read and thoroughly understand this manual before installing and/or operating this system.

Pay particular attention to important safety and operating instructions, as well as warnings and cautions. The hazard symbol  is used to alert users to potentially hazardous conditions and is followed by caution, warning or danger messages.

Failure to READ AND FOLLOW INSTRUCTIONS could result in failure of your tarping system and/or personal injury. Your trailer requirements may, however, call for minor variations to these instructions.

Please inspect your tarping system periodically. Repair or replace worn or damaged parts to your system.

QUESTIONS? CALL OUR HELP LINE:
1-866-748-7435
 MON-FRI 8 AM-5 PM CENTRAL TIME

SAFETY

We at Shur-Co® are concerned with your safety and the safety of all those operating this system. Therefore, we have provided safety decals at various locations on your tarping system. Keep decals as clean as possible at all times. Replace any decal that has become worn or damaged, painted over or otherwise difficult to read. Replacement decals are available through Shur-Co® dealers.

SAFETY INSTRUCTIONS

1. Always wear safety glasses during installation and operation.
2. Stay clear of moving parts.
3. No other use of this system is authorized, except as designed.

RUST PREVENTION

To prevent rust, paint all exposed metal, such as weld seams and/or metal exposed by grinding or cutting, with corrosion-resistant paint.

TABLE OF CONTENTS

Hardware Identification.....	4
Drive Brace Installation.....	5-6
Jack Installation	7
Main Beam to Swing Auger Installation.....	8-11
Control Box Installation.....	12-14
Decal Installation	15

TOOLS REQUIRED

1. #3 Phillips Insert Bit
2. Air or Electric Impact Wrench (3/4" deep socket)
3. 1/2" Deep Socket
4. 3/4" Combination Wrench
5. 1/2" Combination Wrench
6. 1/2" Drill Bit
7. 3/8" Drill
8. Standard/Flathead Screwdriver
9. #2 Phillips Screwdriver
10. Utility Knife
11. Ratchet
12. Pliers
13. Side Cutter
14. Tape Measure
15. 5/16" Nut Driver
16. Aviation Snips
17. Hammer
18. Center Punch or Transfer Punch

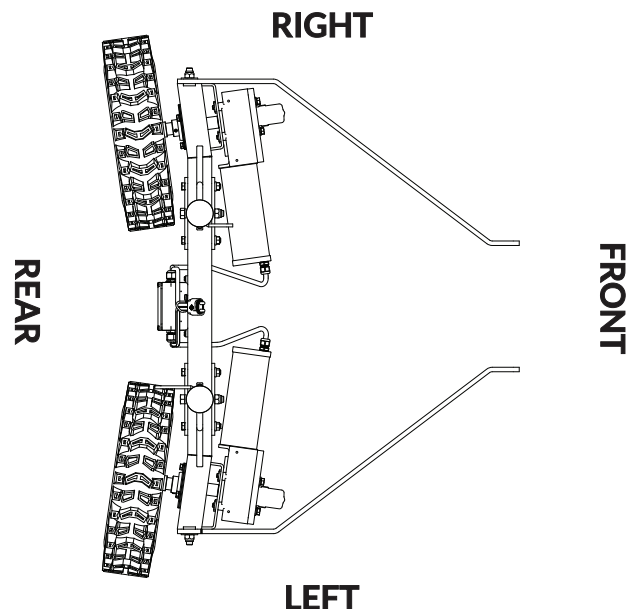
SYSTEM ORIENTATION

Inspect all parts in your DriveMaxx™ electric kit upon arrival.

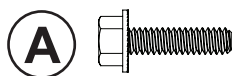

1704308 Flange Cap Screw - #10-24 x 1/2"

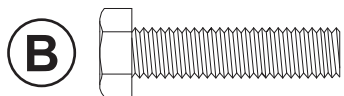

1705719 Hex Head Cap Screw - 3/8" x 1-1/2"

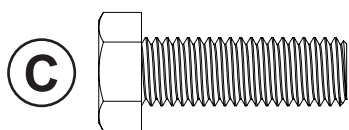

1702075 Hex Head Cap Screw - 1/2" x 1-1/2"

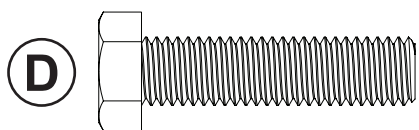

1701042 Hex Head Cap Screw 1/2" x 2"

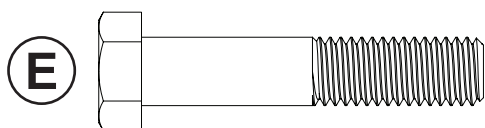

1704041 Hex Head Cap Screw 1/2" x 2-1/2"

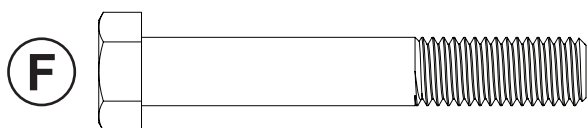

1704808 Hex Head Cap Screw 1/2" x 3-1/4"



1701580 Nylon Lock Hex Nut - 3/8"

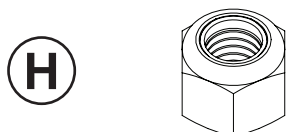

1702115 Nylon Lock Hex Nut - 1/2"



1700429 Flat Washer - 3/8"

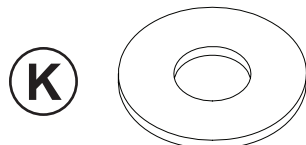

1702114 Flat Washer - 1/2"

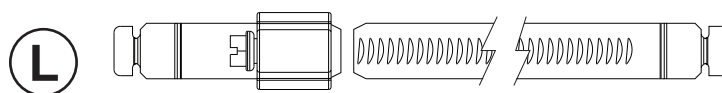

1706376 Hose Clamp Fastener Set



1703231 Cable Tie - 8"



1705977 Cable Tie - 60"

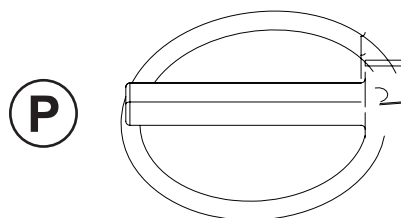

1701098 Lynch Pin - 5/16" x 1-3/4"

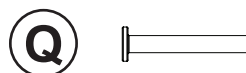

1704751 Harness Lock Pin - 1/4" x 7/8"

Item Part # Description

1. 1127464 Drive Brace - 10" to 11"
 1127468 Drive Brace - 11" to 12"
 1127229 Drive Brace - 12" to 13"
 1127424 Drive Brace - 13" to 14"
 1127273 Drive Brace - 14" to 15"
 1127425 Drive Brace - 15" to 16"
 1127274 Drive Brace - 16" to 17"
 1127426 Drive Brace - 17" to 18"
 1127275 Drive Brace - 18" to 19"
 1128621 Drive Brace - 19" to 20"
 1128622 Drive Brace - 20" to 21"
- C. 1702075 Hex Head Cap Screw - 1/2" x 1-1/2"
 D. 1701042 Hex Head Cap Screw - 1/2" x 2"
 E. 1704041 Hex Head Cap Screw - 1/2" x 2-1/2"
 H. 1702115 Nylon Lock Hex Nut - 1/2"
 K. 1702114 Flat Washer - 1/2"

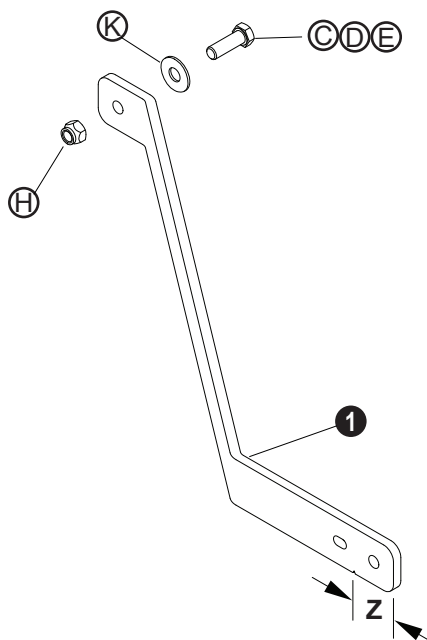

Z	Part #
2"	1127464
2.25"	1127468
2.5"	1127229
2.75"	1127424
3"	1127273
3.25"	1127425
3.5"	1127274
3.75"	1127426
4"	1127275
4.25"	1128621
4.5"	1128622

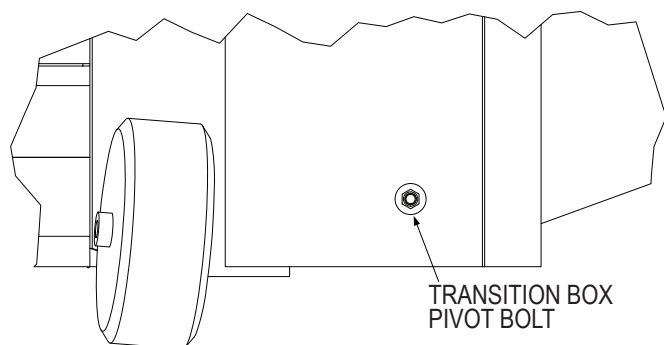
STEP 1: Find existing transition box pivot bolt location.

If transition box does not have pivot bolt, locate and drill a 1/2 inch hole approximately centered front-to-back and 8 inches up from ground.

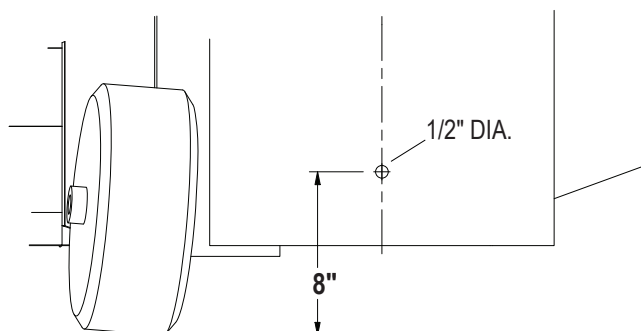

NOTE: Before drilling any holes, verify bolt will not interfere with operation of swing auger.

STEP 2: If box has flange, measure distance from flange to pivot bolt hole.

- If no flange or if distance A is 3-1/2" or greater, continue to STEP 3A.
- If flange is between 2-1/2" and 3-1/2", skip to STEP 3B.
- If flange is less than 2-1/2", skip to STEP 3C.

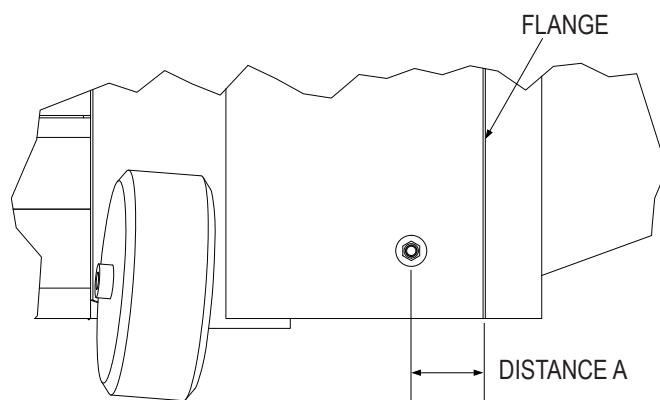

STEP 3A: If distance A is greater than 3-1/2 inches from flange, or if there is no flange, remove existing hardware. Drill holes to accept 1/2 inch bolt (C), if needed. Secure drive brace using bolt (C), washer (K) and nylon nut (H). Hand tighten nut.

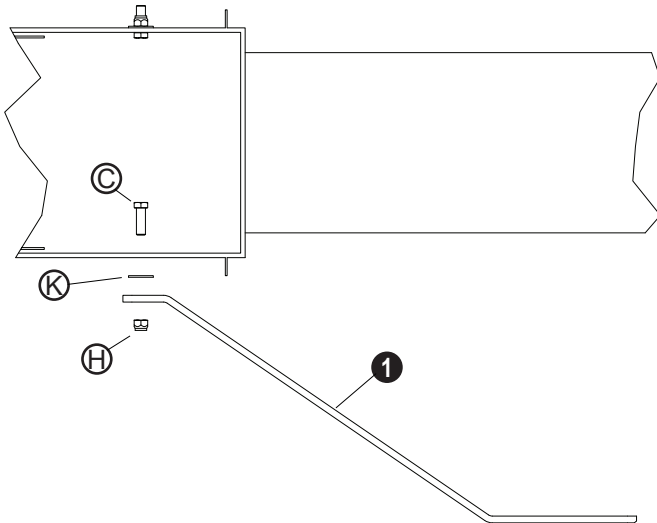

STEP 3B: If distance A is between 2-1/2 and 3-1/2 inches from flange, remove existing hardware. Drill holes in transition box to accept 1/2 inch bolt, if needed. Secure drive brace using bolt (D), 1/2 inch stack of flat washer (K) and nylon nut (H). Hand tighten nut.

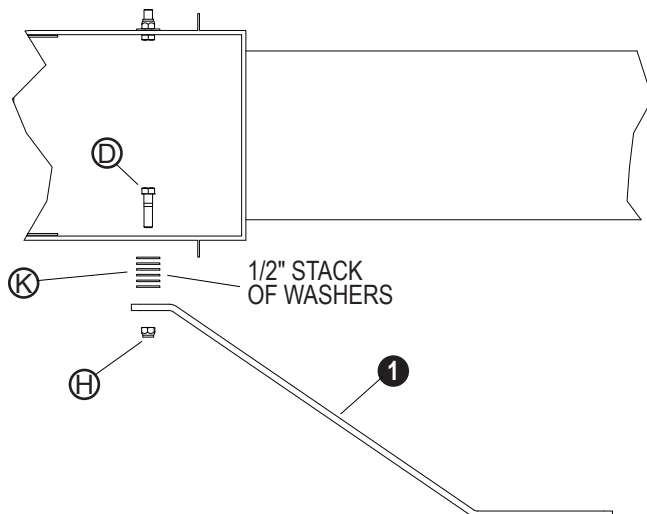

NOTE: Measure stack of washers; thickness can vary.

STEP 3C: Distance A is less than 2-1/2 inches from flange, remove existing hardware. Drill holes in transition box to accept 1/2 inch bolt, if needed. Secure drive brace using bolt (E), 1 inch stack of flat washer (K), and nylon nut (H). Hand tighten nut.

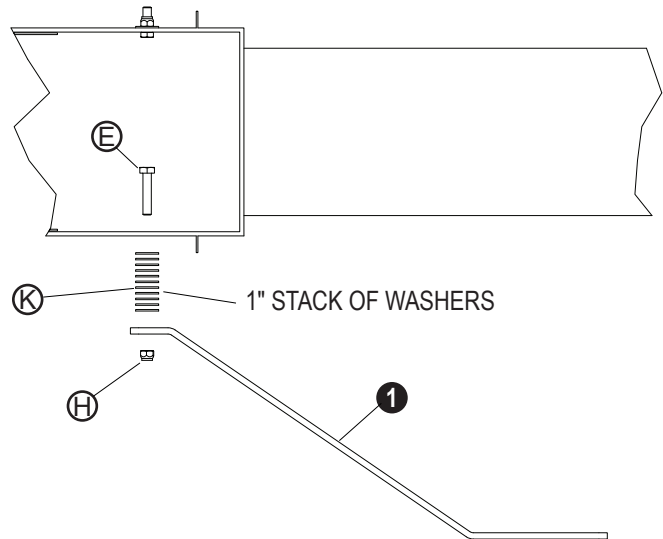

NOTE: Measure stack of washers; thickness can vary.

STEP 4: Repeat STEP 3 on opposite side.

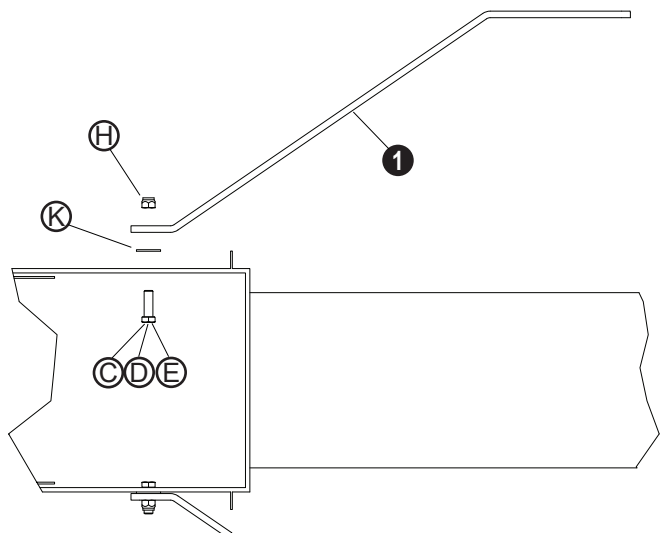

NOTE: Use same bolt and washer stack on both sides.

Item Part # Description

- | | | |
|----|---------|------------------------------------|
| 1. | 1130023 | Main Beam |
| 2. | 1127235 | Jack 2-Hole |
| 3. | 1128578 | Jack 2-Hole Dual |
| F. | 1704808 | Hex Head Cap Screw - 1/2" x 3-1/4" |
| H. | 1702115 | Nylon Lock Hex Nut - 1/2" |

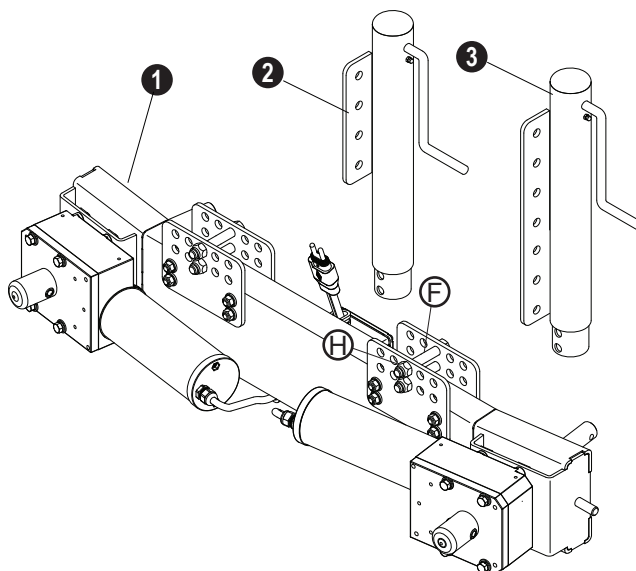

STEP 1: Remove bolt (F) and nylon nut (H) from main beam.

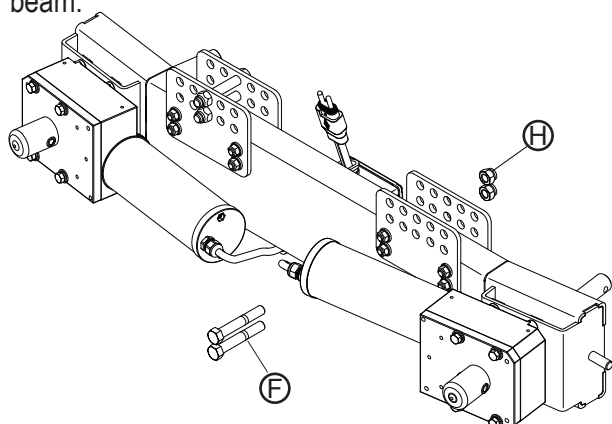

STEP 2: Locate correct hole in jack bracket for tube size of auger.

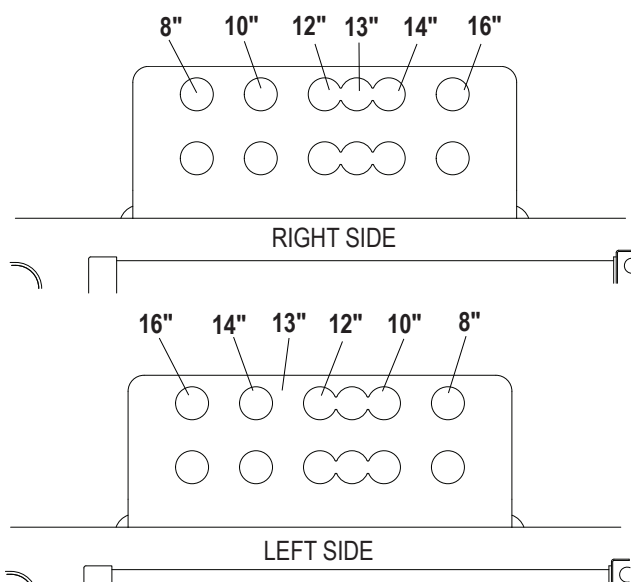

STEP 3A: While on level ground secure jack (2) to main beam with bolt (F) and nylon nut (H). (For 8 to 12 inches auger tubes.)

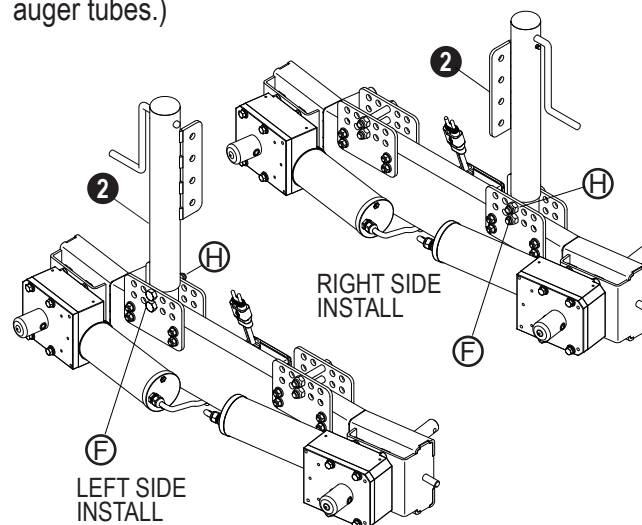

STEP 3B: While on level ground, secure jack (3) to main beam with bolt (F) and nylon nut (H). (For 12 to 16 inch auger tubes.)

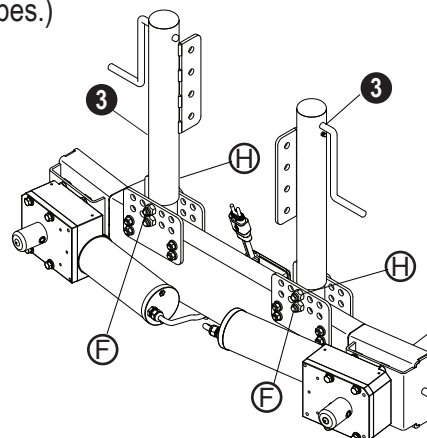

Item	Part #	Description
1.	1127230	Wheel Counter-Clockwise
2.	1127234	Wheel Clockwise
3.	1127291	Tube Band Jack Mount - 8"
	1127250	Tube Band Jack Mount - 10"
	1127252	Tube Band Jack Mount - 12"
	1127293	Tube Band Jack Mount - 13"
	1127254	Tube Band Jack Mount - 14"
	1127256	Tube Band Jack Mount - 16"
4.	1127282	Tube Band - 8"
5.		For 8" to 12" Auger Tubes
6.		For 13" to 14" Auger Tubes
B.	1705719	Hex Head Cap Screw - 3/8" x 1-1/2"
C.	1702075	Hex Head Cap Screw - 1/2" x 1-1/2"
G.	1701580	Nylon Lock Hex Nut - 3/8"
H.	1702115	Nylon Lock Hex Nut - 1/2"
J.	1700429	Flat Washer - 3/8"
K.	1702114	Flat Washer - 1/2"
P.	1701098	Lynch-Pin - 5/16" x 1-3/4"

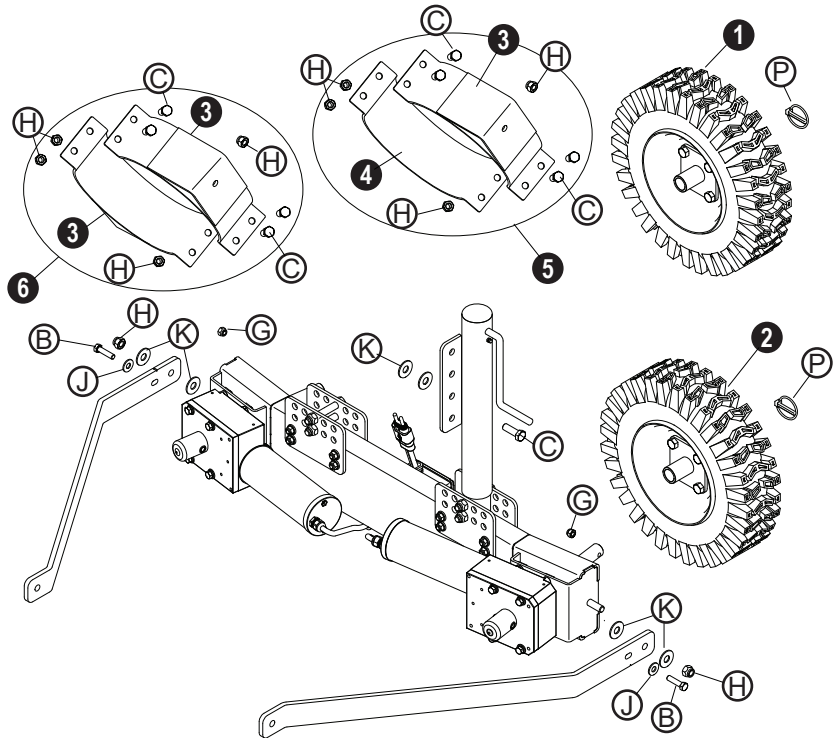

NOTE: 8 to 12 inch auger tube with right side jack installation is shown below. Left side installation is same, but jack will be on opposite side of auger tube. For 13 to 14 inch auger tubes, jack will be on each side of auger tube.

STEP 1: Install wheels on main beam and secure with lynch pin (P).

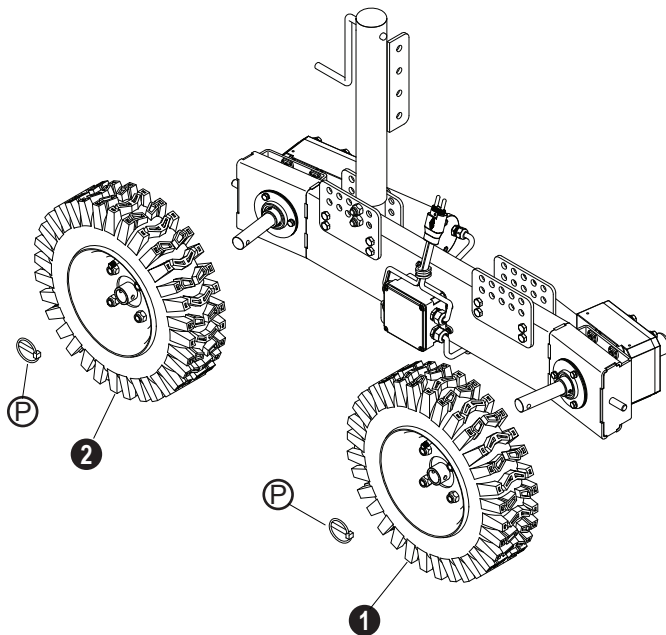

NOTE: Before proceeding to STEP 2, position main auger tube as if filling a bin or silo.

STEP 2: Align main beam and jack with swing auger tube and drive braces. Secure with flat washers (K) and nylon nuts (H). Tighten nylon nuts, then back nut off 1/4 turn so main beam can pivot at drive braces.

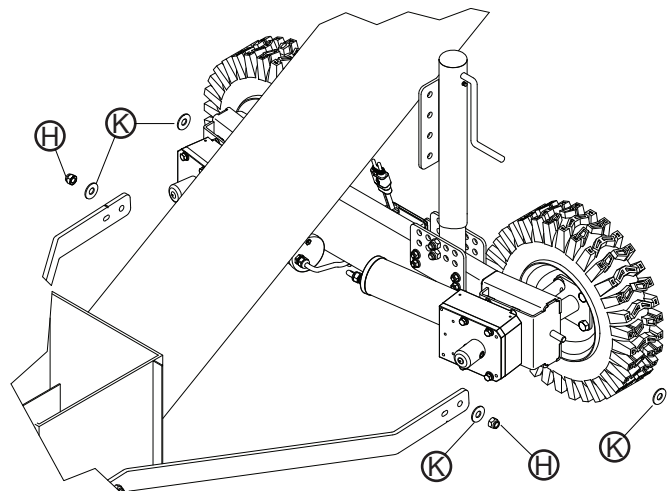

STEP 3: Tighten nylon nuts (H) at transition box. Then back nuts off 1/4 turn so drive brace can rotate on bolt.

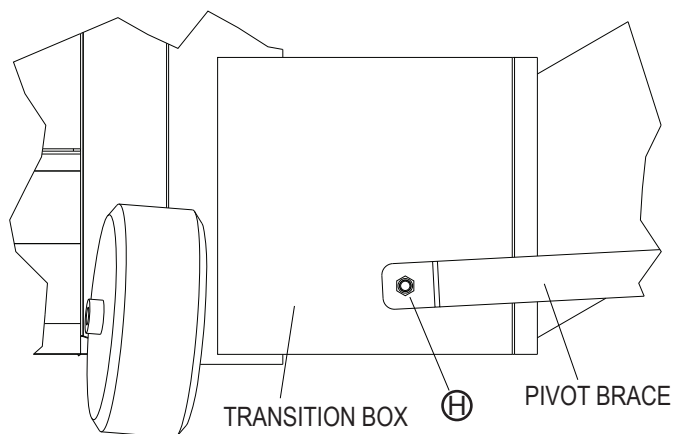

STEP 4: Repeat STEP 3 on other side of transition box.

STEP 5: With drive wheels resting on ground, square main beam assembly so jack is perpendicular to ground. Placing a 5 inch wooden block under main beam will help determine correct position.

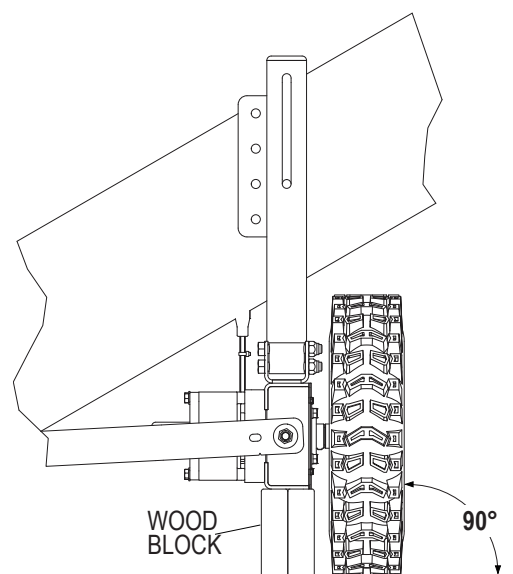

NOTE: Wood block may be constructed by ripping two 12 inch 2 x 6's to 5 inches wide and nailing or screwing together.

STEP 6: Turn jack handle until jack is in fully down position.

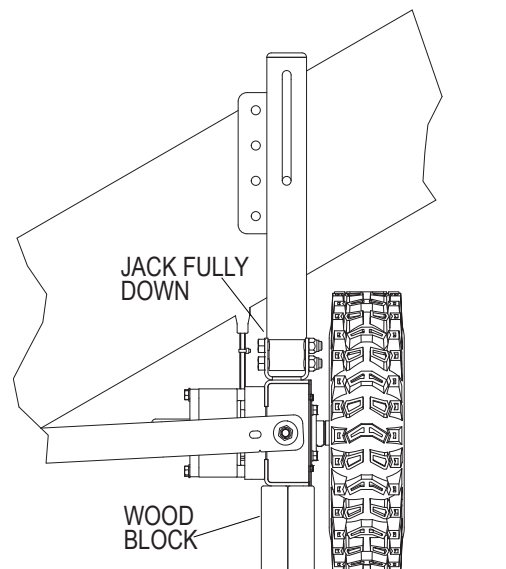

STEP 7: Place tube band jack mount on swing auger tube and align with plate on jack. Turn handle on jack, raising jack plate until hole in tube band jack mount is aligned with hole in jack plate.

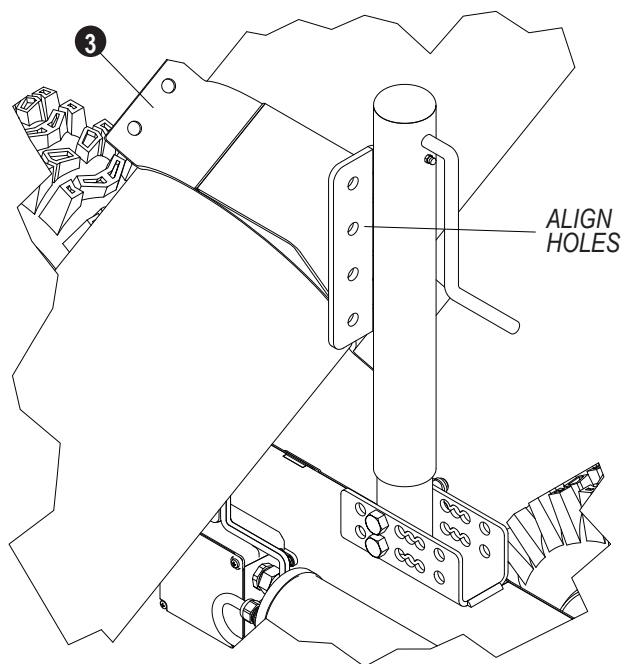

STEP 8: Secure jack plate to tube band jack mount using hex bolt (C), two flat washers (K) between tube band jack mount and jack plate and nylon nut (H). Tighten nylon nut, then back off 1/4 turn.

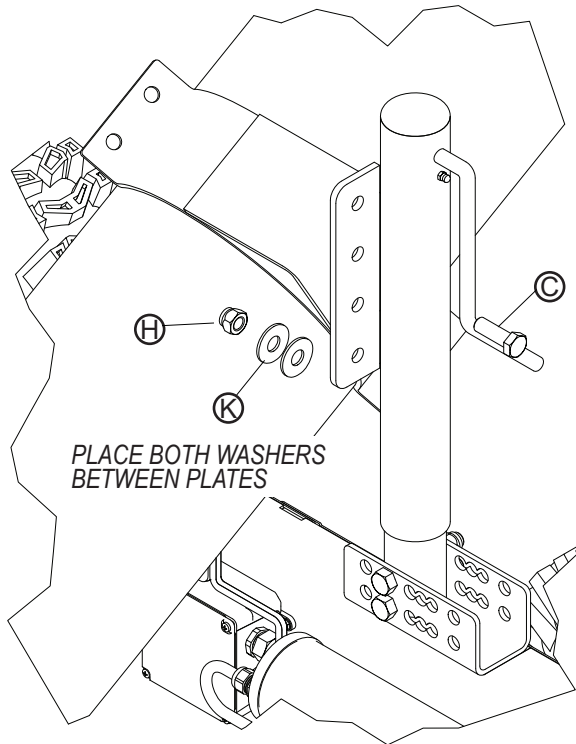

STEP 9: Position tube band by tube band jack mount. Secure bands together using hex bolts (C) and nylon nuts (H). Evenly tighten fasteners securing bands to swing auger.

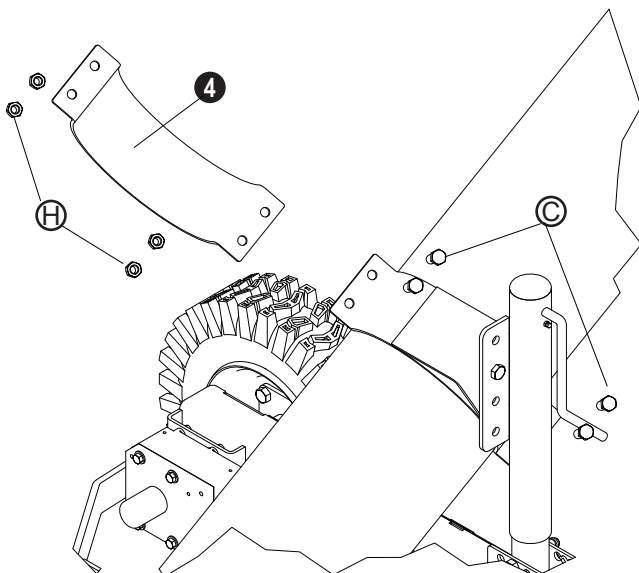

STEP 10: 13, 14 and 16 inch auger tubes will use two tube band jack mount bands (3).

NOTE: Second jack not shown for clarity of image.

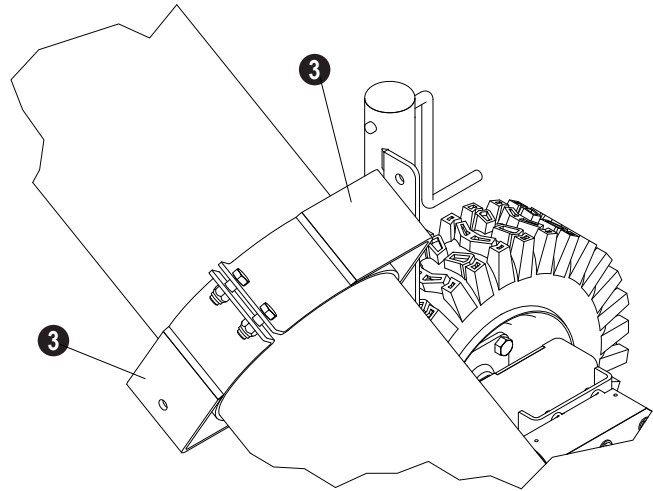

STEP 11: Turn jack handle to bring main beam to fully up position. Verify both wheels are off ground. If wheels do not come off ground, you will need to move to next lower hole in jack plate.

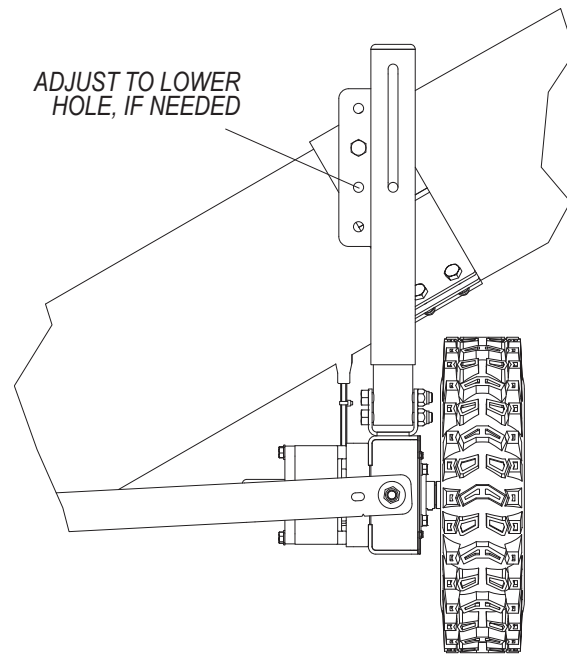

NOTE: The next two steps are for all 13 and 14 inch augers, and 10 and 12 inch augers with additional jacks.

STEP 12: Lower main beam down to wooden blocks. Adjust left side jack so it is extended to same length as right hand jack.

Adjust jack height until holes in jack plate and tube band jack mount align. If holes will not align, match drill a 1/2 inch hole in tube band jack plate using jack plate as guide.

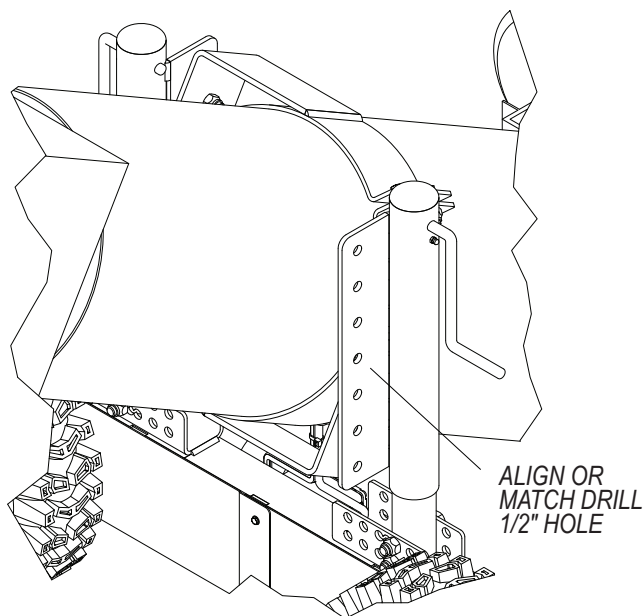

STEP 13: Secure jack plate to tube band jack mount using hex bolt (C), two flat washers (K) between tube band jack mount and jack plate and nylon nut (H). Tighten nylon nut, then back off 1/4 turn.

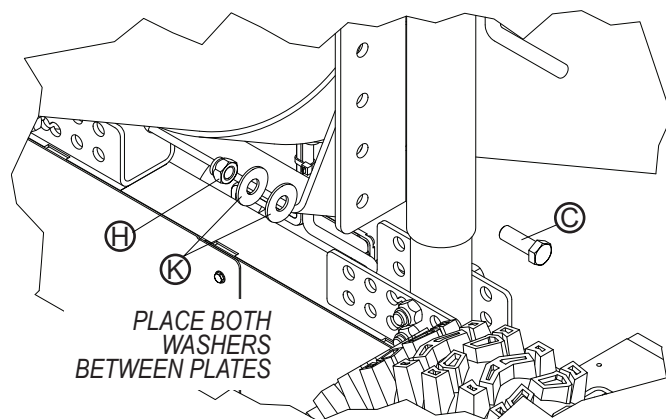

STEP 14: Remove wood block and lower drive wheels to ground.

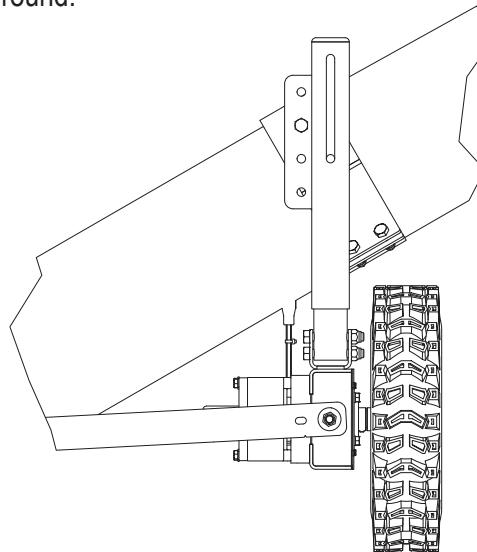

STEP 15: Drill 3/8 inch thru hole using slot as guide. Hole should be centered on flat side of motor mount bracket.

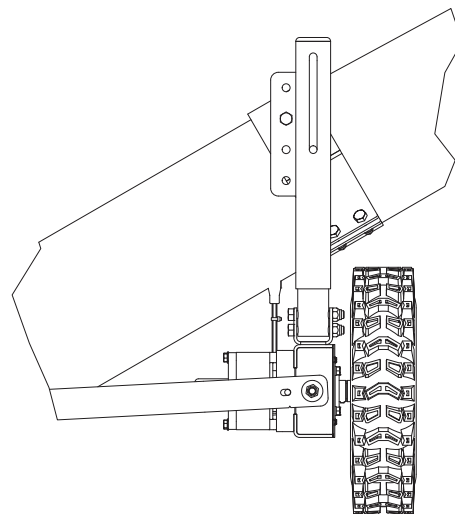

STEP 16: Secure brace using 3/8 inch bolt (B), flat washer (J) and nut (G). Repeat STEPS 14 and 15 for both sides.

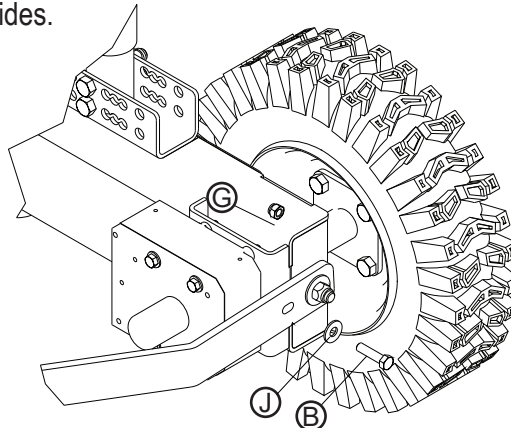

Item	Part #	Description
1.	1128584	Control Panel Mounting Plate
2.	1131774	Control Assembly ShurLink™ w/ShurLink™ LiteALL™
3.	1128572	LiteALL™ w/Magnetic Mount
4.	1131576	5-Channel ShurLink EZR™ Remote
5.	1706751	ShurLink™ PRO™ Replacement Cradle
6.	1706836	USB Charging Cable Type A to C
7.	1131575	ShurLink PRO™ Remote w/Cradle & Charging Cable
A.	1704308	Flanged Cap Screw - #10-24 x 1/2"
L.	1706376	Hose Clamp Fastener Set
M.	1703231	Cable Tie - 8"
N.	1705977	Cable Tie - 60"
Q.	1704751	Wire Harness Lock Pin - 1/4" x 7/8"

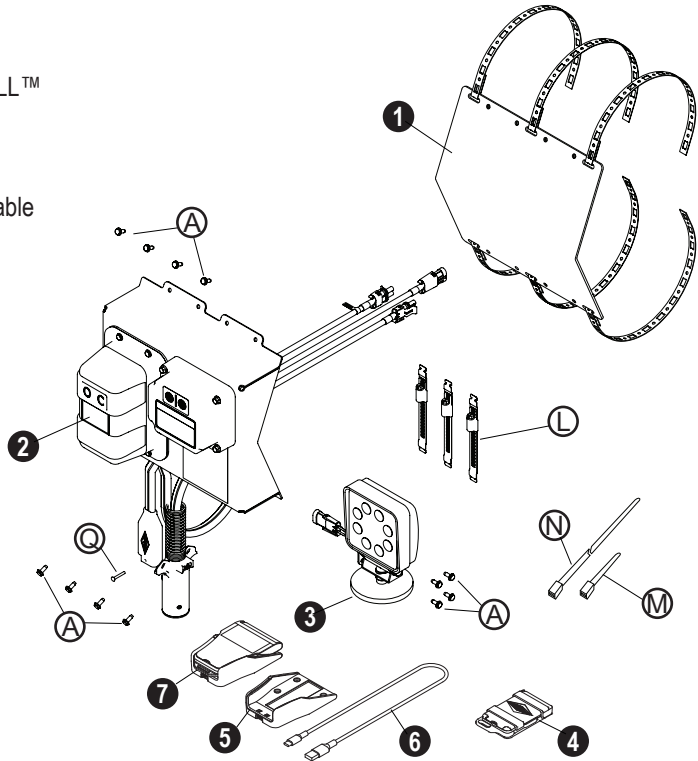

STEP 1: Place control panel mounting plate on auger tube and wrap bands around tube so they overlap.

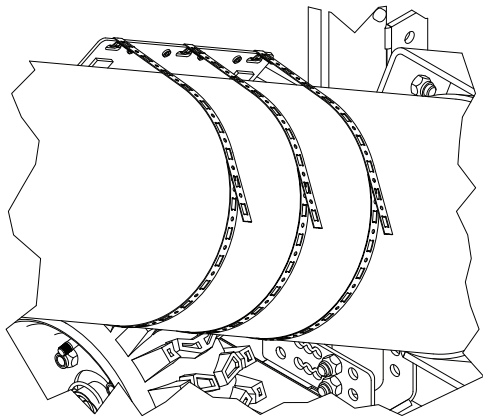

STEP 2: Trim top bands with an aviation snip at holes so new end is approximately 1-1/2 inches above center line of tube.

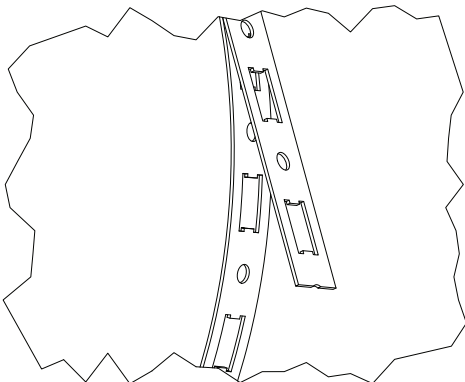

NOTE: Overlap is acceptable, but if bands do not overlap, a max gap of 4-1/2 inches is acceptable between edges of two closest square holes.

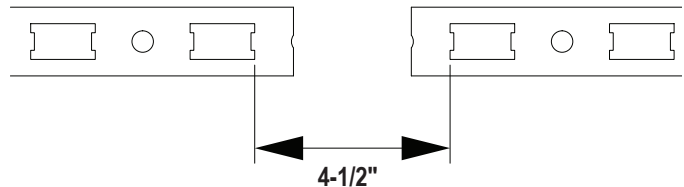

STEP 3: Insert screw half of hose clamp fastener (L) into last square of upper bands.

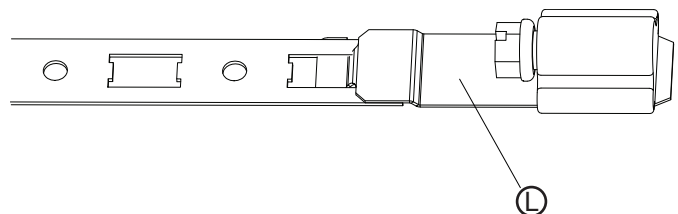

STEP 4: Insert slotted half of hose clamp fastener (L) into square hole of lower bands, approximately 3-1/4 inches from end of screw half of hose clamp fastener (L).

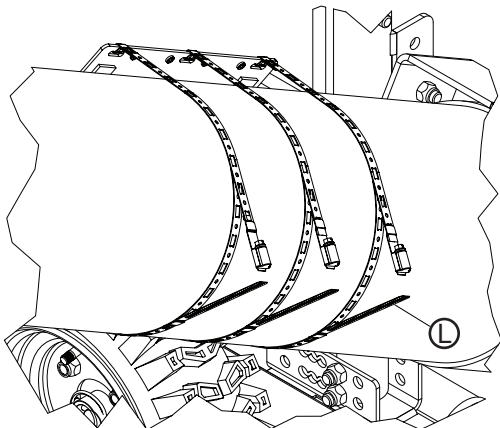

STEP 5: Insert end of slotted fastener into end of screw fastener and tighten each of three bands.

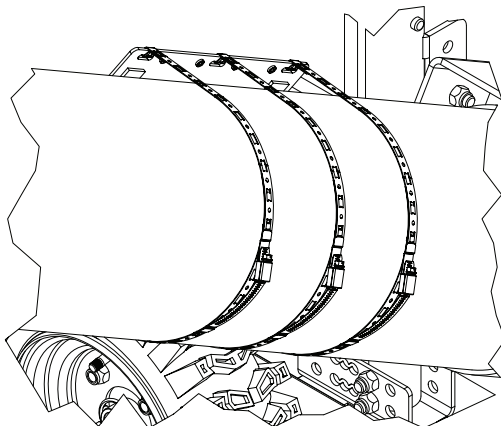

NOTE: Verify location of control pannel will not interfere with storage of swing auger onto side of main auger tube. Adjust accordingly, if necessary.

STEP 6: Insert WeatherPack™ end of LiteALL™ into open hole of bottom of control panel and secure with flange screws (A).

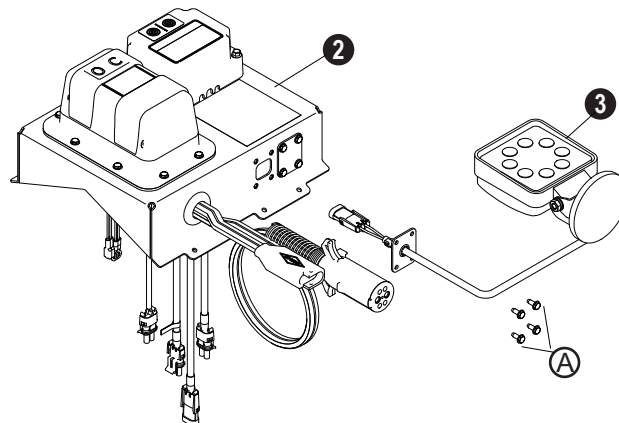

STEP 7: Plug LiteALL™ into mini-module wire.

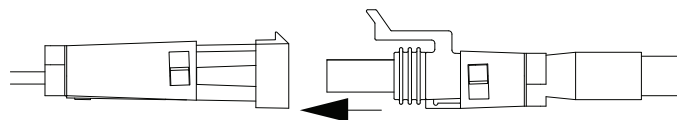

STEP 8: Mount control panel (2) to control panel mounting plate (1) with eight flange screws (A).

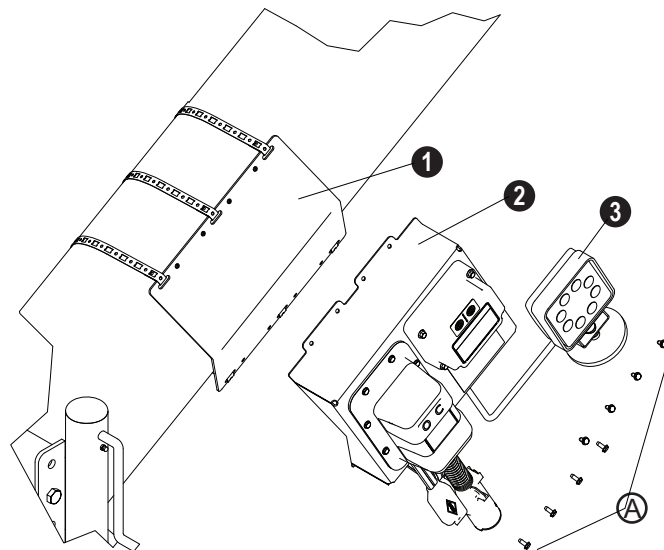

STEP 9: Run SMARTwire™ from rear of control box under swing auger tube and plug female end into male end.

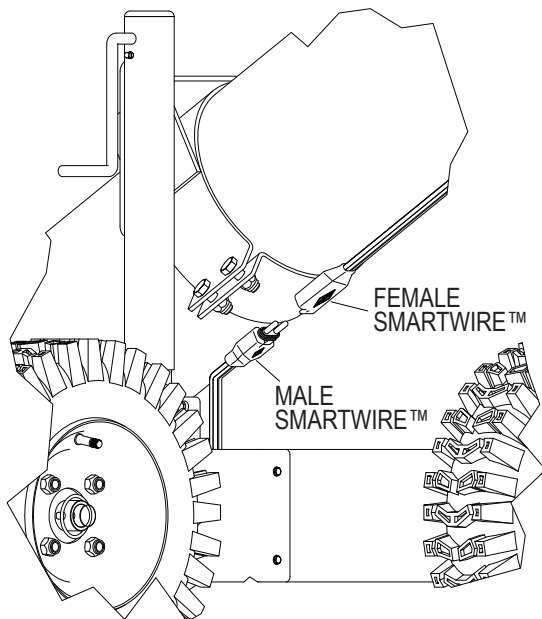

STEP 10: Secure SMARTwire™ to auger tube using 60 inch cable tie (N), leaving enough slack so auger hopper can be raised off ground without putting tension on plug or tie.

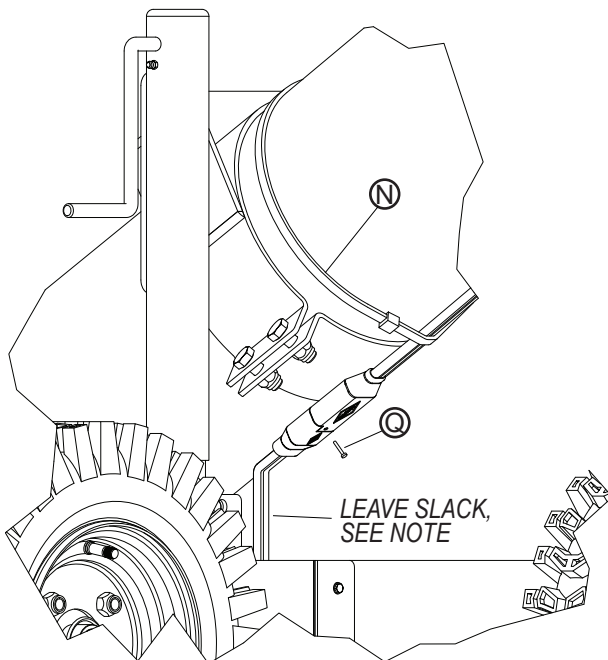

NOTE: Turn handle on jack so it is in fully extended position to ensure enough slack in wire before securing with cable ties.

STEP 11: Working up swing auger tube, gently pull SMARTwire™ snug (under swing auger tube) and secure with 60 inch cable tie (N) at center of tube between first cable tie and discharge box.

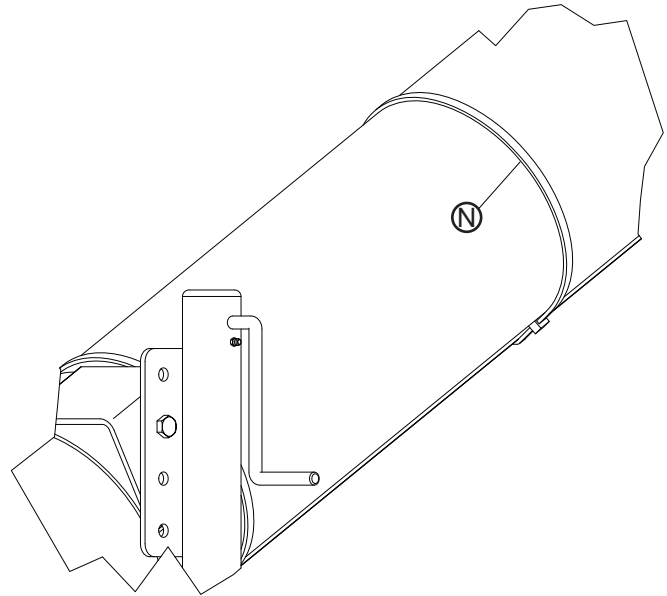

STEP 12: Bind excess wire with 8 inch cable ties (M).



CAUTION

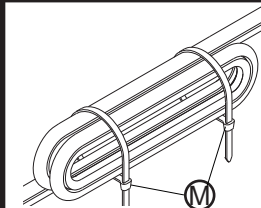

Do not cut SMART-wire™. Bind excess wire with cable ties.

① 11705998 Danger - Pinch Point



STEP 1: Turn jack handle raising drive wheels off ground and push swing auger so swing auger tube and main auger tube are next to each other.

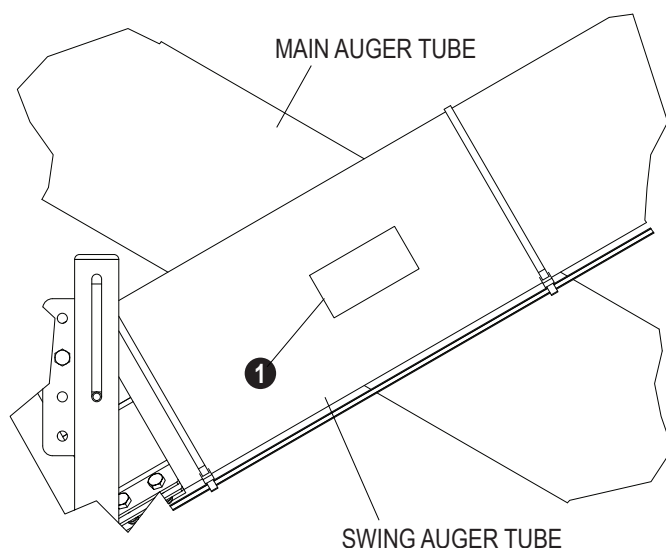

STEP 2: At location where tubes cross, install four Danger - Pinch Point decals on both sides of tubes.



② 1706000 Danger - Automatic Movement



STEP 3: Place Danger - Automatic Movement decal on outside of end and both sides of swing auger hopper.

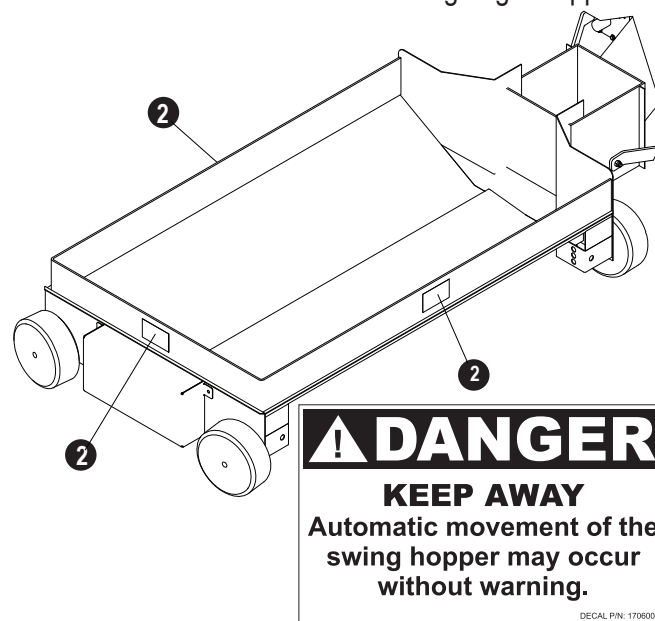

OPERATION INSTRUCTIONS

1. Plug male 2-pole connector into female 2-pole connector on tractor. Route SMARTwire™ so it will not be driven over.
2. Caution: Always verify path of swing auger is clear of obstacles and people before operation.
3. Stand clear of path of swing auger. Use remote of control box to activate motors and verify direction of travel. If swing auger direction of travel is not correct, remove auger control cover and switch green and yellow wires on solenoid.
4. When direction of travel has been verified, run swing auger in both directions, verifying it moves freely and along intended work path.

NOTE: If DriveMaxx™ wheels spin but do not move swing auger, turn jack handle to lower wheels and increase traction.

2309 SHUR-LOK STREET • YANKTON, SD 57078-0713
PHONE: 1-800-SHUR-LOK (800-474-8756) • FAX: 1-605-665-0501
www.SHURCO.com