



**Sidewinder™**

# **OWNER'S MANUAL**

**Electric Side-Flip Tarp System**

PHONE: 1.866.748.7435 | FAX: 1.605.665.0501

2309 SHURLOCK STREET | YANKTON, SD 57078-0713

PHONE: 1.800.327.8287 | FAX: 1.772.287.0431 | STUART, FL

**SHURCO.com**

**! SAFETY INSTRUCTIONS**

At Shurco, your safety is our top priority. Please read and thoroughly understand all instructions before operating all equipment. Failure to READ AND FOLLOW INSTRUCTIONS may result in system failure, property damage, or personal injury. Pay close attention to warnings, cautions, and operating instructions. The hazard symbol **!** alerts users of potentially hazardous conditions, and is followed by Caution, Warning, or Danger messages to indicate risk:

- **Danger** : (Red) Indicates an imminently hazardous situation that, if not avoided, WILL result in death or serious injury.
- **Warning** : (Orange) Indicates a potentially hazardous situation that, if not avoided, COULD result in death or serious injury.
- **Caution** : (Yellow) Indicates a potentially hazardous situation that, if not avoided, MAY result in minor or moderate injury or damage to the system.
- **Notice** : (Blue) Indicates operational notes or other essential information without addressing safety.

Regularly inspect equipment to ensure proper performance. Always repair or replace worn or damaged parts immediately to maintain safety. Safety decals are placed at critical locations on the equipment. Keep these decals clean and legible at all times. Replace any decal that is worn, damaged, painted over or otherwise unreadable. Replacement decals can be obtained by your local Shurco dealer.

- Always wear safety glasses during installation and operation.
- Stay clear of moving parts.
- No other use of Shurco equipment is authorized, except as designed.

**SHUR-CO, LLC TERMS OF SERVICE**

ORDER  
TERMS AND CONDITIONS



WARRANTY



PATENTS



**SERVICE AND DISTRIBUTION CENTERS**

SHURCO.com

LOCATIONS



**MESSAGE TO OWNERS**

Thank you for choosing Shurco for your tarping system needs. We appreciate your confidence in our products. Please note that while this manual provides comprehensive installation and operation instructions, your trailer may require minor adjustments to these guidelines.

Visit [Shurco.com](http://Shurco.com) to access the most current version of these instructions and other important product information.

**QUESTIONS?**  
 CALL OUR HELP LINE:  
**1-866-748-7435**  
 MONDAY-FRIDAY  
 8 AM-5 PM CENTRAL TIME

**MAINTENANCE**

- Daily:
- 1) Check actuator for any damage or cracks
  - 2) Check tarp for excessive wear and tear
  - 3) If equipped check electrical cables for insulation damage
  - 4) Check hydraulic hoses and fittings for damage or leaks
  - 5) Check tarp cables and adjust if loose

- Weekly:
- 1) Check hydraulic cylinder for leaks or wear
  - 2) Check tightness of fasteners
  - 3) Check hinges for excessive wear/looseness
  - 4) If equipped, check hydraulic fluid level in hydraulic reservoir

To prevent rust, paint all exposed metal, such as weld seams and/or metal exposed by grinding or cutting, with corrosion-resistant paint.

**VEHICLE ORIENTATION**

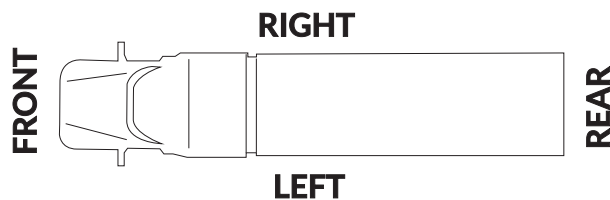

**REQUIRED TOOLS**

1. Wrench Set
2. Ratcheting Socket Wrench
3. Socket Set
4. Hammer
5. Tape Measure
6. Flat Head or Phillips Screwdriver
7. Grinder
8. Pliers
9. Metal Saw
10. Steel Welder
11. Drill Driver with 5/16" Hex Driver
12. Allen Wrench
13. Square

*PLEASE READ THE COMPLETE MANUAL BEFORE  
PROCEEDING WITH INSTALLATION OR USE OF THE TARPING SYSTEM.*

Safety, Legal, and Support Information .....2

Product Guide: Tool Requirements, Maintenance, Vehicle Orientation .....3

Table of Contents .....4

Hardware .....5

Installation Instructions

    1. Actuator Unit Installation.....6

    2. Hydraulic Installation (Electric/Hydraulic).....7

    3. Hinge Installation/Lid Extensions Assembly.....8

    4. Lid Installation .....9

    5. Cable and Tarp Installation.....10

    6. Hydraulic Schematic (Wet Kit).....11

Operation and Maintenance .....12

Replacement Parts .....13



**A** 1801224 Self-Tapping Screw - 1/4" x 3/4"

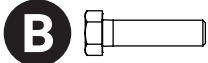

**B** 1800790 Cap Screw - 3/8" x 1-1/2" (Gr. 5)

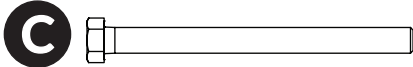

**C** 1705032 Cap Screw - 3/8" x 4-1/2"

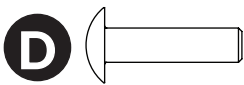

**D** 1800245 Button Head Cap Screw - 1/2" x 2" (SS)

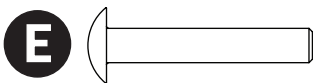

**E** 1800374 Button Head Cap Screw - 1/2" x 3" (SS)

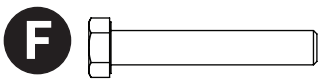

**F** 1800901 Cap Screw - 1/2" x 3" (Gr. 5)



**G** 1800993 Nylock Lock Nut - 3/8"



**H** 1800995 Nylock Lock Nut - 1/2" (Gr. 5)



**J** 1800994 Flat Washer - 3/8"



**K** 1800996 Flat Washer - 1/2"



**L** 1800246 Stainless Steel Flat Washer 1/2"

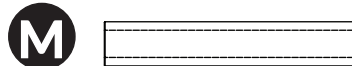

**M** 1809282 Spacer - 5/8" OD x .385" ID x 3.562" LG

**STEP 1:** Locate actuator unit on front of trailer. Stationary rectangular tube should be 8.5" from top of trailer and 9.5" in from drivers side of trailer. Mark mounting holes locations on each of four mounting plates.

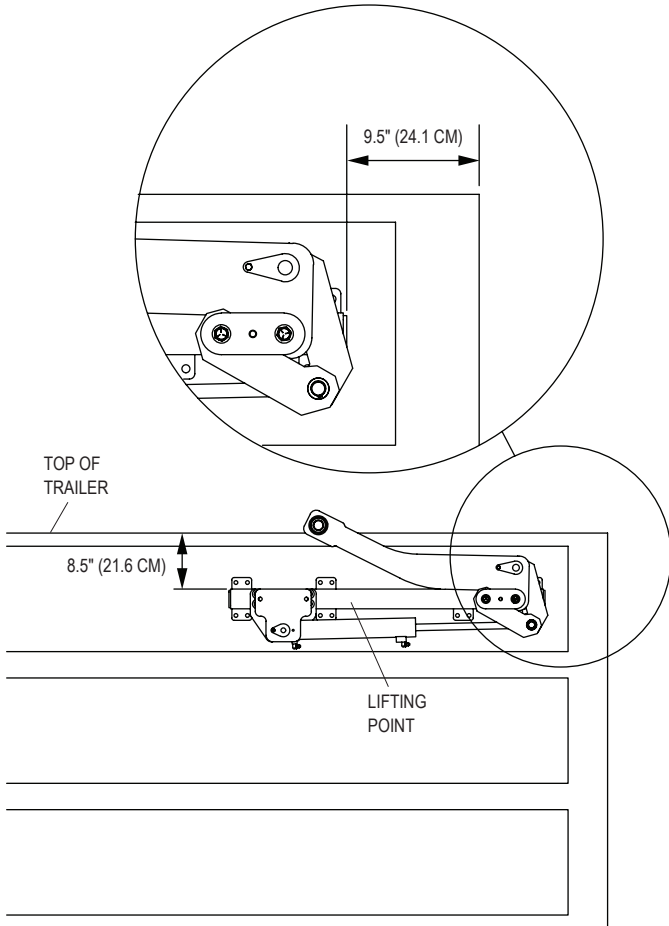

**NOTE:** Actuator unit weighs 134 lbs (64kg). Use over-head lifting device and sling to lift unit. Sling should be wrapped around rectangular mounting bracket. Do not lift from hydraulic cylinder.

Actuator unit may be welded in place to steel trailer, use extreme caution to protect chrome cylinder rod from weld splatter. Will cause permanent damage to cylinder and void systems warranty.

**STEP 2:** Remove actuator unit and drill 17/32" holes in marked locations.

**STEP 3:** Reposition actuator unit and mount using 1/2" Grade 5 bolts or better (bolts not supplied).

**NOTE:** If front wall of trailer is thin aluminum or steel. Reinforce area with backer plate for adequate support.

**STEP 4:** Connect two provided 37.5" hydraulic hoses to cylinder. If using wet kit, refer to page 10 for two longer hoses provided.

**STEP 5:** Install windshield using braces, bolts **D** and **E**, washer **L** and nuts **H**.

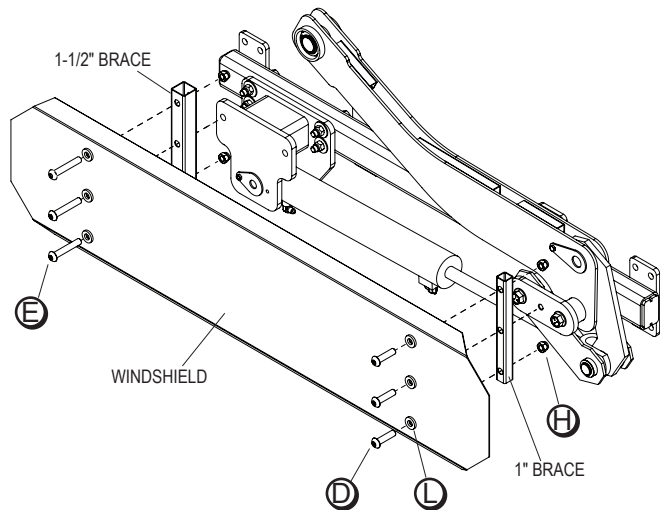

**NOTE:** Skip to page 10 if using wet kit.

**STEP 1:** Using pump mount bracket as template, locate and mark where hydraulic unit will mount - approximately 1' below actuator unit.

**NOTE:** Included hydraulic hoses are roughly 3' long.

**STEP 2:** Remove pump mount bracket and drill 13/32" holes in marked locations.

**STEP 3:** Install pump mount bracket using 3/8" bolts **B**, washers **I** and lock nuts **G**.

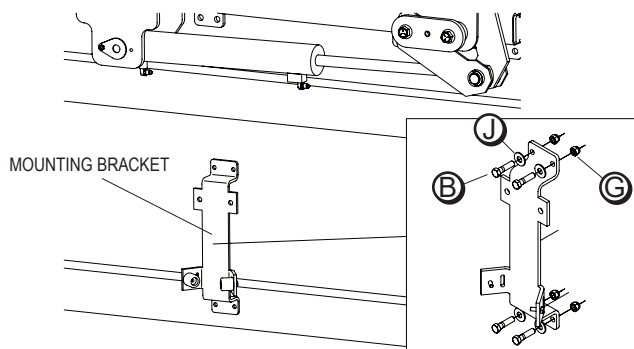

**STEP 4:** Install two rubber bumpers to pump mounts bent tabs and mount pump itself using included 3/8" studs, lock nuts **I** and washers **G**.

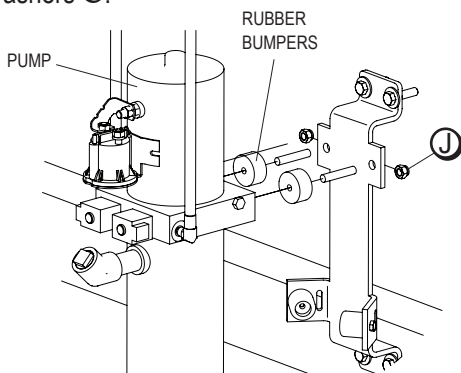

**STEP 5:** Secure bottom of reservoir to mount bracket with included 5-7" adjustable hose clamp.

**STEP 6:** Connect two hydraulic hoses between pump and cylinder. Port C2 to cap end of cylinder and Port C1 to rod end of cylinder. Use hose clips and self-drilling screws **A** to organize and secure hoses to trailer.

**Item Part # Description**

1. 1800925 Elbow 90° - #4 JIC M x #6 ORB M
2. 1800112 Elbow 90° - #4 JIC M x 1/4" NPT M
3. 1801235 Hydraulic Hose - 37-1/2" OAL
4. 1800850 Hydraulic Pump - 12V
5. 1800205 Hydraulic Cylinder - 15-1/2" Stroke

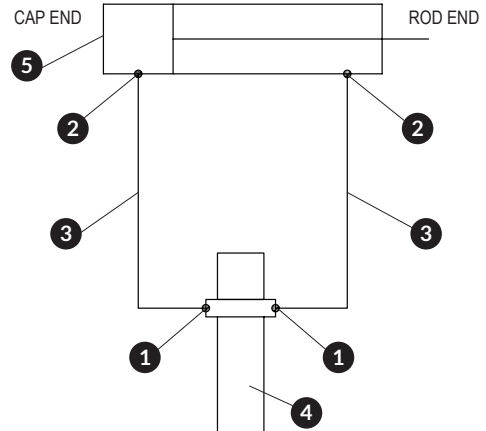

**STEP 7:** Mount control switch using two self-drilling screws **A**. Connect control switch to pump solenoid wiring harness. Secure quick disconnect power cable near control switch. Use hose clips and self-drilling screws **A** to organize and secure cables to trailer.

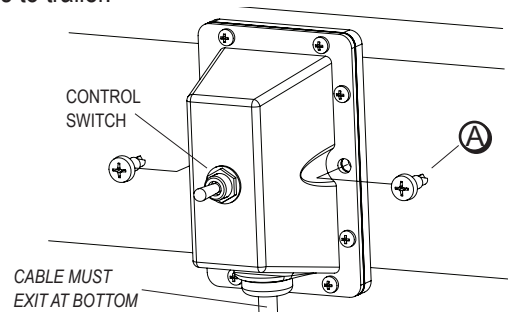

**STEP 8:** Install all provided safety stickers next to control switch. Stickers detailed on page 11.

**STEP 9:** Remove red cap from filler neck on reservoir and fill with approximately three quarts (2.83 Liters) of Dextron Automatic Transmission fluid. Replace red cap with black breather cap.

**NOTE:** Under normal operating conditions fluid will last life of pump. In extreme dirty or wet conditions, check fluid every four to six months and change as needed.

**STEP 10:** Connect a 12V power supply to quick disconnect power cable and cycle cylinder ten times to remove any air in system. Failure to do this may result in personal injury and/or damage to Sidewinder™ system.

## HINGE INSTALLATION

**STEP 1:** Lid hinges may be mounted either by welding or by bolts. If welding, move to Step 2. If bolting, skip to Step 3.

**STEP 2:** Locate front, center and rear hinge positions. Weld hinges in place to steel trailer. Use caution to protect chrome cylinder rod from weld splatter. Skip Steps 3-5 if hinges are welded.

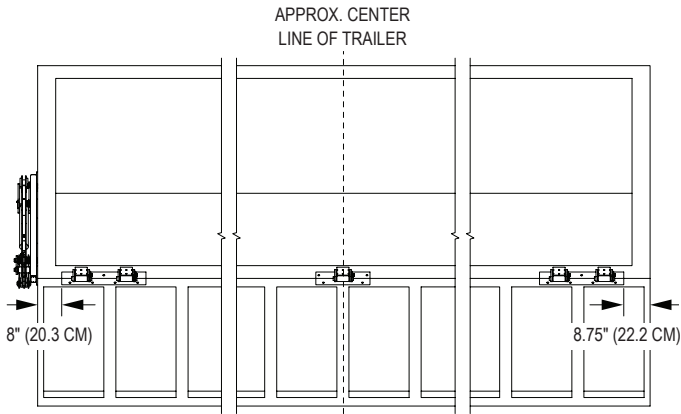

**NOTE:** For trailers with center support above top rail, offset center hinge to either side of support.

**STEP 3:** Locate front, center and rear hinge positions. Mark hinge hole positions.

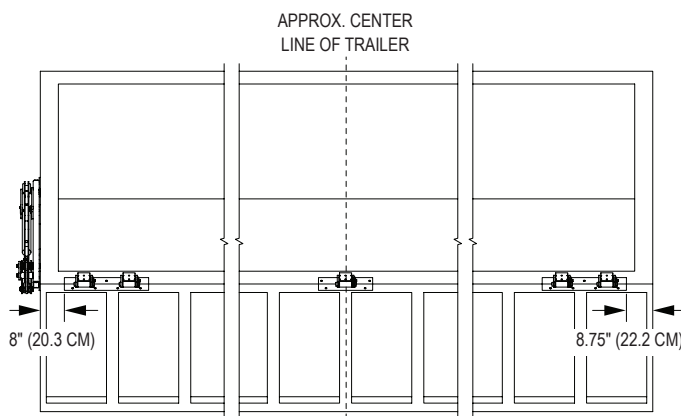

**STEP 4:** Remove hinges and drill 17/32" (13.5mm) holes in marked locations on side of top rail. Drill and tap marked locations on top of top rail for 1/2" bolts.

**STEP 5:** Reposition hinges and mount using 1/2" Grade 5 bolts or better (bolts not supplied).

## LID EXTENSION ASSEMBLY

**STEP 1:** Starting with front lid, noted by having a C-channel and additional gussets, measure outside-to-outside width at front of trailer at top rail. Slide extension tube into front lid matching this measurement then weld in place.

**NOTE:** Orientation of angle will be pointing toward ground when lid is mounted to trailer.

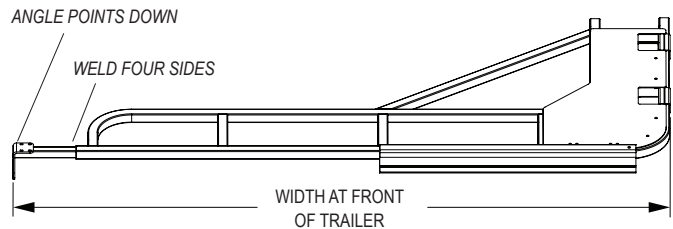

**STEP 2:** Repeat process measuring outside-to-outside width at center and rear of trailer. Adjust extension tubes for center and rear lids respectively.

**NOTE:** Center lid extension will not have a cable attached, but will get two turn-buckles at a later step. The rear lid has no C-channel or additional gussets as compared to front lid.

**STEP 1:** Install roller and shaft onto actuator arm using c-clip and shim.

**NOTE:** This may slide as needed through actuator arm in order to line up with front lid roller track.

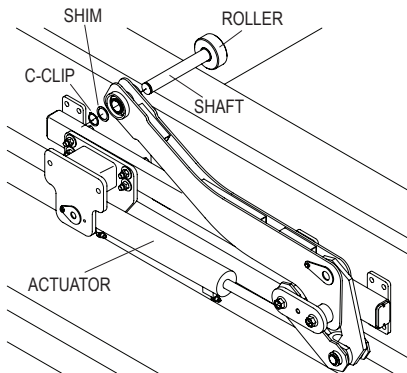

**STEP 2:** With actuator arm near fully open position, slide front lid roller track over roller and pivot into alignment. Attach to hinges with bolts (F), washers (K) and lock nuts (H).

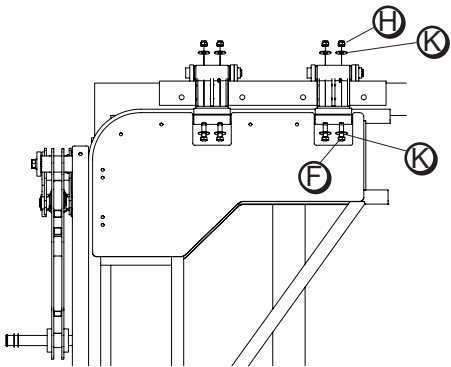

**STEP 3:** Install spacer (M) into roller track using bolt (C), washers (J) and lock nut (G).

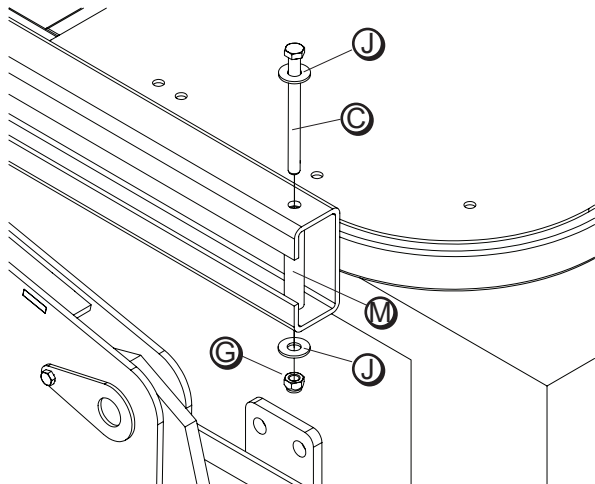

**STEP 4:** Repeat Step 2 for center and rear lids using two and four bolts respectively to connect to their hinges.

**STEP 5:** With all three lids in closed position, measure distance between lids and add 8" to get the final length of each ladder section.

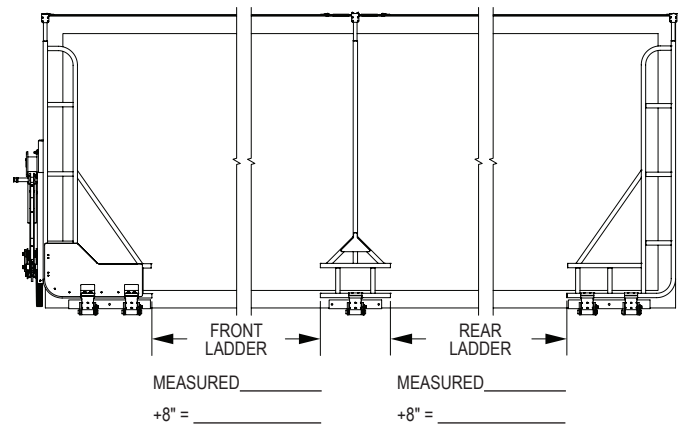

**STEP 6:** Assemble two to three ladder sections and "H" connectors to obtain final length of front lid from previous step. If needed, cut ladder to length. Ensure cut is at least 4" (101.6mm) away from nearest rung so there is enough remaining to insert into lids.

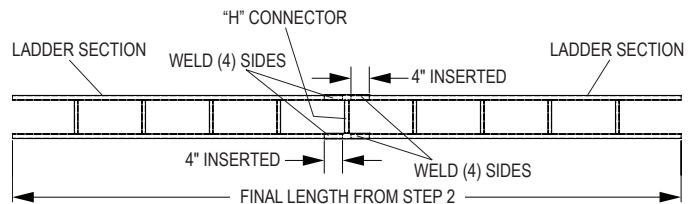

**STEP 7:** Mark ladder 4" (101.6mm) in on each end. Lift and slide front ladder section into front and center lids until each has been inserted a minimum of 4". Weld all four sides of each ladder to front and center lids. Note underside will be welded in Step 8.

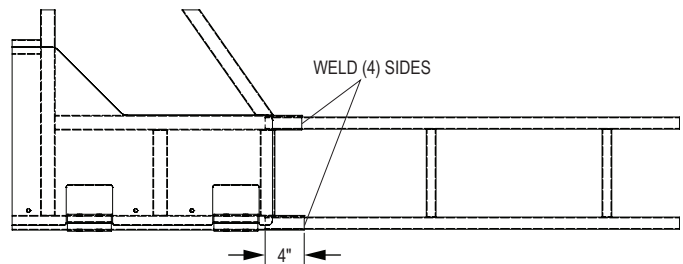

**STEP 8:** Repeat process for rear ladder using final length for the rear ladder from Step 5. Open system to access underside of ladder to finish welding.

**STEP 1:** Open lid to lay flat on side of trailer. Locate two 30' cables with turnbuckles. Fully extend turnbuckles. Hook each turnbuckle into center lid extension.

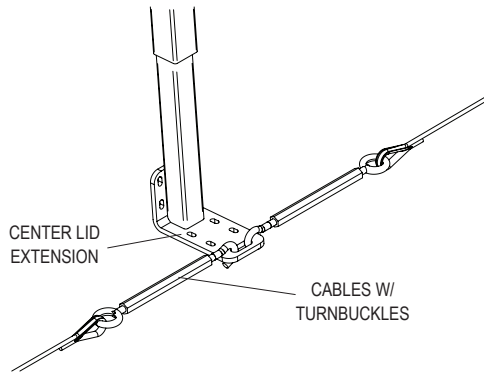

**STEP 2:** One cable will attach to front lid, second cable will attach to rear lid. These are attached using 3/16" timble and two 3/16" cable nuts.

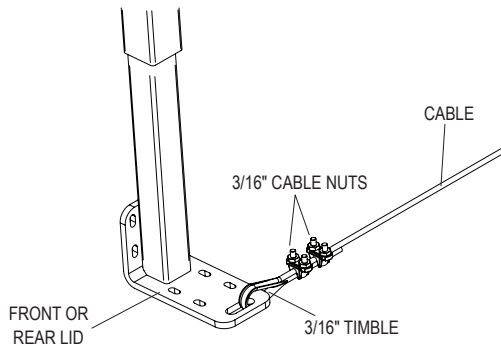

**STEP 3:** Tighten both turnbuckles evenly until cable are taught. Do not over tighten turnbuckles as this may cause excess stress on lids and hinges. Apply small amount of liquid thread locker to turnbuckle jam nuts and tighten to prevent loosening.

**STEP 4:** Lay out mesh tarp in a clear open area to verify dimensions and tarp condition.

**STEP 5:** With lid still in fully open position, start attaching tarp to cable only. Start at front lid using zip ties every 12-18" (30.5-45.7cm).

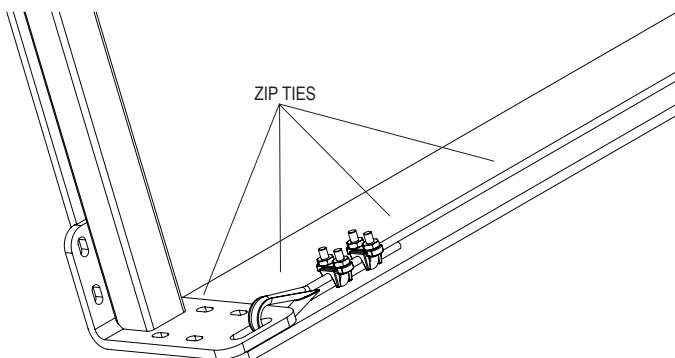

**STEP 6:** Carefully actuate lid to vertical position, ensuring mesh does not snag or catch anything. In vertical position, tarp should hang from cable down to lid's ladders. Attach tarp to ladder using provided zip ties, every 12-18" (30.5-45.7cm).

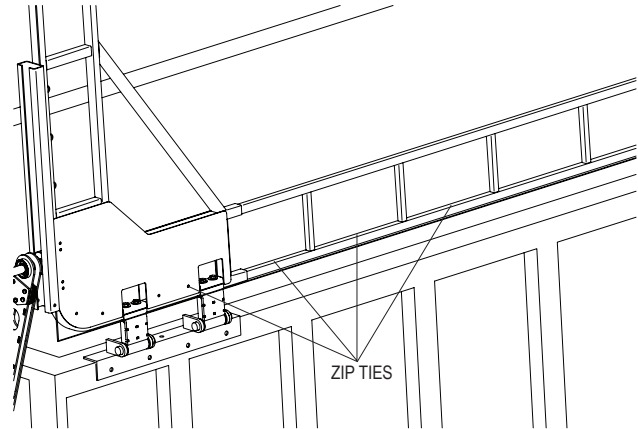

**STEP 7:** Attach tarp along front lid with provided zip ties. Use holes and D-ring on front lid.

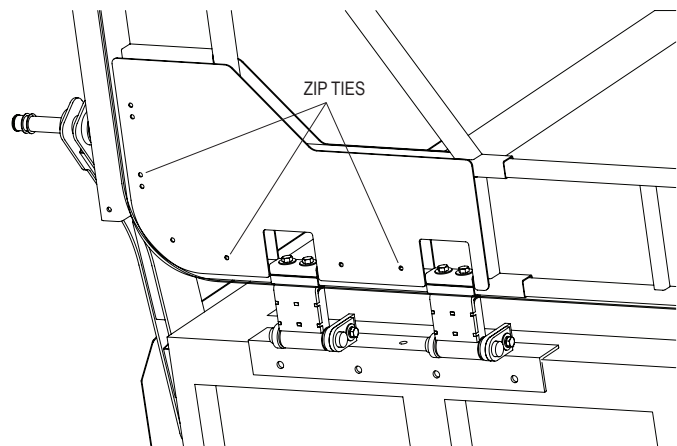

**STEP 8:** For trailers shorter than tarp length, cut tarp at back of trailer with approximately 6-8" (15.2-20.3cm) of extra material to be folded over and zip tied along rear lid.

**NOTE:** If there is a large gap between rear lid and trailer rear door, do not cut any of excess tarp materials. Roll up the excess and zip tie to rear lid to help cover gap.

**NOTE:** 2" wide splicing tape can be used to protect tarp by wrapping a small length around any sharp points on system of truck.



**⚠ CAUTION**

Before operating this or any tarper, check your surroundings for any overhead power lines, tree limbs or other obstruction in path of tarper travel from open to close and back.

**⚠ CAUTION**

Before servicing or repairing Sidewinder™ system, disconnect power to components from vehicle's battery or other power source.

**NOTE:** Noise level is less than 72 dB(A).

**To Open Tarp**

Press UP on switch lever to open lid.

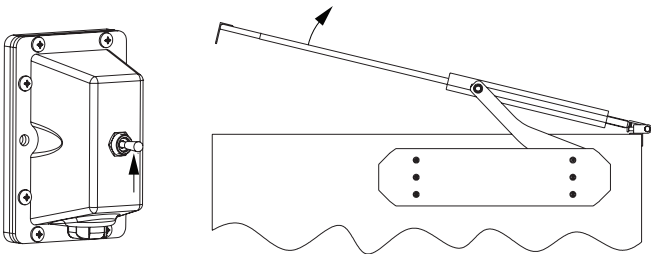

**To Close Tarp**

Press DOWN on switch lever to open lid.

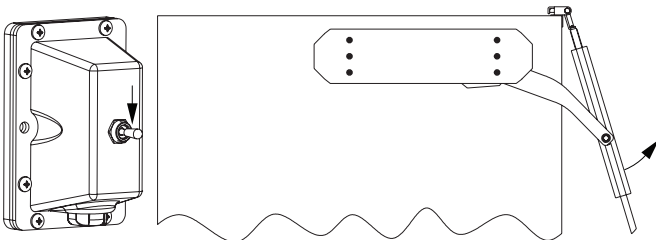

**NOTICE**

**SIDEWINDER™  
MAINTENANCE SCHEDULE**

**DAILY**

- Check tarp for rips or holes, use zip ties to make repairs. Timely repairs will prevent rips or holes from getting larger and help extend the life of tarp.

**BI-WEEKLY**

- Maintain proper cable tensions by tightening turnbuckles as necessary.
- Ensure tarp is secured along all sides, center leg and cables.

**MONTHLY**

- Grease the actuator, grease fittings are accessible through notches in the plastic motor cover.
- Check the tightness of all nuts and bolts on the entire system.
- Check to ensure that split collars are tight.
- Inspect electrical wires and connectors for damage or exposed wires.

**SEMI-ANNUALLY**

- Check fluid hydraulic pump. Remove the plastic motor cover over the hydraulic pump - if fluid is not at the top of the fill port, refill with Dexron automatic transmission fluid.

**VISIT SHURCO.COM OR CALL 1-800-474-8756**

For technical assistance, warranty information, instruction manual or ordering information.

DECAL P/N: 1808425

**⚠ CAUTION**

BEFORE OPERATING TARPING MECHANISM, ENSURE ADEQUATE CLEARANCE ABOVE AND ALONGSIDE TRAILER. ACCOUNT FOR FULL WIDTH AND LENGTH OF TARP.

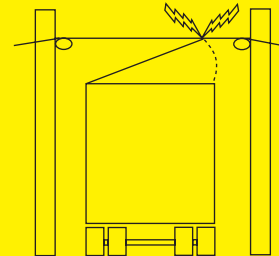

DO NOT USE A SOLID OR HEAVY TARP ON THE SIDEWINDER™. THE SYSTEM WAS DESIGNED FOR USE WITH THE TARP SUPPLIED. THE USE OF ANY OTHER TARP MAY CAUSE SYSTEM FAILURE, INJURY, AND VOID THE WARRANTY. IF YOU NEED A REPLACEMENT TARP OR HAVE QUESTIONS ABOUT USING A DIFFERENT STYLE TARP, PLEASE CONTACT: SHURCO AT 800-474-8756

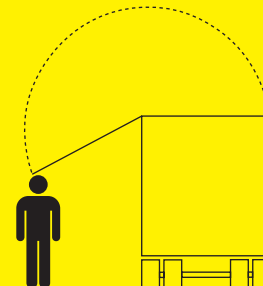

POSITION TARP FLUSH AGAINST SIDE OF TRAILER BEFORE LOADING. ENSURE TARP IS RESTING COMPLETELY ON TOP OF TRAILER PRIOR TO MOVING TRAILER.

DECAL P/N: 1808424

**SIDEWINDER™**

Item	Part #	Description
1.	1800286	Backhoe Actuator Assembly - Left Hinge (includes items 4; 5; 6; 14; 16; 17; 22; 23; 24; 25; 2 of 3, 7, 8, 9, 10, 26, & 27; 4 of 21)
2.	1801907	Backhoe Actuator Assembly - Right Hinge (includes items 4; 5; 6; 14; 16; 17; 22; 23; 24; 25; 2 of 3, 7, 8, 9, 10, 26, & 27; 4 of 21)
3.	1800276*	Gearlock Bearing
4.	1800282	Cylinder Mount
5.	1800287	Base Tube Weldment
6.	1800292	Cylinder Base Pin Assembly
7.	1800880	External Retaining Ring - 1-1/2" Dia.
8.	1801707*	External Retaining Ring - 1" Dia.
9.	1800112	Hydraulic Fitting - #4 JIC x 1/4" NPT 90°
10.	1800180	Short Link Assembly (includes 11; 12; 13)
11.	1800497	Bushing - 1" ID x 1-1/4" OD x 1"
12.	1800879	Bushing - 1-1/2" ID x 1-3/4" OD x 1"
13.	1800181	Short Link
14.	1800190	Long Link w/Bushing (includes 11; 12; 15)
15.	1800191	Long Link
16.	1800194	Pin Connector
17.	1800197	Rotating Arm Assembly (includes 19; 20; 2 of 7, 18 & 21)
18.	1800156	Bushing - 1-1/2" ID x 1-3/4" OD x 2"
19.	1800199	Rotating Arm
20.	1800203	Bushing - Turned
21.	1800204	Shim - 1-1/2" ID x .047"
22.	1800205	Hydraulic Cylinder - 2-1/2" x 15-1/4"
23.	1800207*	Short Link Spacer
24.	1800208	Long Link Pin
25.	1800211	Long/Short Link Pin
26.	1800232	Hex Bolt w/Serrated Washer - 5/8" 1-1/2"
27.	1800250*	Shim - 1" ID x 1-1/2" OD x .047
28.	1800289	Front Lid Assembly
29.	1800293	Wind Deflector
30.	1800294*	Deflector Brace - 1-1/2"
31.	1800295*	Deflector Brace - 1"
32.	1800335	Roller Shaft Assembly - 10" (includes 33; 34; 35; 36; 54; 2 of 27)
33.	1800331	Roller Shaft
34.	1800977*	Shim - 1-1/4" ID x .047"
35.	1800978*	Retaining Ring - 1-1/4"
36.	1800177	Roller - UHMW
37.	1800374*	Stainless Button Head Screw - 1/2" x 3"
38.	1800872	Cable Nut - 3/16"
39.	1800923	Loop Strap 3/4"
40.	1801379*	Loctite™ - 5ML - Tube
41.	1801510*	Bumper Stripes - UHMW
42.	1800897	Center Lid Extension
43.	1801236	Rubber Bumper - 1-1/2" Round
44.	1801276	Cable w/Turnbuckle - 30'
45.	1801342*	Solenoid Cover - SL
46.	1801495*	Clamp Hose - 4-1/16" x 5"
47.	1800412	Pump Mount Bracket
48.	1800884	Rear Lid Assembly
49.	1800885	Center Lid Assembly
50.	1800889	Ladder Assembly
51.	1800945	Pump Assembly - 12V (includes 52; 53; 54; 58; 2 of 43, 55, 56, & 57)
52.	1800458*	150-Amp Circuit Breaker
53.	1800850	Hydraulic Pump - 12V M3551

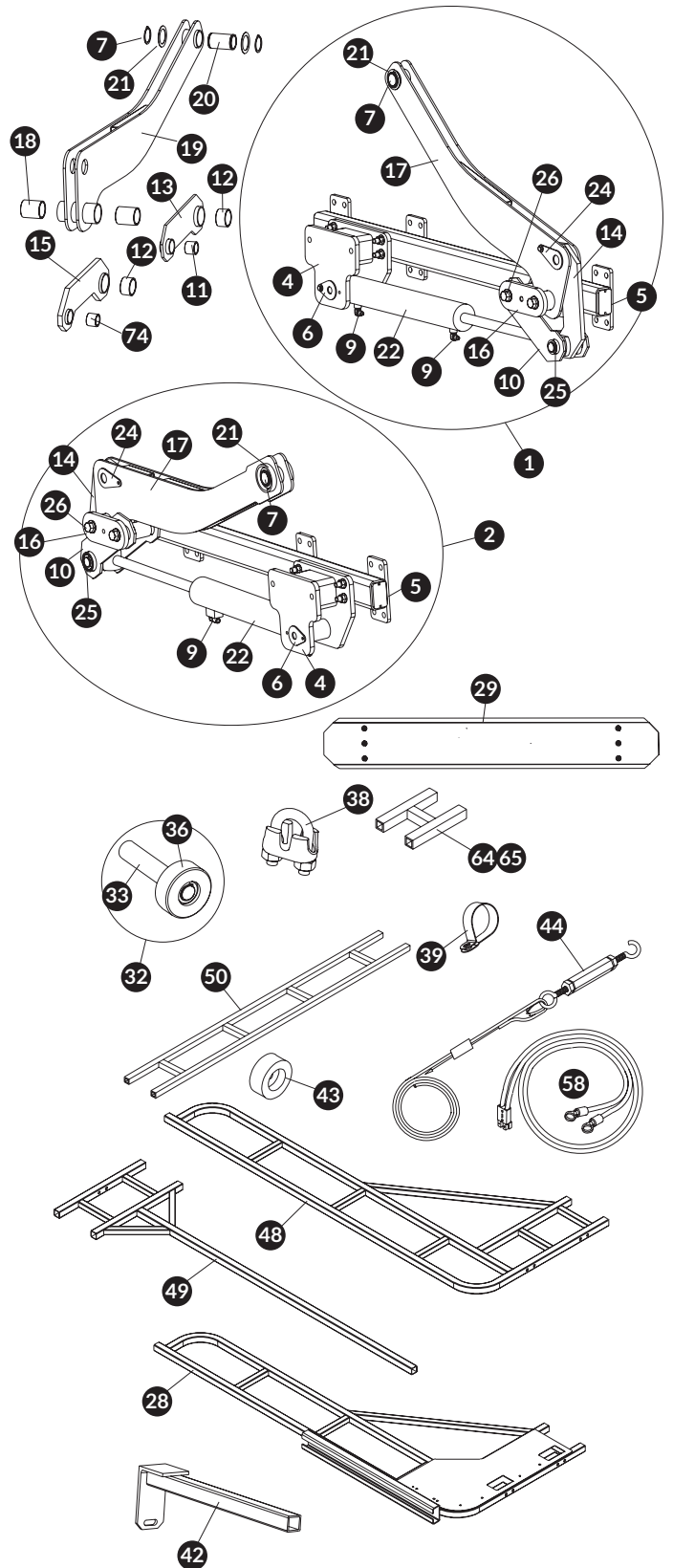

\*These items are NOT shown in the drawing: numbered for future reference

Continued to Next Page. ->

**SIDEWINDER™ (CONT.)**

Item	Part #	Description
54.	1800906	Clamp 5" to 7"
55.	1800925	Male Hydraulic Fitting - #6 x 90°
56.	1800926*	Stud - 3/8" x 2-5/8"
57.	1801235	Hydraulic Hose - 37-1/2" OAL
58.	1801237	Wiring Harness - 9' (includes 59; 62; 2 of 60)
59.	1800149*	Connector - 120 Amp - 4 Ga.
60.	1800158*	Ring Terminal - 4 Ga. x 3/8" Stud - Battery
61.	1800221*	Dual-Conductor Wire - 4 Ga. - 9'
62.	1801238	Wiring Harness - 16' (includes 59; 62; 2 of 60)
63.	1800220*	Dual-Conductor Wire - 4 Ga. - 16'
64.	1801233*	4H Connectors (includes 4 of 65)
65.	1800891	Connector - H
66.	1801599	Front & Rear Hinge Assembly - Low Profile (includes 72; 2 of 67, 70; 4 of 68)
67.	1800606	Hinge Pin Assembly
68.	1800860	Flanged Bushing - 1-1/4" ID
69.	1801600	Rear Hinge - Low Profile
70.	1801603	Hinge Lid - Low Profile
71.	1801601	Center Hinge Assembly - Low Profile (includes 67; 69; 70; 2 of 68)
72.	1801602	Center Hinge - Low Profile
73.	1800315*	Hose Bundle Wrap - 1/2"
74.	1800497	Bushing - 1" ID x 1-1/4" OD x 1/2"
75.	1808766	External Retaining Ring - 1"
76.	1801430*	Sidewinder™ Wet Kit

\*These items are NOT shown in the drawing; numbered for future reference

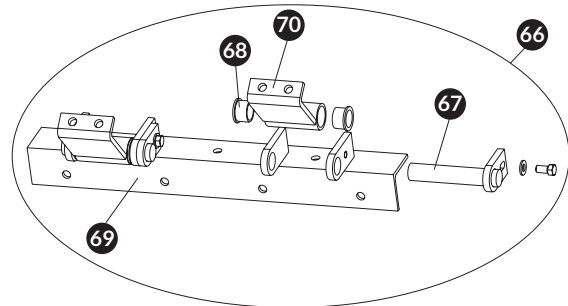
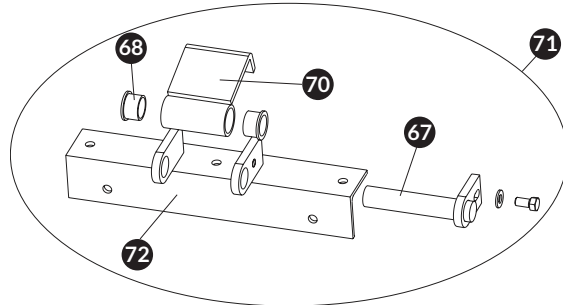
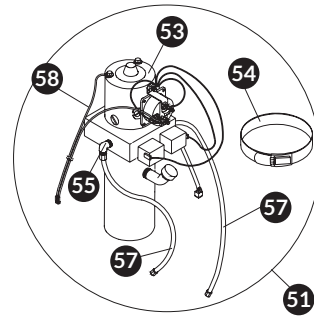



---

2309 SHURLOCK STREET | YANKTON, SD 57078-0713  
PHONE: 1.866.748.7435 | FAX: 1.605.665.0501

PHONE: 1.800.327.8287 | FAX: 1.772.287.0431 | STUART, FL

**SHURCO.com**

---