

Item	Part #	Description
1.	1702439	Pull Bar 1-Piece
2.	1809833	Pull Bar End Cap
3.	1701595	End Plug
4.	1800017	Shaft Collar
5.	1800782	Eye Bolt
6.	1800765	Hex Nut 5/16"

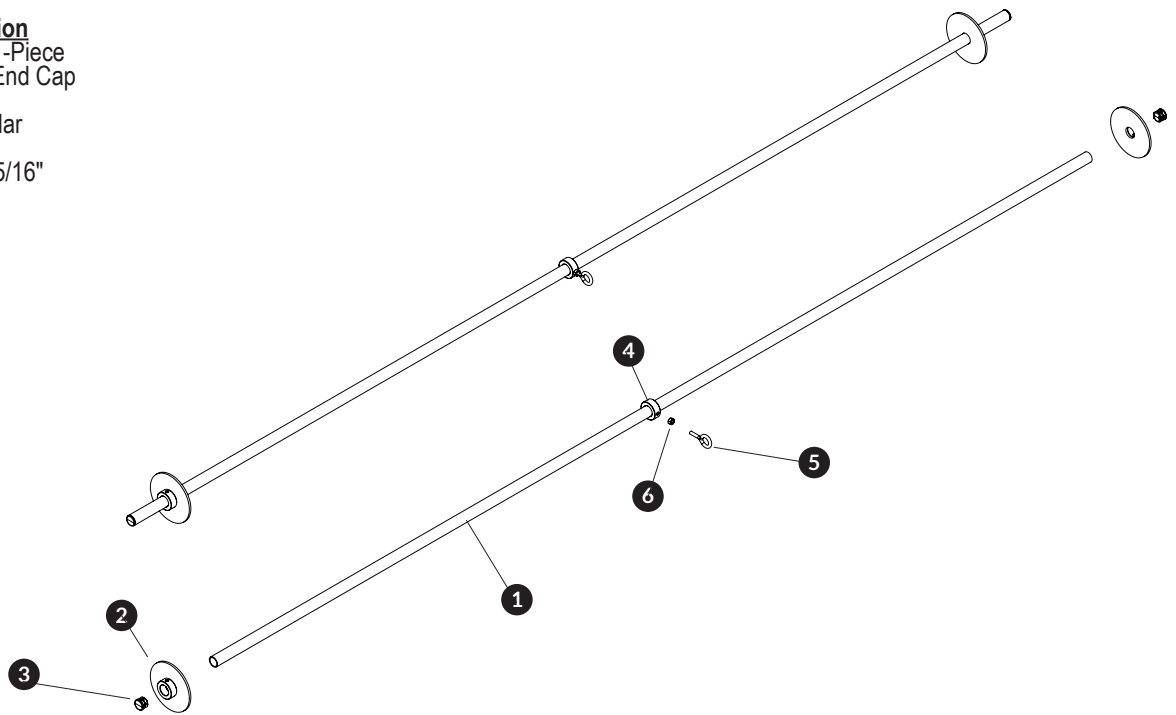

STEP 1: Slide shaft collar 4 to center of pull bar 1 and tighten eye bolt 5 in place with nut 6.

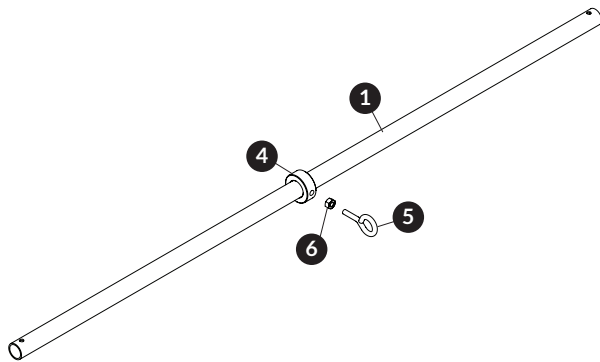

STEP 2: Slid assembled pull bar into tarp pocket. Cut 1/4" slot in center of pocket for eye bolt 5 to slide through. Place end caps 2 center pull pull bar on trailer. Tighten set screws after applying Locktite™. Trim pull bar if needed. Insert plastic end plugs 3.

