





Shur-Lok™ E-Series Open-Top Van

OWNER'S MANUAL

3-Inch Electric Roll Tarp Conversion

Download the ShurLink™ App

 <p>Shurlink Shur-Co, LLC ★★★★★ 5.0 Free</p>	 <p>iOS</p>	 <p>Android</p>
--	--	--

PHONE: 1.866.748.7435 | FAX: 1.605.665.0501

2309 SHURLOCK STREET | YANKTON, SD 57078-0713

SHURCO.COM



**SAFETY INSTRUCTIONS**

At Shurco™, your safety is our top priority. Please read and thoroughly understand all instructions before operating all equipment. Failure to READ AND FOLLOW INSTRUCTIONS may result in system failure, property damage, or personal injury. Pay close attention to warnings, cautions, and operating instructions. The hazard symbol  alerts users of potentially hazardous conditions, and is followed by Caution, Warning, or Danger messages to indicate risk:

- **Danger** : (Red) Indicates an imminently hazardous situation that, if not avoided, WILL result in death or serious injury.
- **Warning** : (Orange) Indicates a potentially hazardous situation that, if not avoided, COULD result in death or serious injury.
- **Caution** : (Yellow) Indicates a potentially hazardous situation that, if not avoided, MAY result in minor or moderate injury or damage to the system.
- **Notice** : (Blue) Indicates operational notes or other essential information without addressing safety.

Regularly inspect equipment to ensure proper performance. Always repair or replace worn or damaged parts immediately to maintain safety. Safety decals are placed at critical locations on the equipment. Keep these decals clean and legible at all times. Replace any decal that is worn, damaged, painted over or otherwise unreadable. Replacement decals can be obtained by your local Shurco™ dealer.

- Always wear safety glasses during installation and operation.
- Stay clear of moving parts.
- No other use of Shurco™ equipment is authorized, except as designed.

Shur-Co LLC. TERMS OF SERVICE

ORDER
TERMS AND CONDITIONS



WARRANTY



PATENTS

**SERVICE AND DISTRIBUTION CENTERS**

SHURCO.com

LOCATIONS



MESSAGE TO OWNERS

Thank you for choosing Shurco™ for your tarping system needs. We appreciate your confidence in our products. Please note that while this manual provides comprehensive installation and operation instructions, your trailer may require minor adjustments to these guidelines.

Visit Shurco.com to access the most current version of these instructions and other important product information.

QUESTIONS?

CALL OUR HELP LINE:

1-866-748-7435

MONDAY-FRIDAY
8 AM-5 PM CENTRAL TIME

MAINTENANCE

- Spray all bearings with penetrating oil as needed.
- Brush springs with steel brush weekly to remove dirt and spray with penetrating oil.
- Tighten loose bolts.
- Make sure arms are not hitting ends of box. Replace damaged/bent arms.
- Replace worn or broken springs.
- Replace/repair worn or damaged tarp.

VEHICLE ORIENTATION

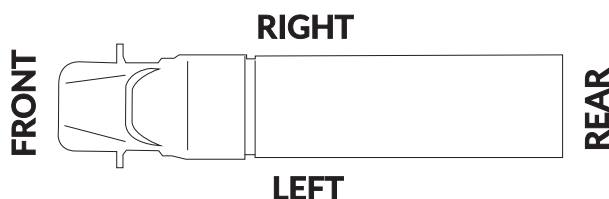

REQUIRED TOOLS

- Welder Steel, Aluminum Optional
- Hammer
- Center Punch or Transfer Punch
- #3 Phillips Insert Bit
- #2 Phillips Insert Bit
- Air or Electric Impact Wrench (9/16" and 3/4" deep socket)
- 7/16", 9/16", 1/2", 3/4" Combination Wrench
- 7/32", 1/4", 21/64", 5/16", 3/8", 1/2" Drill Bit
- 1/4" Drive with Swivel
- 1/2" Socket
- 15" Socket Drive Extension
- Standard/Flathead Screwdriver
- Utility Knife
- Ratchet
- Hack Saw (metal cutter)
- Pliers
- Grinder
- Tape Measure

NOTICE: This installation requires two people for safe and efficient completion.



Inspect your kit to ensure all parts and hardware are included before starting installation.

*PLEASE READ THE COMPLETE MANUAL BEFORE
PROCEEDING WITH INSTALLATION OR USE OF THE TARPING SYSTEM.*

Safety, Legal, and Support Information	2
Product Guide: Tool Requirements, Maintenance, Vehicle Orientation	3
Table of Contents	4
Hardware	5
Installation Instructions	
1. Roll Tube Preparation	6
2. Rear Arm & Pivot Bracket	7
3. Front Arm & Pivot Bracket	10
4. Motor Mounting	12
5. U-Clamps	14
6. Wiring- Motor, Dual Conductor Socket & Receiver	15
7. Operation	17
Electric to Manual Power Conversion	18
Manual Operation & Tarp Tensioning	19
Replacement Parts	20

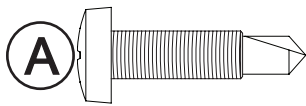

1705198 Self-Drilling Screw - 1/4" x 1"

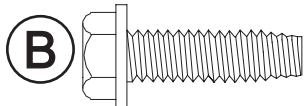

1704338 Self-Tapping Screw - 1/4" x 1"

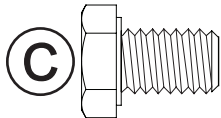

1703171 Hex Head Cap Screw - 5/16" x 1/2"

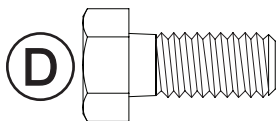

1701045 Cap Screw - 5/16" x 3/4"

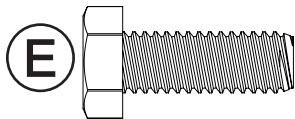

1702926 Cap Screw - 5/16" x 7/8"

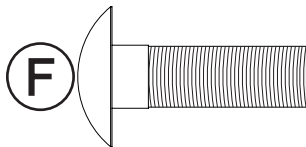

1704237 Carriage Bolt - 5/16" x 1" - Grade 5

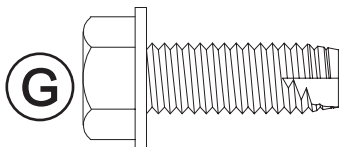

1700400 Self-Tapping Screw - 3/8" x 1"

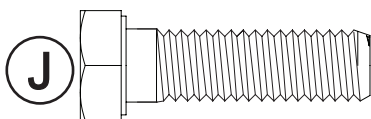

1702891 Cap Screw - 3/8" x 1-1/4"



1704264 Cap Screw - 3/8" x 2" - Grade 8

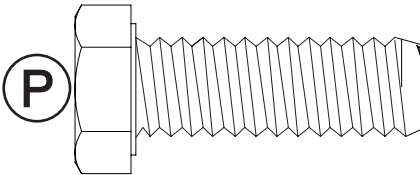

1702075 Hex Head Cap Screw - 1/2" x 1-1/2"



1701543 Nylon Lock Nut - 1/4"



1704297 Nylon Lock Nut - 5/16"

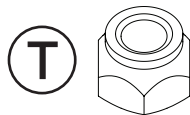

1700419 Nylon Lock Hex Nut - 5/16"

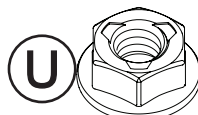

1704946 Top Lock Flanged Nut - 5/16"



1701580 Nylon Lock Nut - 3/8"

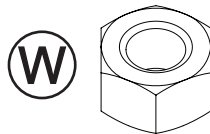

1700407 Hex Nut - 3/8"



1700416 Lock Nut - 1/2"

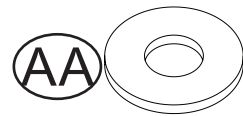

1700427 Flat Washer - 1/4"

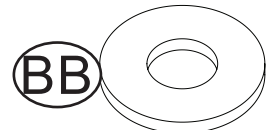

1700428 Flat Washer - 5/16"

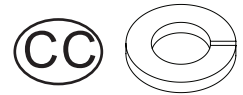

1700433 Lock Washer - 5/16"



1700434 Lock Washer - 3/8"

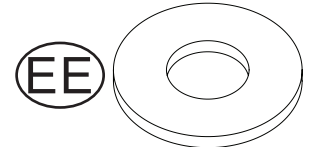

1700429 Flat Washer - 3/8"

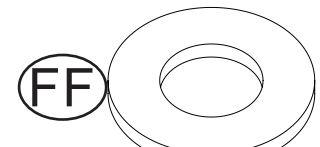

1703373 Flat Washer - 1/2"

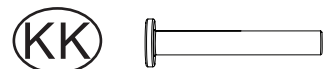

1704751 Harness Lock Pin - 1/4" x 7/8"

STEP 1: REMOVE HAND CRANK

- Using the hand crank, close the tarp over the box until the roll tube hangs below the latchplates.
- Remove the existing hand crank from the end of the roll tube.

NOTICE: Store the hand crank arm in the truck or mount it to the trailer. (Example - above kingpin, near the apex.)

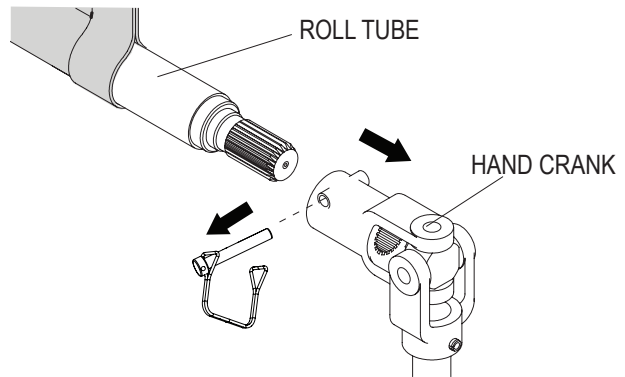

IMAGE 110

STEP 2: PREPARE EXISTING ROLL TUBE

- Remove any existing returns, such as a cable return, bungee return, etc.
- Remove all U-clamps and screws from the roll tube, and retain them for later use.

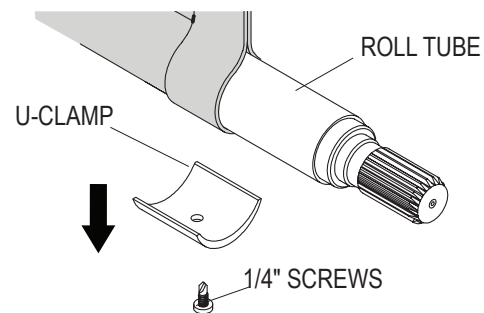

IMAGE 111

STEP 3: CUT ROLL TUBE

- Determine roll tube length by adding 9 inches to the trailer's length.
- Mark and cut the **roll tube** to the required roll tube length. Grind edges until smooth.

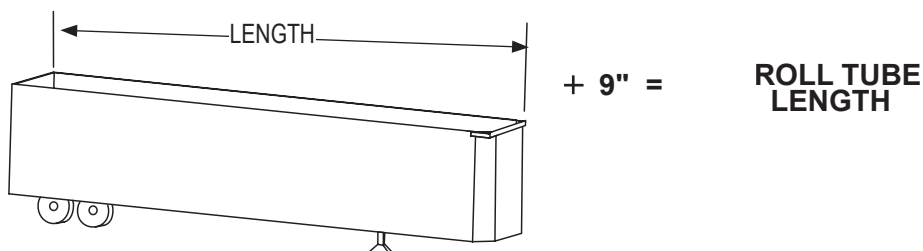

IMAGE 112

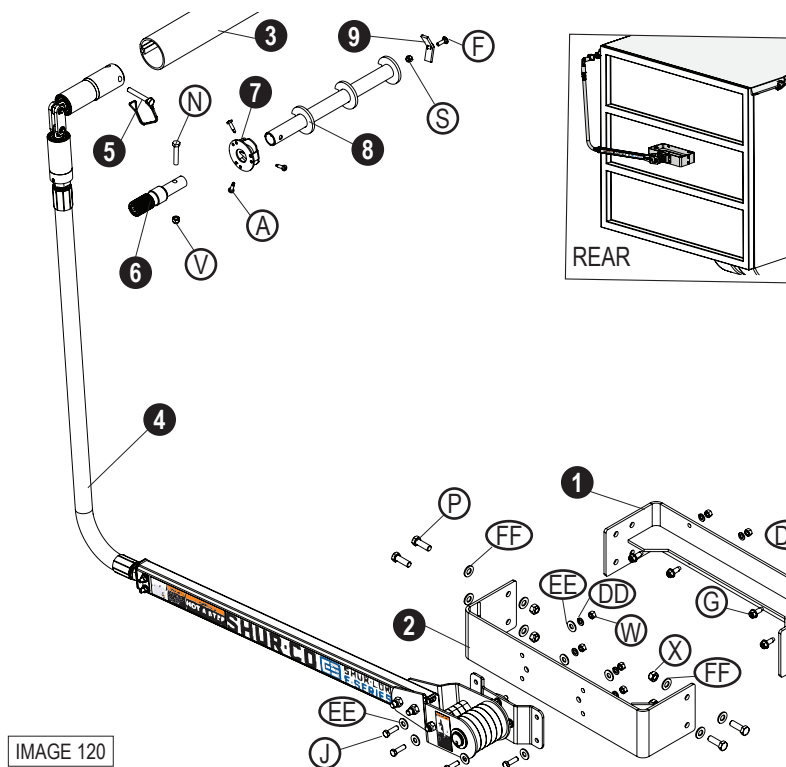

IMAGE 120

Item	Part #	Description
1.		Rear Pivot Bracket
2.		Front Pivot Bracket
3.		Roll Tube
4.	1133194	Rear Arm Assembly
5.	1700526	Wire Lock Pin - 3/8" x 2-1/2"
6.	1121111	Manual Crank Spline - 3"
7.	1121040	Roll Tube End Cap - Rear
8.	1121039	Rear Cartridge - 3"
9.	1118194	Cartridge Clamp
A.	1705198	Self-Drilling Screw - 1/4" x 1"
F.	1704237	Carriage Bolt - 5/16" x 1"
G.	1700400	Self-Tapping Screw - 3/8" x 1"
J.	1702891	Hex Head Cap Screw - 3/8" x 1-1/4"
N.	1704264	Hex Head Cap Screw - 3/8" x 2" Grade 8
P.	1702075	Hex Head Cap Screw - 1/2" x 1-1/2"
S.	1704297	Nylon Lock Nut - 5/16"
V.	1701580	Nylon Lock Nut - 3/8"
W.	1700407	Hex Nut - 3/8"
X.	1700416	Lock Nut - 1/2"
DD.	1700434	Lock Washer - 3/8"
EE.	1700429	Flat Washer - 3/8"
FF.	1703373	Flat Washer - 1/2"

Rear Arm & Pivot Bracket Installation

STEP 1: ASSEMBLE CARTRIDGE

Loosely fasten the **cartridge clamp (9)** to the **cartridge (8)** using **bolt (F)** and nut **(S)**.

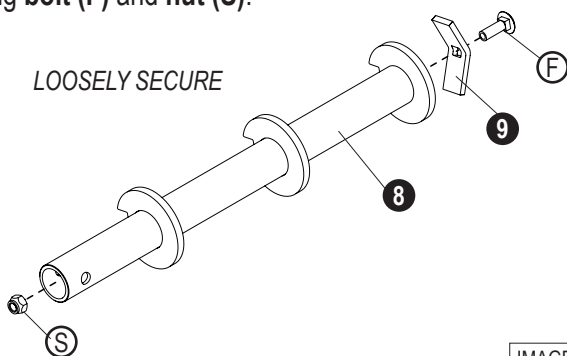

IMAGE 121

STEP 2: INSERT CARTRIDGE

Insert the **cartridge assembly** into the roll tube.

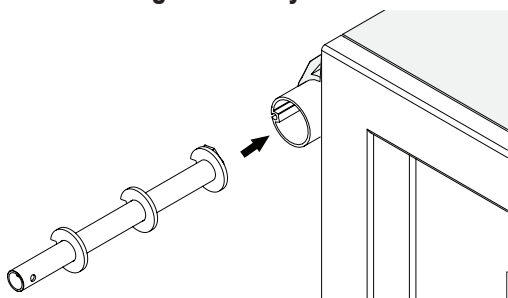

IMAGE 122

STEP 3: SECURE CARTRIDGE

- Adjust the **cartridge assembly** so that it extends 1-5/8 inches beyond the end of the roll tube.
- Tighten nut **(S)** to 20 ft-lb.

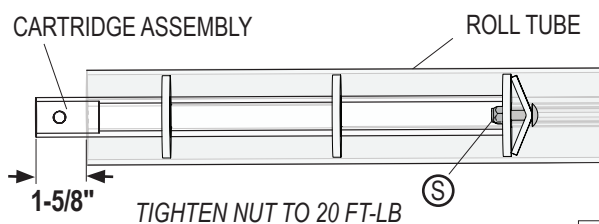

IMAGE 123

STEP 4: SECURE CAP

Insert the **cap (7)** onto the end of the **cartridge (8)** and into the roll tube. Fasten three **screws (A)** through the roll tube and into the three flats on the side of the cap.

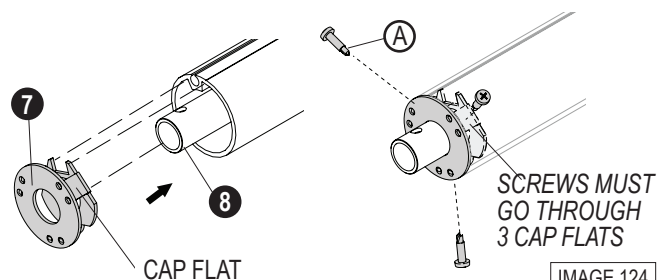

IMAGE 124

STEP 5: SECURE SPLINE

Insert the **spline (6)** into the end of the **cartridge (8)** and secure with **screw (N)** and **nut (V)**.

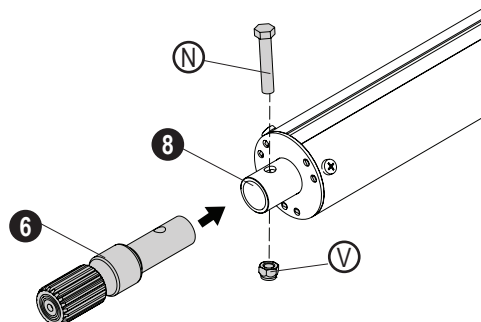

IMAGE 140

STEP 6: DETERMINE BRACKET LOCATION**REAR TRAILER**

Center the **rear bracket (1)** according to trailer length:

- 102-inch trailer - center 46-inches down from highest point.
- 96-inch trailer - center 48-inches down from highest point.

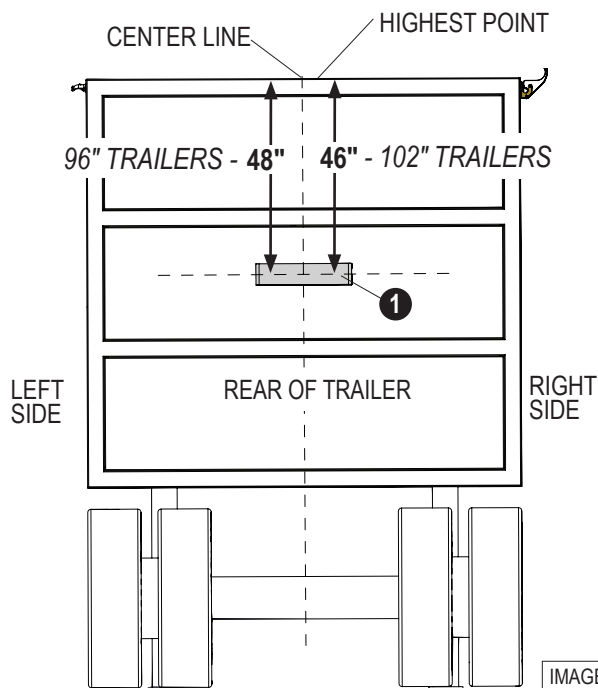

IMAGE 141

NOTICE: Before drilling any holes, make sure arm has a clear pathway to operate.

STEP 7: MOUNT REAR BRACKET

- Hold **rear bracket (1)** at location identified in Step 6. Mark hole locations.
 - When possible, remove existing rivets to use existing holes.
 - If required, drill 21/64-inch holes in trailer.
- Secure **rear bracket (1)** with four **screws (G)**, four **washers (DD)** and four **nuts (W)**.

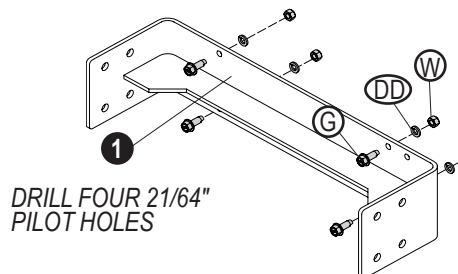

IMAGE 142

STEP 8: SECURE BRACKETS

Install the **front bracket (2)** to the **rear bracket (1)** using the inner set of holes (closest to the trailer). Secure them with four **screws (P)**, eight **washers (FF)**, and four **nuts (X)**, as shown in Image 143.

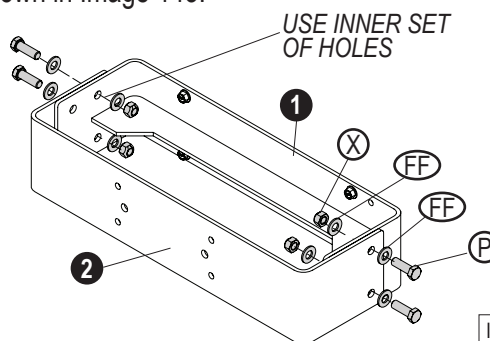

IMAGE 143

! WARNING

Flex arms are under tension while torsion springs are engaged. Use caution when assembling and disassembling arms. Failure to read and follow instructions may result in serious injury or death.

! CAUTION

The arm assembly must be installed with the warning decals facing away from the trailer and in plain view.

! WARNING

Do not stand or climb on the flex arm. Doing so may result in a fall or impact, causing serious injury or death.

STEP 9: ATTACH REAR ARM TO BRACKET

- Align holes on the rear **arm plate (4)** with the holes in the front **bracket (2)**. Keep arm parallel to the front of the trailer.
- Place **washers (EE)** and hex cap **screws (J)** onto the plate and insert them into the bracket hole.
- From inside the bracket, attach washers (**EE**), lock washers (**DD**) and nuts (**W**) onto the end of the hex cap screws.

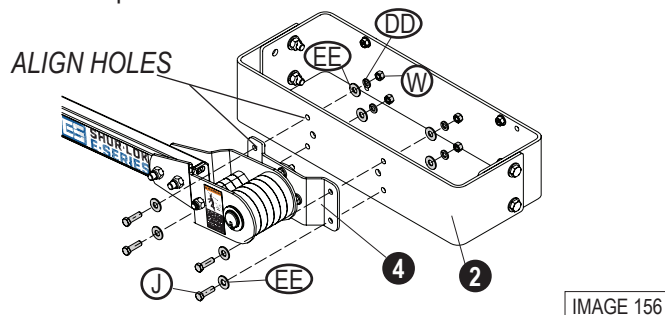
**STEP 10: SECURE REAR ARM**

- Lift the rear arm (4) and slide the coupling onto the spline (6).
- Insert the pin of the wire lock (5) through the arm to secure it into place.

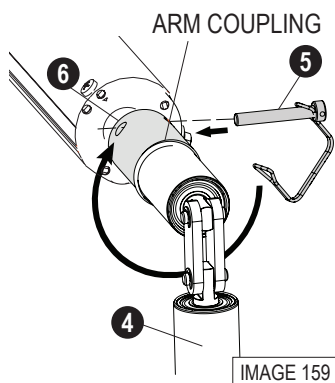
**STEP 11: VERIFY REAR ARM PLACEMENT**

At the rear of the trailer, ensure the rear arm (4):

- Lines up straight, parallel to the face panel.
- Remains at a right angle to the roll tube.

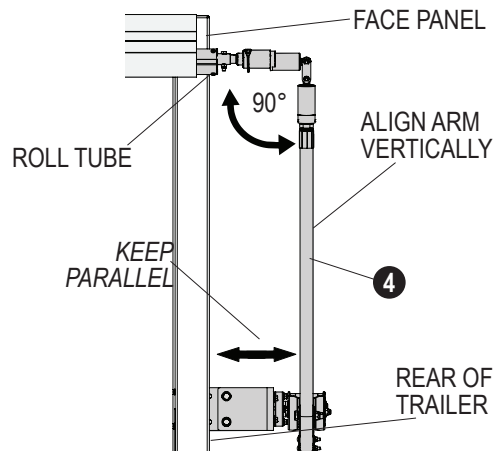

Item	Part #	Description
A.	1705198	Self-Drilling Screw - 1/4" x 1"
F.	1704237	Carriage Bolt - 5/16" x 1"
G.	1700400	Self-Tapping Screw - 3/8" x 1"
J.	1702891	Hex Head Cap Screw - 3/8" x 1-1/4"
P.	1702075	Hex Head Cap Screw - 1/2" x 1-1/2"
S.	1704297	Nylon Lock Nut - 5/16"
W.	1700407	Hex Nut - 3/8"
X.	1700416	Lock Nut- 1/2"
DD.	1700434	Lock Washer - 3/8"
EE.	1700429	Flat Washer - 3/8"
FF.	1703373	Flat Washer - 1/2"

Item	Part #	Description
1.		Rear Pivot Bracket
2.		Front Pivot Bracket
3.		Roll Tube
4.		Front Arm Assembly
5.	1118194	Cartridge Clamp
6.	1122264	Drive Shaft - 3" Roll Tube

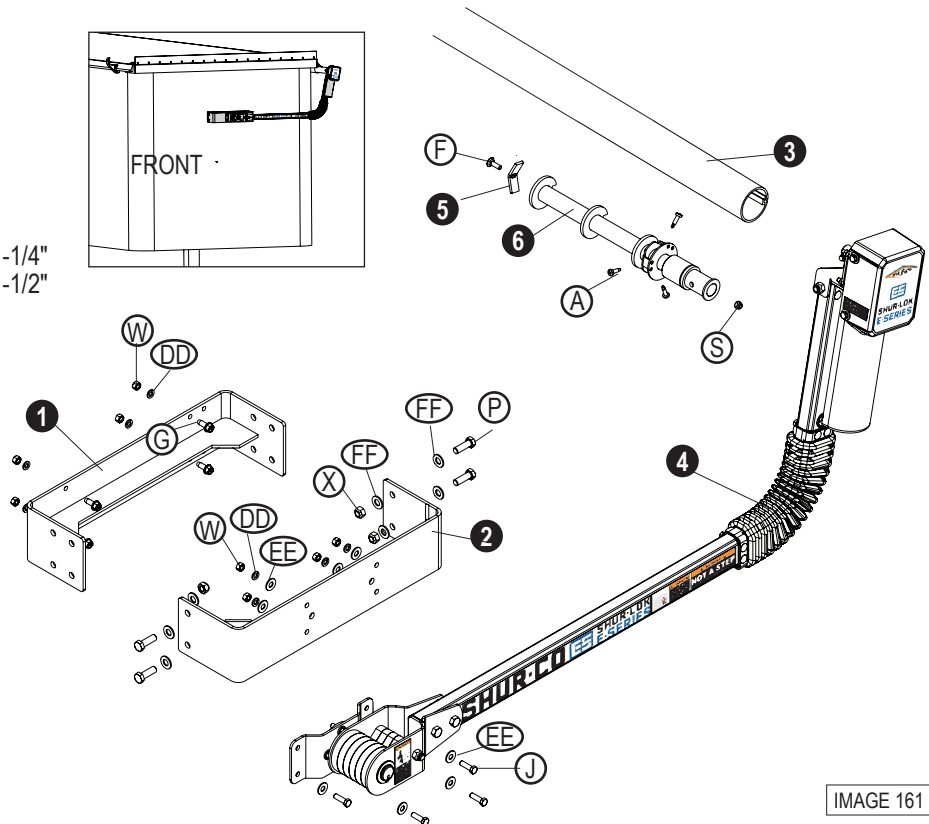

Front Arm & Pivot Bracket Installation

STEP 1: ASSEMBLE CARTRIDGE

Loosely fasten the **cartridge clamp (5)** to the **drive shaft (6)** using **bolt (F)** and **nut (S)**.

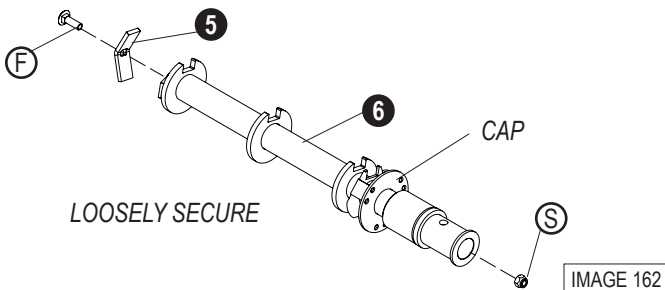

STEP 2: INSERT DRIVE SHAFT

Insert the **drive shaft (6) assembly** into the **roll tube (3)**.

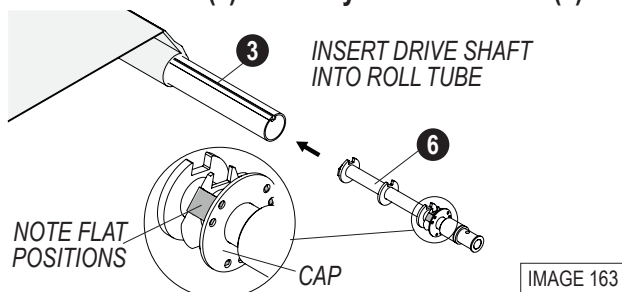

STEP 3: SECURE DRIVE SHAFT

Align the **drive shaft (6)** so that it is 5-1/4" beyond the end of the roll tube and tighten **nut (S)** to 20-ft-lb.

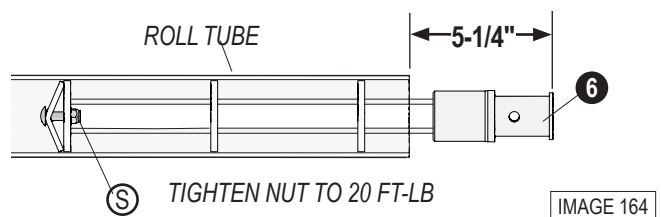

STEP 4: SECURE CAP

Fasten three **screws (A)** through the roll tube and into the three flats on the side of the cap.

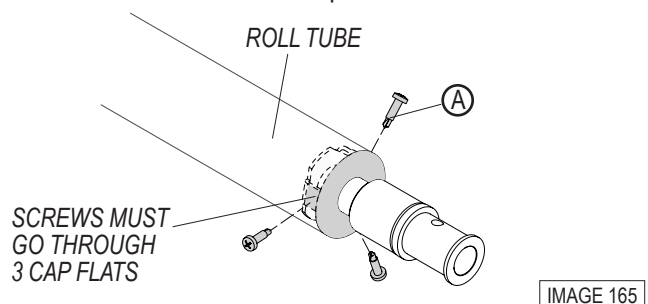

STEP 5: BRACKET PLACEMENT**FRONT TRAILER**

Center the **rear bracket (1)** according to trailer length:

- 102-inch trailer - center 28 inches down from highest point.
- 96-inch trailer - center 30 inches down from highest point.

NOTICE: Before drilling any holes, make sure arm has a clear pathway to operate.

NOTICE: Wire lengths are predetermined. Before installing SMARTwire™ components, review and confirm wire routing so wires reach components with ample room for connection.

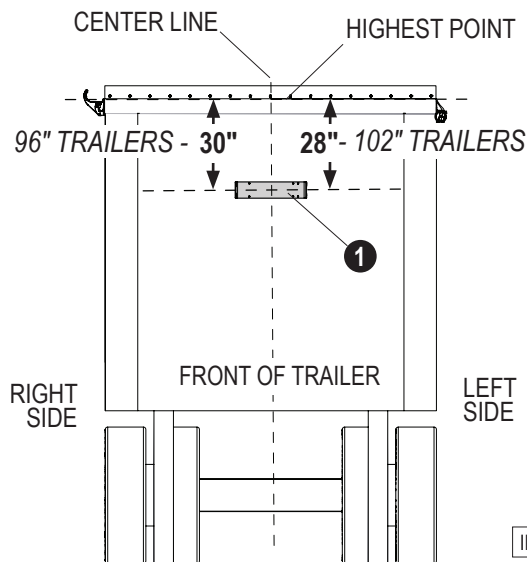

IMAGE 166

STEP 6: MOUNT BRACKET TO TRAILER FRONT

Hold **rear bracket (1)** at location identified in Step 5. Mark hole locations and drill 21/64-inch holes in trailer. Secure bracket as shown in Image 167.

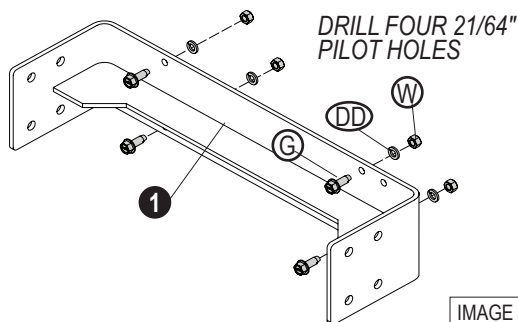

IMAGE 167

STEP 7: SECURE BRACKETS

Install the **front bracket (2)** to the **rear bracket (1)** using the inner set of holes (closest to the trailer). Secure them with four **screws (P)**, eight **washers (FF)**, and four **nuts (X)**, as shown in Image 168.

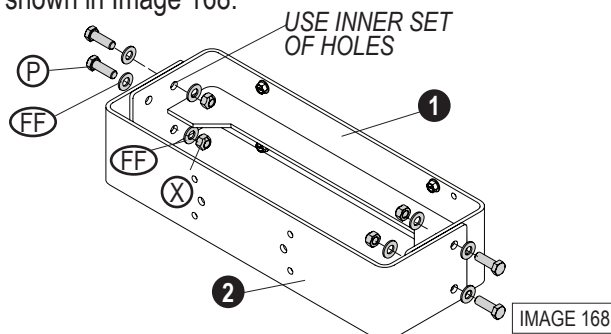

IMAGE 168

⚠ WARNING

Do not stand or climb on the flex arm. Doing so may result in a fall or impact, causing serious injury or death.

⚠ WARNING

Flex arms are under tension while torsion springs are engaged. Use caution when assembling and disassembling arms. Failure to read and follow instructions may result in serious injury or death.

⚠ CAUTION

The arm assembly must be installed with the warning decals facing away from the trailer and in plain view.

STEP 8: ATTACH FRONT ARM TO BRACKET

- Align holes on the front **arm plate (4)** with the holes in the front **bracket (2)**. Keep arm parallel to the front of the trailer.
- Place **washers (EE)** and hex cap **screws (J)** onto the plate and insert them into the bracket hole.
- From inside the bracket, attach washers (**EE**), lock washers (**DD**) and nuts (**W**) onto the end of the hex cap screws.

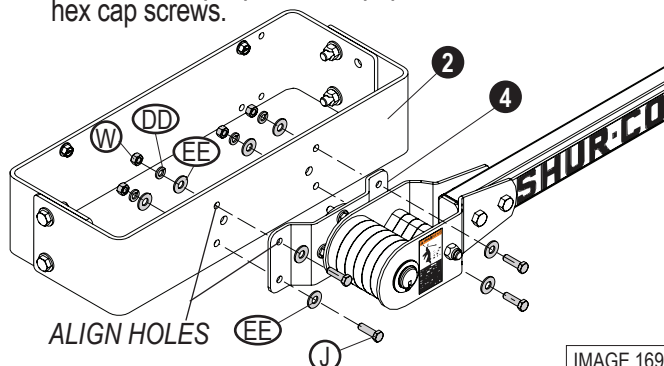

IMAGE 169

Item	Part #	Description
1.		Front Arm Assembly
2.	1120680	Motor Mount Bearing Spacer
3.	1704736	Radial Ball Bearing - 1/4" x 3/4"
4.	1120681	Motor Mount Bearing Retainer
5.	1120679	Motor Spacer
6.	1122264	Drive Shaft - 3" Roll Tube
C.	1703171	Hex Head Cap Screw - 5/16" x 1/2"
N.	1704264	Cap Screw - 3/8" x 2" - Grade 8
R.	1701543	Nylon Lock Nut - 1/4"
V.	1701580	Nylon Lock Nut - 3/8"
BB.	1700428	Flat Washer - 5/16"
CC.	1700433	Lock Washer - 5/16"

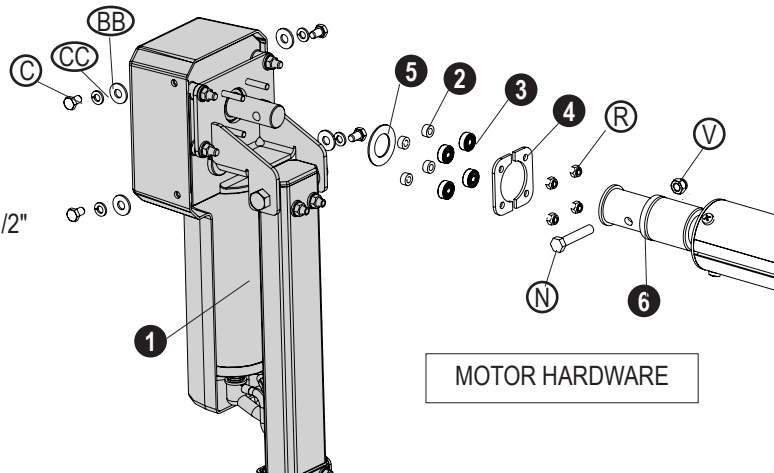

IMAGE 180

Motor Installation

STEP 1: VERIFY REAR ARM PLACEMENT

At the rear of the trailer, ensure the rear arm:

- Lines up straight, parallel to the face panel.
- Remains at a right angle to the roll tube.

STEP 2: PREPARE MOTOR

At the front of the trailer, slide the **motor spacer (5)** over the motor shaft and press it against the motor.

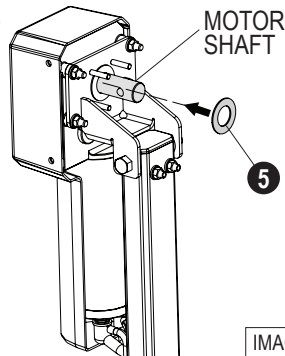

IMAGE 181

STEP 3: SECURE ARM TO ROLL TUBE

- Ensure the roll tube is in its correct position and the front arm is aligned vertically on the front end of the trailer.
- Fasten and secure the roll tube to the motor shaft with **Grade 8 screw (N)** and **lock nut (V)**.

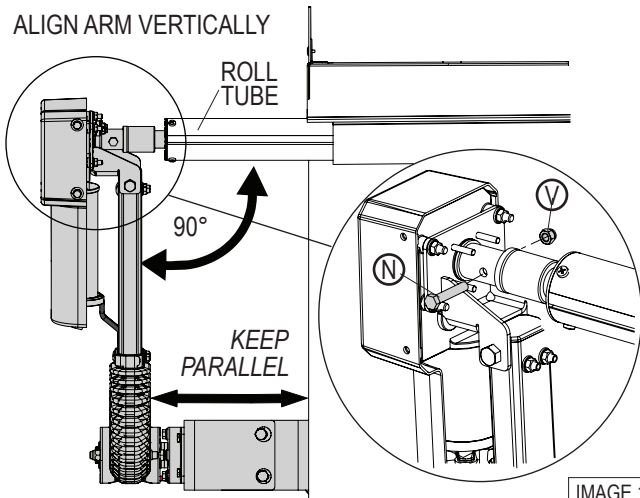

IMAGE 182

⚠ CAUTION

Avoid pinch points when sliding the roll tube extension over the motor shaft and during tightening. Keep hands and fingers clear of moving parts to prevent injury.

⚠ WARNING

Flex arms are under tension while torsion springs are engaged. Use caution when assembling and disassembling arms. Failure to read and follow instructions may result in serious injury or death.

STEP 4: SECURE MOTOR HARDWARE

Install four **bearing spacers (2)**, four **ball bearings (3)**, two **bearing retainers (4)** onto the four threaded posts and secure with four **nuts (R)**.

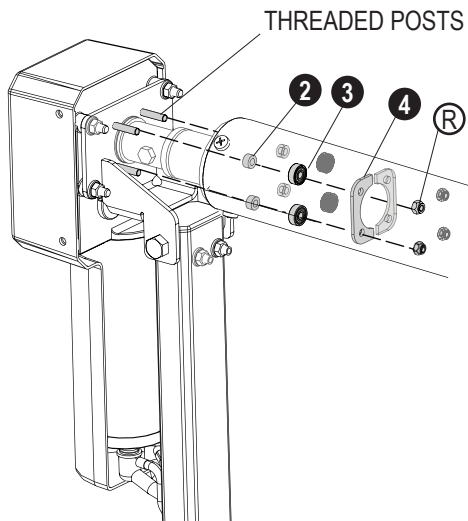

IMAGE 183

STEP 5: INSTALL MOTOR COVER

Fasten the **motor cover** to the motor with four **screws (C)**, **lock washers (CC)**, and **washers (BB)**.

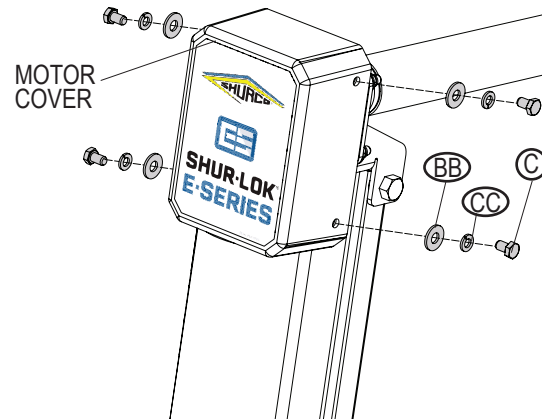
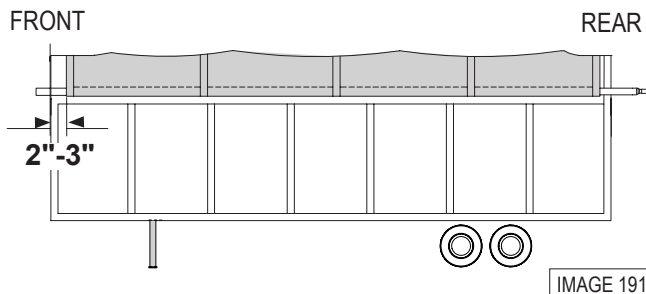

IMAGE 184

STEP 1: POSITION THE TARP

Ensure the tarp is square and the roll tube is aligned 2–3 inches from the wind deflectors, matching the fixed tube alignment.



NOTICE: Use the U-clamps and screws removed at the beginning of the installation.

STEP 2: ATTACH FRONT U-CLAMP

Center a U-clamp on the front edge of the tarp, positioning a self-drilling screw on the crease at the bottom of the tarp pocket. Fasten the U-clamp with the screw.

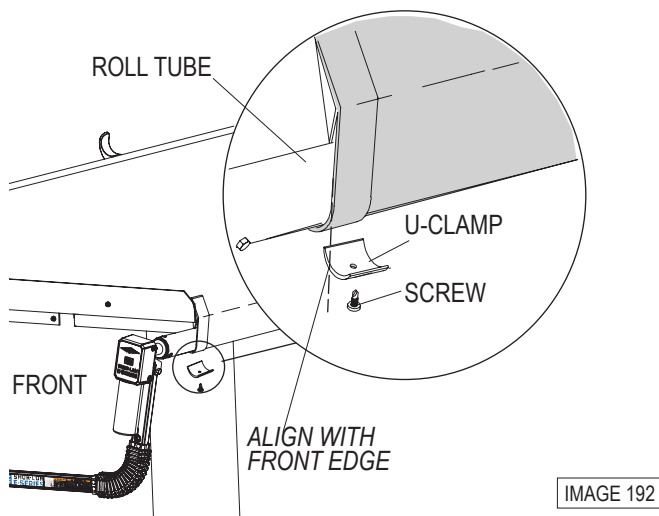

STEP 3: ATTACH REAR U-CLAMP

- Stretch the tarp along the roll tube so the tarp is square.
- Install a U-clamp on the rear strap, positioning self-drilling screw on the crease at the bottom of the tarp pocket.
- Fasten the U-clamp with self-drilling screw.

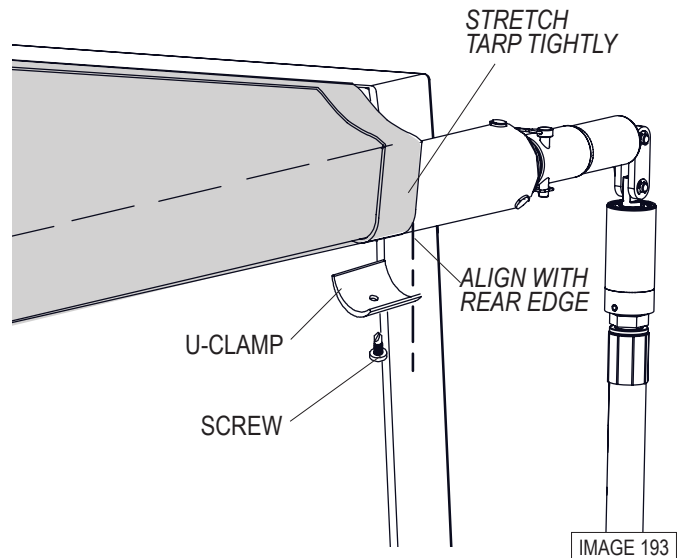

STEP 4: ATTACH REMAINING U-CLAMPS

- Position the remaining U-clamps evenly between the front and rear U-clamps.
 - If the tarp includes straps, place one U-clamp on each strap.
 - If there are no straps, space the U-clamps no more than 36 inches apart.
- Fasten with self-drilling screws.

Item	Part #	Description
1.		Front Arm
2.	1132046	Receiver
3.	1120670	SMARTwire™ Dual-Conductor Socket
4.	1127798	Conductor Plug Mtg (Z) Bracket
5.	1702108	Wire Clip - 3/4"
6.	1703231	Cable Ties (not pictured)
7.	1704378	Dielectric Grease (not pictured)
8.	1704627	Motorized System Warning Decal
9.	1707865	Express Operation Decal
B.	1704338	Self-Tapping Screw - 1/4" x 1"
D.	1701045	Cap Screw - 5/16" x 3/4"
E.	1702926	Hex Head Cap Screw - 5/16" x 7/8"
G.	1700400	Self-Tapping Screw - 3/8" x 1"
T.	1700419	Nylon Lock Hex Nut - 5/16"
U.	1704946	Flanged Top Lock Nut - 5/16"
W.	1700407	Hex Nut - 3/8"
AA.	1700427	Flat Washer - 1/4"
BB.	1700428	Flat Washer - 5/16"
DD.	1700434	Lock Washer - 3/8"
KK.	1704751	Harness Lock Pin - 1/4" x 7/8"

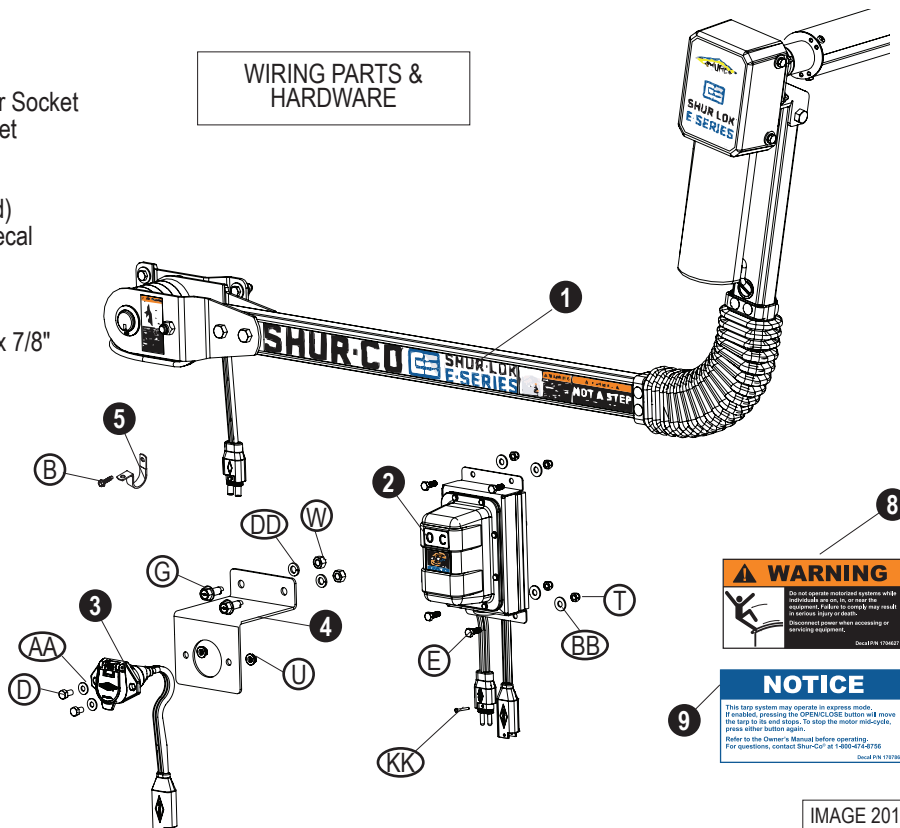
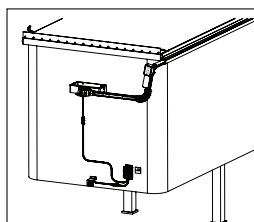

IMAGE 201

Front Arm, Dual Conductor Socket & Receiver Wiring

CAUTION

- Do not cut SMARTwire™. Wire ends are designed with sealed connections to prevent corrosion; cutting the wire may lead to operational problems.
- Bind excess wire with cable ties to prevent loose wire entanglement.

NOTICE: Wire lengths are predetermined. Before installing SMARTwire™ components, review and confirm wire routing so wires reach components with ample room for connection.

STEP 1: CAB WIRING (Optional)

See the Dual Conductor Plug Kit for cab wiring instructions (Part Number 1119643).

NOTICE: Washers and nuts may be omitted if wall thickness prevents proper securement.

STEP 2: MOUNT DUAL CONDUCTOR SOCKET & BRACKET

- Determine location on the front of the trailer, near the existing 7-pole conductor socket for the **socket (3)**.
- Drill two 21/64" pilot holes.
- Fasten the **mounting bracket (4)** with two **screws (G)**, two **lock washers (DD)** and two **nuts (W)**.
- Attach the **socket (3)** with two **screws (D)**, two **washers (AA)**, and two **nuts (U)**.

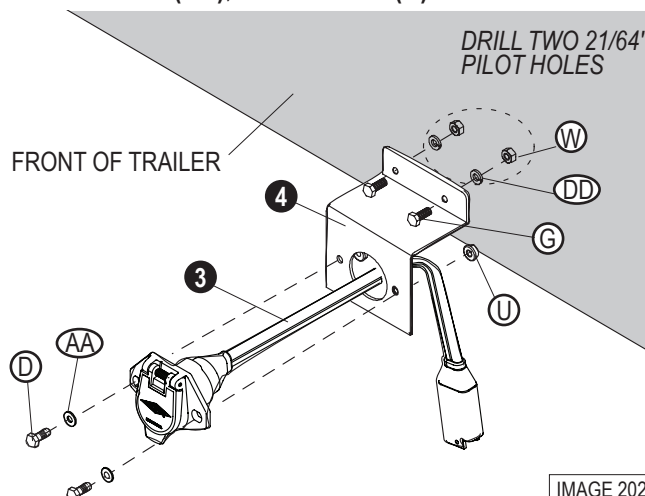

IMAGE 202

STEP 3 : FASTEN RECEIVER

- Determine a location on the front, left side of the trailer, positioning the **receiver (2)** as low as possible to ensure the front arm can move in an unobstructed travel path.
- Use the holes on the receiver as a guide to drill four 5/16-inch holes.
- Insert four **screws (E)** through the front of the receiver brackets and attach four **washers (BB)** and four **nuts (T)** inside the trailer skin.

DRILL FOUR 5/16-INCH HOLES

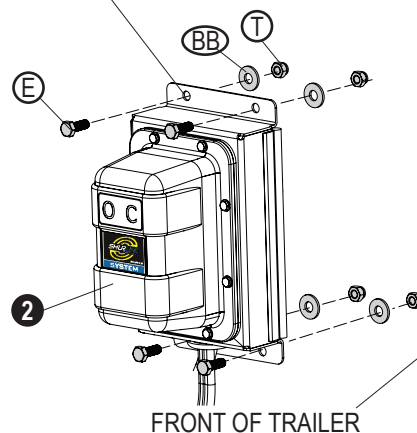

IMAGE 203

STEP 4 :CONNECT SMARTWIRE

- Apply **dielectric grease (7)** to the male plug ends of the **receiver (2)** and **front arm (1)**.
- Connect the SMARTwire from the **front arm (1)** to the **receiver (2)**.
- Connect the SMARTwire from the **receiver (2)** to the **dual-conductor socket (3)**.
- Secure connections with **lock pins (KK)**.
- Secure wires to the trailer with **wire clips (5)** and **screws (B)**. Use **cable ties (6)**, if needed.

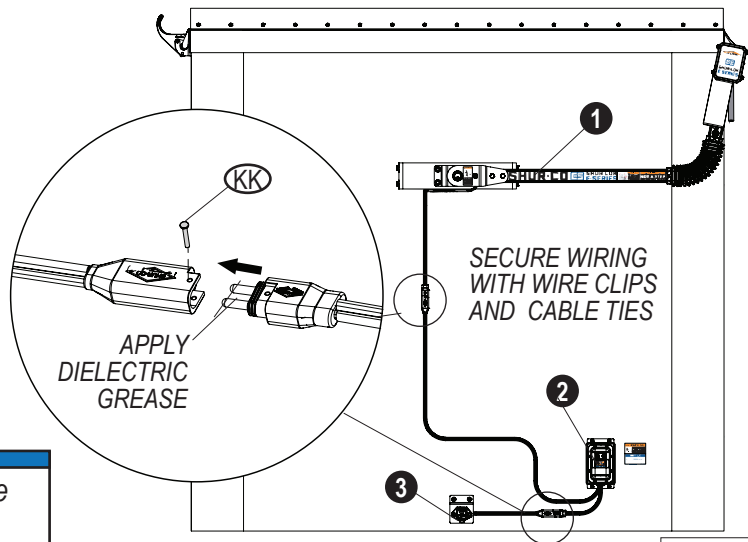

IMAGE 204

NOTICE: Coat each connection with dielectric grease to prevent corrosion.

STEP 5: PLACE DECALS

- Ensure the surface area near the receiver is clean and dry.
- Remove the backing from **warning decal (8)** and **express notice decal (9)**.
- Place the decals in a visible location near the receiver, as shown in Image 205.
 - Regularly inspect all safety decals for wear and adhesion to maintain safety.
 - Replace worn or damaged decals as necessary.

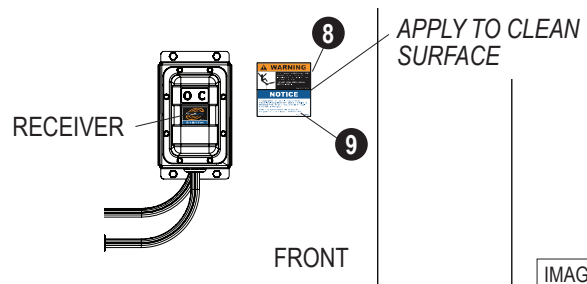
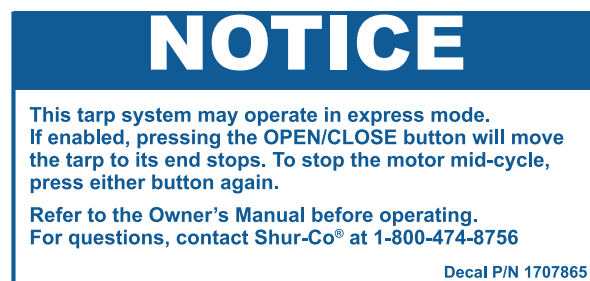

IMAGE 205



⚠ CAUTION

Ensure all hardware is secure before operating the system. Inspect the complete system at this time and make adjustments as required.

EXPRESS MODE

The tarp system automatically enters Express Mode when operated using the buttons on the trailer-mounted receiver box or through the Shurlink™ remote system. In this mode, pressing the O (open) or C (close) button initiates an express operation to open or close the tarp. This operation will continue until either button is pressed again to stop, or it will automatically conclude once the tarp reaches the end of its travel.

⚠ WARNING

Do not stand or climb on the flex arm. Doing so may result in a fall or impact, causing serious injury or death.



TEST OPERATION

- Check the motor direction by pressing either the Open or Close button on the receiver.
- If the button is released and operation continues, the system is in Express Mode. To stop operation, press button again.

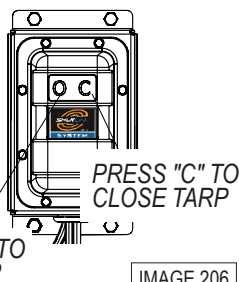
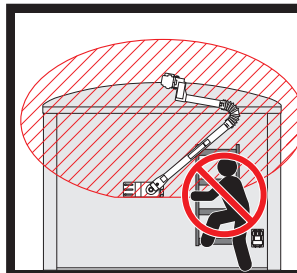

IMAGE 206



⚠ WARNING

Stay clear of the roll tarp and arm(s) sweep area, from front-to-back, during operation. Failure to do so may result in a fall/impact causing serious injury or death. For repair/-service of equipment, reference manual for proper safety precautions before proceeding.

REMOTE OPERATION (OPTIONAL - NOT INCLUDED)

EZR™ remotes are pre-programmed to Express Mode but can be reconfigured according to your preferences. To stop the tarp system while using the remote, press the open or close button within range. If operation was initiated from the receiver, note that closing the remote lid or pressing the select button does not stop the system during Express Mode operation. For remote operation, refer to the remote instruction manual.

CHANGE MOTOR DIRECTION

If the open/close buttons are running the system backwards, download the app to change motor direction.

Follow QR code for Shurlink™ App Product Support



⚠ WARNING

Powering any Shur-co® wireless system solely with a battery charger may lead to operational issues or system failure. A 12-volt truck or automobile battery must be used as the power source for the trailer's system.

NOTICE: Only one electric tarp system can be hooked up at a time.

⚠ WARNING

Do not operate motorized systems while individuals are on, in, or nearby the equipment. Failure to comply may result in serious injury or death.

Disconnect power when accessing or servicing equipment.

Perform the following steps to convert the Shur-lock E Series electric system to manual crank operation.

NOTICE: Store the hand crank arm in the truck or mount it to the trailer. (Example - above kingpin, near the apex.)

STEP 1: DISCONNECT POWER

Disconnect power from the front of the trailer.

STEP 2: REMOVE REAR ARM

- At the rear end of the trailer, remove the lock pin securing the rear arm to the roll tube.
- Remove the rear arm.

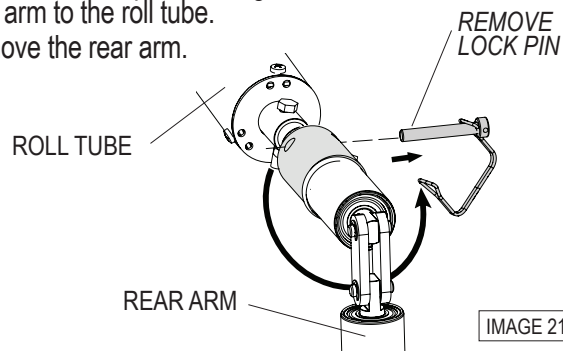

IMAGE 210

STEP 3: ATTACH HAND CRANK

Place splined U-joint of the hand crank on the splined shaft. Secure with wire lock pin.

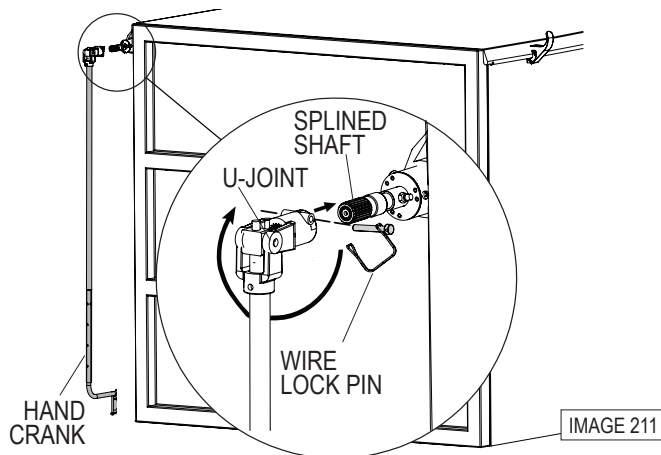

IMAGE 211

⚠ WARNING

Do not open or close the tarp unless the U-joint is securely fastened to the splined shaft with the wire lock pin. Failure to do so could result in severe injury or death.

NOTICE: The U-joint is designed to operate as shown in Image 212 and is able to withstand considerably more pressure in this position.

RECOMMENDED

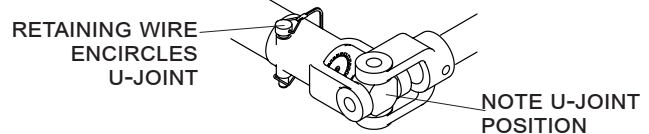

IMAGE 212

NOT RECOMMENDED

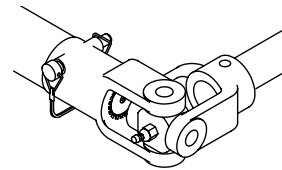

IMAGE 213

⚠ WARNING

Ensure the retaining wire encircles the U-joint to prevent the wiring from catching during operation. Failure to do so could cause severe injury or death.

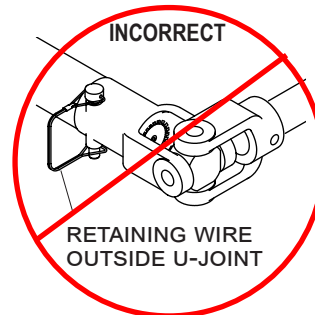

IMAGE 214

STEP 4: DISCONNECT MOTOR

At the Rear of the Trailer: Hold the crank handle to prevent the arms from rotating the roll tube.

At the Front of the Trailer:

Have a second person remove the screw (N) and nut (V) from the motor shaft and roll tube extension.

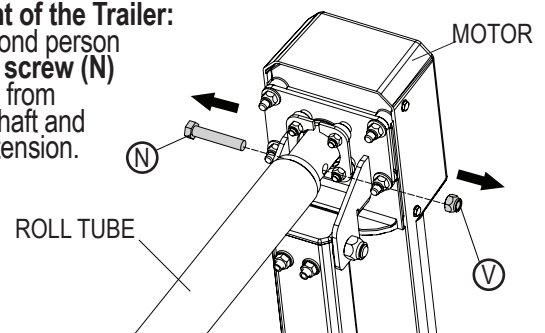

IMAGE 215

OPERATING INSTRUCTIONS

Use the crank arm assembly mounted at the rear of the trailer to manually open and close the tarp system until electrical system issues can be resolved. See the Shur-Lok® owner's manual for proper safety procedures at www.shurco.com.

STEP 1:

Hold the crank firmly with both hands and roll the tarp closed under the latchplate. Bring the crank handle down perpendicular to the ground.

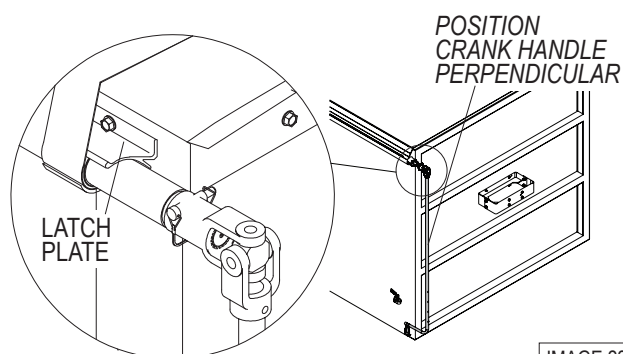

IMAGE 220

STEP 2:

Tighten the tarp by lifting the crank handle up into the crank retainer and secure with lock pin.

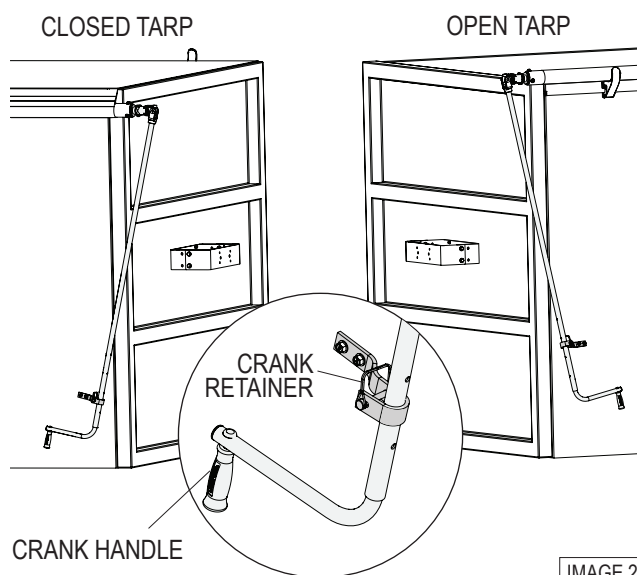

IMAGE 221

STEP 3:

Check the tarp tension. It should take 40 to 60 pounds of pressure to force the crank handle into the crank retainer. The crank extension will bend 1/8".

⚠ WARNING

Do not open or close the tarp unless the U-joint is securely fastened to the splined shaft with the wire lock pin. Failure to do so could result in severe injury or death.

STEP 4:

If required, adjust the tension by removing the U-joint from the splined shaft, rotating the U-joint tooth, and replacing it on the splined shaft.

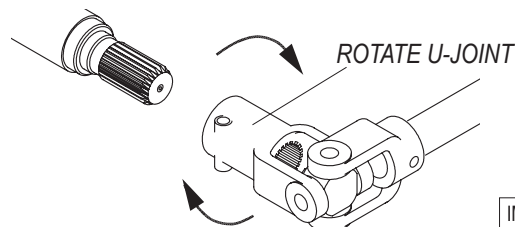

IMAGE 222

STEP 5:

Repeat Step 3 and Step 4 until the correct tension is achieved.

STEP 6:

Secure the U-joint to the splined shaft with the wire lock pin.

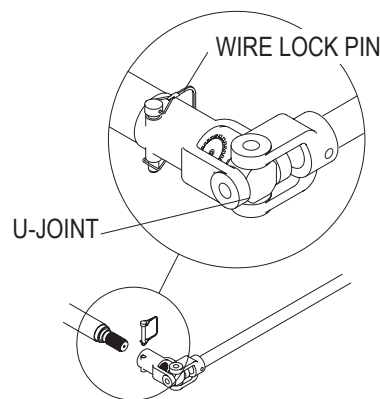

IMAGE 223

To uncover load:

1. Release the crank from the crank retainer.
2. Turn the crank clockwise (counter-clockwise for reverse roll) until the tarp has rolled up against the tarp stops.
3. Place the crank back into the crank retainer and secure with lock pin.

To cover load:

1. Release the crank from the crank retainer.
2. Turn the crank counter-clockwise (clockwise for reverse roll) until the tarp is unrolled over the edge of the trailer.
3. Continue cranking to roll the tarp up under the latchplate.
4. Bring the crank arm down to a vertical position.
5. Swing the crank arm up and place it into the crank retainer and secure with lock pin.

Decals

Item	Part #	Description
1.	1703897	Flex Arm Tension Warning Decal
2.	1704627	Motorized System Warning Decal
3.	1707862	Flex Arm Step Warning Decal
4.	1707865	Express Operation Decal

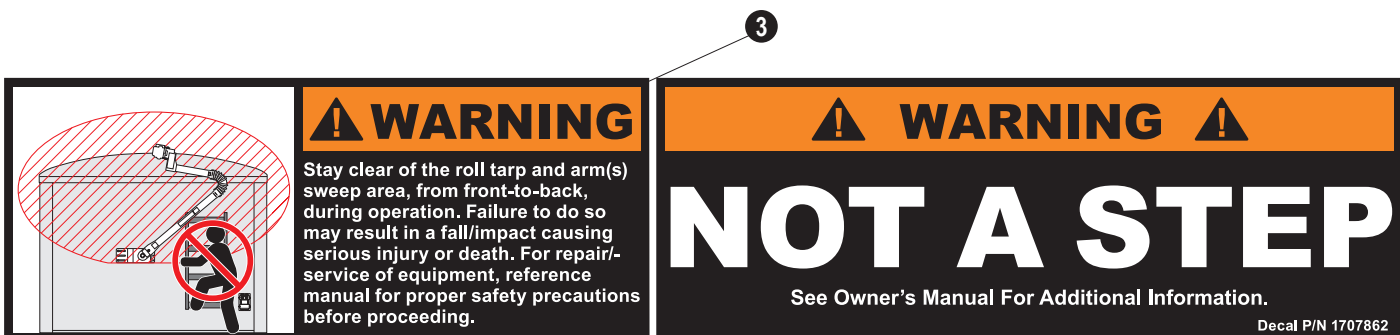
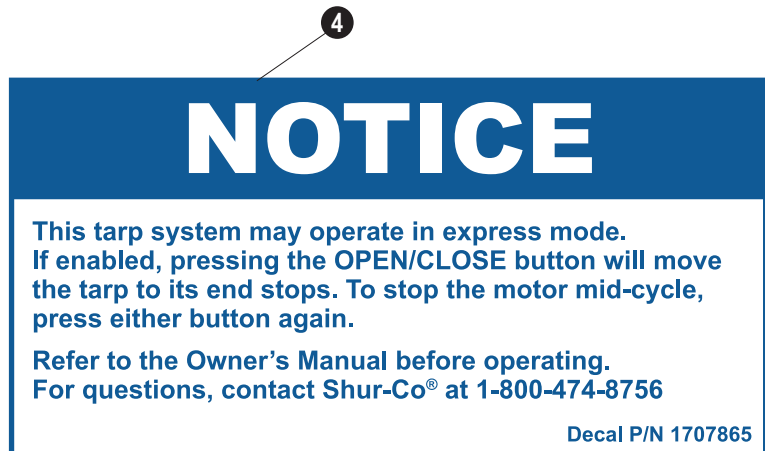
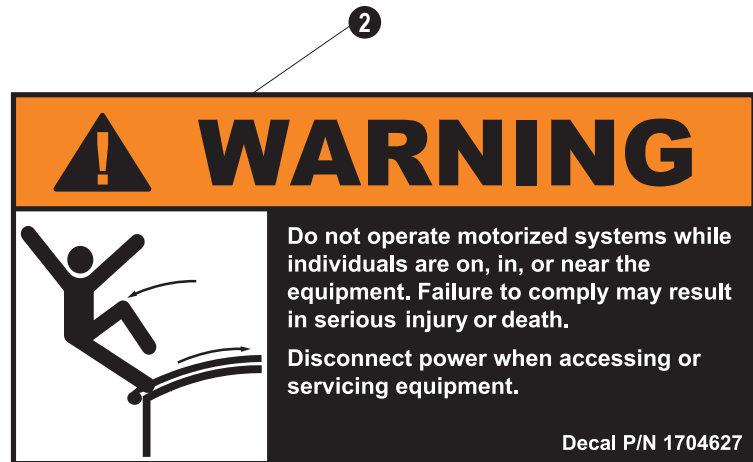

Front Arm**Item Part # Description**

1. 1133197 Front Arm Assembly without Motor
1133224 Front Arm Assembly with Motor
2. 1133019 E-Series Motor
3. 1133018 Motor Cover Kit - E-Series
4. 1122880 Electric Drive Shaft Kit - 3"
Cartridge Clamp
Drive Shaft - 3"
Self-Drilling Screw - 1/4" x 1"
Nylon Lock Nut - 5/16"
Cap Screw - 3/8" x 2" - Grade 8
Nylon Lock Nut - 3/8"
Carriage Bolt - 5/16" x 1"
Self-Tapping Screw - 3/8" x 1"
5. 1120977 Motor Mount Hdw - 4500HD/E-Series
Motor Mount Bearing Spacer
Radial Ball Bearing - 1/4" x 3/4"
Motor Mount Bearing Retainer
Motor Spacer
Cap Screw - 3/8" x 2" - Grade 8
Nylon Lock Nut - 3/8"
Nylon Lock Nut - 1/4"

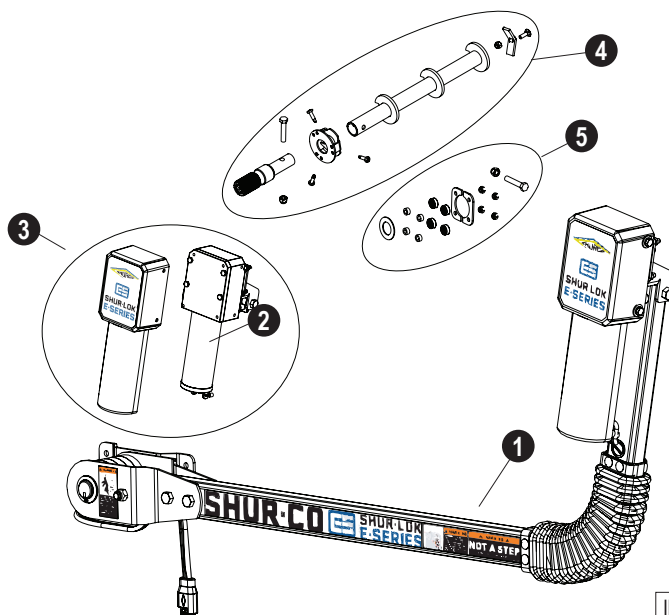
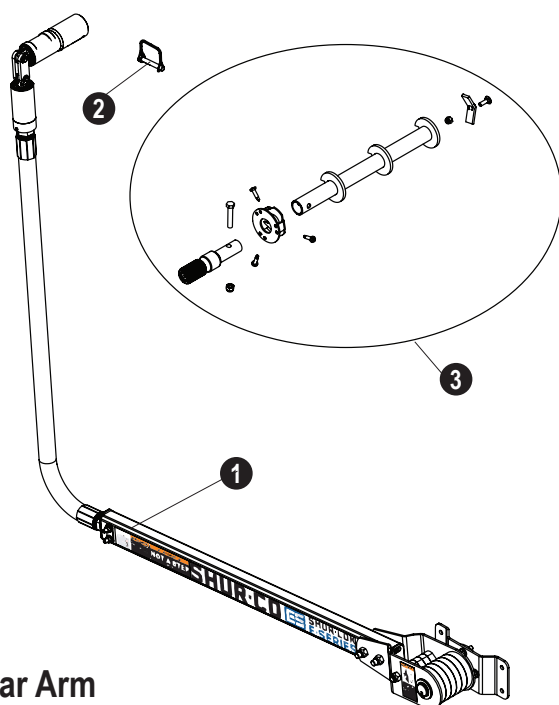

IMAGE 703

**Rear Arm****Item Part # Description**

1. 1133194 Rear Arm Assembly
2. 1700526 Wire Lock Pin - 3/8" x 2-1/2"
3. 1122879 Rear Roll Tube Adapter Kit
Manual Crank Spline - 3"
Roll Tube End Cap - Rear
Rear Cartridge - 3"
Cartridge Clamp
Nylon Lock Nut - 3/8"
Carriage Bolt - 5/16" x 1"
Hex Head Cap Screw - 3/8" x 2" Grade 8
Nylon Lock Nut - 5/16"
Self-Drilling Screw - 1/4" x 1"

IMAGE 704

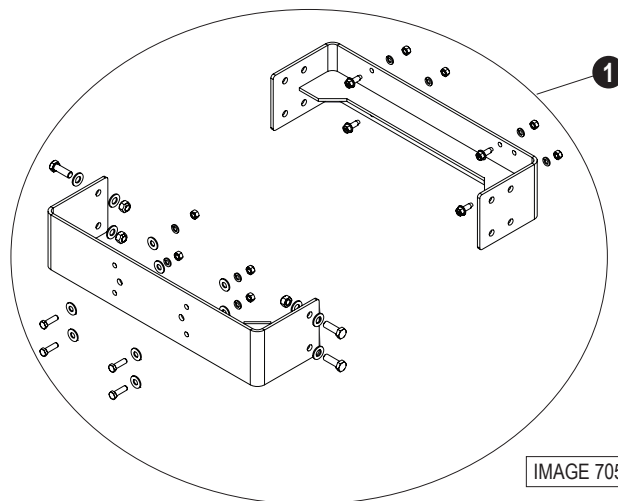

IMAGE 705

Brackets**Item Part # Description**

1. 1133199 Bracket Mounting Kit
Rear Pivot Bracket
Front Pivot Bracket
Self-Tapping Screw - 3/8" x 1"
Hex Head Cap Screw - 3/8" x 1-1/4"
Hex Head Cap Screw - 1/2" x 1-1/2"
Hex Nut - 3/8"
Lock Nut - 1/2"
Lock Washer - 3/8"
Flat Washer - 3/8"
Flat Washer - 1/2"

RECEIVER & DUAL-CONDUCTOR SOCKET COMPONENTS

Item	Part #	Description
1.	1132046	Receiver Flanged Nylon Lock Nut - 5/16" Flat Washer - 5/16" Wire Clip - 3/4" Cap Screw - 5/16" x 7/8" Cable Ties (not pictured) Dielectric Grease (not pictured) Self-Tapping Screw - 1/4" x 1" Harness Lock Pin - 1/4" x 7/8"
2.	1120670	SMARTwire™ Dual-Conductor Socket
3.	1127798	Conductor Plug Mtg (Z) Bracket
4.	1700400	Self-Tapping Screw - 3/8" x 1"
5.	1700407	Hex Nut - 3/8"
6.	1700434	Lock Washer - 3/8"

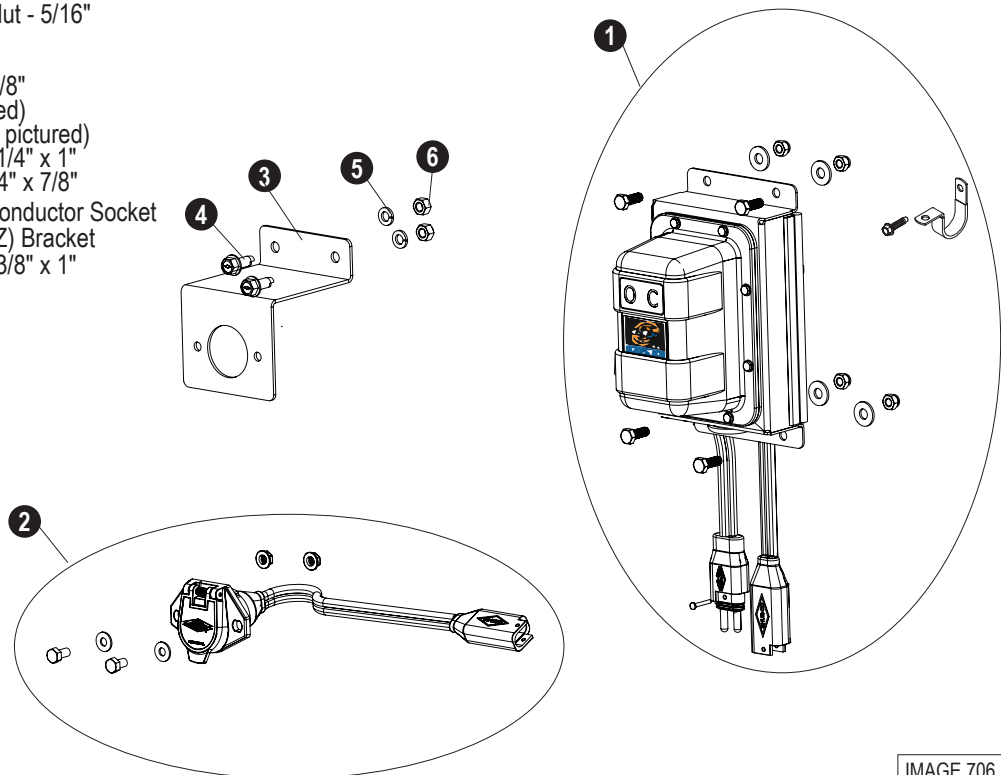

IMAGE 706

OPTIONS

Item	Part #	Description
1.	1119643	Cab Wiring Kit - 6 Ga. x 30'- 40Amp HD Dual-Cond Plug - Vert Pin Dual-Cond Wire - 6 Ga. - 30' (not pictured) 40-Amp Modified-Reset Circuit Breaker Cable Tie - 8" Ring Terminal - 6 Ga. x 3/8" Stud - Battery Ring Terminal - 6 Ga. x #10 Stud - Motor/Breaker Circuit Breaker Boot - Red
2.	1131576	ShurLink EZR™ Remote

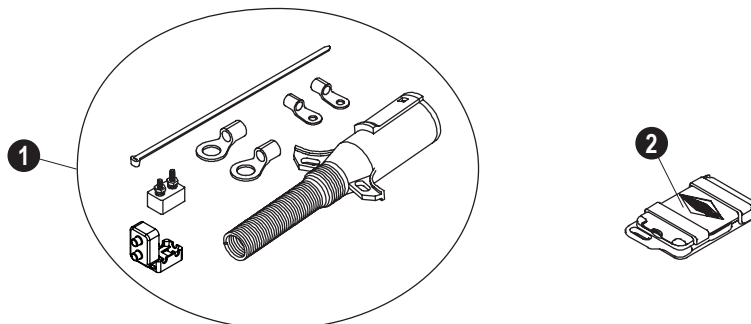

IMAGE 707

2309 SHURLOCK STREET | YANKTON, SD 57078-0713
PHONE: 1.866.748.7435 | FAX: 1.605.665.0501
SHURCO.com
