



ENGINEERED TARPING SOLUTIONS

P/N 1120474 Rev. A

# OWNER'S MANUAL

## LITEALL™

WIRELESS LED WORK LIGHT PACKAGE



*READ BEFORE INSTALLING*

PO BOX 713 ■ 2309 SHUR-LOK STREET ■ YANKTON, SD 57078-0713  
PHONE 1-800-4-SHUR-LOK (1-800-474-8756) ■ FAX 605-665-0501  
[www.shurco.com](http://www.shurco.com)

SHOP ONLINE: [www.shopshurco.com](http://www.shopshurco.com)

**MESSAGE TO OWNERS**

Thank you for buying this product from Shur-Co®. We appreciate your confidence in our products. Please read and thoroughly understand this manual before installing and/or operating this system.

Pay particular attention to important safety and operating instructions, as well as warnings and cautions. The hazard symbol  is used to alert users to potentially hazardous conditions and is followed by caution, warning or danger messages.

Failure to READ AND FOLLOW INSTRUCTIONS could result in failure of your system and/or personal injury. Your trailer requirements may, however, call for minor variations to these instructions.

Please inspect your system periodically. Repair or replace worn or damaged parts to your system.

QUESTIONS? CALL OUR HELP LINE:

**1-866-748-7435**

MON-FRI 8 AM-5 PM CENTRAL TIME

**SAFETY**

We at Shur-Co® are concerned with your safety and the safety of all those operating this system. Therefore, we have provided safety decals at various locations on your system. Keep decals as clean as possible at all times. Replace any decal that has become worn or damaged, painted over or otherwise difficult to read. Replacement decals are available through Shur-Co® dealers.

**SAFETY INSTRUCTIONS**

- 1. Always wear safety glasses during installation.**
- 2. Keep body and clothing clear of moving parts.**
- 3. No other use of this system is authorized, except as designed.**

**TABLE OF CONTENTS**

LiteALL™ Benefits & Advantages..... 1

Program SMARTransmitter® to LiteALL™ .....2

Enabling & Disabling SMARTransmitter® Channels .....2

Hardware Identification.....3

Tools Required for Installation .....3

Wiring Diagrams .....4

LiteALL™ Control Module Installation .....5 - 6

LiteALL™ Work Light Installation .....7 - 8

Replacement Parts .....8

Terms & Conditions .....9

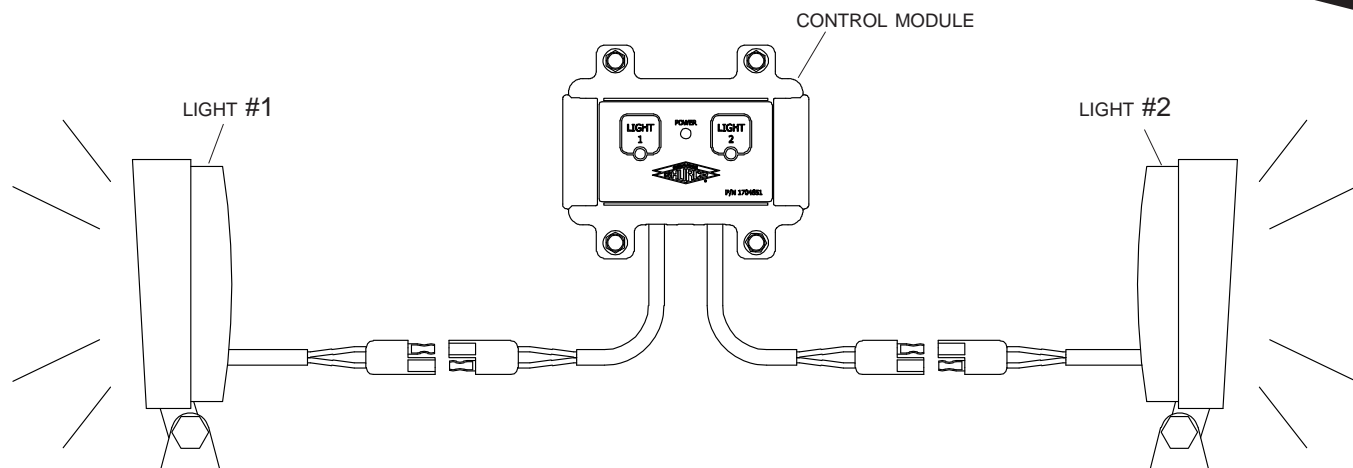

The LiteALL™ LED work light package has been specifically designed for use with the Shur-Co® exclusive SMARTransmitter® wireless remote. The built-in flexibility of the LiteALL™ accommodates manual operation using the Shur-Co® control module. Adjustable mounting brackets and an additional 20-ft. extension cable make it easy to direct the high-intensity LED flood beams exactly where you need them. The LiteALL™ is a valuable addition to the Shur-Co® SMARTrailer®, providing you the opportunity to extend the day by working into night.

- The Shur-Co® LiteALL™ control module has two output channels. Each channel can be controlled independently or together using a Shur-Co® SMARTransmitter® remote.
- The work lights can also be independently controlled manually using the keypad interface on the control module.
- Up to five SMARTransmitters can be programmed to control each output channel on the LiteALL™ control module.
- The control module is quick and easy to reprogram to new or different SMARTransmitters.

**LiteALL™ Operation:**

- When the LiteALL™ control module is connected to power, the green *POWER* LED is illuminated, indicating that the module is active.
- To remotely control the LiteALL™ control module with a SMARTransmitter®, toggle your SMARTransmitter® to the channel that has been programmed to the output channel that you want to control (typically the *LIGHTS* or *AUX* channel). Press the *OPEN/ON* button to turn on the light(s) that are connected to the output channel. Press *CLOSE/OFF* to turn the lights off. See the programming instructions on the next page for programming a SMARTransmitter® to the LiteALL™ control module.
- To manually control the module, simply press the *LIGHT 1* button to toggle the light(s) connected to the *LIGHT 1* output channel, or press the *LIGHT 2* to toggle the light(s) connected to the *LIGHT 2* output channel.

**Specifications**

- System voltage: 10 to 16 volts DC
- System current: 4 amps max. w/two LED work lights  
1.8 additional amps max. for each additional work light
- Reverse polarity protection: Yes
- Work light output: 1600 lumens
- Work light power: 24 watts
- Work light IP rating: IP67
- Work light life: 30,000 hours estimated

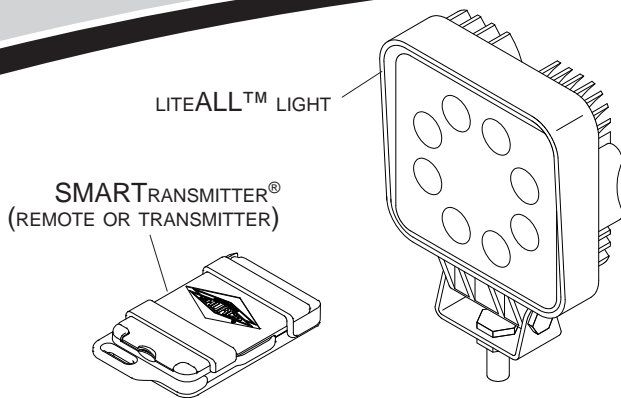

**Program SMARTransmitter® to LiteALL™**

1. Be sure the LiteALL™ control module is connected to power by checking that the green *POWER* LED on the control module is on. If a battery disconnect switch is installed, make sure it is turned on.
2. To program the *LIGHT 1* output channel, hold the *LIGHT 1* button for five seconds until the *POWER* LED turns off. The *LIGHT 1* LED should still be on.
3. Set the SMARTransmitter® to the *LIGHTS* channel LED by pressing the *SELECT* button. A different channel on the SMARTransmitter® may be used if desired. If your SMARTransmitter® will not toggle to the desired channel due to being disabled previously, see the Enabling & Disabling SMARTransmitter® Channels instructions.
  - 3a. **One SMARTransmitter®:** Press the *OPEN/ON* button five times. After each button press, the *LIGHT 1* channel LED will flash briefly.
  - 3b. **Multiple SMARTransmitters:** Press the *OPEN/ON* button at least one time for each transmitter. After each transmission, the *LIGHT 1* channel LED will flash briefly. The LiteALL™ will expect five signals, so if you are programming less than five transmitters, press the *Open/On* button additional times on the last transmitter to take up all five memory slots in the LiteALL™ control module.
4. After the fifth transmission, the *LIGHT 1* channel LED will flash twice to indicate that the transmitter(s) have been successfully introduced to the LiteALL™ control module. The *POWER* LED will then turn back on.
5. You can now operate the lights connected to the *LIGHTS 1* output channel with your SMARTransmitter®.
6. To program the *LIGHT 2* output channel, repeat the instructions above using the *LIGHT 2* button on the LiteALL control module. If you want the SMARTransmitter(s) to control both LiteALL™ output channels together with one button press, make sure to select the same SMARTransmitter® channel that was programmed to *LIGHT 1* in step 3.

**Enabling & Disabling SMARTransmitter® Channels:**

The Shur-Co® SMARTransmitter® has five channels. Pressing the *Select* button toggles through these channels. Unused channels can be disabled, if desired, using the following process. This process may be skipped. Unused transmitter channels will not perform any functions.

Hold the *Select* button down for 10 seconds and the transmitter will enter *Channel Programming Mode*. Each time *Channel Programming Mode* is entered, the status of all five channels must be reset by pressing *Open/On* or *Close/Off*.

*NOTE: This process will not interfere with pre-programmed signals that have been pre-set by the factory or dealer.*

While in *Channel Programming Mode*, the programmable channel will be indicated by a solid lit LED.

*NOTE: The transmitter will NOT activate any motor or the LiteALL™ while the transmitter is in Channel Programming Mode.*

Press the *Open/On* button to enable the current channel (designated by the indicator light). Press the *Close/Off* button to disable the current channel. The indicator light will automatically jump to the next channel.

After programming all five channels, the transmitter will display the programmed channel status for all channels for three seconds. All enabled channel LEDs will be lit solid and all disabled channel LEDs will not be lit. Buttons will not function during this three-second period.

The transmitter will automatically exit *Channel Programming Mode* after three seconds and return to *Operational Mode*.

*NOTE: If there is not at least one enabled channel after programming, the transmitter will not save the changes and will revert back to the previously saved channel settings.*

*TIP: To cancel your changes and exit Channel Programming Mode, close the transmitter cover.*

**A**  1704405 Pan Hd. Self-Drilling Screw - #8 x 3/4" (qty. 27)

**B**  1704761 Self-Drilling Screw - #12 x 1 1/4" (qty. 4)

**C**  1704739 Ring Terminal 14 to 16 Ga. #10

**D**  1704153 Ring Terminal 14 to 16 Ga. 1/4" Stud (qty. 2)

**E**  1704698 Nylon Wire Clip - 1/4" Black (qty. 21)

**F**  1704699 Nylon Wire Clip - 5/16" Natural (qty. 4)

**G**  1704700 Nylon Wire Clip - 3/8" Black (qty. 2)

**H**  1118037 Plastic Washer - Black (qty. 8)

**J**  1704397 Rubber Grommet - 7/16" x 15/16" (qty. 2)

**K**  1704556 Rubber Grommet - 5 to 10mm IP65

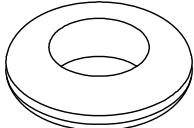
**L**  1703282 Rubber Grommet - 7/8" x 1 5/8"

1118437 5-Channel SMARTransmitter®

1704740 Extension Cable - 16 Ga. 2 Conductor - 20-ft.

1704719 LED Work Light - 24 Watt (qty. 2)

\_\_\_\_\_ Control Module

1703231 Cable Tie - 8" (qty. 10)

**TOOLS REQUIRED FOR INSTALLATION**

LiteALL™ Control Module

- Drill
- 5/16" Nut Driver or 5/16" Socket w/Drill Adapter
- 1 1/4" Hole Saw (optional for installing grommet & passing three module cables through wall surface up to .150" thick)
- #2 Phillips Bit
- Wire Stripper
- Wire Terminal Crimper

LiteALL™ Work Lights

- Drill
- 13/32" Drill Bit
- 11/16" Hole Saw (optional for installing grommet & passing work light cables through wall surface up to .080" thick)
- 1/2" Combination Wrench
- 9/16" Combination Wrench
- 11/16" Combination Wrench
- #2 Phillips Bit

20' LiteALL™ Work Light Extension Cord

- Drill
- #2 Phillips Bit

Power Cord into Sealed Junction Box

*(junction box ordered separately)*

- #2 Phillips Screwdriver
- Drill (if additional port is needed for LiteALL™ power cable)
- 21/32" Drill Bit (if additional port is needed for LiteALL™ power cable)
- Ratchet
- 5/16" Socket (if connecting to junction box with #10 studs on circuit breaker)
- 7/16" Socket

Power Cord into Shur-Link™ Pro

- #2 Phillips Screwdriver
- Ballpoint Pen

**INSPECT ALL PARTS IN YOUR LiteALL™ KIT UPON ARRIVAL**

**ON TRAILERS WITH SHUR-CO® 3500 SERIES & PROTRAPS**

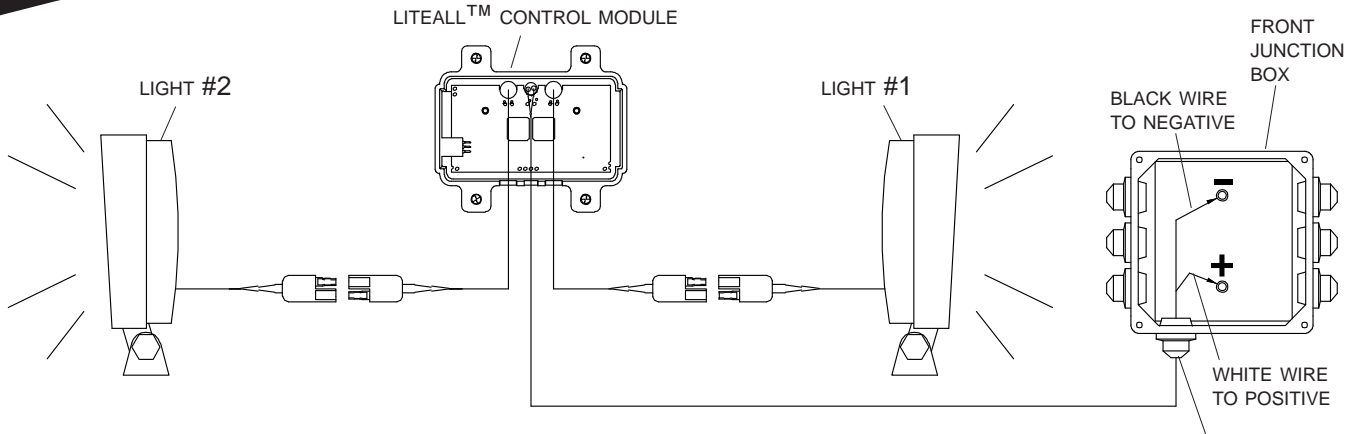

DRILL 2 1/32" HOLE FOR GROMMET P/N1704556 IF NEEDED. PASS CABLE THROUGH GROMMET.

**ON TRAILERS WITH SHUR-CO® PROTRAP®**

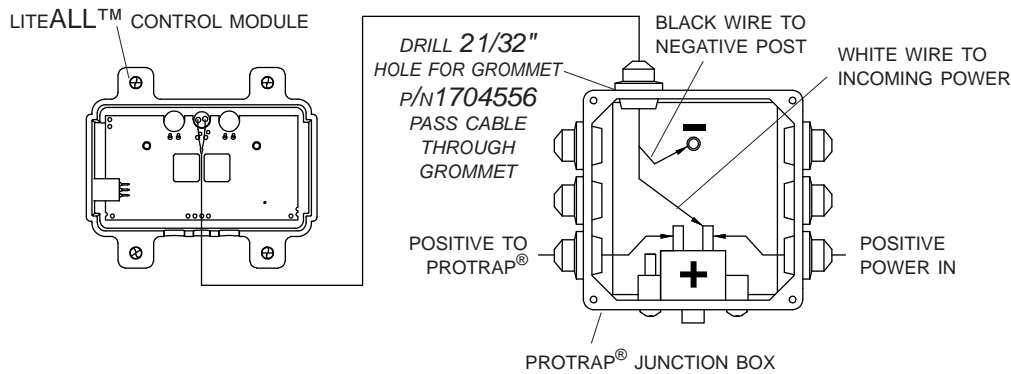

**ON TRAILERS WITH SHUR-CO® SHUR-LINK PRO™**

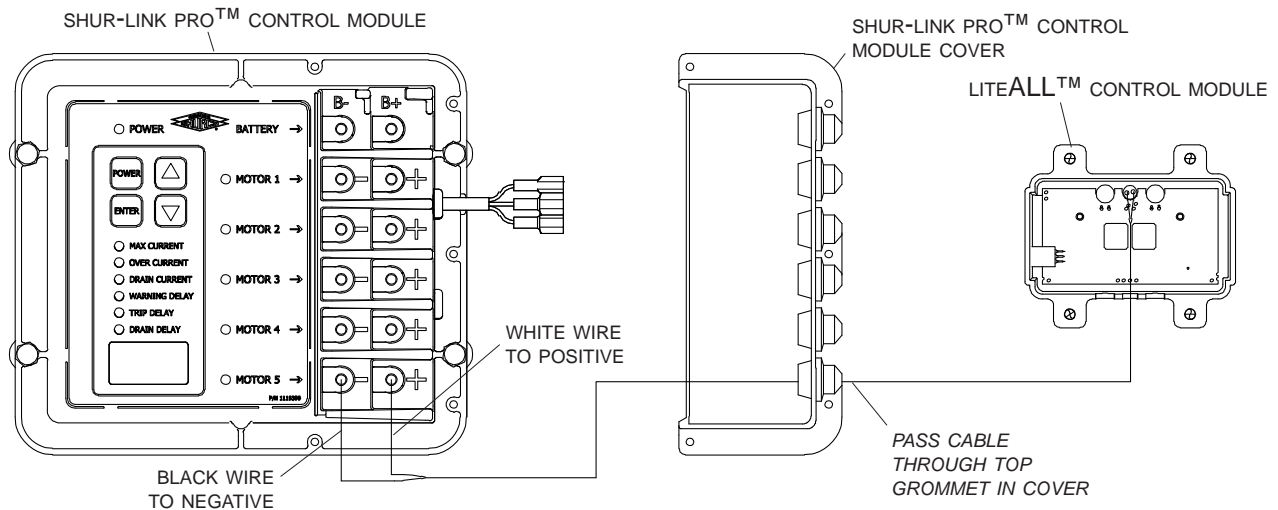

**ON OTHER INSTALLATIONS WIRING IS DETERMINED BY USER**

HOOK TO POWER USING 16 GA. OR LARGER WIRE

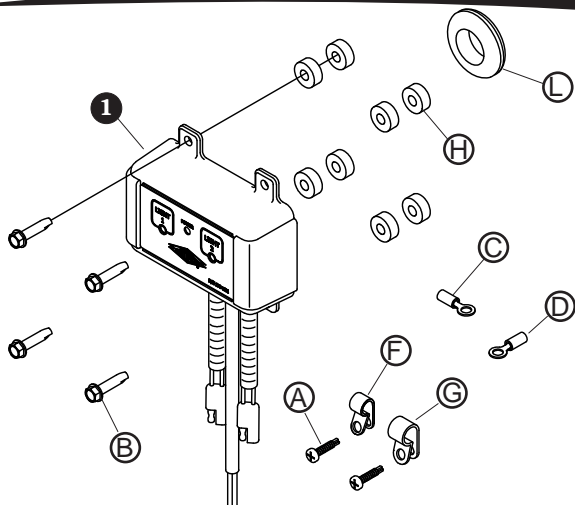

| Item | Part #  | Description                             |
|------|---------|---|
| 1.   | 1704651 | Control Module                          |
| A.   | 1704405 | Pan Hd. Self-Drilling Screw - #8 x 3/4" |
| B.   | 1704761 | Self-Drilling Screw - #12 x 1 1/4"      |
| C.   | 1704739 | Ring Terminal - 14 to 16 Ga. #10        |
| D.   | 1704153 | Ring Terminal - 14 to 16 Ga. 1/4" Stud  |
| F.   | 1704699 | Nylon Wire Clip - 5/16" Natural         |
| G.   | 1704700 | Nylon Wire Clip - 3/8" Black            |
| H.   | 1118037 | Plastic Washer - Black                  |
| L.   | 1703282 | Rubber Grommet - 7/8" x 1 5/8"          |

**STEP 1:** Determine mounting location for LiteALL™ control module. If SMARTransmitter® will be used to operate module, it is recommended to locate module where user will have direct line of sight to module while operating SMARTransmitter®.

If the LiteALL™ control module is not being hooked up to either the 3500 Series junction box, the ProTrap® junction box, or the Shur-Link Pro™ control module, it is the responsibility of the owner to select an appropriate 12-volt DC power connection that does not compromise any potential system operation.

If you have any questions about connecting the LiteALL™ control module to your equipment, contact the equipment manufacturer.

**NOTE:** Keep in mind that the power cable on the module is 8' long and must be connected to 12 volts.

**STEP 2:** If power and/or output cables are to pass through mounting surface (.150" max. wall thickness), use 1 1/4" hole saw to cut hole directly behind module. Pass cables through grommet L, then insert grommet into hole.

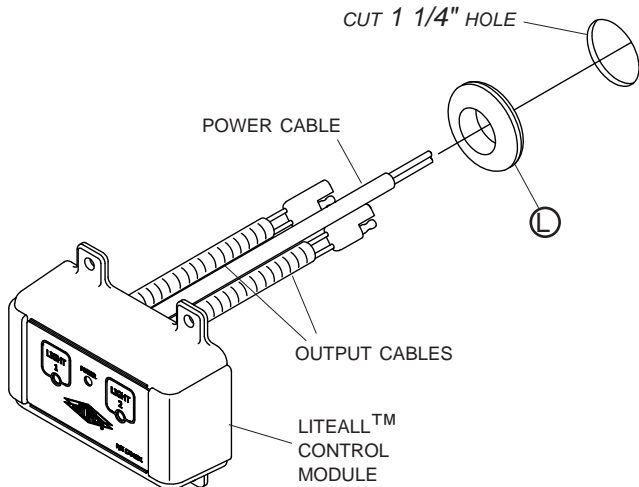

**STEP 3:** If power and/or output cables are not being routed through mounting surface, route them through cutouts in bottom sidewall of LiteALL™ control module.

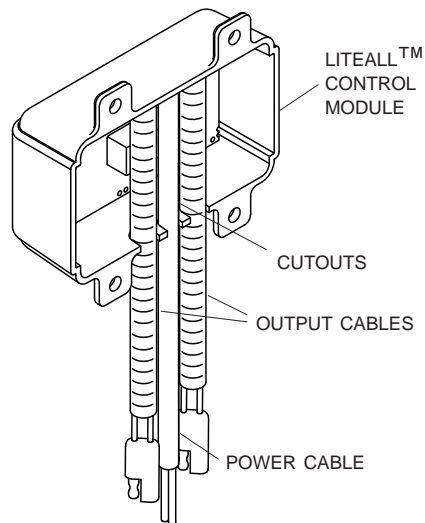

**STEP 4:** Fasten LiteALL™ control module to mounting surface with four self-drilling screws B and eight washers H (optional).

**NOTE:** Use of spacer may increase RF range in certain installations.

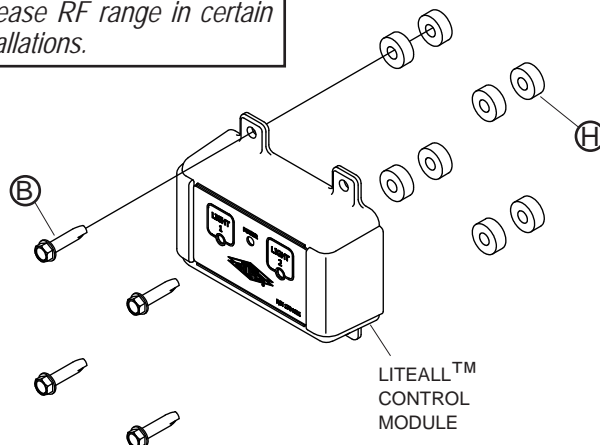

**STEP 5:** Route power cable to power terminals. Verify cable routing before securing cable. White wire will be connected to the 12-volt terminal and the black wire will be connected to the ground terminal. Reference wiring diagram on page 4.

**STEP 6:** Attach or crimp appropriate terminals onto 8' power cord.

| <u>Power Supply</u>                       | <u>Terminals</u>  |
|---|---|
| • Shur-Link Pro™                          | Two 1/4" ring terminals   |
| • Sealed junction box w/circuit breaker   | One #10 ring terminal on white wire<br>One 1/4" ring terminal on black wire |
| • Sealed junction box w/o circuit breaker | Two 1/4" ring terminals   |
| • User specified                          | User specified  |

Cut wires to length and strip only enough wire insulation to install ring terminals. Insert bare wire into ring terminals and crimp securely.

**STEP 7:** If possible, disconnect 12-volt power source from terminal posts or plugs where control module power cord will be connected. Fasten power cable ends to terminal posts. Connect white wire to 12-volt terminal and connect black wire to ground terminal. See electrical wiring diagrams on page 4.

**NOTE:** Do not leave the power connections exposed to the elements. If needed, an optional sealed junction box is available from Shur-Co®.

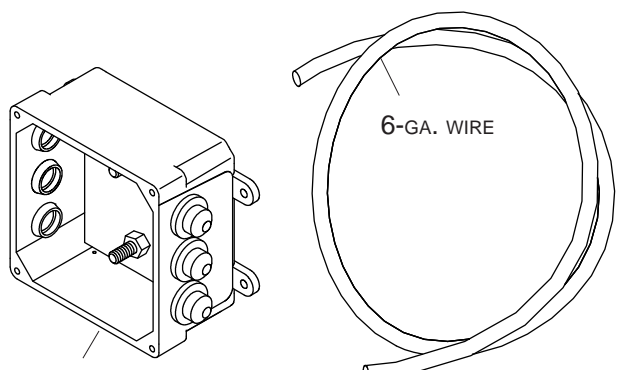

**STEP 8:** Use wire clips **F** and/or cable ties to secure power cable. Use drill and #2 Phillips bit to self-drill screws **A** and secure wire clips.

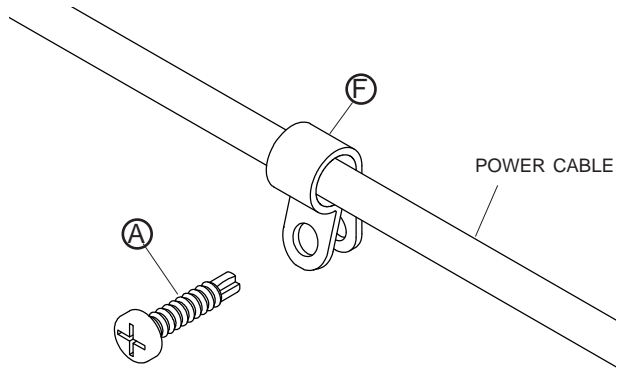

**STEP 9:** Use wire clips **G** and/or cable ties to secure output cables. Use drill and #2 Phillips bit to self drill screws **A** and secure wire clips.

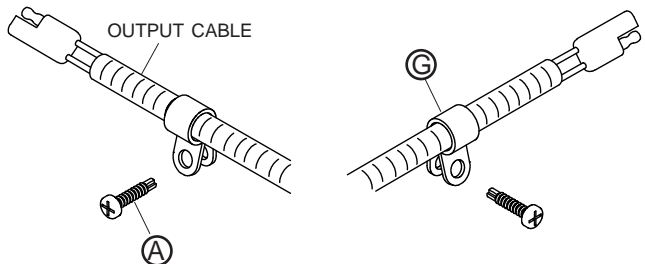

P/N 1119365 - 6-HOLE JUNCTION BOX

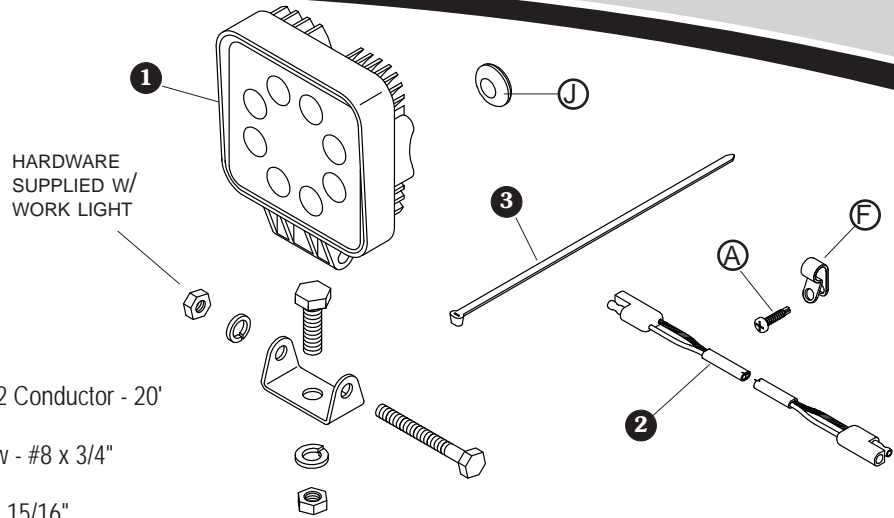

| Item | Part #  | Description                                |
|------|---------|--|
| 1.   | 1704719 | LED Work Light - 24 Watt                   |
| 2.   | 1704740 | Extension Cable - 16 Ga. 2 Conductor - 20' |
| 3.   | 1703231 | Cable Tie - 8"                             |
| A.   | 1704405 | Pan Hd. Self-Drilling Screw - #8 x 3/4"    |
| F.   | 1704699 | Nylon Wire Clip - 5/16"                    |
| J.   | 1704397 | Rubber Grommet - 7/16" x 15/16"            |

**STEP 1:** Use 1/2" and 9/16" combination wrenches to assemble LED work light mounting brackets. Use hardware found in LED work light boxes as shown.

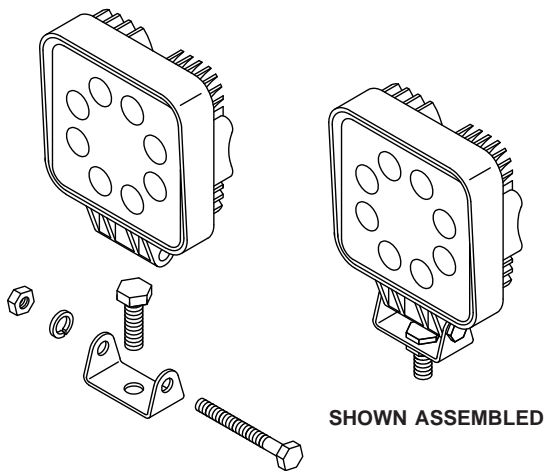

**STEP 2:** Drill 13/32" hole in desired location for work light mounting stud. Insert stud through hole and use 11/16" combination wrench to fasten lock washer and mounting nut.

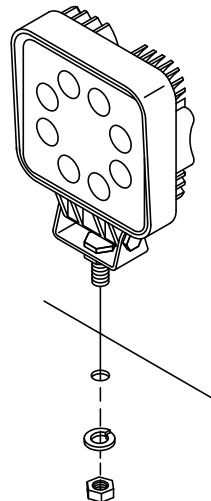

**STEP 3:** If work light cable is to be passed through mounting surface, use 11/16" hole saw to cut hole for grommet **J**. Thread work light cable through grommet, then insert grommet into hole.

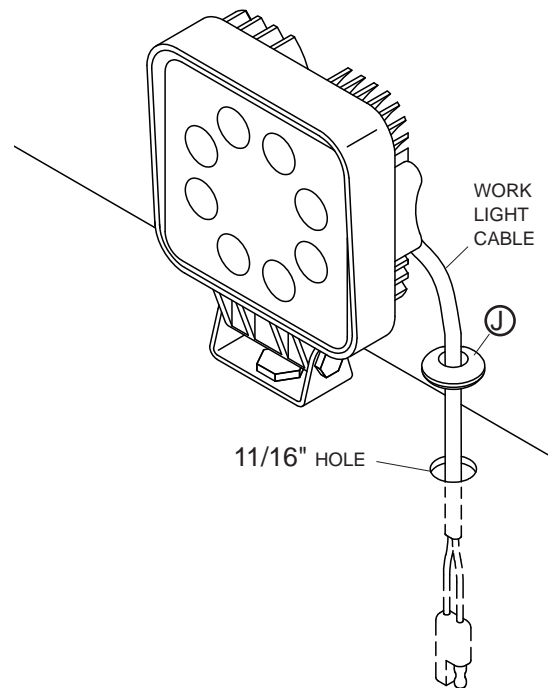

**STEP 4:** Route work light cable to LiteALL™ control module. Verify cable routing before securing cable. If 20' extension cable is needed, route extension cable between LiteALL™ control module and work light cables. Verify that molded two-way trailer connector will fit complementing connector; black wire to black wire, white wire to white wire. If not, use other end of extension cable. Connect two-way trailer connectors together.

**NOTE:** If needed, 20' extension cables are available for purchase at Shur-Co® (see parts list).

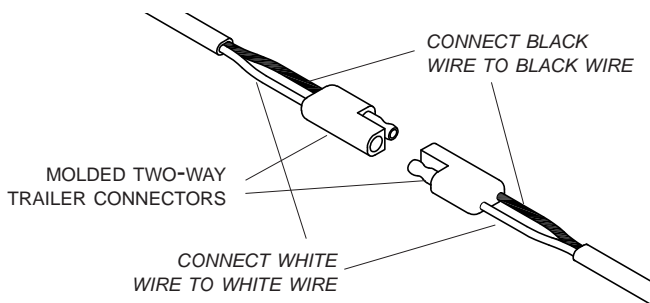

**STEP 5:** Use wire clips **F** and/or cable ties to secure work light cable. Use wire clips **E** and/or cable ties to secure extension cable (if installed). Use drill and #2 Phillips bit to self-drill screws **A** to secure wire clips.

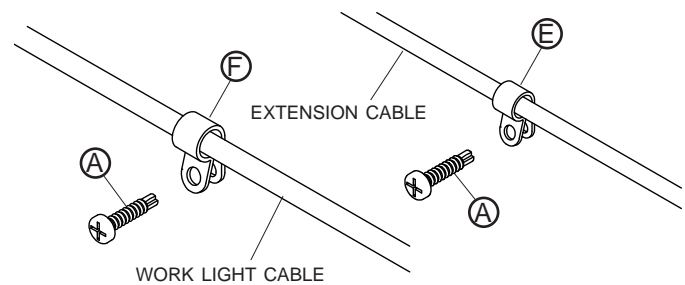

**STEP 6:** Coil and secure any excess cable with cable ties.

**LiteALL™ REPLACEMENT PARTS**

| Item | Part #  | Description                                |
|------|---------|--|
|      | 1120440 | LiteALL™ Retail Kit                        |
|      | 1120504 | LiteALL™ Junction Box Kit                  |
| 1.   |         | Control Module                             |
| 2.   | 1704719 | LED Work Light - 24 Watt                   |
| 3.   | 1704740 | Extension Cable - 16 Ga. 2 Conductor - 20' |
| 4.   | 1118437 | 5-Channel SMARTransmitter®                 |
| 5.   | 1703282 | Rubber Grommet - 7/8" x 1 5/8"             |
| 6.   | 1704397 | Rubber Grommet - 7/16" x 15/16"            |
| 7.   | 1704556 | Rubber Grommet - 5 to 10mm IP65            |
| 8.   | 1704153 | Ring Terminal 14 to 16 Ga. 1/4" Stud       |
| 9.   | 1704739 | Ring Terminal 14 to 16 Ga. #10             |
| 10.  | 1704700 | Nylon Wire Clip - 3/8" - Black             |
| 11.  | 1704699 | Nylon Wire Clip - 5/16" - Natural          |
| 12.  | 1704698 | Nylon Wire Clip - 1/4" - Black             |
| 13.  | 1704405 | Pan Hd. Self-Drilling Screw - #8 x 3/4"    |
| 14.  | 1704761 | Self-Drilling Screw - #12 x 1 1/4"         |
| 15.  | 1703231 | Cable Tie - 8"                             |
| 16.  | 1118037 | Plastic Washer - Black                     |

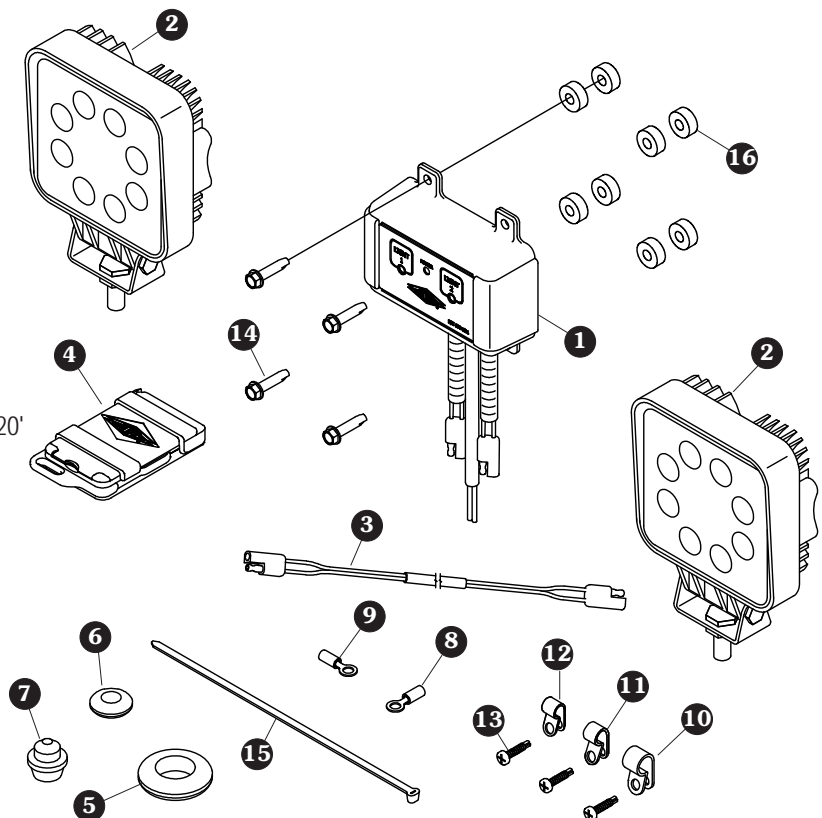

**SHIPPING.** All orders are shipped F.O.B. from the Shur-Co®, LLC sites listed below. There will be no full freight allowed or prepaid shipment accepted unless quoted and approved in writing prior to acceptance of the order. All shipments are made by the most reasonable means in accordance with the size and weight of the order, unless specified routing instructions are furnished by the customer. Shipments are made daily via U.P.S. and common carrier. Claims for shortages must be made within 10 days. All claims for damages or loss in transit must be made with the carrier. No collect calls will be accepted. To ensure delivery of orders, we need your full street address and phone number. When you receive your shipment, examine it carefully. Be sure all cartons listed on the delivery sheet are accounted for. Large items may be packaged separately. If a carton is damaged, open it and inspect the contents before signing for delivery. If merchandise is damaged, describe the damage on the delivery receipt. Failure on your part to document damaged or missing merchandise on the delivery receipt releases the carrier of all liability; repair or replacement will be the customer's responsibility.

**WARRANTY.** Shur-Co®, LLC warrants that all new products are free from defects in materials and workmanship.\* This warranty is effective if products are properly installed and used for the purpose for which they were intended and applies to the original buyer only. Our obligation under this warranty is limited to repairing or, at our option, replacing any part that is returned, transportation prepaid, to Shur-Co®, LLC, Yankton, SD, if the product is, in our judgement, defective. All materials returned without prior authorization will be refused. We shall not be

liable or responsible to supply or pay labor to replace any part found defective nor liable for damages of any kind or nature to person, product, property or downtime. There are no warranties for used products or products that have been repaired, altered, modified or subjected to misuse, negligence, accident or ordinary wear and tear. We will not honor claims if non-Genuine Shur-Co® parts are used.

\* Certain products have specific warranties that differ from this statement, i.e. motors and electronics. Product-specific documentation is available for these items.

**RETURN POLICY.** All sales are final. Returns for warranty must be accompanied by a Return Merchandise Authorization number (RMA#) to ensure proper credit. Transportation charges must be prepaid on returned warranty goods. C.O.D. returns will not be accepted. Upon confirmation of deficiencies by inspection, the merchandise will be corrected and returned prepaid, or purchase price credited if still under warranty. All other returns are subject to a 15% restocking fee. Any deviations to above merchandise returns must be preapproved. All prices, product listings, sizes, weights and manufacturing details are subject to change without notice. If a return is scheduled to be picked up by Shur-Co®, LLC, no storage charges will be paid by Shur-Co®, LLC prior to pickup. We will pick up the merchandise at our earliest convenience. No person is authorized to modify the foregoing conditions of sale whatsoever.

### SHUR-CO® OF SOUTH DAKOTA

*Corporate HQ and Outlet Store*  
2309 Shur-Lok St., PO Box 713  
Yankton, SD 57078-0713  
Phone - 800.474.8756  
Fax - 605.665.0501

### SERVICE CENTERS

**SHUR-CO® of NORTH DAKOTA**  
920 38th St. NW, Exit 66  
 Fargo, ND 58102  
Phone - 877.868.4488  
CANADA - 800.663.0000  
Fax - 701.277.1283

**SHUR-CO® of OHIO**  
1100 N. Freedom, St. Rt. 88 & 14  
Ravenna, OH 44266  
Phone - 866.356.0242  
Fax - 330.297.5599

**SHUR-CO® of TEXAS**  
34505 I-10 West, S. Frontage Rd.  
Brookshire, TX 77423  
Phone - 866.689.0039  
Fax - 281.934.3311

**SHUR-CO® of OKLAHOMA**  
1604 East US Hwy 66  
El Reno, OK 73036  
Phone - 866.356.0243  
Fax - 405.262.3842

**SHUR-CO® of COLORADO**  
10220 Brighton Rd., Unit #1  
Henderson, CO 80640  
Phone - 866.355.9173  
Fax - 303.289.2298

**SHUR-CO® of ILLINOIS**  
4350 E. Boyd Rd.  
Decatur, IL 62521  
Phone - 866.356.0246  
Fax - 217.877.8270

**SHUR-CO® of IOWA**  
3839 Midway Blvd.  
Ft. Dodge, IA 50501  
Phone - 866.356.0245  
Fax - 515.576.5578

# MORE QUALITY PRODUCTS FROM SHUR-CO®

---

- **Genuine Replacement Tarps**
- **Genuine Replacement Parts**
  
- **Agriculture Products**
  - Value Series Shur-Lok
  - Super Duty Shur-Lok
  - Shur-Lok® Junior
  - Premium Belt 'n Ratchet
  - Cable-Lok™
  - Turning Point™ Bow System
  
- **SMARTrailer™ Accessories for Agriculture Products**
  - SMARTransmitter®
  - Shur-Link Pro™
  - 3500 Series Electric
  - ProTrap® Hopper Opener
  - LiteALL™ Work Lights
  - Cable-Lok™ Electric Upgrade
  - Electric Turning Point™ Bow System
  - Value Series Electric
  - Solar Power Pack
  
- **Flatbed Products**
  - Lumber Tarps
  - Steel Tarps
  - Coil Tarps
  - Cargo Control
  
- **Construction Products**
  - Super Duty Shur-Lok
  - Premium Belt 'n Ratchet
  - Shur-Trak II™
  - Cover-Pro II®
  - UltraSteel Econo-Pull
  - UltraSteel Arm - Basic
  - UltraSteel Arm - Premium
  - Arm-Matic™
  - Turning Point™ Bow System
  
- **SMARTrailer™ Accessories for Construction Products**
  - SMARTransmitter®
  - 3500 Series Electric w/Gate Flex™
  - Shur-Trak II™ Electric Upgrade
  - Cover-Pro II® Electric Upgrade
  - Electric Turning Point™ Bow System
  - Solar Power Pack
  
- **Custom Products**
  - Fitted Truck Covers
  - Flat Utility Tarps
  - Bean Drill Covers
  - Hopper Extension Covers
  - Auger Boots

**ENGINEERED TARPING SOLUTIONS**

