

STEP 1: Remove spring pin and crank arm from head shaft. Store crank arm on trailer.

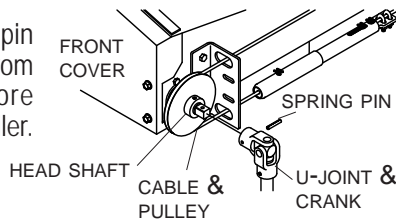

NOTE: Install motor on PASSENGER side only. Driver side is reserved for manual override crank arm.

STEP 2: Loosely mount electric motor to motor mount base plate. Fasten with screws supplied with motor and washers.

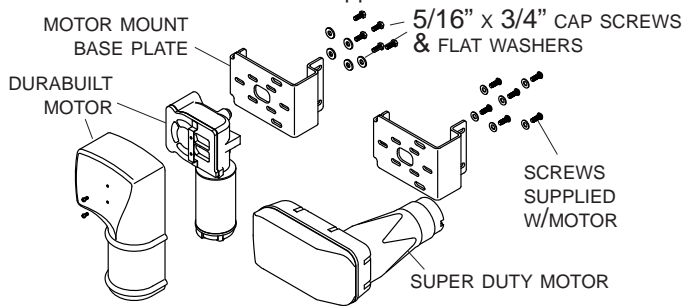

NOTE: Gear box can be mounted with motor down as shown or with motor up.

STEP 3: Slide electric motor shaft into head shaft bore. Fasten with cap screw **B** and lock nut **H**.

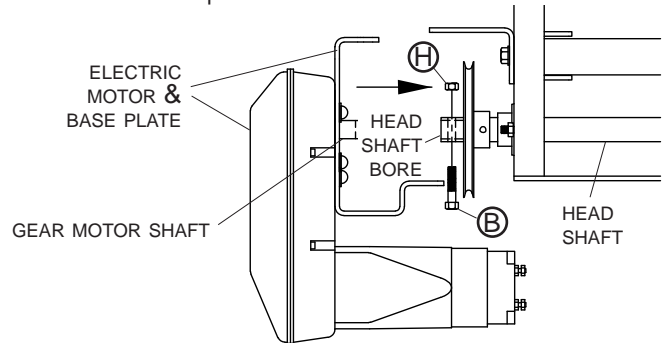

STEP 4: Fasten motor mount plate to cable guard. Fasten with screws **D**, lock washers **F**, flat washers **G** and nuts **K**. Replace hardware on front cap, engaging motor mount plate as shown. Tighten motor mount bolts.

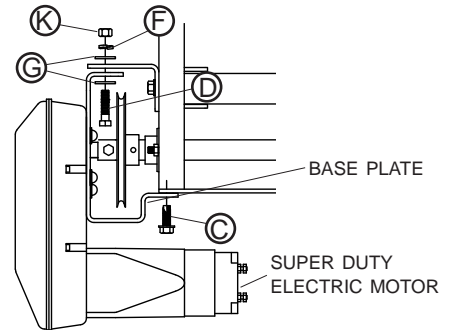

ELECTRIC MOTOR WIRING

STEP 5: Mount solenoid in suitable location - ventilated area near battery is ideal. Run 6-ga. wire from motor to solenoid and from power supply to circuit breaker to solenoid as shown. Run 14-ga. wire from solenoid to switch. Mount switch in an area convenient to operator, inside or outside cab. Mount with bracket or install directly into dash panels.

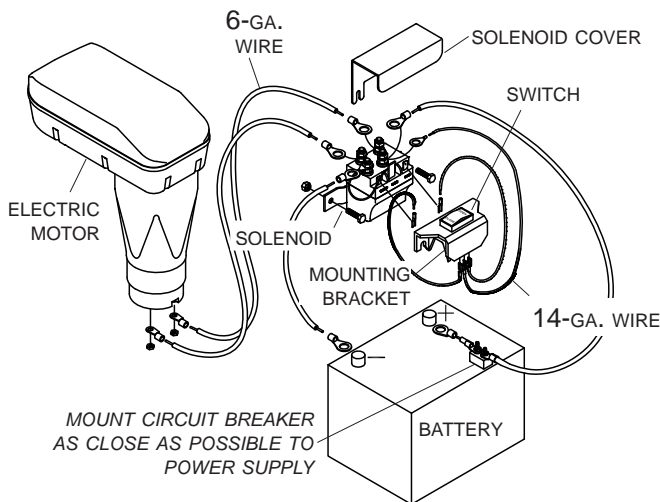

NOTE: Ground system through switch only. Wires to motor reverse continuity.

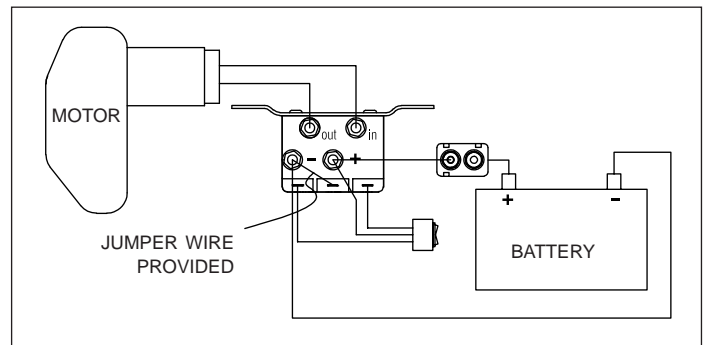

TIPS ON WIRING

- Pick up power at battery or terminal block. Use 6-ga. wire or larger when connecting to power supply and motor.
- Do not place wire in areas where wire could be pinched or cut during operation. Be sure to loop extra wire at hinge area on dump bodies.
- If switch is running system backwards, reverse 14-ga. wire at solenoid to reverse system operation.
- Momentary contact must be held open or closed to operate system.

DURABUILT ELECTRIC MOTOR
Lower torque for shorter truck boxes

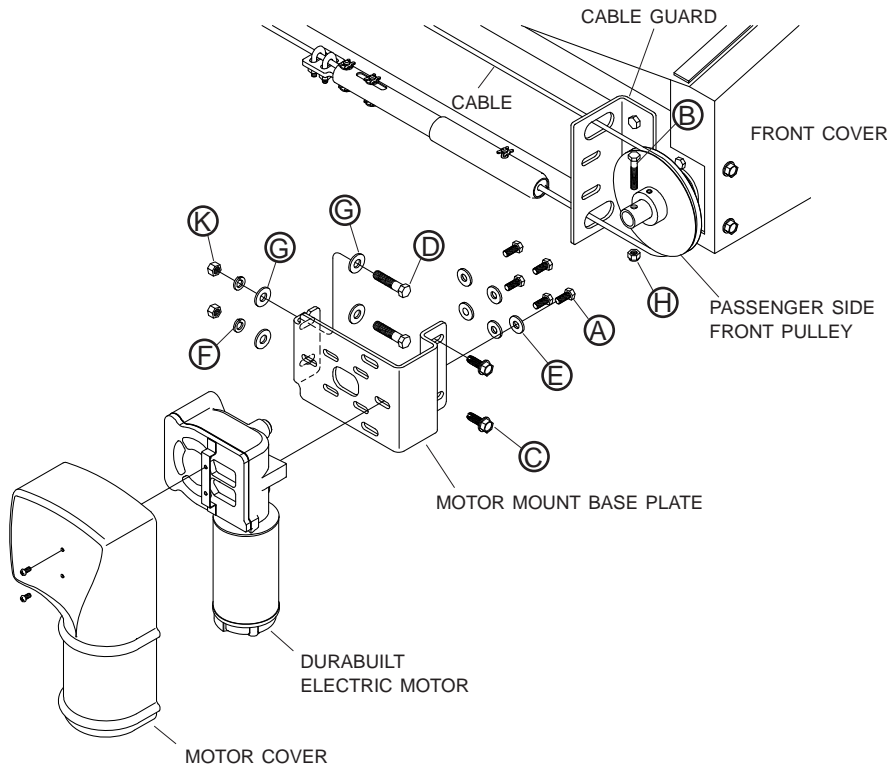

ELECTRIC COMPONENTS
Switch, bracket, breaker, solenoid and electric parts kit

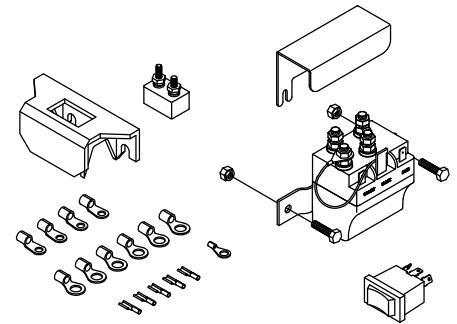

SUPER DUTY MOTOR

Higher torque for longer truck boxes

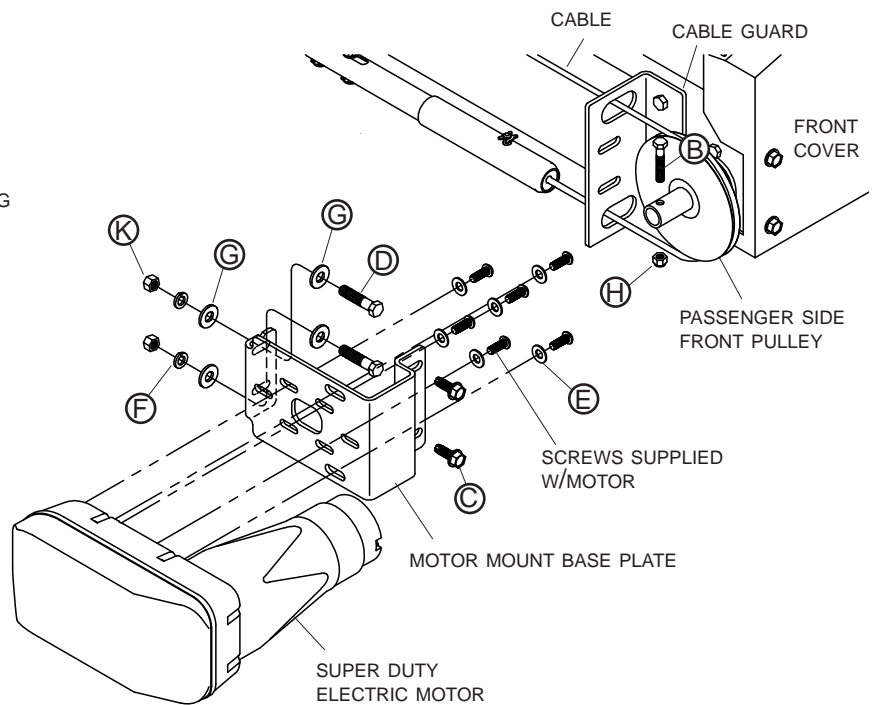

DUAL POLE CONDUCTOR

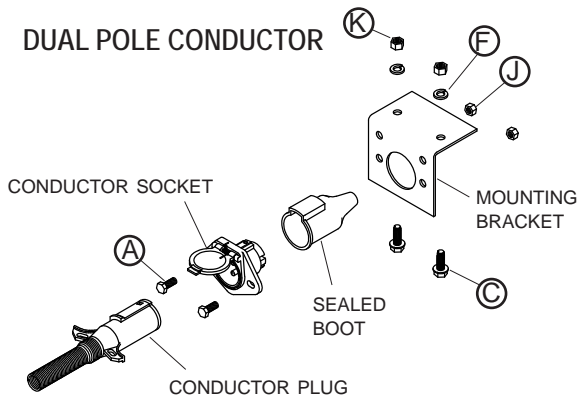

Hardware

Item	Part #	Description
A.	1701045	5/16" x 3/4" Cap Screw
B.	1701468	5/16" x 1 3/4" Cap Screw
C.	1700400	3/8" x 1" Self-Tapping Screw
D.	1701434	3/8" x 1 1/2" Cap Screw
E.	1700428	5/16" Flat Washer
F.	1700434	3/8" Lock Washer
G.	1701176	3/8" Flat Washer
H.	1702492	5/16" Top Lock Nut
J.	1700411	5/16" Hex Nut
K.	1700407	3/8" Hex Nut