



ENGINEERED TARPING SOLUTIONS

P/N 1120886 Rev. B

# INSTALLATION INSTRUCTIONS



## Wiring 4500 Series & Four ProTraps

*READ BEFORE INSTALLING*

PO BOX 713 ■ 2309 SHUR-LOK STREET ■ YANKTON, SD 57078-0713  
PHONE 1-800-4-SHUR-LOK (1-800-474-8756) ■ FAX 605-665-0501  
[www.shurco.com](http://www.shurco.com)

SHOP ONLINE: [www.shopshurco.com](http://www.shopshurco.com)

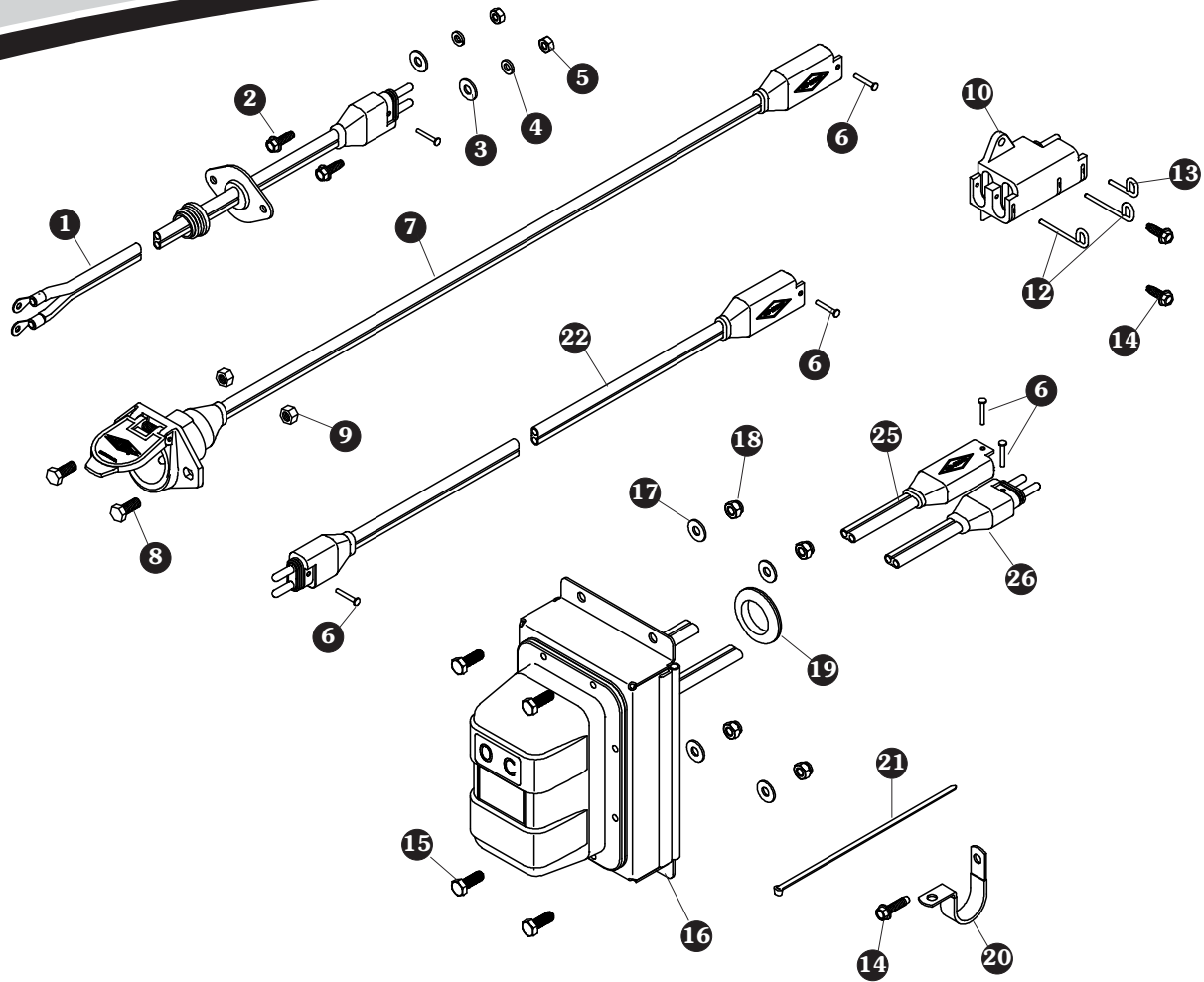

**SMARTWIRE™ INSTALLATION**

This instruction sheet covers a variety of trailers, therefore the locations for the SMARTwire™ components shown here may need to vary slightly on your trailer. Mounting locations are critical because wire lengths cannot be altered. Mounting SMARTwire™ components as close as possible to the locations shown will not only ensure a quick and easy installation, but will also facilitate SMARTwire™ upgrades.

Item	Part #	Description
1.		SMARTwire™ - 6 Ga. - Plug - 9' 9"
2.	1700403	Self-Tapping Screw - 1/4" x 3/4"
3.	1700427	Flat Washer - 1/4"
4.	1700436	Lock Washer - 1/4"
5.	1700408	Hex Nut - 1/4"
6.	1704751	Harness Lock Pin - 1/4" x 7/8"
7.	1120670	SMARTwire™ Dual Conductor Socket
8.	1701045	Cap Screw - 5/16" x 3/4"
9.	1700411	Hex Nut - 5/16"
10.	1704695	Harness Junction Block
12.	1704696	Harness Lock Pin - Long
13.	1704711	Harness Lock Pin - Short

Item	Part #	Description
14.	1704338	Self-Tapping Screw - 1/4" x 1"
15.	1702926	Cap Screw - 5/16" x 7/8"
16.		Shur-Co® Wireless Receiver - SMARTwire™
17.	1201237	Flat Washer - 5/16"
18.	1700419	Lock Nut - 5/16"
19.	1202938	Rubber Grommet - 1 1/2" Insert
20.	1702108	Wire Clip - 3/4"
21.	1703231	Cable Tie - 8"
22.		SMARTwire™ - 6 Ga. x 25' - Plug/Socket
25.		SMARTwire™ - 6 Ga. x 6' 3" - Socket
26.		SMARTwire™ - 6 Ga. x 2' 4" - Plug

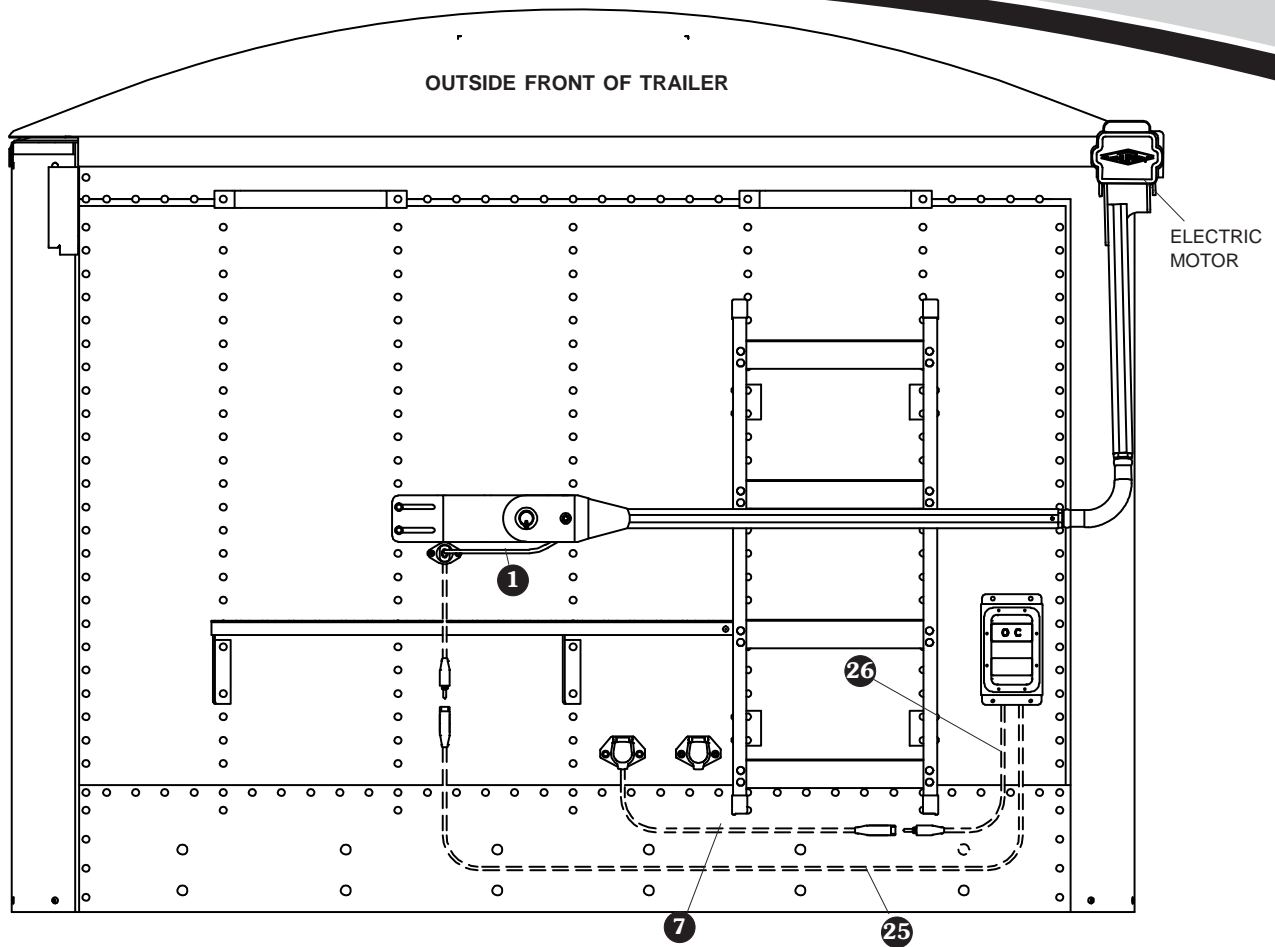

**NOTE:** Wire lengths are predetermined. Before installing SMARTwire™ components, review and confirm wire routing so that wires will reach components with ample room for connection.

**DUAL-POLE CONDUCTOR SOCKET INSTALLATION**

**STEP 1:** Locate dual-pole conductor socket near seven-pole conductor socket as shown. Determine location and drill 2" hole through trailer skin.

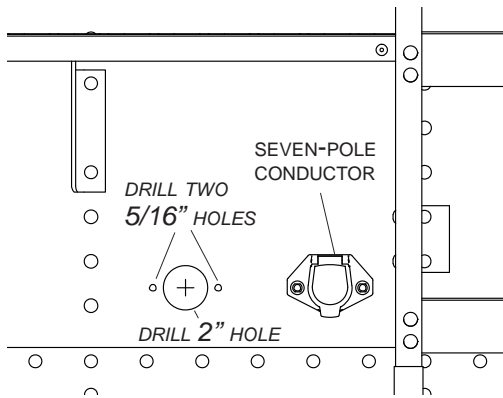

**STEP 2:** Align socket over 2" hole. Using holes in flanges on socket as a guide, mark and drill two 5/16" holes.

**STEP 3:** Fasten conductor socket to trailer with 5/16" x 3/4" cap screws and nuts.

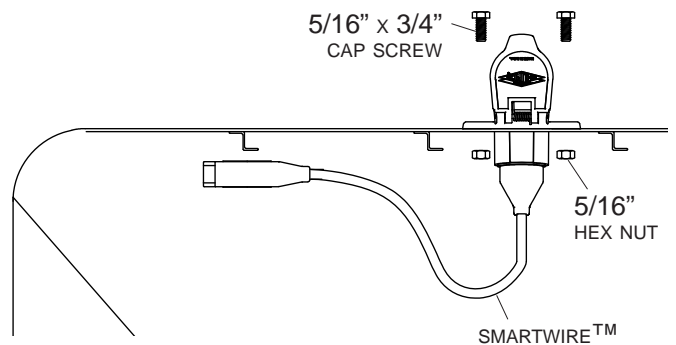

**SHUR-CO® WIRELESS RECEIVER INSTALLATION**

**STEP 1:** Locate Shur-Co® wireless receiver as shown on page 2. Determine location and drill 2" hole through trailer skin.

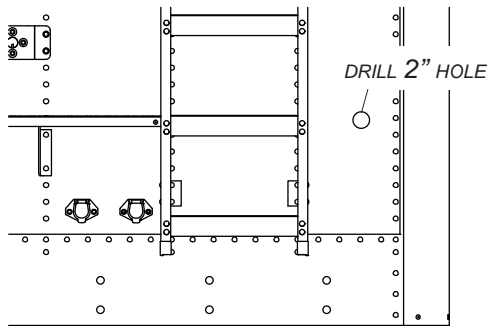

**STEP 2:** Align holes in wireless receiver over 2" hole in trailer as shown below. Using holes on flanges on receiver as a guide, mark and drill four 5/16" holes as shown.

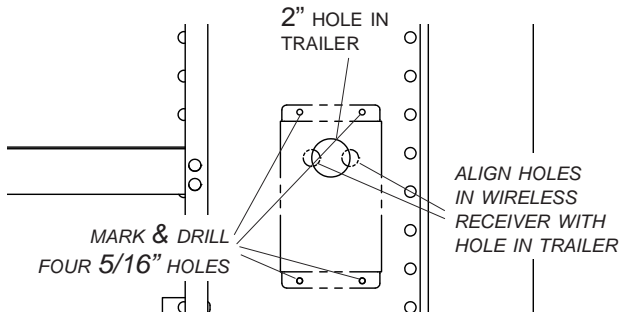

**STEP 3:** Install grommet into 2" hole. Insert wire from wireless receiver through grommet.

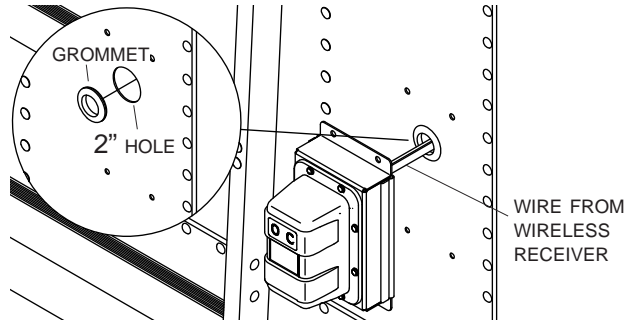

**STEP 4:** Align holes on wireless receiver with holes on trailer. Fasten receiver to trailer with 5/16" x 7/8" cap screws, lock washers and nuts.

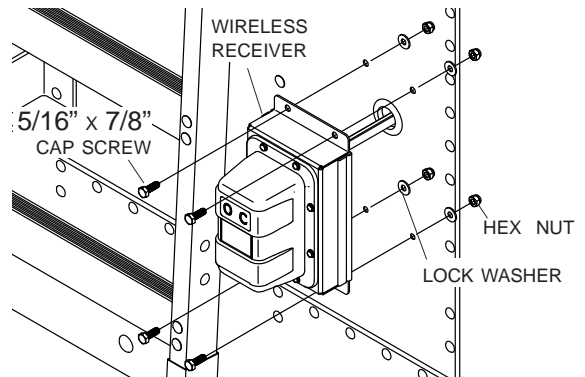

**ADAPTER PLUG INSTALLATION**

**STEP 1:** Measure 11" horizontally from center line of trailer and 1" down from lower edge of pivot bracket. Mark and drill 1 1/2" hole through trailer skin.

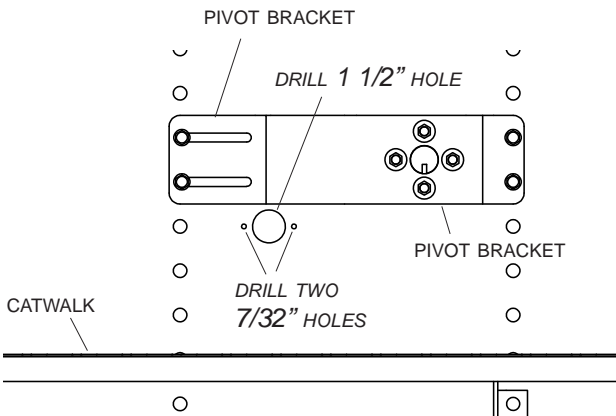

**STEP 2:** Align adapter plug with 1 1/2" hole. Using plug as a guide, mark and drill two 7/32" holes as shown.

**STEP 3:** Fasten adapter plug to front of trailer with 1/4" x 3/4" cap screws, lock washers and nuts.

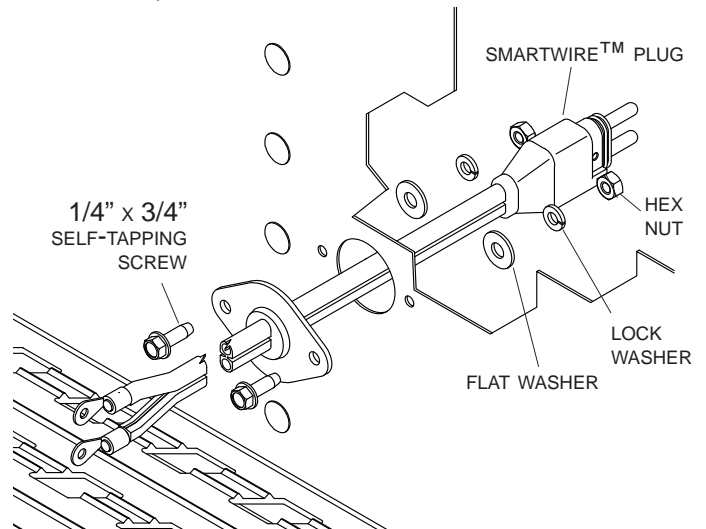

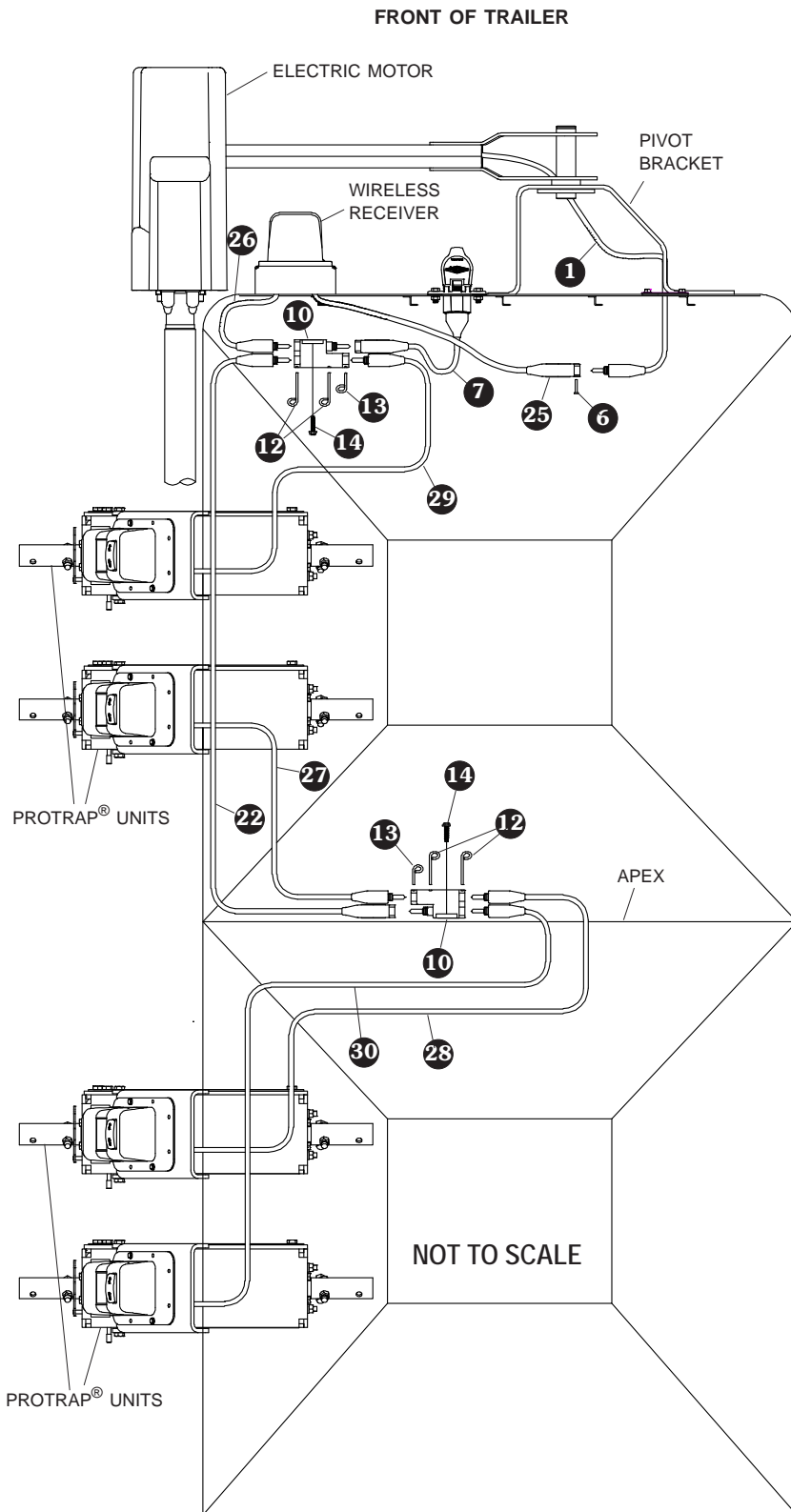

**NOTE:** Coat each connection with dielectric grease (P/N 1704378) to prevent corrosion.

**CAUTION**  
Do not fasten SMARTwire™ components to trailer through hopper walls.

**FRONT OF TRAILER**

- STEP 1:** Route SMARTwire™ 25 from wireless receiver to adapter plug. Connect wire to adapter plug and secure with lock pin 6.
- STEP 2:** To determine location of front junction block, route SMARTwires 7 and 26 to a location where wires will reach. Mount junction block 10 at this location. Using holes in junction block as a guide, mark and drill two 7/32" holes.
- STEP 3:** Fasten junction block 10 to trailer with screws 14.
- STEP 4:** Connect SMARTwires 7, 22, 29 and 26 to junction block 10. Secure connections with lock pins 12 and 13.
- STEP 5:** Route SMARTwire™ 22 from front to apex of trailer.

**APEX OF TRAILER**

- STEP 6:** To determine location of second junction block, route SMARTwires 22, 27, 30 and 23 to a location near apex of trailer where wires will reach. Mount junction block 10 at this location. Using holes in junction block as a guide, mark and drill two 7/32" holes.
- STEP 7:** Fasten junction block 10 to trailer with screws 14.
- STEP 8:** Connect SMARTwires 22, 27, 30 and 23 to junction block 10 at apex of trailer. Secure all connections with lock pins 12 and 13.
- STEP 9:** Secure all wires to trailer with cable clips 20 and screws 14. If needed, use cable ties 21.





# MORE QUALITY PRODUCTS FROM SHUR-CO®

---

- **Genuine Replacement Tarps**
- **Genuine Replacement Parts**
  
- **Agriculture Products**
  - Value Series Shur-Lok
  - Super Duty Shur-Lok
  - Shur-Lok® Junior
  - Premium Belt 'n Ratchet
  - Cable-Lok™
  - Turning Point™ Bow System
  
- **SMARTrailer™ Accessories for Agriculture Products**
  - SMARTransmitter®
  - Shur-Link Pro™
  - 4500 Series Electric
  - ProTrap® Hopper Opener
  - LiteALL™ Work Lights
  - Cable-Lok™ Electric Upgrade
  - Electric Turning Point™ Bow System
  - Value Series Electric
  - Solar Power Pack
  
- **Flatbed Products**
  - Lumber Tarps
  - Steel Tarps
  - Coil Tarps
  - Cargo Control
  
- **Construction Products**
  - Super Duty Shur-Lok®
  - Premium Belt 'n Ratchet
  - Shur-Trak II™
  - Cover-Pro II®
  - UltraSteel Econo-Pull
  - UltraSteel Arm - Basic
  - UltraSteel Arm - Premium
  - Arm-Matic™
  - Turning Point™ Bow System
  - IronSide™ Side Arm System
  
- **SMARTrailer™ Accessories for Construction Products**
  - SMARTransmitter®
  - 4500 Series Electric w/Gate Flex™
  - Shur-Trak II™ Electric Upgrade
  - Cover-Pro II® Electric Upgrade
  - Electric Turning Point™ Bow System
  - Solar Power Pack
  
- **Custom Products**
  - Fitted Truck Covers
  - Flat Utility Tarps
  - Bean Drill Covers
  - Hopper Extension Covers
  - Auger Boots

ENGINEERED TARPING SOLUTIONS

